

Ford FL1Z13008F

Ford FL1Z-13008-F Headlamp Assembly Instruction Manual

Genuine Ford Part: FL1Z-13008-F

1. PRODUCT OVERVIEW

This manual provides essential information for the proper installation, operation, and maintenance of your Ford FL1Z-13008-F Headlamp Assembly. This is a genuine Ford replacement part designed to fit specific vehicles, ensuring optimal performance and compatibility.

Key Features:

- **Genuine Ford Part:** Ensures quality, fit, and durability.
- **Front Left Position:** Specifically designed for the driver's side front of the vehicle.
- **Waterproof Design:** Provides protection against environmental elements.
- **Meets OEM Specifications:** Manufactured to meet original equipment manufacturer standards for form, fit, and function.



Image 1.1: Front view of the Ford FL1Z-13008-F Headlamp Assembly, showcasing the clear lens and internal components.

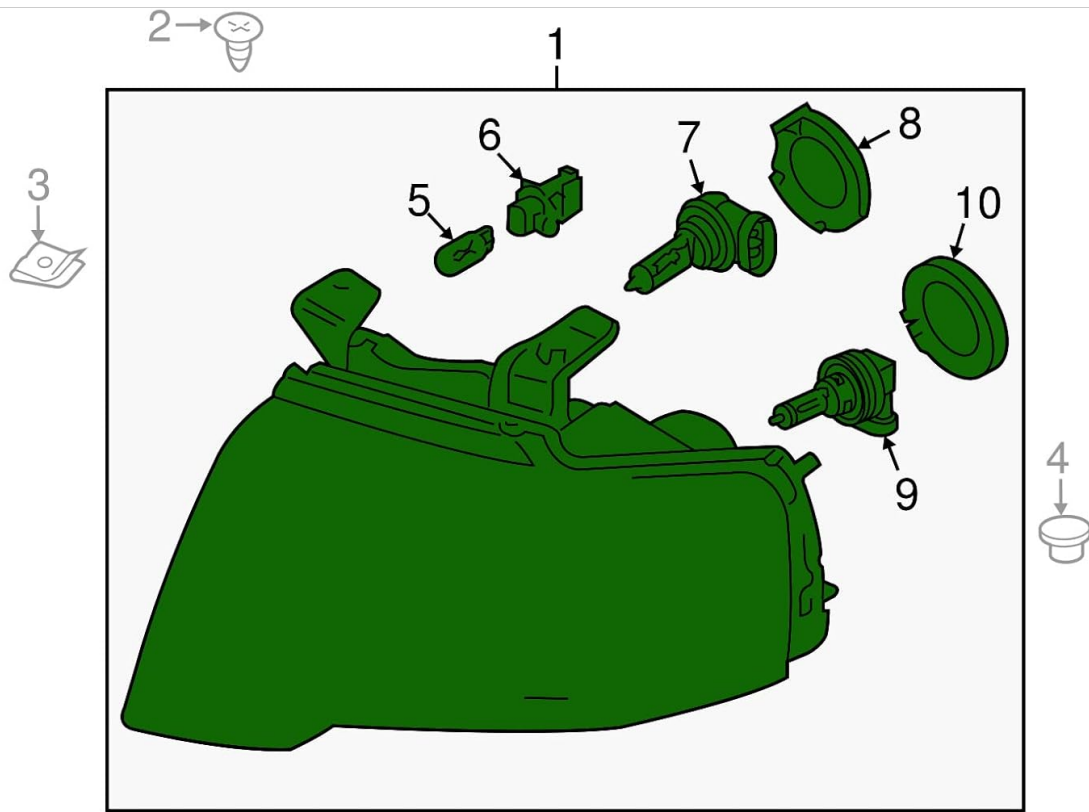

Part or sub-assembly is #1 in diagram
Diagram may not be specific to your vehicle

Image 1.2: Official Ford Parts label for the FL1Z-13008-F Headlamp Assembly, confirming part number and authenticity. The part number is **FL1Z-13008-F** and the manufacturing code is **5412707**.

2. SETUP AND INSTALLATION

Installation of a headlamp assembly typically requires mechanical aptitude and specific tools. It is highly recommended that this procedure be performed by a qualified automotive technician. Incorrect installation can lead to damage to the vehicle, the headlamp assembly, or improper function.

General Installation Steps (Consult your vehicle's service manual for specific instructions):

1. **Safety First:** Ensure the vehicle is turned off, the parking brake is engaged, and the battery is disconnected to prevent electrical hazards.
2. **Access:** Depending on the vehicle model, access to the headlamp assembly may require removing the front bumper, grille, or fender liner.
3. **Disconnect:** Carefully disconnect the electrical connectors from the existing headlamp bulbs and any other wiring harnesses attached to the assembly.
4. **Remove Old Assembly:** Unbolt and remove the old headlamp assembly. Note the location and type of all fasteners.
5. **Inspect:** Before installing the new assembly, inspect the vehicle's wiring harness and mounting points for any damage or corrosion.
6. **Install New Assembly:** Position the new Ford FL1Z-13008-F Headlamp Assembly into place. Secure it with the appropriate bolts, ensuring it is seated correctly.
7. **Connect:** Reconnect all electrical connectors to the new headlamp assembly. Ensure connections are secure.

8. **Test:** Reconnect the vehicle battery. Test all headlamp functions (low beam, high beam, turn signal, parking light) before reassembling any removed body panels.
9. **Aiming:** After installation, it is crucial to properly aim the headlamps to ensure correct illumination of the road and to avoid blinding oncoming drivers. Refer to your vehicle's service manual for headlamp aiming procedures.

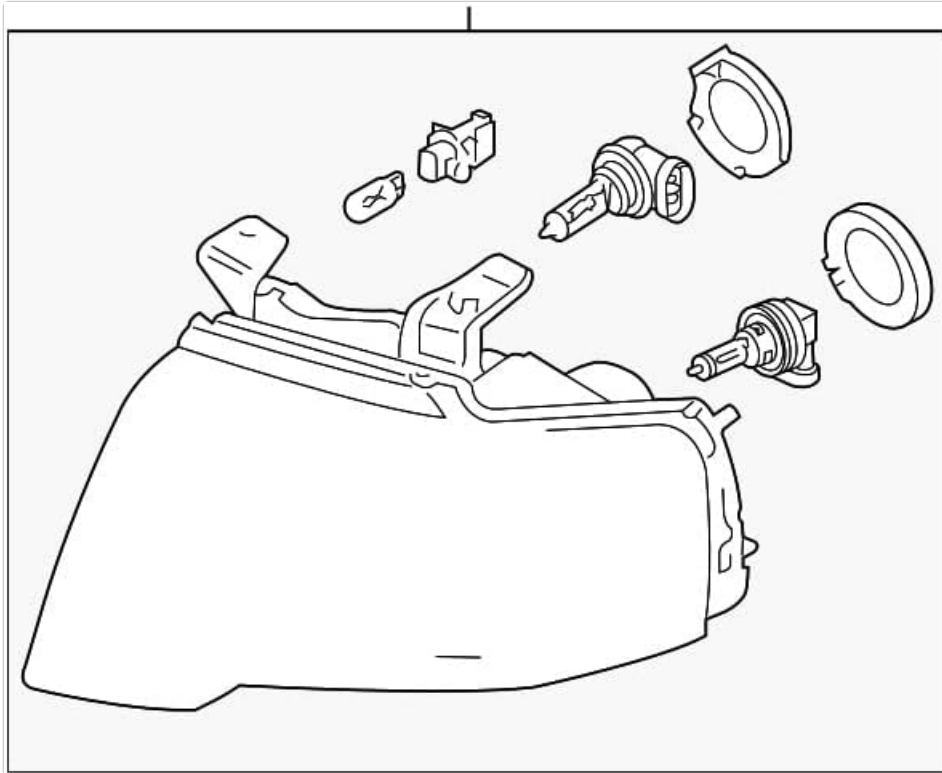

Image 2.1: Exploded view diagram illustrating the various components of a headlamp assembly, including bulbs and mounting points. This diagram aids in understanding the assembly's structure for installation.



Image 2.2: Rear view of the headlamp assembly, highlighting the access points for bulbs and electrical connections, crucial for installation and maintenance.

3. OPERATING INSTRUCTIONS

The Ford FL1Z-13008-F Headlamp Assembly functions as part of your vehicle's primary lighting system. Its operation is controlled directly by your vehicle's existing headlamp switch and stalk controls.

Basic Operation:

- **Low Beams:** Activated via the vehicle's headlamp switch, providing standard illumination for driving.
- **High Beams:** Activated via the vehicle's stalk control, providing maximum illumination for clear visibility when appropriate.
- **Turn Signals:** The integrated turn signal light operates in conjunction with your vehicle's turn signal lever.
- **Parking Lights:** The assembly includes parking lights, which are typically activated with the headlamp switch in a specific position.

Always refer to your vehicle's owner's manual for detailed instructions on operating your specific vehicle's lighting system.

4. MAINTENANCE

Proper maintenance ensures the longevity and optimal performance of your headlamp assembly. Regular checks and cleaning are recommended.

Cleaning:

- Clean the exterior lens of the headlamp regularly with a soft cloth and mild automotive soap or glass cleaner.
- Avoid abrasive cleaners or harsh chemicals, as these can damage the lens coating.
- If the lens appears hazy or yellowed over time, specialized headlamp restoration kits can be used, or professional service may be sought.

Bulb Replacement:

- Bulbs are consumable items and will eventually require replacement.
- Refer to your vehicle's owner's manual for the correct bulb types and specific replacement procedures.
- When replacing bulbs, avoid touching the glass portion of the new bulb with bare hands, as oils can reduce bulb life. Use gloves or a clean cloth.
- Ensure the replacement bulb is securely seated and the electrical connector is firmly attached.

Inspection:

- Periodically check the headlamp assembly for cracks, moisture intrusion, or loose mounting.
- Ensure all lights (low beam, high beam, turn signal, parking light) are functioning correctly.

5. TROUBLESHOOTING

If your headlamp assembly is not functioning as expected, consider the following basic troubleshooting steps. For complex issues, professional diagnosis is recommended.

Common Issues and Solutions:

- **Headlamp Not Working:**
 - Check the bulb: The bulb may be burnt out and require replacement.
 - Check the fuse: A blown fuse in the vehicle's fuse box can prevent the headlamp from working. Refer to your vehicle's manual for fuse box location and diagram.
 - Check electrical connections: Ensure all connectors to the headlamp assembly and bulbs are secure and free of corrosion.
- **Headlamp is Dim or Flickering:**
 - Weak electrical connection: Inspect wiring and connectors for looseness or corrosion.
 - Aging bulb: Bulbs can dim over time before completely failing. Consider replacing the bulb.
 - Voltage issue: This may indicate a problem with the vehicle's electrical system (e.g., alternator, wiring). Professional diagnosis is recommended.
- **Moisture Inside Headlamp:**
 - Small amounts of condensation can be normal and should dissipate.
 - If significant water accumulation or persistent condensation occurs, inspect the assembly for cracks or improper sealing. This may require replacement or professional repair.

6. SPECIFICATIONS

Attribute	Detail
Brand	Ford
Manufacturer Part Number	FL1Z13008F
Position	Front Left
Special Features	Waterproof
Specific Uses For Product	Head Lights
Vehicle Service Type	Car
Lens Color	Clear

7. WARRANTY INFORMATION

As a genuine Ford part, this headlamp assembly is typically covered by Ford's standard parts warranty. Warranty terms and conditions can vary based on the purchase location and installation method (e.g., dealer installed vs. DIY). For specific warranty details, please retain your proof of purchase and contact an authorized Ford dealer or visit the official Ford website.

8. SUPPORT

For further assistance, technical support, or to locate an authorized service center, please contact:

- Your local authorized Ford dealership.

- Ford Customer Service (refer to the official Ford website for contact information specific to your region).

When contacting support, please have your vehicle's VIN (Vehicle Identification Number) and the part number (FL1Z-13008-F) readily available.