

Manuals+

[Q & A](#) | [Deep Search](#) | [Upload](#)

manuals.plus /

› [American Lighting](#) /

› [American Lighting LED Complete 2 Under Cabinet Fixture ALC2-12-WH Instruction Manual](#)

American Lighting ALC2-12-WH

American Lighting LED Complete 2 Under Cabinet Fixture ALC2-12-WH Instruction Manual

Model: ALC2-12-WH

INTRODUCTION

This manual provides comprehensive instructions for the safe installation, operation, and maintenance of your American Lighting LED Complete 2 Under Cabinet Fixture. This 120-Volt dimmable warm white LED fixture is designed for efficient and uniform lighting in various indoor applications.



Image: The American Lighting LED Complete 2 Under Cabinet Fixture, a white, rectangular LED light bar with a switch on the front, designed for under-cabinet installation.

IMPORTANT SAFETY INFORMATION

WARNING:

- Read all instructions before beginning installation.
- This product may represent a possible shock or fire hazard if improperly installed or attached in any way. Products should be installed in accordance with these instructions, current electrical codes, and/or the current National Electric Code (NEC).

- To reduce the risk of fire, electric shock, or injury to persons, pay close attention to this manual and stay within its guidelines when using this product.
- Ensure that the voltage of your power supply is compatible (120V AC).
- Do not exceed 5 AMPS maximum load.
- For use with 120V 60Hz power supply only.
- Wiring must be completed before mounting.
- All fixtures connected to junction box must be mounted.
- Do not install in wet environments. For indoor, dry location use only.
- Qualified electricians in accordance with local electrical codes should perform all installations.
- UL approved dimmers may be used with the LED Complete (ALC Series) dimmable under cabinet fixtures.
- This product is suitable for use in dimming circuits.
- Always disconnect electrical power to the product before cleaning or putting on or taking off parts.
- Do not operate this product if jumper cable has been damaged.
- Keep jumper cable away from sources of heat and heated surfaces.
- Do not operate this product in environments where aerosol sprays are being used or where oxygen is being administered.
- For cleaning, use a soft, dry damp cloth. Do not use harsh chemicals or abrasives.

CAUTION:

- To reduce the risk of electric shock, do not use this junction box or jumper cables for the ALC series (part numbers ALC-length-color) to provide power to any products other than the LED Complete fixtures (ALC Series).
- To reduce the risk of fire, electric shock, or injury to persons, do not operate fixture with missing or damaged lens or wiring compartment cover.
- To reduce the risk of electric shock or injury to persons, do not operate without end connector cover(s) in place for any molex ports/connectors not in use.
- Not intended for recessed installation in ceilings or soffits.
- LEDs are bright! Do not look directly at LED light source.
- Do not touch LEDs.
- There are no serviceable parts inside the LED module.

INSTALLATION INSTRUCTIONS

ALC2 Series



⚠ WARNING

These products may represent a possible shock or fire hazard if improperly installed or attached in any way. Products should be installed in accordance with these instructions, current electrical codes, and/or the current National Electric Code (NEC).

⚠ WARNING

To reduce the risk of fire, electric shock or injury to persons, make sure that the electrical power to the system is disconnected at the source prior to installation or any servicing.

⚠ WARNING

Caution: Injury to persons and damage to the fixture and/or mounting surface may result if the fixture is pulled from the surface. To reduce the likelihood of such injury or damage, mount on a surface that is mechanically sound.

IMPORTANT SAFETY INFORMATION

- Read all instructions before beginning. Save these instructions for future use.
- To reduce the risk of fire, electric shock, or injury to persons, pay close attention to this manual and stay within its guidelines when using this product.
- **CAUTION:** To reduce the risk of electric shock or injuries to persons, use only insulated staples or plastic ties to secure cords and only route/secure cords to that they will not be pinched or damaged when the cabinet is pushed to the wall.
- **CAUTION:** To reduce the risk of electric shock or injuries to persons, do not operate fixture with missing or damaged lens or wiring compartment cover.
- **CAUTION:** To reduce the risk of electric shock or injuries to persons, do not operate without end connector cover(s) in place for any molex ports/connectors not in use.
- **WARNING! CAUTION - RISK OF FIRE:** Keep fixtures away from curtains and other combustible materials.
- Suitable for indoor dry locations only.
- Do not exceed the maximum load of 400 watts when interconnecting fixtures.
- Not intended for recessed installation in ceilings or soffits
- LEDs are bright! Do not look directly at LED light source.
- Do not touch LEDs.
- There are no serviceable parts inside the LED module.
- For cleaning, use a soft, dry or damp cloth. Do not use harsh chemicals or abrasives.

PRE-INSTALLATION NOTES:

LED Complete 2 fixtures can be hardwired directly via rear access door, or hardwired indirectly via the Hardwire Junction Box, or powered by a 120V receptacle. Fixtures can be powered by an adjacent fixture using linking cables. Determine installation method and purchase necessary accessories separately. Available Accessories (sold separately) include **ALC-BOX:** 120V Hardwire Junction Box **ALC-PC6:** 120V AC Power Cord (6ft length), and **ALC-EX:** Interconnectable linking/jumper cable (6" and 12" lengths). This product is suitable for use in dimming circuits. It is compatible with most standard TRIAC, CL, ELV and MLV dimmers (5-100% light control).

CONNECTING POWER VIA SUPPLY WIRES THROUGH REAR ACCESS DOOR (See Figures 1-4):

The rear access door is located in the center of the back of the fixture housing. It has its own knockout for quick connection to supply wires, foregoing the need to remove the lens cover and open the wiring compartment.

1. Remove knockout using a hammer or punch, then loosen the screw that secures the rear access door using a Philips head screwdriver or driver bit. See Figure 1.
2. Install the 3/8" cable connector (included) for the supply wire following National Electric Code and local codes through this knockout on the access door. See Figure 2. Use 14AWG or 12AWG wires. AC should be protected by circuit breaker or fuse.
3. Strip back jacket on supply wires to 3/8" and use push-in wire connectors inside housing to connect the wires, matching polarity (Black to Black = Hot, White to White = Neutral, Yellow/Green to Bare Wire = Ground) through knockout so that push-in connectors are positioned on the housing side of the access door. See Figure 3.
4. Replace rear access door and tighten retaining screw. Be sure that the wires are not pinched or damaged by any part of the housing or the cover. See Figure 4.

FIGURE 1

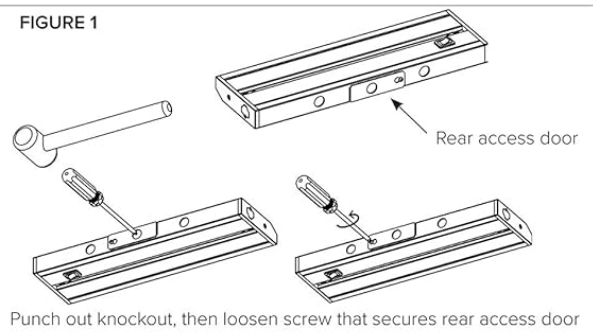

FIGURE 2

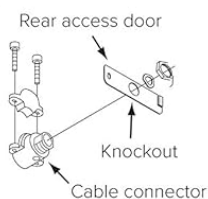

FIGURE 3

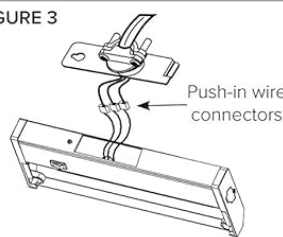

FIGURE 4

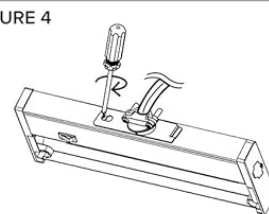

Image: A page from the installation instructions detailing important safety information, warnings, and pre-installation notes for the LED Complete 2 series.

SETUP AND INSTALLATION

The American Lighting LED Complete 2 fixture offers flexible installation options, including direct wire and linking multiple units.

Mounting the Fixture

1. Determine locations for each fixture. For hardwire installations, connect supply wires via knockouts before mounting.
2. Use a Phillips head screwdriver or driver bit to tighten captive mounting screws and secure fixture to an



Features

- 3000K color temperature and 93+ CRI
- Diffused lens eliminates dotting
- Efficacies up to 70 lumens per watt
- Linkable up to 400W
- Low profile design - less than 1" high
- Plug-in or direct wire capable
- Dimmable with most CL and ELV dimmers
- cETLus Listed for indoor dry locations
- 35,000 hours rated life
- ENERGY STAR certified

Available Sizes

8" / 12" / 18" / 24" / 32" / 40"

Available Finishes



White Dark Bronze

Dimming Options

- CL (5-100%)
- ELV (5-100%)

Listing / Ratings



LED Complete 2 - 120V

Choose from six energy efficient fixture lengths in two finishes. Easy installation with captive mounting screws, quick access door to wiring compartment, and handy accessories such as hardwire box and linking cables. Multiple fixtures can also be linked directly with an inline connector (included). Long life, high CRI and convenient dimming are additional benefits.

Technical Information

Series	ALC2
Input Voltage	120V AC, 60Hz
CCT	3000K
CRI	93+
Wattage	Up to 14W (see individual product)
Lumens	Up to 955Lm (see individual product)
Beam Angle	120°
Max Run	400W
Dimmable	5-100%
Mounting	Surface mount
Rating	cETLus Listed (dry location)
Rated Life	35,000 hrs

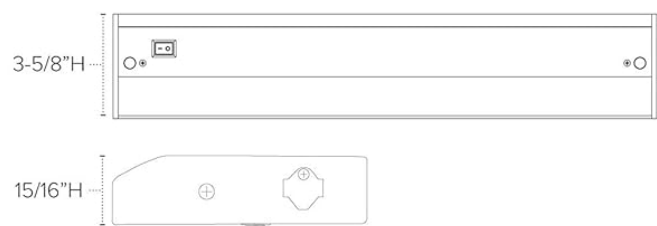

A AMERICAN LIGHTING

www.AmericanLighting.com

Image: Diagram showing the mounting points and rear access door of the fixture. It illustrates how to secure the fixture to a surface using screws.

Connecting Power via Rear Access Door

This method is used for hardwiring the fixture directly to a power source.

1. The rear access door is located in the center of the back of the fixture housing. It has its own knockout for quick connection to supply wires, foregoing the need to remove the lens cover and open the wiring compartment.

2. Remove knockout using a hammer or punch, then loosen the screw that secures the rear access door using a Phillips head screwdriver or driver bit.
3. Install the 3/8" cable connector (included) for the supply wire following National Electric Code and local codes through this knockout on the access door. Ensure to use 14AWG or 12AWG wire. AC should be protected by circuit breaker or fuse.
4. Strip back jacket on supply wires to 3/8" and use push-in connectors inside housing to connect the wires, matching polarity (Black=Black, Hot; White=White, Neutral; Yellow/Green=Bare Wire = Ground) through knockout so that push-in connectors are positioned on the housing side of the access door.
5. Replace rear access door and tighten retaining screw. Be sure that the wires are not pinched or damaged by any part of the housing or the cover.

120V LED COMPLETE 2 Undercabinet



PROJECT: _____ TYPE: _____

LOCATION: _____ CAT: _____



Dark Bronze



White

Description

A modular LED undercabinet fixture with dimmable Warm White LEDs, a low profile housing and glare-free acrylic lens.

Features

- Cool operation and high light output
- Powder coated aluminum housing
- Full length diffuse acrylic lens
- Multiple connection points hold PC board firmly against heat sink, optimizing heat dissipation and extending LED life
- Modular design with hardwire junction boxes, power cords, and linking cables (sold separately)
- Hardwire, modular, or plug-in power options

Mounting

Captive mounting screws and quick stab wire connectors plus quick access door for hardwire installations. Captive mounting screw holes are located 9/16" from the side and 2" from the front of the fixture.

Applications

Under-cabinets, Task Lighting

Technical Information



Length	8-3/4"		12-1/4"		18-1/4"		24-1/4"		32-3/4"		40-1/4"	
Finish	DB	WH	DB	WH	DB	WH	DB	WH	DB	WH	DB	WH
Voltage	120V AC, 60Hz											
CCT	3000K											
CRI	93+											
Wattage	3W		4W		6W		8W		11W		14W	
Lumens (up to)	175	180	250	270	375	415	475	515	650	770	800	955
Max Run	400 watts											
Beam Angle	120°											
Dimming	5-100% with most standard 2-wire and CL dimmers											
Rating	Energy Star, cETLus Listed, dry locations											
Rated Life	35,000 Hours											

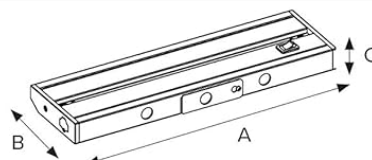

Part Number	A	B	C
ALC2-8	8-3/4"	3-5/8"	15/16"
ALC2-12	12-1/4"	3-5/8"	15/16"
ALC2-18	18-1/4"	3-5/8"	15/16"
ALC2-24	24-1/4"	3-5/8"	15/16"
ALC2-32	32-3/4"	3-5/8"	15/16"
ALC2-40	40-1/4"	3-5/8"	15/16"

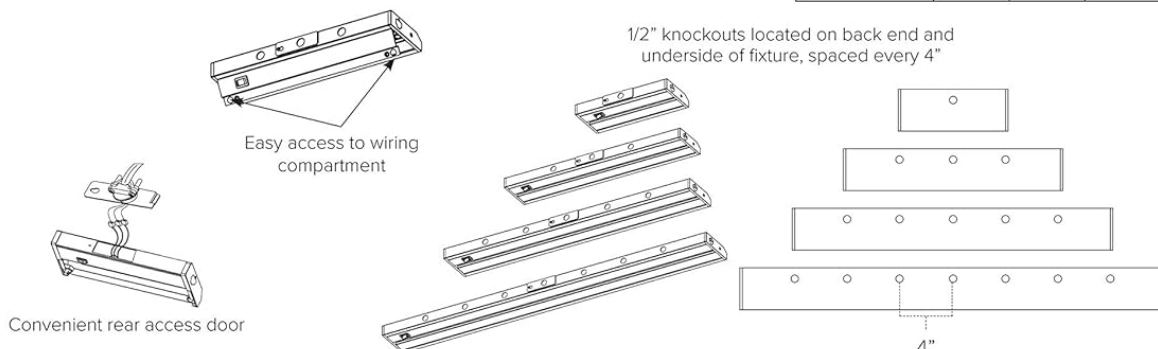

It shows how to connect the electrical wires securely.

Interconnecting Fixtures

Multiple fixtures can be linked together for continuous lighting.

Interconnecting via Linking/Jumper Cable

1. To interconnect nearby fixtures, remove the adjacent port covers and utilize the ALC-EX linking cable (sold separately).
2. If needed, linking cables can be interconnected to make longer lengths.

120V | LED COMPLETE 2 Undercabinet Light



AMERICAN LIGHTING
BRIGHT IDEAS • INNOVATIVE SOLUTIONS

INSTALLATION INSTRUCTIONS

ALC2 Series



MOUNTING FIXTURE:

1. Determine locations for each fixture. For hardwire installations, connect supply wires via knockouts before mounting.
2. Use a Philips head screwdriver or driver bit to tighten captive mounting screws and secure fixture to an appropriate mounting surface.

CONNECTING POWER VIA ALC-PC6 POWER CORD:

ALC-PC6 (optional 120V power cord, sold separately) has a polarized plug (one blade is wider than the other) as a feature to reduce the risk of electric shock. This plug will fit in a polarized outlet only one way. If the plug does not fit fully in the outlet, reverse the plug. If it still does not fit, contact a qualified electrician. Never use with an extension cord unless the plug can be fully inserted. Do not alter plug.

1. Position fixture in desired location and use a Philips head screwdriver or driver bit to tighten captive mounting screws in order to secure the fixture to an appropriate mounting surface.
2. Remove the side port cover and insert the power cord into side port labeled "input" until fully seated.

INTERCONNECTING FIXTURES (SEE FIGURE 5):

Interconnecting via linking/jumper cable: To interconnect nearby fixtures, remove the adjacent port covers and utilize the ALC-EX linking cable (sold separately) as shown in Figure 5. If needed, linking cables can be interconnected to make longer lengths.

Interconnecting via end-to-end linking connector: To interconnect fixtures directly to each other (end-to-end), utilize the in-line connector (included with each fixture) by removing adjacent port covers and inserting fully.

CONNECTING POWER VIA SUPPLY WIRES THROUGH HOUSING KNOCKOUTS (See Figures 6-7):

This type of installation is less common and typically only done when the rear access door cannot be utilized.

1. Open wiring compartment by removing screws at each end and lifting cover from housing body. See Figure 6.
2. Punch out whichever knockout is best suited for connection to 120V supply wires. Knockouts are located along back and top of housing. See Figure 7.
3. Install cable connector and connect fixture wires following National Electric Code and/or local building code requirements. Use minimum 18AWG solid copper wires. AC supply should be 120V protected by circuit breaker or fuse.
4. Attach line voltage AC supply wires to fixture lead wires: Black to Black/Hot, White to White/Neutral and Yellow/Green (Ground) to Green or bare wire inside the fixture. Secure each connection using push-in wire connectors provided on the fixture lead wire. If your system has no ground wire, consult a qualified electrician before proceeding with the installation. Note: Electric shock, overheating, low or no light output, and shortened fixture life can result if proper grounding is not done.
5. Replace the wiring compartment cover, securing with the existing retaining screws. Note: Be sure that the wires are not pinched or damaged by any part of the housing or the cover.
6. Follow directions above for mounting fixture.

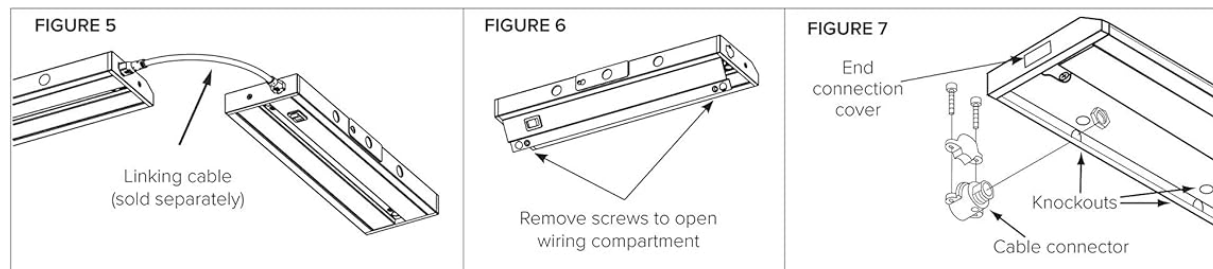

5- YEAR LIMITED PRODUCT WARRANTY

This product is warranted to be free from defects in material and workmanship for a period of five years from the date of purchase. Products that prove to be defective during this period will be either repaired (i.e. replacement of defective electronics, defective parts of the fixture housing, lens, wiring, switching or lamp sockets; excluding the lamp) or replaced, at the discretion of American Lighting, Inc. Claims for defective products must be submitted to the retail location from which the product was purchased within the warranty period. Upon submission of proper return claim documentation and product to American Lighting, Inc. by the retailer, American Lighting, Inc. reserves the right to inspect the product for misuse or abuse. Claims for indirect or consequential damages or for product that, in American Lighting Inc's opinion has been misused will be denied. This is a warranty of product reliability only and not a warranty of merchantability or fitness for a particular purpose. American Lighting, Inc. shall have no liability whatsoever in any event for payment of incidental or consequential damages, including, without limitations, installation costs and damages for personal injury and property. These products may represent a possible shock or fire hazard if improperly installed or altered in any way. This warranty applies only to product that has been properly installed in accordance with instruction sheet and current local codes and/or the National Electrical Code. Warranty does not apply to any product that has been improperly installed or in situations where components have been altered in any way.

For questions, comments, technical assistance and/or repair parts, please call toll free at: 1-800-285-8051 (M-F 8am - 5pm, MST)

LIGHT DISTRIBUTION:

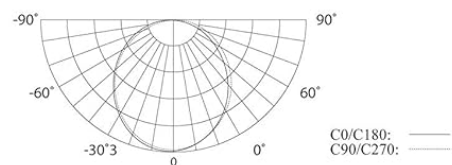

Model #	Amperage	Wattage
ALC2-8	0.025	3
ALC2-12	0.033	4
ALC2-18	0.05	6
ALC2-24	0.067	8
ALC2-32	0.091	11
ALC2-40	0.117	14

Image: Diagram showing how to link multiple LED Complete 2 fixtures using an inline connector or jumper cable. It illustrates the connection points on the side of the fixtures.

Interconnecting via End-to-End Linking

To interconnect fixtures directly to each other (end-to-end), utilize the in-line connector (included with each fixture) by removing adjacent port covers and inserting fully.

Direct Wire Junction Box Installation (for ALC-BOX-##)

This type of installation is less common and typically only done when the rear access door cannot be utilized.

1. Open wiring compartment by removing screws and open the end of the fixture cover from housing body.
2. Punch out whichever knockout is best suited for connection to 120V supply wire.
3. Install cable connector and connect fixture wires following National Electric Code and/or local building code requirements. Minimum 18AWG solid copper wire. AC lead should be 120V protected by circuit breaker or fuse.
4. Attach line voltage supply wires to fixture lead wires with wire nuts/WAGO. White to White/Neutral and Yellow/Green (Ground) to Green or bare wire inside the fixture. Secure each connection using push-in wire connectors provided on the fixture lead wire. If your system has no ground wire, consult a qualified electrician before proceeding with the installation.
5. Do not install in wet environment.
6. Replace the wiring compartment cover, securing with the existing retaining screws. Note: Be sure that the wires are not pinched or damaged by any part of the housing or the cover.
7. Follow directions above for mounting fixture.

120V DIRECT WIRE JUNCTION BOX FOR LED COMPLETE

INSTALLATION INSTRUCTIONS FOR ALC-BOX-##
120V AC, 60Hz Operation

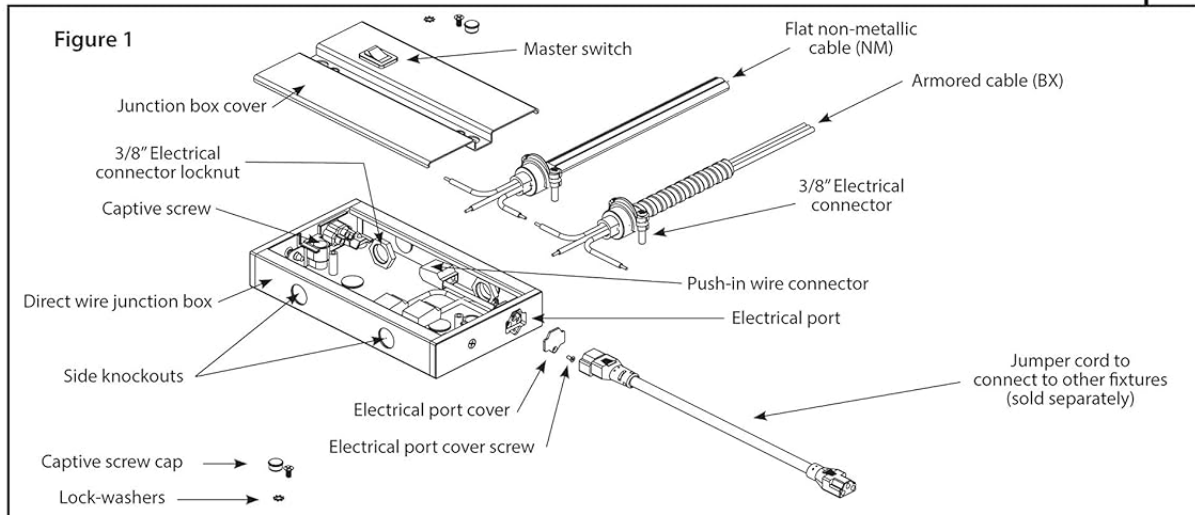

DIRECT WIRE JUNCTION BOX INSTALLATION (See Figure 1, above)

1. Turn off power for appropriate electrical circuit at electrical service panel.
2. Remove junction box cover screws and remove cover. Save screws and lock-washers.
3. Prepare flat, non-metallic cable (NM)(2C+Ground) or armored cable (BX) by stripping conductor ends approximately 3/8".
4. For installation using 3/8" electrical connector to junction box (as shown), determine mounting orientation and remove one side knockout on desired side of junction box. Attach 3/8" electrical connector to junction box then affix 3/8" electrical connector to electrical supply (BX or NM). NM cable outer jacket must protrude through 3/8" electrical connector to adequately protect internal conductors.
5. Tighten locknut and clamping screw(s) on electrical connector, fitting securely.
6. Put stripped ends of wires into the push-in wire connectors (see Figure 1). Supply wires are typically color coded: Hot-black, Neutral-white, Ground-green or bare copper (see Wiring Diagram on previous page). Note that black supply wire goes into the connector with black wire, white with white, and green with green.
7. Push excess electrical supply wire back into wall and locate the junction box on mounting surface. Affix the junction box to the underside of the cabinet with captive screws provided. Be careful not to drive screws all the way through the cabinet bottom; Use shorter screws if necessary.
8. Replace and secure junction box cover with supplied screws. Make sure lock-washers are located beneath screw heads to properly ground cover.
9. Follow installation instructions provided with undercabinet light fixture. Mount fixture, and insert jumper wire (sold separately) or direct end-to-end connector (supplied with fixture) into appropriate electrical port of direct wire junction box.
10. Make sure that all fixtures connected to junction box are properly installed and that all open electrical ports on the module and fixtures are safely covered with electrical port covers.
11. Restore circuit power at electrical service panel. Turn on master switch on junction box and turn on switches for each individual fixture. Master switch can be used to control all fixtures simultaneously or fixtures can be operated individually.

REMOTE CONNECTING JUNCTION BOX TO FIXTURE USING JUMPER CORD (SOLD SEPARATELY)

Do not attempt to modify the junction box or fixture in any way to make power connection. Jumper cords can connect to either or both electrical ports, depending upon layout needs. Jumper cords may be interconnected to create longer lengths. Do not connect more than five jumper cords between fixtures. Use only jumper cords listed below to make connections between junction box and fixture or between fixtures. Failure to follow these instructions will void warranty.

ALC-EX6-BK	6" jumper cord for ALC fixtures; Black
ALC-EX6-WH	6" jumper cord for ALC fixtures; White
ALC-EX12-BK	12" jumper cord for ALC fixtures; Black
ALC-EX12-WH	12" jumper cord for AL fixtures; White

RV1536
www.americanlighting.com

PAGE 2 OF 2

AMERICAN LIGHTING
BRIGHT IDEAS • INNOVATIVE PRODUCTS

Image: Diagram detailing the direct wire junction box installation for the LED Complete 2 fixture. It shows the components like the junction box, electrical port, and push-in connectors, along with wiring instructions.

OPERATING INSTRUCTIONS

Powering On/Off

The fixture is equipped with a switch for basic on/off control. For hardwired installations, the fixture will operate via the wall switch connected to the circuit.

Dimming

The American Lighting LED Complete 2 fixture is dimmable. Use a compatible 120V dimmer switch (UL

approved) for optimal performance. Refer to the "Compatible Dimmers" section for recommended models.

120V | LED COMPLETE 2 Undercabinet



Ordering Information

ALC2

PRODUCT	LENGTH	FINISH
ALC2	8 = 8-3/4" 12 = 12-1/4" 18 = 18-1/4" 24 = 24-1/4" 32 = 32-3/4" 40 = 40-1/4"	DB = Dark Bronze WH = White

ALC2 fixtures include:
(1) 3/8" Clamp connector
(1) Inline/direct connector
(2) Captive mounting screws
(2) Mounting hole covers

Example Part # **ALC2-32-DB**

ALC2	32	DB
-------------	-----------	-----------

Recommended Power Supplies

Part Number	Description	Finish	Application	Primary & Secondary	Total Wattage	Listing	Dimensions
ALC-BOX-DB	Hardwire box with male/female Molex connections, end power connection ports, (6) 3/8" knockouts, and On/Off rocker switch	Dark Bronze	Dry location	120V AC	150 x 2	cETLus	7-3/8"L x 2-1/8"W x 1"H
ALC-BOX-WH		White					
ALC-PC6-BK	6ft power cord with 3-prong grounded plug and Molex connector	Black	Dry location	120V AC	150	cETLus	6ft length
ALC-PC6-WH		White					

Accessories

Image	Part Number	Length	Finish	Description
	ALC-EX6-BK	6"	Black	Linking cable; 18AWG wire with male/female molex connectors; cETLus Listed
	ALC-EX12-BK	12"		
	ALC-EX6-WH	6"	White	Linking cable; 18AWG wire with male/female molex connectors; cETLus Listed
	ALC-EX12-WH	12"		
	ALC-CON-BK	N/A	Black	Replacement in-line connector for end-to-end connections; cETLus Listed
	ALC-CON-WH		White	

Compatible Dimmers

Brand	Model #	Type	Dimming Range	Notes
Lutron® Diva	DVCL-153P	Universal (CFL/LED/Incandescent)	5-100%	
Lutron® Diva	DVELV-300P	Electronic Low Voltage (ELV)	5-100%	
Leviton® Sureslide	6613	Magnetic Low Voltage (MLV)	5-100%	

Dimmer performance may vary in field application due to unknown external factors. Dimmers not included on the chart above are not necessarily incompatible; they have yet to be fully evaluated. Please reference dimmer manufacturer's instructions for more detailed information regarding performance and compatibility.

Photometrics

LED Complete 2

Model #	Amperage	Wattage
ALC2-8-xx	0.03	3W
ALC2-12-xx	0.03	4W
ALC2-18-xx	0.05	6W
ALC2-24-xx	0.07	8W
ALC2-32-xx	0.09	11W
ALC2-40-xx	0.12	14W

Image: A page from the product information showing recommended power supplies, accessories, and a table of compatible dimmers from various brands, including model numbers and dimming ranges.

MAINTENANCE

Cleaning

To clean the fixture, ensure power is disconnected. Use a soft, dry, or slightly damp cloth. Do not use harsh chemicals, abrasive cleaners, or solvents, as these can damage the finish or electrical components.

LED Module

The LED module within this fixture is not user-serviceable. Do not attempt to open or repair the LED module.

TROUBLESHOOTING

If your American Lighting LED Complete 2 fixture is not functioning as expected, please review the following common issues and solutions:

- **Fixture does not light up:**
 - Check if the power supply is connected and the circuit breaker is on.
 - Ensure all wiring connections are secure and correct, especially for hardwired installations.
 - Verify that the fixture's on/off switch (if present) is in the "on" position.
 - Confirm that the voltage supplied is 120V AC.
- **Light output is inconsistent or flickering:**
 - Ensure a compatible dimmer switch is being used. Incompatible dimmers can cause flickering or poor dimming performance.
 - Check for loose wiring connections.
- **Fixture is damaged:**
 - If the lens or wiring compartment cover is missing or damaged, discontinue use and contact customer support.
 - Do not operate if the jumper cable is damaged.

If these steps do not resolve the issue, please contact American Lighting customer support.

SPECIFICATIONS

Technical Information for ALC2-12-WH

Feature	Detail
Model Number	ALC2-12-WH
Input Voltage	120V AC, 60Hz
Wattage	4 watts
Brightness	273 Lumens
Color Temperature (CCT)	3000K (Warm White)
Color Rendering Index (CRI)	90+
Dimmable	Yes (with compatible 120V dimmers)
Rated Life	35,000 hours
Dimensions (L x W x H)	12.25 x 4 x 0.94 inches
Material	Powder Coated Aluminum Housing, Acrylic Lens
Mounting Type	Surface Mounted, Under Cabinet
Indoor/Outdoor Usage	Indoor Use Only

Feature	Detail
Certifications	cETLus Listed (dry location), ENERGY STAR certified

106

TASK LIGHTING / UNDERCABINET / LED COMPLETE 2

TRULUX LIGHTING SYSTEMS

LED COMPLETE 2
UNDERCABINET

DOWNLIGHTING

LINEAR LIGHTING

ARCHITECTURAL LIGHTING

POWER SUPPLIES

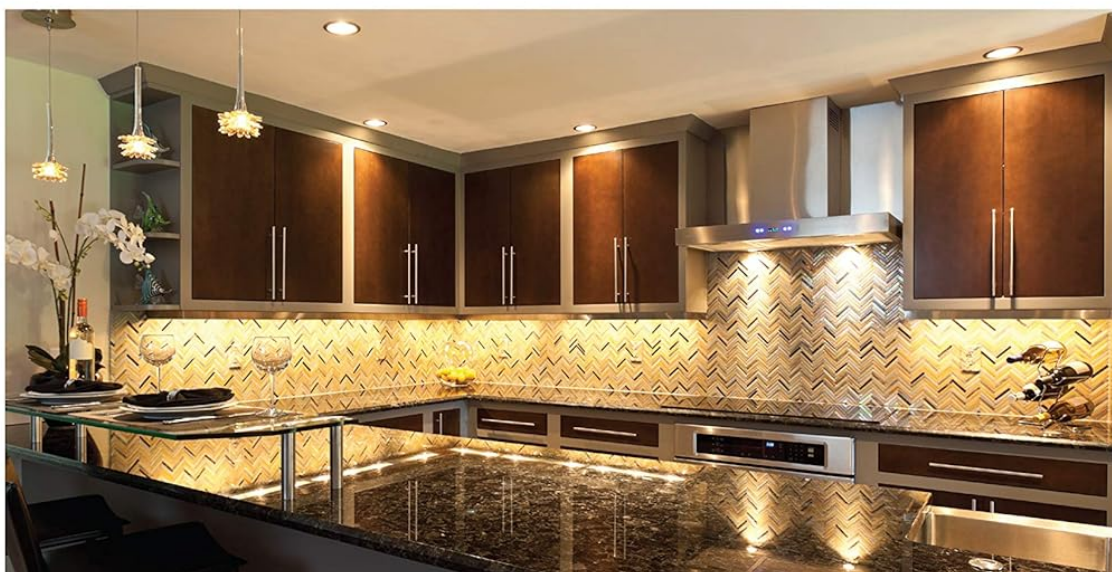

Features

- 3000K color temperature and 93+ CRI
- Diffused lens eliminates dotting
- Efficacies up to 70 lumens per watt
- Linkable up to 400W
- Low profile design - less than 1" high
- Plug-in or direct wire capable
- Dimmable with most CL and ELV dimmers
- cETLus Listed for indoor dry locations
- 35,000 hours rated life
- ENERGY STAR certified

Available Sizes

8" / 12" / 18" / 24" / 32" / 40"

Available Finishes



White

Dark Bronze

Dimming Options

- CL (5-100%)
- ELV (5-100%)

Listing / Ratings



LED Complete 2 - 120V

Choose from six energy efficient fixture lengths in two finishes. Easy installation with captive mounting screws, quick access door to wiring compartment, and handy accessories such as hardwire box and linking cables. Multiple fixtures can also be linked directly with an inline connector (included). Long life, high CRI and convenient dimming are additional benefits.

Technical Information

Series	ALC2
Input Voltage	120V AC, 60Hz
CCT	3000K
CRI	93+
Wattage	Up to 14W (see individual product)
Lumens	Up to 955Lm (see individual product)
Beam Angle	120°
Max Run	400W
Dimmable	5-100%
Mounting	Surface mount
Rating	cETLus Listed (dry location)
Rated Life	35,000 hrs

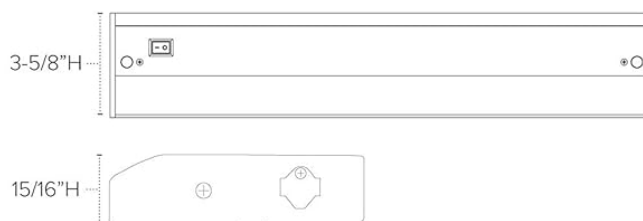

A AMERICAN LIGHTING

www.AmericanLighting.com

Image: A page from the product brochure detailing technical specifications for the LED Complete 2 series, including input voltage, CCT, CRI, wattage, lumens, and rated life.

WARRANTY

This American Lighting product is warranted to be free from defects in material and workmanship for a

period of five years from the date of purchase. Products that prove to be defective during this period will be either repaired (i.e. replacement of defective electronic parts) or, at the discretion of American Lighting, Inc., exchanged for a new or reconditioned product.

This warranty does not cover damage due to improper installation, accident, abuse, misuse, or normal wear and tear. It also does not cover incidental or consequential damages.

For complete warranty terms and conditions, please refer to the official American Lighting website or contact customer support.

CUSTOMER SUPPORT

For technical assistance, warranty claims, or additional information, please contact American Lighting:

- **Website:** www.americanlighting.com
- **Address:** 11775 E. 45th Ave. Denver, CO 80239
- **Phone:** 1-800-880-1180
- **Fax:** 303-695-7633

© 2024 American Lighting. All rights reserved.

Related Documents - ALC2-12-WH

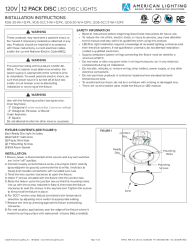
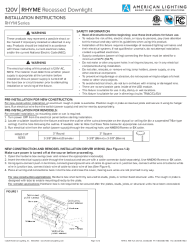
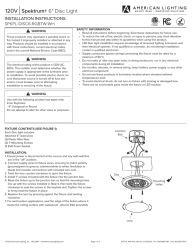
	<p>American Lighting 120V 12 Pack LED Disc Lights Installation Instructions</p> <p>Detailed installation instructions for American Lighting's 120V 12 Pack LED Disc Lights (models RD6-30-WH-12PK, RD6-5CCT-WH-12PK, QD6-30-WH-12PK, QD6-5CCT-WH-12PK). Includes safety information, fixture contents, installation steps, and maintenance.</p>
	<p>American Lighting RHYM Series 120V Recessed Downlight Installation Guide</p> <p>Comprehensive installation instructions for the American Lighting RHYM Series 120V recessed downlight, covering safety, new construction and remodel installation, wiring, optic lens replacement, care, maintenance, FCC compliance, and warranty.</p>
	<p>American Lighting Spektrum+ 6" Disc Light Installation Guide (SPKPL-DISC6-RGBTW-WH)</p> <p>Detailed installation instructions and safety information for the American Lighting Spektrum+ 6" RGB+TW Disc Light (Model SPKPL-DISC6-RGBTW-WH). Learn how to safely install and control this smart LED fixture.</p>

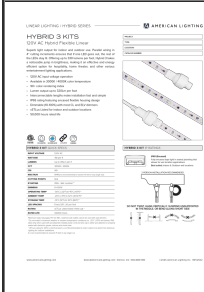

[American Lighting Hybrid 3 Kits: 120V AC Flexible Linear LED Lighting](#)

Explore American Lighting's Hybrid 3 Kits, offering 120V AC flexible linear LED lighting with superb output, IP65 rating, and 50,000-hour lifespan. Ideal for indoor and outdoor applications. View specifications, ordering information, and warranty details.

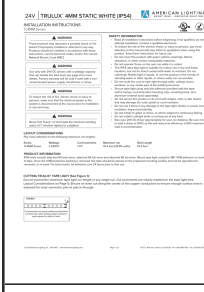

[24V Trulux 4mm Static White IP54 LED Tape Light Installation Guide](#)

Installation instructions and safety information for the American Lighting 24V Trulux 4mm Static White IP54 LED tape light (TL4MM Series). Includes product details, layout considerations, cutting guide, and warranty information.

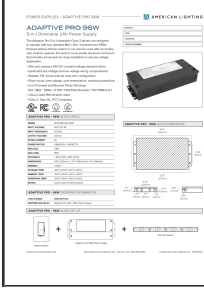

[Adaptive Pro 96W 5-in-1 Dimmable 24V Power Supply | American Lighting](#)

Technical specifications, dimensions, wiring diagrams, and warranty for the American Lighting Adaptive Pro 96W 5-in-1 dimmable 24V DC constant voltage power supply. Suitable for MLV, ELV, TRIAC, 0-10V dimming.