

BMW 11-42-7-577-010

BMW 11-42-7-577-010 Return Pipe User Manual

Genuine OEM Part for Optimal Vehicle Performance

1. PRODUCT OVERVIEW

This manual provides essential information for the proper installation, maintenance, and understanding of the BMW 11-42-7-577-010 Return Pipe. This component is a genuine Original Equipment Manufacturer (OEM) part, designed to ensure precise fitment and optimal performance within your BMW vehicle's exhaust and emissions system.

The return pipe plays a critical role in the vehicle's fluid or exhaust management system, ensuring proper flow and preventing leaks. Using genuine OEM parts guarantees compatibility and maintains the integrity of your vehicle's original design and engineering.

- **Part Number:** 11-42-7-577-010
- **Installation Type:** Bolt-On
- **Material:** Other (as per manufacturer specification)
- **Weight:** Approximately 4 pounds

2. SAFETY INFORMATION

Always prioritize safety when working on any vehicle. Failure to follow safety precautions can result in injury or damage to the vehicle.

- Ensure the vehicle is parked on a level surface and properly secured with wheel chocks.
- Disconnect the vehicle's battery before beginning any work to prevent electrical hazards.
- Allow the engine and exhaust system to cool completely before handling any components to avoid burns.
- Wear appropriate personal protective equipment (PPE), including safety glasses, gloves, and protective clothing.
- Use proper lifting equipment (e.g., jack stands) if the vehicle needs to be raised. Never rely solely on a jack.
- Refer to your vehicle's specific service manual for detailed safety procedures and torque specifications.
- Keep children and pets away from the work area.

3. COMPONENTS AND DIAGRAM

The BMW 11-42-7-577-010 Return Pipe is typically part of a larger assembly. The following diagram illustrates its position within a typical system. The part itself is highlighted as item #3.

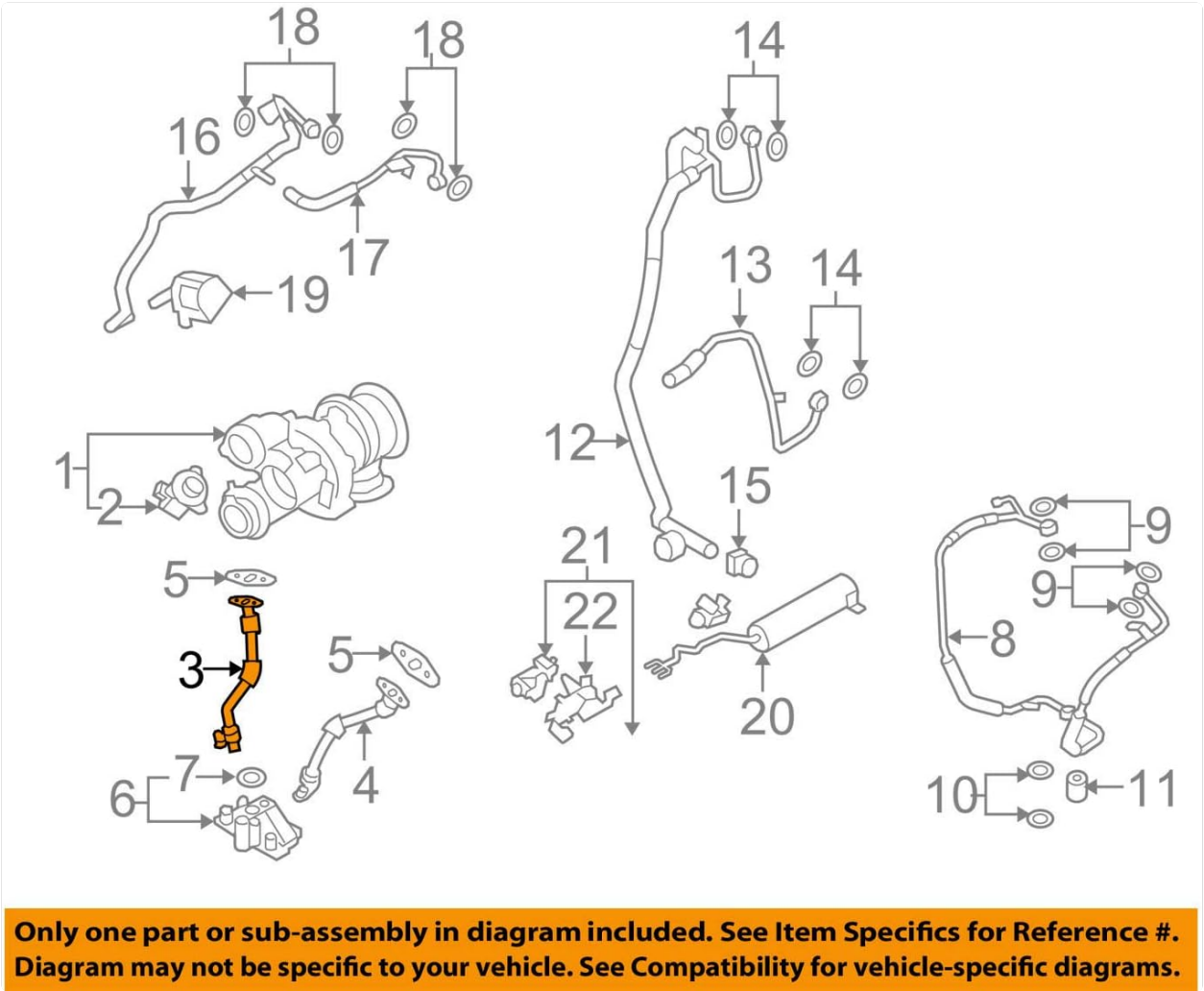
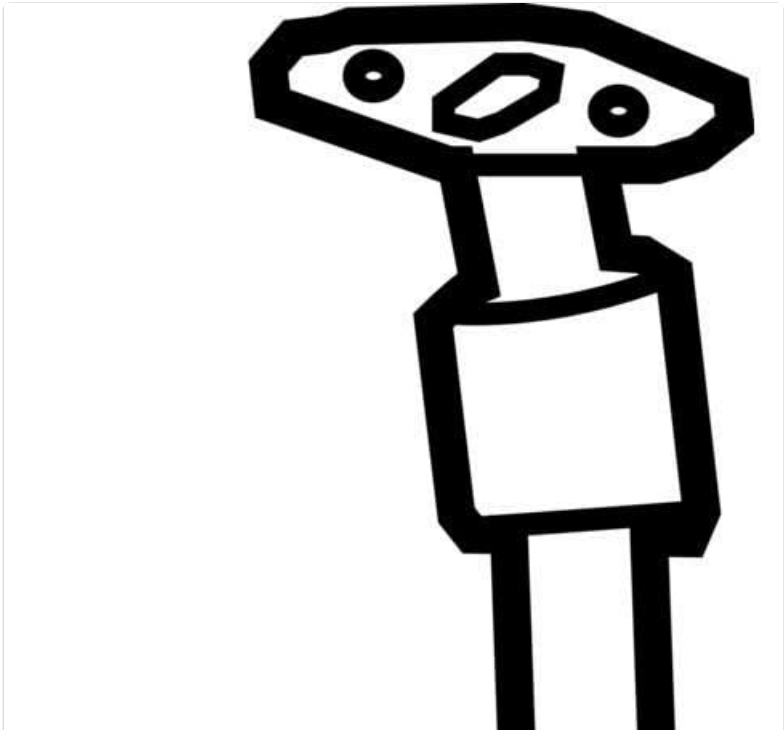

Figure 3.1: Exploded view diagram of the automotive system, with the return pipe identified as item #3. This diagram helps in understanding the pipe's location relative to other components.



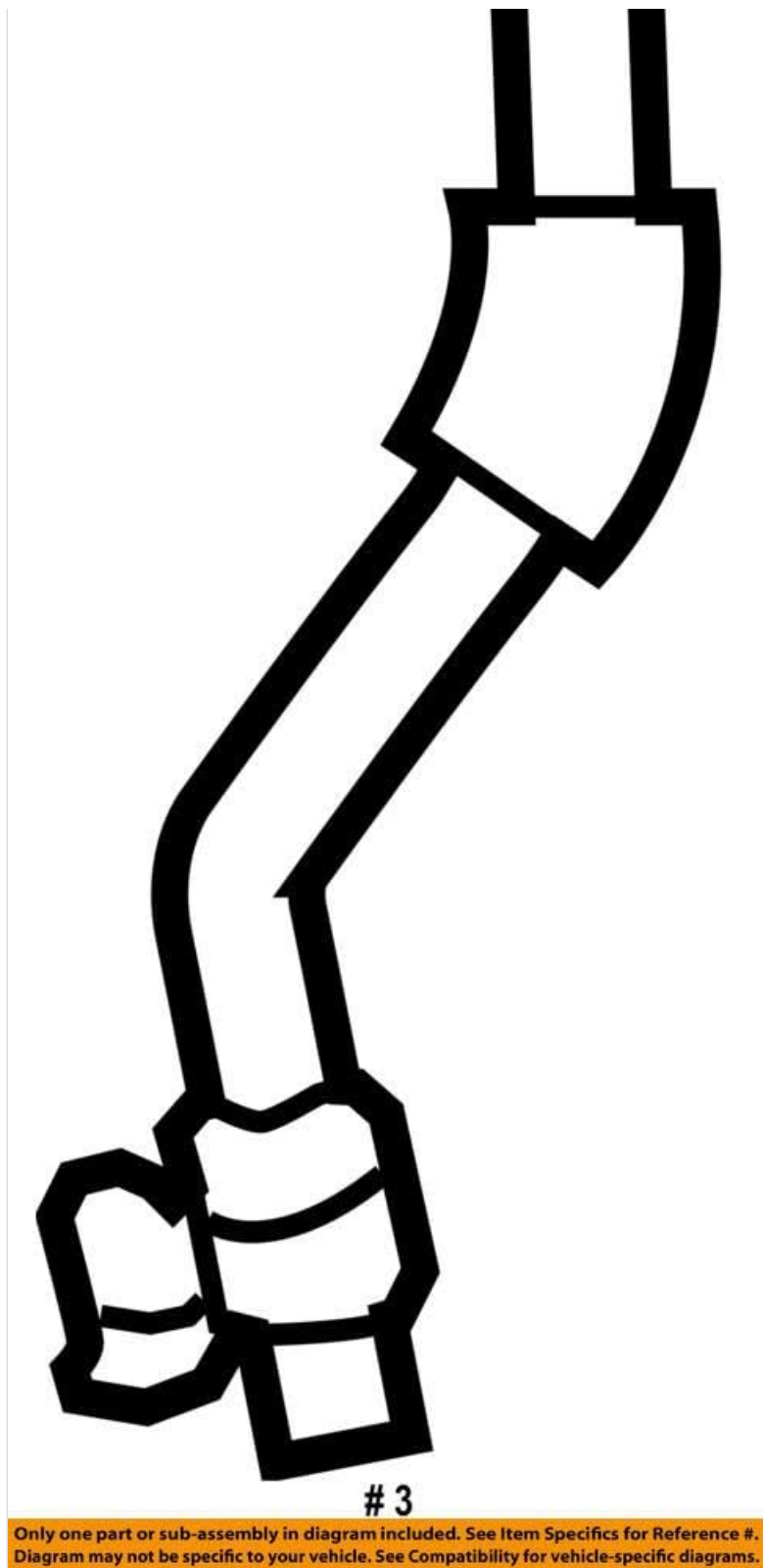

Figure 3.2: Detailed line drawing of the BMW 11-42-7-577-010 Return Pipe (item #3), illustrating its specific design and bolt-on connection points.

Before installation, ensure all necessary tools and replacement gaskets or seals (if applicable) are available. Inspect the new return pipe for any signs of damage during shipping.

4. INSTALLATION INSTRUCTIONS (SETUP)

The BMW 11-42-7-577-010 Return Pipe is designed for bolt-on installation. While specific steps may vary slightly depending on the vehicle model and engine configuration, the general procedure is as follows:

1. **Preparation:** Ensure the vehicle is cool, safely lifted (if necessary), and the battery is disconnected.

Locate the existing return pipe assembly.

2. **Removal of Old Pipe:** Carefully loosen and remove the bolts or clamps securing the old return pipe. Be prepared for any fluid drainage if this is a fluid return pipe. Dispose of old components responsibly.
3. **Clean Mating Surfaces:** Thoroughly clean the mating surfaces on the engine or exhaust manifold where the new pipe will connect. Remove any old gasket material or corrosion to ensure a proper seal.
4. **Install New Gaskets/Seals:** If new gaskets or seals are required, place them onto the mating surfaces or the new pipe as per manufacturer recommendations.
5. **Position New Pipe:** Carefully position the new BMW 11-42-7-577-010 Return Pipe into place, aligning it with the bolt holes or connection points.
6. **Secure Pipe:** Install the bolts or clamps, tightening them finger-tight initially. Then, tighten them to the vehicle manufacturer's specified torque settings, typically in a crisscross pattern if multiple bolts are present, to ensure even pressure.
7. **Reconnect Battery:** Once the pipe is securely installed, reconnect the vehicle's battery.

Note: Always consult your specific vehicle's service manual for precise torque specifications and any model-specific installation nuances.

5. POST-INSTALLATION CHECKS (OPERATION)

After installation, perform the following checks to ensure proper operation and prevent issues:

- **Visual Inspection:** Double-check all connections to ensure they are tight and secure. Look for any signs of leaks (fluid or exhaust gas) around the newly installed pipe.
- **Start Engine:** Start the vehicle's engine and allow it to reach operating temperature.
- **Leak Detection:** For exhaust pipes, listen for any unusual hissing or blowing sounds indicating an exhaust leak. For fluid return pipes, visually inspect for any drips or wet spots. A common method for exhaust leaks is to use soapy water sprayed on connections; bubbles indicate a leak.
- **Test Drive:** If safe to do so, take the vehicle for a short test drive to confirm normal operation and listen for any abnormal noises or performance issues.

6. MAINTENANCE

As an exhaust or fluid return component, the BMW 11-42-7-577-010 Return Pipe typically requires minimal maintenance beyond periodic inspection. However, regular checks can extend its lifespan and prevent future issues:

- **Periodic Visual Inspection:** During routine vehicle maintenance (e.g., oil changes), visually inspect the return pipe for signs of corrosion, cracks, dents, or loose connections.
- **Check for Leaks:** Regularly check for any signs of fluid leaks or exhaust gas leaks around the pipe and its connections.
- **Address Issues Promptly:** If any damage or leaks are detected, address them immediately to prevent further damage to the vehicle or potential safety hazards.

7. TROUBLESHOOTING

If you experience issues after installing the BMW 11-42-7-577-010 Return Pipe, consider the following common troubleshooting steps:

Symptom	Possible Cause	Solution
Exhaust/Fluid Leak	Loose connections, damaged gasket/seal, improperly seated pipe.	Tighten bolts to spec, replace gasket/seal, re-seat pipe.
Unusual Noises (e.g., rattling)	Pipe contacting other components, loose mounting hardware.	Inspect for contact points, ensure all mounting hardware is secure.
Check Engine Light (if related to exhaust/emissions)	Significant exhaust leak affecting sensor readings, incorrect installation.	Verify no leaks, ensure all sensors are properly connected. Consult a professional if light persists.

If troubleshooting steps do not resolve the issue, it is recommended to consult a certified BMW technician or a qualified automotive mechanic.

8. SPECIFICATIONS

Key specifications for the BMW 11-42-7-577-010 Return Pipe:

- **Part Number:** 11-42-7-577-010
- **Manufacturer:** BMW
- **Installation Type:** Bolt-On
- **Item Weight:** Approximately 4 pounds
- **Package Dimensions:** Approximately 1.01 x 1.01 x 1.01 inches (Note: These dimensions seem to be for packaging, not the pipe itself, which would be longer. Refer to actual part for precise dimensions.)
- **Material:** Other (OEM specified)
- **Vehicle Service Type:** Car
- **Shape:** Round (referring to pipe cross-section)

9. VEHICLE COMPATIBILITY

The BMW 11-42-7-577-010 Return Pipe is designed for specific BMW models and years. Always verify compatibility with your vehicle's VIN (Vehicle Identification Number) or by consulting a BMW parts catalog or dealership.

Below is an example of a compatibility list. *Note: This list is illustrative and may not be exhaustive or current. Always cross-reference with official BMW documentation.*

Compatible List

1. YEAR: 2018 MAKE: BMW MODEL: 650i Gran Coupe TRIM: Base Hatchback 4-Door ENGINE: 4.4L 4395CC V8 GAS DOHC Turbocharged
2. YEAR: 2018 MAKE: BMW MODEL: 650i Gran Coupe TRIM: Base Sedan 4-Door ENGINE: 4.4L 4395CC V8 GAS DOHC Turbocharged REFNUM: 4
3. YEAR: 2018 MAKE: BMW MODEL: 650i xDrive Gran Coupe TRIM: Base Sedan 4-Door ENGINE: 4.4L 4395CC V8 GAS DOHC Turbocharged REFNUM: 4
4. YEAR: 2018 MAKE: BMW MODEL: X6 TRIM: xDrive50i Sport Utility 4-Door ENGINE: 4.4L 4395CC V8 GAS DOHC Turbocharged REFNUM: 3
5. YEAR: 2017 MAKE: BMW MODEL: 550i GT xDrive TRIM: Base Hatchback 4-Door ENGINE: 4.4L 4395CC V8 GAS DOHC Turbocharged REFNUM: 6
6. YEAR: 2017 MAKE: BMW MODEL: 650i TRIM: Base Convertible 2-Door ENGINE: 4.4L 4395CC V8 GAS DOHC Turbocharged REFNUM: 4
7. YEAR: 2017 MAKE: BMW MODEL: 650i TRIM: Base Coupe 2-Door ENGINE: 4.4L 4395CC V8 GAS DOHC Turbocharged REFNUM: 4
8. YEAR: 2017 MAKE: BMW MODEL: 650i TRIM: Gran Coupe Sedan 4-Door ENGINE: 4.4L 4395CC V8 GAS DOHC Turbocharged
9. YEAR: 2017 MAKE: BMW MODEL: 650i TRIM: M Sport Coupe 2-Door ENGINE: 4.4L 4395CC V8 GAS DOHC Turbocharged
10. YEAR: 2017 MAKE: BMW MODEL: 650i Gran Coupe TRIM: Base Sedan 4-Door ENGINE: 4.4L 4395CC V8 GAS DOHC Turbocharged REFNUM: 4
11. YEAR: 2017 MAKE: BMW MODEL: 650i xDrive TRIM: Base Convertible 2-Door ENGINE: 4.4L 4395CC V8 GAS DOHC Turbocharged REFNUM: 4
12. YEAR: 2017 MAKE: BMW MODEL: 650i xDrive TRIM: Base Coupe 2-Door ENGINE: 4.4L 4395CC V8 GAS DOHC Turbocharged REFNUM: 4
13. YEAR: 2017 MAKE: BMW MODEL: 650i xDrive Gran Coupe TRIM: Base Sedan 4-Door ENGINE: 4.4L 4395CC V8 GAS DOHC Turbocharged REFNUM: 4
14. YEAR: 2017 MAKE: BMW MODEL: X5 TRIM: xDrive50i Sport Utility 4-Door ENGINE: 4.4L 4395CC V8 GAS DOHC Turbocharged REFNUM: 3
15. YEAR: 2017 MAKE: BMW MODEL: X6 TRIM: xDrive50i Sport Utility 4-Door ENGINE: 4.4L 4395CC V8 GAS DOHC Turbocharged REFNUM: 3
16. YEAR: 2016 MAKE: BMW MODEL: 550i TRIM: Base Sedan 4-Door ENGINE: 4.4L 4395CC V8 GAS DOHC Turbocharged REFNUM: 6
17. YEAR: 2016 MAKE: BMW MODEL: 550i GT xDrive TRIM: Base Hatchback 4-Door ENGINE: 4.4L 4395CC V8 GAS DOHC Turbocharged REFNUM: 6
18. YEAR: 2016 MAKE: BMW MODEL: 550i xDrive TRIM: Base Sedan 4-Door ENGINE: 4.4L 4395CC V8 GAS DOHC Turbocharged REFNUM: 6
19. YEAR: 2016 MAKE: BMW MODEL: 650i TRIM: Base Convertible 2-Door ENGINE: 4.4L 4395CC V8 GAS DOHC Turbocharged REFNUM: 4
20. YEAR: 2016 MAKE: BMW MODEL: 650i TRIM: Base Coupe 2-Door ENGINE: 4.4L 4395CC V8 GAS DOHC Turbocharged REFNUM: 4

Figure 9.1: Example of a compatibility list for the BMW 11-42-7-577-010 Return Pipe, detailing various BMW models and years.

For precise compatibility, it is crucial to use the part number and your vehicle's specific details. Genuine OEM parts ensure the correct fit and function for your BMW.

10. WARRANTY AND SUPPORT

Genuine BMW parts typically come with a manufacturer's warranty. For specific warranty terms and conditions, please refer to the documentation provided with your purchase or contact an authorized BMW dealership.

For technical support, installation assistance, or warranty claims, please contact your authorized BMW service center or the point of purchase. Providing your vehicle's VIN and the part number (11-42-7-577-010) will help expedite support.

[Official BMW Website](#)