

## Manuals+

[Q & A](#) | [Deep Search](#) | [Upload](#)

manuals.plus /

- › [Duravit](#) /
- › [Duravit ME by Starck Sink 2336830000 Instruction Manual](#)

## Duravit 2336830000

# Duravit ME by Starck Sink Instruction Manual

Model: 2336830000

## INTRODUCTION

This manual provides essential instructions for the installation, operation, and maintenance of your Duravit ME by Starck Sink, model 2336830000. Please read this manual thoroughly before beginning installation or use to ensure proper function and longevity of your product. Retain this manual for future reference.

**Important Safety Information:** Installation should be performed by a qualified professional. Always turn off the water supply before beginning any plumbing work. Wear appropriate personal protective equipment. Follow all local plumbing and building codes.

## PRODUCT OVERVIEW

The Duravit ME by Starck Sink is a ceramic vanity sink designed for drop-in installation. It features a single rectangular basin with a faucet hole and an overflow. Its minimalist design integrates seamlessly into various bathroom aesthetics.



Image: Top-down view of the Duravit ME by Starck Sink, showcasing its rectangular basin, single faucet hole, and overflow. A chrome faucet is installed.



Image: The Duravit ME by Starck Sink integrated into a modern bathroom vanity, demonstrating its aesthetic appeal within a complete setup.

## SETUP AND INSTALLATION

---

This sink is designed for drop-in installation. Professional installation is highly recommended to ensure proper fit, sealing, and plumbing connections.

### Required Tools and Materials (Not Included):

- Plumber's putty or silicone sealant
- Adjustable wrench
- Screwdriver set
- Measuring tape
- Safety glasses and gloves
- Faucet and drain assembly (compatible with standard fittings)

### Installation Steps:

1. **Unpack and Inspect:** Carefully remove the sink from its packaging. Inspect for any damage or manufacturing defects. Do not install if damaged.
2. **Prepare Vanity:** Ensure the vanity countertop opening is correctly sized for the drop-in sink. Refer to the technical drawing for precise dimensions.
3. **Install Faucet and Drain:** Before dropping the sink into the vanity, install the faucet and drain assembly onto the sink according to their respective manufacturer's instructions. Apply plumber's putty or silicone sealant as required for a watertight seal.
4. **Apply Sealant:** Apply a bead of silicone sealant around the perimeter of the vanity countertop

**Position Sink:** Carefully lower the sink into the countertop opening, ensuring it is centered and level. Press down firmly to create a good seal with the silicone.

**Secure Sink:** Use the provided mounting clips (if applicable) or follow the vanity manufacturer's instructions to secure the sink to the underside of the countertop.

**Connect Plumbing:** Connect the faucet supply lines to the hot and cold water shut-off valves. Connect the drain assembly to the P-trap. Ensure all connections are tight and leak-free.

**Test for Leaks:** Turn on the water supply and check all connections for leaks. Run water through the faucet and into the drain to verify proper function and drainage.

**Clean Excess Sealant:** Wipe away any excess silicone sealant immediately for a clean finish.

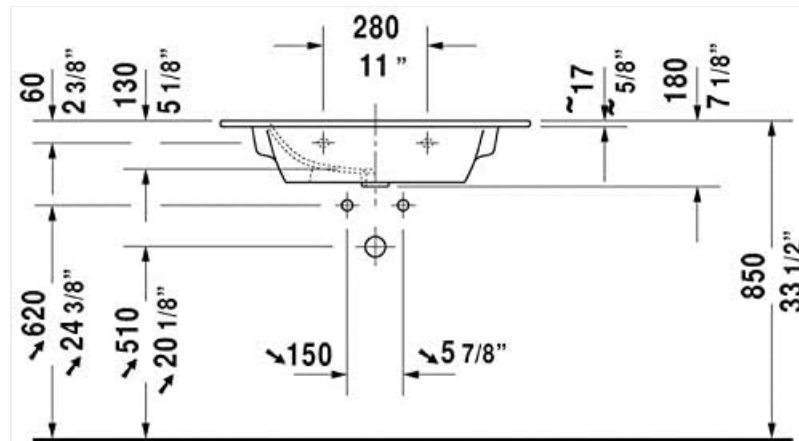

Image: Technical drawing illustrating the precise dimensions and installation requirements for the Duravit ME by Starck Sink. All measurements are critical for proper fit.

The Duravit ME by Starck Sink operates like any standard bathroom sink. Water flow is controlled by the installed faucet (not included). The integrated overflow is designed to prevent minor flooding by diverting excess water back into the drain system if the main drain is blocked. It is not a substitute for attentive use.

- Ensure the drain stopper (if installed) is open for normal drainage.
- Adjust water temperature and flow using the faucet handles.
- Do not pour harsh chemicals or excessive amounts of grease down the drain, as this can cause blockages and damage plumbing.

Proper care will maintain the appearance and functionality of your Duravit ME by Starck Sink for years. The sink is made of durable porcelain, but abrasive cleaners can damage its finish.

- **Daily Cleaning:** Wipe the sink surface with a soft, dry cloth after each use to prevent water spots and soap scum buildup.
- **Regular Cleaning:** Use a mild, non-abrasive liquid cleaner and a soft sponge or cloth. Rinse thoroughly with clean water and dry immediately.
- **Avoid:** Do not use abrasive cleaners, scouring pads, steel wool, or cleaners containing harsh chemicals such as ammonia, bleach, or strong acids, as these can scratch or damage the porcelain finish.

- **Drain Maintenance:** Periodically remove and clean the drain stopper to prevent hair and debris buildup, which can cause slow drainage.

**General Maintenance:**

- Regularly check plumbing connections under the sink for any signs of leaks. Tighten connections as needed.
- Inspect the sealant around the sink's perimeter for deterioration. Reapply sealant if necessary to maintain a watertight seal.

**TROUBLESHOOTING**

This section addresses common issues you might encounter with your sink. For problems not listed here, or if solutions do not resolve the issue, contact a qualified plumber.

Problem	Possible Cause	Solution
Slow Drainage	Hair or debris buildup in the drain or P-trap.	Remove and clean the drain stopper. If necessary, disassemble and clean the P-trap. Avoid chemical drain cleaners if possible.
Water Leaks Around Drain or Faucet Base	Loose connections or deteriorated sealant.	Check and tighten all plumbing connections. Reapply plumber's putty or silicone sealant as needed around the drain or faucet base.
Water Leaks Under Sink (from pipes)	Loose supply lines or P-trap connections.	Ensure all supply lines and P-trap connections are securely tightened. Check washers and gaskets for proper seating.
Sink Surface Stains	Hard water deposits or mineral buildup.	Use a mild, non-abrasive cleaner specifically designed for ceramic surfaces. For stubborn stains, a paste of baking soda and water can be gently applied and rinsed.

**SPECIFICATIONS**

Feature	Detail
Brand	Duravit
Model Number	2336830000
Color	White
Material	Porcelain
Product Dimensions (D x W x H)	7.13"D x 32.63"W x 7.13"H
Style	American
Installation Type	Drop In

Finish Type	White
Shape	Rectangular
Drain Type	Grid
Item Weight	23.1 Pounds
Included Components	Item included Only, Hardware (Faucet and drain assembly not included)

## WARRANTY AND SUPPORT

---

**Warranty:** This Duravit product is covered by a 5-Year Limited Warranty. This warranty covers manufacturing defects under normal use and service. Please retain your proof of purchase for warranty claims. For full warranty terms and conditions, please refer to the official Duravit website or contact customer service.

**Customer Support:** For technical assistance, replacement parts, or warranty inquiries, please contact Duravit customer service. Contact information can typically be found on the official Duravit website or on your purchase documentation.

**Website:** [www.duravit.us](http://www.duravit.us)