



[Manuals.plus](#) /

> [VIVOSUN](#) /

> VIVOSUN S336 3x3 Grow Tent (36"x36"x72") Instruction Manual

## VIVOSUN S336

# VIVOSUN S336 3x3 Grow Tent Instruction Manual

Model: S336 (36"x36"x72")

## 1. INTRODUCTION

---

This manual provides detailed instructions for the assembly, operation, and maintenance of your VIVOSUN S336 3x3 Grow Tent. Designed for indoor plant cultivation, this tent offers a controlled environment to optimize plant growth. Please read this manual thoroughly before assembly and use to ensure proper setup and safe operation.



Image 1.1: Assembled VIVOSUN S336 Grow Tent with internal components.

## 2. SAFETY INFORMATION

---

- Always ensure the grow tent is assembled on a flat, stable surface.
- Do not overload the hanging bars. Refer to the specifications for maximum weight capacity.
- Keep all electrical components (lights, fans, etc.) away from water and moisture.
- Ensure proper ventilation to prevent heat buildup and maintain air quality.
- Regularly inspect the tent for any damage or wear, especially zippers and fabric.
- Keep out of reach of children and pets.

## 3. PACKAGE CONTENTS

---

Before beginning assembly, verify that all components are present and undamaged. If any parts are missing or damaged, please contact VIVOSUN customer support.

- Grow Tent Fabric Cover (1)
- Metal Poles (various lengths, labeled A, B, C, D)
- Corner Connectors (tool-free)
- Top Hanging Bars (for equipment)
- Removable Floor Tray (1)
- Hanging Straps (2)
- Instruction Manual (1)

## 4. SETUP AND ASSEMBLY

---

Follow these steps to assemble your VIVOSUN S336 Grow Tent. Assembly typically takes minutes with the provided instructions.

### 4.1 Frame Assembly

1. Unpack all components and lay them out on a clean, flat surface.
2. Identify the different lengths of metal poles (A, B, C, D) and corner connectors.
3. Connect the base frame using the appropriate poles and corner connectors. Ensure all connections are secure.
4. Assemble the vertical poles, connecting them to the base frame and then to the top frame using the remaining corner connectors.
5. Install the top hanging bars across the top frame. These bars are designed to support lighting and ventilation equipment.

# Durable Metal Frame

Provide a secure and stable environment for optimal plant growth.

0.8mm

16mm  
Pipe Diameter



Stable Hanging Bars

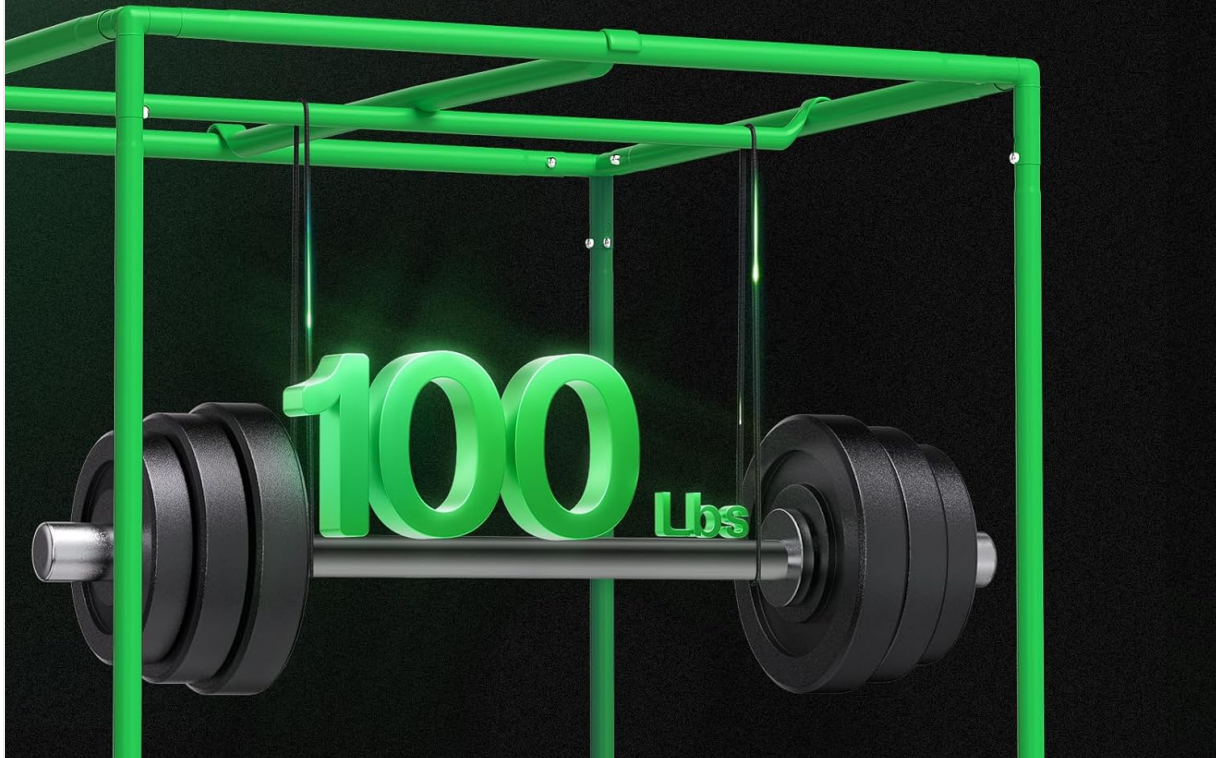

Image 4.1: Illustration of the durable metal frame structure and weight capacity.

## 4.2 Tent Cover Installation

1. Carefully unfold the tent fabric cover.
2. Drape the cover over the assembled metal frame, starting from the top.
3. Work the fabric down over the frame, ensuring it fits snugly around all corners and poles.
4. Zip up the main door and any other openings to ensure a lightproof seal. The upgraded SBS zippers are designed for smooth operation.

# Multi-Layered Fabric

Blocks all light leaks and boosts the output efficiency of your setup.

**600D**

Oxford Nylon

**340G**

Lightproof PE

**100%**

Reflective Mylar

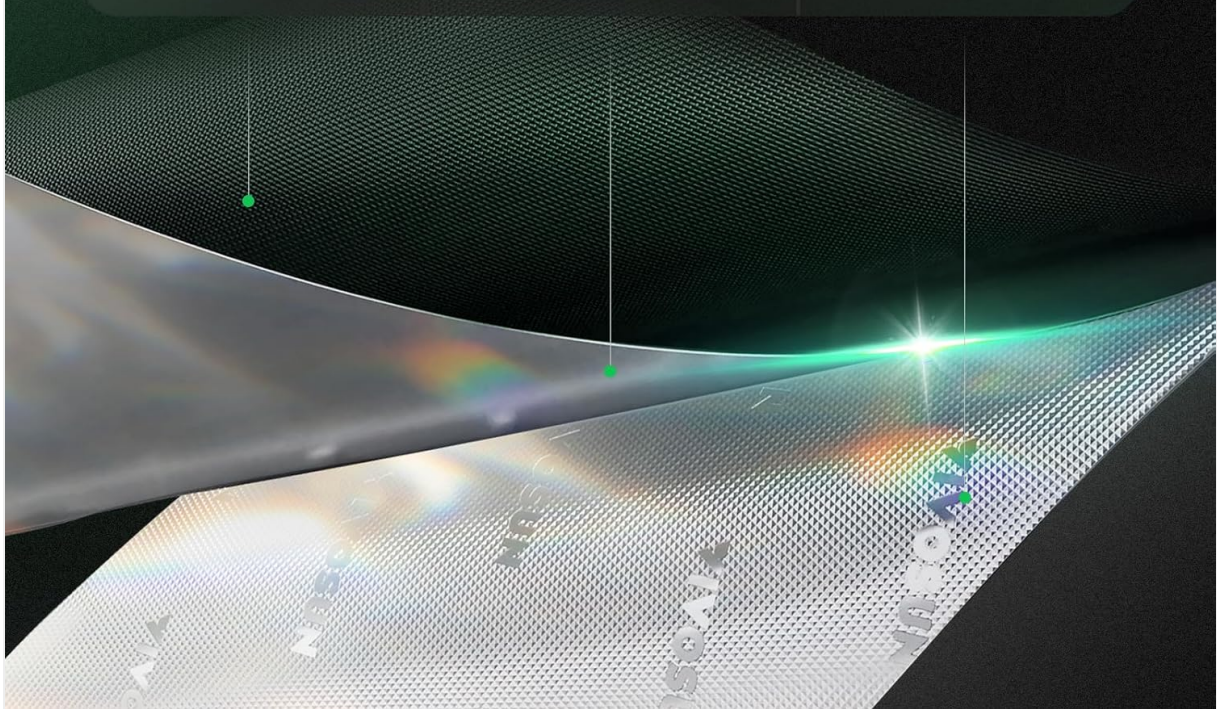

Image 4.2: Detail of the multi-layered fabric construction for light blocking and reflection.

# Upgraded SBS Zippers

Heavy-duty SBS zipper for a strong grip and seamless, effortless zipping.



Image 4.3: Detail of the upgraded SBS zippers.

## 4.3 Final Touches

1. Place the removable floor tray inside the tent at the bottom. This tray helps contain spills and makes cleaning easier.
2. Utilize the hanging straps to secure any carbon filters or other equipment to the top bars as needed.
3. Route electrical cords through the designated cable management slots to maintain a tidy and safe setup.

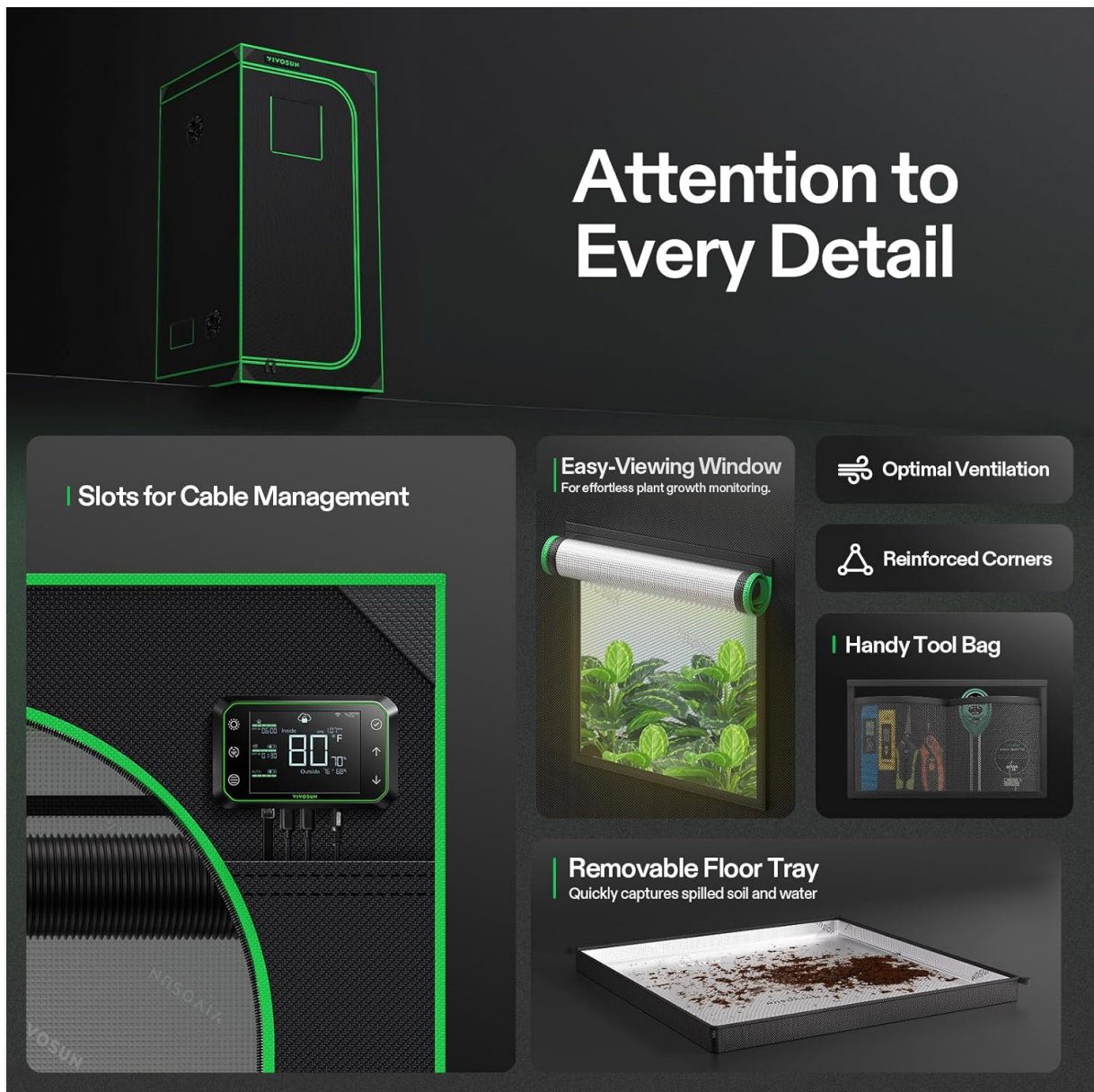



Image 4.4: Overview of tent features including cable management, viewing window, and floor tray.

## 5. OPERATING INSTRUCTIONS

### 5.1 Light Management

The tent's interior is lined with 100%-reflective Mylar, designed to maximize light utilization and distribution for your plants. Ensure all zippers are fully closed to prevent light leakage and maintain optimal growing conditions.

# 100% Reflective Diamond Mylar

 **Better**  
Light Utilization

 **Even**  
Light Distribution

 **High**  
Energy Efficiency

 **Increased**  
Yield & Quality

VIVOSUN		Other
Thickness	>17µm	<10µm
Reflectivity	100%	70%-80%



Image 5.1: Benefits of the reflective Mylar interior.

## 5.2 Ventilation and Airflow

The tent features multiple openings for duct fans and electrical cords, allowing for customized ventilation setups. Proper airflow is crucial for plant health and temperature regulation. The window at the bottom also aids in heat dissipation.

## 5.3 Observation Window

A transparent plastic observation window allows you to monitor your plants' growth without disturbing the internal environment. The hook and loop fasteners make it easy to open and close the window cover.

## 5.4 Internal Tool Organizer

An inner tool organizer is provided for convenient storage of gardening tools, keeping them accessible and organized within the tent.

## 6. MAINTENANCE

### 6.1 Cleaning the Tent

- The removable floor tray can be easily taken out for cleaning to manage spilled soil and water.

- Wipe down the interior Mylar lining with a damp cloth as needed to maintain its reflectivity.
- Clean the exterior fabric with a mild detergent and water, then allow it to air dry completely.

## 6.2 Zipper Care

To ensure the longevity of the zippers, operate them smoothly and avoid forcing them. Periodically clean any debris from the zipper teeth.

## 7. TROUBLESHOOTING

---

### 7.1 Light Leaks

If minor pinprick light leaks are observed, particularly around zippers, these are generally minimal and unlikely to significantly impact plant growth. Ensure zippers are fully closed and the tent fabric is properly stretched over the frame. The zipper part has an upgraded black inner lining to prevent light.

### 7.2 Tight Ventilation Ports

The ventilation ports are designed to fit snugly to prevent air and light leaks. When installing ducting, take your time to gently work the duct through the opening to avoid tearing the fabric. The tight fit also provides some support for attached equipment.

### 7.3 Instability

Ensure all metal poles are fully inserted into the corner connectors. Verify that the frame is square and level. Do not exceed the maximum weight capacity for hanging equipment.

## 8. SPECIFICATIONS

---

<b>Brand</b>	VIVOSUN
<b>Model</b>	S336
<b>Product Dimensions</b>	36"L x 36"W x 72"H
<b>Item Weight</b>	20.7 Pounds
<b>Frame Material</b>	Metal (16mm pipe diameter, 0.8mm thickness)
<b>Inner Material</b>	100% Reflective Mylar
<b>Outer Material</b>	600D Oxford Fabric, PE
<b>Top Hanging Bar Capacity</b>	Up to 100 lbs per bar
<b>Coverage Area</b>	9 ft <sup>2</sup>
<b>Volume</b>	54 ft <sup>3</sup>
<b>Plant Capacity</b>	2-4 Plants in 3-Gallon Pots (approximate)

# Specifications

Model: S336

**Small**  
Size

**9 ft<sup>2</sup>**  
Coverage

**54 ft<sup>3</sup>**  
Volume

**100 lbs.**  
Weight Capacity

**16mm Steel**  
Frame

**2-4 Plants in  
3-Gallon Pots**  
Plant Capacity



Image 8.1: Visual representation of VIVOSUN S336 specifications.

## 9. WARRANTY AND SUPPORT

VIVOSUN products are manufactured to high-quality standards. For specific warranty details, please refer to the warranty card included with your purchase or visit the official VIVOSUN website. If you encounter any issues or require assistance, please contact VIVOSUN customer support through their official channels. Provide your model number (S336) and purchase details for efficient service.

## 10. ADDITIONAL RESOURCES

While no specific videos were provided for direct embedding in this manual, VIVOSUN often provides helpful resources. For visual guides on assembly or advanced usage tips, please visit the official VIVOSUN YouTube channel or their support page. Look for videos related to 'VIVOSUN S336 Grow Tent Assembly' or 'Indoor Grow Tent Setup'.