

## SCS Sentinel 3760074136520

# SCS Sentinel SCS1 Standard Motorisation Kit for Swing Gate, 24V

Model: 3760074136520

## INTRODUCTION

---

This user manual provides comprehensive instructions for the installation, operation, and maintenance of your SCS Sentinel SCS1 Standard Motorisation Kit for Swing Gate, 24V. Please read this manual carefully before beginning installation or operation to ensure safe and efficient use of the product. Keep this manual for future reference.

## SAFETY INFORMATION

---

Always prioritize safety during installation and operation. Failure to follow safety guidelines may result in injury or damage to the product.

- Ensure all electrical connections are made by a qualified professional and comply with local regulations.
- Disconnect power before performing any maintenance or troubleshooting.
- Keep children and pets away from the gate area during operation.
- Do not attempt to repair damaged components yourself. Contact qualified service personnel.
- Ensure the gate operates freely without obstruction before and after motorization.

## PACKAGE CONTENTS

---

Verify that all components listed below are present in your package:



Image: Overview of the SCS Sentinel SCS1 Motorisation Kit, showing the two 24V motors, the electronic control box, and two remote controls.

- 2 x 24V Motors (actuators)
- 1 x Electronic Control Box
- 2 x 4-Channel Rolling Code Remote Controls
- 2 x Gate Mounting Lugs
- 2 x Pillar Mounting Lugs
- 1 x User Manual (this document)
- Assorted Screws and Fittings

prim' by  
SCS Sentinel

**Motorisation à vérins  
pour portail battant**

Automation kit for swing gate  
Motorizzazione a martinetto per cancello a battente  
Kit automatismos portal dos batientes  
Zylinderantrieb für Flügeltore



Ship From :  
SCS SENTINEL  
110 RUE PIERRE GILLES DE GENNES  
BP69 I  
49300 CHOLET (FR)

Ship To :  
GXO XOR1  
PARC D ACTIVITE DE L A5  
2449 RUE DENIS PAPIN - PARIS  
77550 REAU (FR)

Purchase order(s) :  
17ZNC87I

Nr avis exp. : ASNCDC036435

GTIN : 3760074136520  
SCS 1



QTY : 1  
CARTON : 74 of 76

SSCC : (00) 3370 1085 2013 0976 21



Points de collecte sur [www.quefairede mesdechets.fr](http://www.quefairede mesdechets.fr)  
Privilégiez la réparation ou le don de votre appareil !

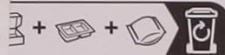

Séparez les éléments avant de trier

Toutes l  
[www.scs-](http://www.scs-)

**SCS S**

110, rue Pier  
49300 Cho



Fabriqu  en Chine

Image: The product packaging displaying the kit contents in multiple languages, confirming the inclusion of motors, control unit, remote controls, screws, and user manual.

## SETUP

The installation process involves three main steps: mechanical installation, electrical connection, and programming/synchronization.

# Installation rapide en 3 ÉTAPES

## Installation mécanique

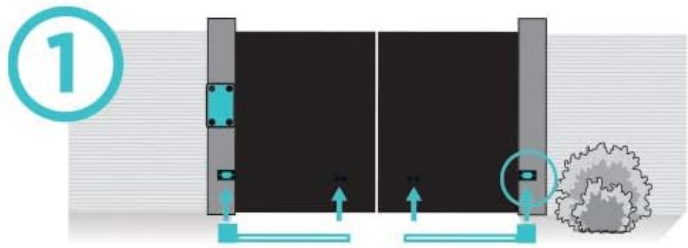

## Raccordement électrique

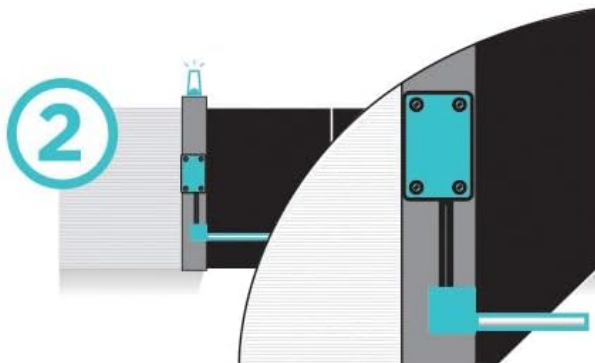

## Programmation et synchronisation

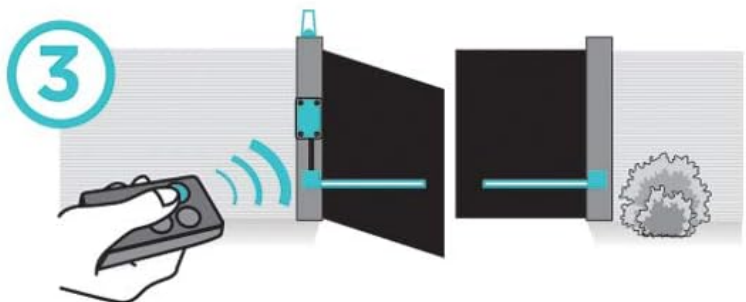

Image: A visual representation of the three quick installation steps: 1. Mechanical installation, 2. Electrical connection, and 3. Programming and synchronization.

### 1. Mechanical Installation

Mount the motors to your swing gate and pillars using the provided mounting lugs. Ensure the gate is within the specified dimensions (up to 3m wide and 300kg per leaf). Proper alignment is crucial for smooth operation.



Image: An illustration showing the SCS Sentinel SCS1 motors installed on a swing gate, demonstrating the mechanical setup.

Refer to the included diagram for optimal mounting angles and distances to ensure the actuators operate with minimal stress. The system is designed for gates up to 1.5m wide and 150kg per leaf, or 3m wide and 300kg total for a double gate.

## 2. Electrical Connection

Connect the motors and power supply to the electronic control box. Follow the wiring diagram provided in the detailed manual (not included in this summary). Ensure all connections are secure and insulated. The system operates on 24V.

## 3. Programming and Synchronization

Once mechanical and electrical installations are complete, program the control unit and synchronize the remote controls. This typically involves a learning procedure where the system records the gate's opening and closing limits. Refer to the detailed manual for specific programming steps, including setting pedestrian opening and automatic closing functions.

## OPERATING INSTRUCTIONS

---

Your SCS Sentinel SCS1 kit offers convenient and reliable gate operation.

### Remote Control Operation



Image: A close-up view of the two 4-channel rolling code remote controls included with the kit.

- Press the designated button on your 4-channel remote control to open or close the gate.
- A second press during operation will stop the gate. A third press will reverse its direction.
- The remote controls can be programmed for full opening or partial (pedestrian) opening.

### Automatic Closing

If photocells are installed and configured, the gate can be set to close automatically after a set delay once it has fully opened. This feature enhances security and convenience.

### Obstacle Detection

The system is equipped with obstacle detection. If the gate encounters an obstruction during closing, it will stop and reverse direction to prevent damage or injury.

### Manual Override

In case of power failure or system malfunction, the motors can be manually disengaged using the provided hexagonal keys. This allows the gate to be opened or closed by hand.

## MAINTENANCE

---

Regular maintenance ensures the longevity and optimal performance of your gate motorization system.

- **Monthly:** Inspect the gate for any physical obstructions, ensure hinges are lubricated, and check that the gate moves freely.
- **Quarterly:** Clean the motor actuators and control box to prevent dust and debris buildup. Check all mounting points for tightness.
- **Annually:** Have a qualified technician inspect the electrical connections and overall system for wear and tear.
- Do not use abrasive cleaners or solvents on any components.

## TROUBLESHOOTING

This section addresses common issues you might encounter. For more complex problems, consult a qualified technician.

Problem	Possible Cause	Solution
Gate does not respond to remote.	No power; remote battery low; remote not programmed; obstruction.	Check power supply; replace remote battery; re-program remote; clear obstructions.
Gate stops mid-operation.	Obstruction detected; motor overload; faulty sensor.	Remove obstruction; check gate movement for friction; inspect sensors.
Gate opens partially.	Pedestrian mode activated; limit switch issue.	Check remote button pressed; re-calibrate limit switches.
Unusual noise during operation.	Lack of lubrication; loose components; motor wear.	Lubricate hinges/moving parts; tighten fasteners; contact support if noise persists.

## SPECIFICATIONS

Key technical specifications for the SCS Sentinel SCS1 Standard Motorisation Kit:



# SCS1

## MOTORISATION À VÉRINS POUR PORTAIL BATTANT

Facile d'utilisation & simple d'installation  
(bornier avec codes couleurs)

Compatible avec tous les matériaux : bois,  
aluminium, fer, PVC (renforcé)

Ouverture rapide

Ouverture totale et partielle (ouverture piéton)

Angle d'ouverture maximum : 120°

Ralentissement de fin de course

Arrêt sur obstacle

Fermeture automatique (si photocellules)

Déverrouillage manuel

Apprentissage de la course

Image: A graphic detailing key features and specifications of the SCS1 motorization kit, including ease of use, 24V operation, silent motors, and 3-year warranty.

Feature	Detail
Model Number	3760074136520
Power Supply	24V
Max Gate Length (per leaf)	3 meters
Max Gate Weight (per leaf)	300 kg
Max Opening Angle	120°
Product Dimensions	71 x 98 x 19.2 cm
Item Weight	12.2 Kilograms
Included Components	2 motors, 1 electronic control box, 2 remote controls, mounting lugs, fittings



# WARRANTY AND SUPPORT





SCS Sentinel products are designed for reliability and durability. This product typically comes with a manufacturer's warranty. Please refer to the warranty card included in your package for specific terms and conditions, including the warranty period (often 3 years as indicated in some product images).

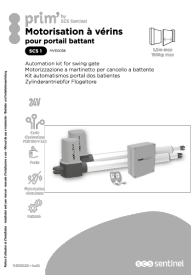

For technical support, spare parts, or warranty claims, please contact SCS Sentinel customer service. Contact details can usually be found on the manufacturer's website or on the product packaging.

**Manufacturer:** SCS Sentinel

**Address:** 110, rue Pierre Gilles de Gennes, 49300 Cholet - France

## Related Documents - 3760074136520

	<p><a href="#">SCS Sentinel SCS 1 Motorisation Kit for Swing Gates - Installation and User Manual</a></p> <p>Comprehensive guide for the SCS Sentinel SCS 1 swing gate motorization kit, covering installation, wiring, settings, maintenance, and troubleshooting. Features 24V DC motors, remote controls, and safety photocells.</p>
	<p><a href="#">SCS Sentinel OpenGate 1 MVE0100 Swing Gate Automation Kit - Installation and User Manual</a></p> <p>Comprehensive guide for the SCS Sentinel OpenGate 1 MVE0100 swing gate automation kit, covering installation, wiring, settings, maintenance, and troubleshooting. Features 24V DC motors for residential use.</p>
	<p><a href="#">SCS Sentinel OpenGate 2 MBA0103: Guide d'installation et d'utilisation</a></p> <p>Manuel détaillé pour l'installation et l'utilisation du kit d'automatisation de portail battant SCS Sentinel OpenGate 2 (modèle MBA0103). Inclut consignes de sécurité, description du kit, câblage, réglages et maintenance.</p>
	<p><a href="#">SCS Sentinel MCO0058: Kit d'automatisation pour portail coulissant 24V</a></p> <p>Manuel d'installation et d'utilisation du kit d'automatisation SCS Sentinel MCO0058 pour portail coulissant 24V. Ce guide couvre le câblage, les réglages, les caractéristiques techniques et la maintenance pour une installation résidentielle sécurisée.</p>

	<p><a href="#">SCS Sentinel SimplyOpen 1+ Swing Gate Motorisation Installation and User Manual</a></p> <p>Comprehensive installation, usage, maintenance, and troubleshooting guide for the SCS Sentinel SimplyOpen 1+ swing gate motorisation system. Includes technical specifications, safety instructions, and wiring diagrams.</p>
	<p><a href="#">SCS Sentinel OpenGate 1 MVE0100 Swing Gate Automation Kit Manual</a></p> <p>Comprehensive manual for the SCS Sentinel OpenGate 1 MVE0100 swing gate automation kit, covering installation, operation, maintenance, and troubleshooting. Includes technical specifications and safety guidelines.</p>