

GROHE 23571000

GROHE Universal Concealed Body for 2-Hole Basin Mixer, Model 23571000 - Installation and Operation Manual

1. INTRODUCTION AND OVERVIEW

This manual provides detailed instructions for the installation, operation, and maintenance of the GROHE Universal Concealed Body, Model 23571000. This component is designed for use with 2-hole basin mixers requiring wall installation. It features a GROHE SilkMove 35 mm ceramic cartridge, adjustable flow rate limitation, and a temperature limiter. The design allows for flexible positioning of the spout on either the left or right side. The required installation depth is between 45 mm and 75 mm. The unit is constructed from dezincification-resistant brass and includes an installation template for precise setup. Please note that the finishing trim set is sold separately.

2. SAFETY INFORMATION

- Always turn off the main water supply before beginning any installation or maintenance work.
- Ensure all plumbing connections are secure and watertight to prevent leaks.
- Professional installation by a qualified plumber is recommended to ensure correct setup and compliance with local building codes.
- Wear appropriate personal protective equipment, such as safety glasses and gloves, during installation.
- Do not use abrasive cleaners or harsh chemicals on any part of the product, as this may damage the finish or internal components.

3. PACKAGE CONTENTS

Verify that all components are present before beginning installation:

- 1 x GROHE Universal Concealed Body (Model 23571000)
- Installation Template
- Mounting Hardware (if applicable, refer to packaging)

Note: The finishing trim set for the basin mixer is not included and must be purchased separately.

4. SPECIFICATIONS

Feature	Detail
Brand	GROHE
Model Name	Universal Concealed Body
Part Number	23571000
Recommended Uses	Basin
Mounting Type	Wall Mount (Concealed)
Hole Count	Designed for 2-Hole Basin Mixers
Material	Dezincification-resistant Brass, Ceramic
Cartridge	GROHE SilkMove 35 mm Ceramic Cartridge
Installation Depth	45 mm to 75 mm
Spout Position	Adjustable (Left or Right)
Product Dimensions	4.76"D x 6.22"W x 3.31"H
Item Weight	0.045 ounces (approx. 1.28 grams)
EU Spare Part Availability	10 Years

5. INSTALLATION (SETUP)

This section outlines the general steps for installing the GROHE Universal Concealed Body. Refer to the specific instructions provided with your chosen finishing trim set for complete details.

- 1. Prepare the Installation Area:** Ensure the wall cavity is clear and provides sufficient space for the concealed body and plumbing connections. The installation depth should be between 45 mm and 75 mm.
- 2. Position the Concealed Body:** Use the provided installation template to mark the precise location for the concealed body and the two holes for the basin mixer's spout and handle. The template ensures correct spacing and alignment.



Figure 1: The GROHE Universal Concealed Body shown alongside its installation template, illustrating how the template guides the placement of the unit within the wall.

3. **Secure the Concealed Body:** Mount the concealed body securely within the wall cavity using appropriate fasteners. Ensure it is level and firmly fixed. The brass frame provides robust support.



Figure 2: The concealed body is shown installed within a wall, with the white installation template still in place, demonstrating proper embedding and alignment.

4. **Connect Water Supply:** Connect the hot and cold water supply lines to the designated inlets on the concealed body. Ensure all connections are tightened properly to prevent leaks.
5. **Install Finishing Trim Set:** Once the concealed body is installed and water connections are made, proceed with installing the chosen GROHE 2-hole basin mixer finishing trim set according to its specific instructions. This includes attaching the spout and handle components.
6. **Test for Leaks:** After installation, slowly turn on the main water supply and carefully check all connections for any signs of leaks. Address any leaks immediately.



Figure 3: A clear front view of the GROHE Universal Concealed Body, highlighting its brass structure and blue protective sleeves for the water outlets.

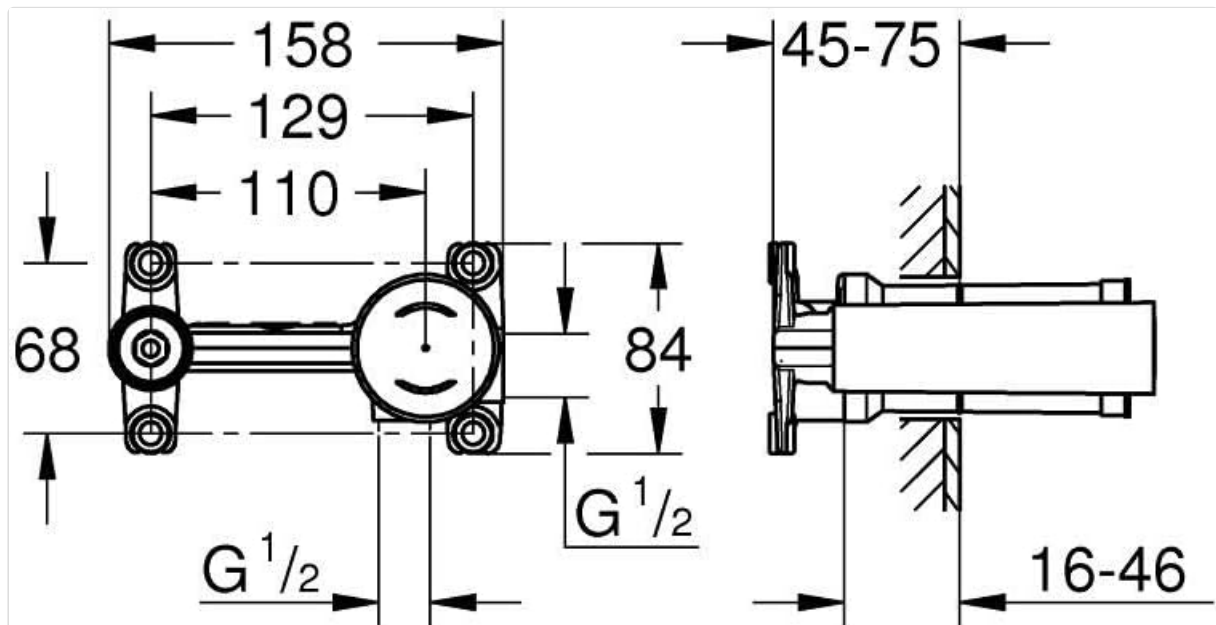

Figure 4: A technical diagram providing precise measurements and dimensions for the GROHE Universal Concealed Body, crucial for accurate planning and installation.

6. OPERATION

The GROHE Universal Concealed Body functions as the core mechanism for your 2-hole wall-mounted basin mixer. Its operation is directly controlled by the external trim set (spout and handle) that is installed over it.

- **Water Flow Control:** The integrated GROHE SilkMove 35 mm ceramic cartridge allows for smooth and precise control of water flow and temperature through the mixer handle.

- **Temperature Limiter:** The concealed body includes a temperature limiter, which can be adjusted during installation to prevent scalding by restricting the maximum hot water temperature.
- **Adjustable Spout Position:** The design permits the spout to be positioned on either the left or right side of the handle, offering flexibility in bathroom design.

7. MAINTENANCE

Proper maintenance ensures the longevity and optimal performance of your GROHE concealed body and basin mixer.

- **Regular Cleaning:** Clean the visible parts of your basin mixer (trim set) regularly with a soft cloth and mild soap. Avoid abrasive cleaners, scouring pads, or harsh chemicals, as these can damage the finish.
- **Check for Leaks:** Periodically inspect the area around the concealed body for any signs of water leakage. Although concealed, persistent dampness or water stains on the wall could indicate an issue.
- **Cartridge Longevity:** The GROHE SilkMove ceramic cartridge is designed for durability. If you notice a significant change in water flow or temperature control over time, the cartridge may require inspection or replacement by a qualified professional.
- **Water Quality:** In areas with hard water, mineral deposits can affect performance. Regular flushing of the system or professional descaling may be beneficial.

8. TROUBLESHOOTING

This section addresses common issues you might encounter. For complex problems, contact a qualified plumber or GROHE customer support.

- **Issue: Reduced Water Flow**
Possible Causes: Clogged aerator on the spout (if applicable), mineral buildup in the cartridge, or issues with the water supply.
Solution: Clean the aerator. If the problem persists, the cartridge may need professional inspection or replacement.
- **Issue: Inconsistent Water Temperature**
Possible Causes: Faulty cartridge, incorrect temperature limiter setting, or issues with hot/cold water supply.
Solution: Check the temperature limiter setting. If the issue continues, the cartridge may be worn and require replacement.
- **Issue: Leaks from the Wall**
Possible Causes: Loose connections within the concealed body, damaged seals, or issues with the water supply lines.
Solution: Immediately turn off the water supply. This requires professional inspection and repair, as it indicates a problem with the concealed plumbing.
- **Issue: Mixer Handle is Stiff or Loose**
Possible Causes: Worn cartridge, loose mounting screws on the trim set.
Solution: Check the mounting of the external trim set. If the issue is with the handle's internal movement, the cartridge may need replacement.

9. WARRANTY AND SUPPORT

GROHE products are manufactured to high-quality standards. The GROHE Universal Concealed Body, Model

23571000, benefits from a commitment to long-term support, with EU spare part availability guaranteed for 10 years.

For warranty claims, technical assistance, or to purchase spare parts, please contact GROHE customer service or visit the official GROHE website. Keep your proof of purchase for warranty validation.

For further information, you may visit the [GROHE Store on Amazon](#).