

[Manuals.plus](#) /

> [Kircuit](#) /

> Kircuit AC Adapter K0108030 for Stanley SL3HS LED Rechargeable Spotlight Instruction Manual

## Kircuit K0108030

# Kircuit AC Adapter K0108030 for Stanley SL3HS LED Rechargeable Spotlight Instruction Manual

## INTRODUCTION

This instruction manual provides essential information for the proper installation, operation, and maintenance of your Kircuit AC Adapter, model K0108030. This adapter is specifically designed to provide power and charge the Stanley SL3HS LED Rechargeable Spotlight. Please read this manual thoroughly before use to ensure safe and efficient operation.

## PRODUCT OVERVIEW

The Kircuit AC Adapter is a high-quality replacement power supply featuring a robust design for reliable performance. It includes built-in dynamic IC, charger IC, and power fuse for rapid charging and protection against overcharge.



Image: Two Kircuit AC adapters, displaying the input/output specifications on their labels and the barrel connector type.



Image: A Kircuit AC adapter with its attached power cord, clearly indicating a cord length of 6.5 feet.

## SETUP INSTRUCTIONS

1. **Identify Components:** Ensure you have the Kircuit AC Adapter and your Stanley SL3HS LED Rechargeable Spotlight.
2. **Connect to Spotlight:** Insert the barrel connector end of the AC adapter cable into the charging port of your Stanley SL3HS LED Rechargeable Spotlight. Ensure a secure connection.
3. **Connect to Power Outlet:** Plug the AC adapter's two-prong plug into a standard 100V-240V AC wall power outlet.
4. **Verify Connection:** Once connected, the spotlight should begin charging. Refer to your spotlight's manual for specific charging indicators.



Image: The Kircuit AC adapter is shown plugged into a white power strip on a wooden desk, ready for use.

## OPERATING INSTRUCTIONS

- **Charging:** Once properly connected, the adapter will supply power to your Stanley SL3HS LED Rechargeable Spotlight for charging. The charging duration will depend on the spotlight's battery level and capacity.
- **Overcharge Protection:** The adapter is equipped with built-in overcharge protection to prevent damage to your device's battery. You can leave the spotlight connected to the adapter without concern for overcharging.
- **Input Voltage:** The adapter supports a wide input voltage range of 100V-240V AC, making it suitable for use in various regions with appropriate plug adapters (not included).

## Durable design

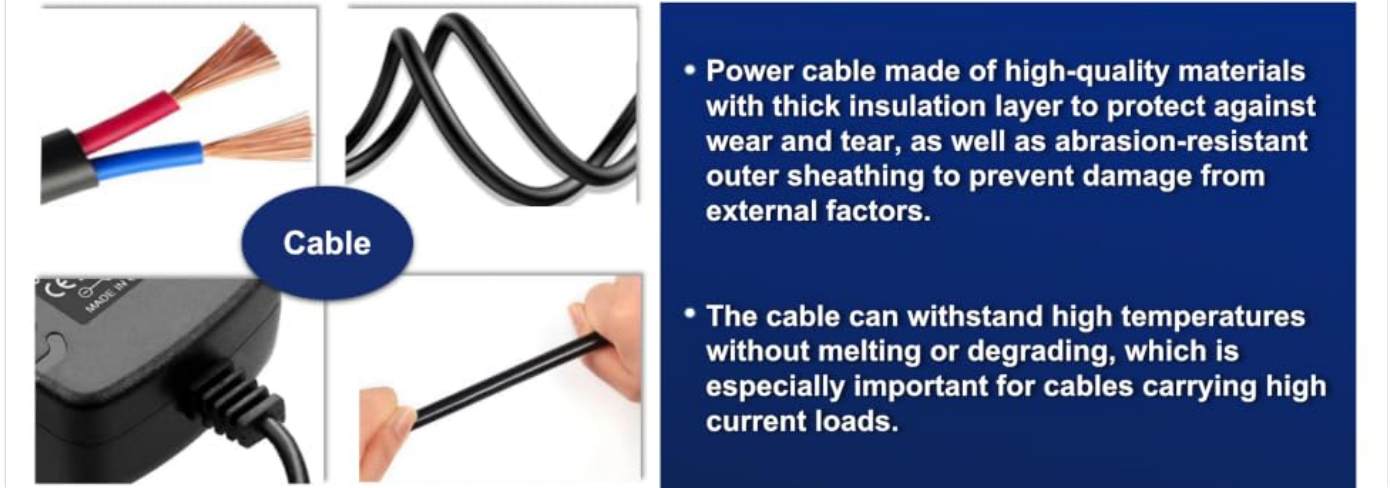

Image: A diagram illustrating the four key built-in safety protections of the Kircuit adapter: Short Cut protection, Excess Voltage protection, Over Temperature protection, and Overcurrent protection.

## MAINTENANCE

- **Cleaning:** Disconnect the adapter from the power outlet and the spotlight before cleaning. Use a soft, dry cloth to wipe the exterior of the adapter. Do not use liquid cleaners or solvents.
- **Storage:** Store the adapter in a cool, dry place away from direct sunlight and extreme temperatures when not in use. Avoid wrapping the cable too tightly.
- **Cable Care:** Regularly inspect the power cord and connector for any signs of damage, such as fraying, cuts, or bent pins. Do not use the adapter if the cable or connector is damaged.

- The plugs on the power cable also well-made and designed to provide a secure and stable connection.
- The plugs can handle high electrical loads without overheating or causing a fire hazard.

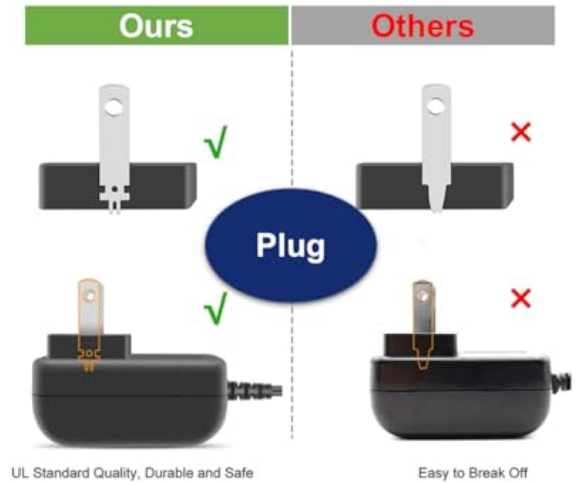

Image: Visuals demonstrating the durable construction of the adapter's cable, highlighting its high-quality materials and flexibility.

## Why choose Kircuit ?



**Kircuit adapters have a wide range of product offerings that are compatible with various device types, power requirements, and connector standards. Kircuit adapters have a strong quality control process in place to ensure our products meet the highest standards of safety and performance.**

Image: A comparison showing the secure and stable connection provided by the Kircuit adapter's plug design compared to less robust alternatives.

Problem	Possible Cause	Solution
Spotlight not charging	Loose connection, no power from outlet, damaged adapter/cable	Ensure all connections are secure. Test the power outlet with another device. Inspect the adapter and cable for damage. If damaged, discontinue use and replace.
Adapter feels hot during use	Normal operation, excessive load, poor ventilation	A slight warmth is normal. Ensure the adapter is in a well-ventilated area. If it becomes excessively hot or emits smoke/odor, disconnect immediately and discontinue use.

## SPECIFICATIONS

Feature	Specification
Brand	Kircuit
Model Number	K0108030
Input Voltage	100V-240V AC
Frequency Range	50/60 Hz
Connector Type	Barrel Connector
Compatible Devices	Stanley SL3HS LED Rechargeable Spotlight
Included Components	1 x AC Adapter
Special Features	Portable, Travel, Overcharge Protection
Main Power Connector Type	2 Pin (Type C Power Plug)
GTIN / UPC	069462222245

## WARRANTY INFORMATION

This Kircuit AC Adapter is covered by a standard limited warranty against manufacturing defects. Please retain your proof of purchase for warranty claims. For specific warranty terms and conditions, refer to the product packaging or contact Kircuit customer support.

## SUPPORT

For technical assistance, troubleshooting, or product inquiries, please contact the seller or manufacturer directly. Refer to your purchase documentation for contact details.