

Legrand LEG97605

Legrand LEG97605 300W Non-Flush Rotary Dimmer Switch User Manual

1. INTRODUCTION

This manual provides comprehensive instructions for the safe installation, operation, and maintenance of your Legrand LEG97605 300W Non-Flush Rotary Dimmer Switch. Please read this manual thoroughly before installation and use, and retain it for future reference.

The Legrand LEG97605 is a 300W dimmer switch designed for surface mounting, featuring a rotary button for light intensity control and an integrated push-button for ON/OFF functionality. It is suitable for 1-way circuit applications.



Figure 1: Front view of the Legrand LEG97605 Dimmer Switch.

2. IMPORTANT SAFETY INFORMATION

WARNING: RISK OF ELECTRIC SHOCK. Always turn off power at the circuit breaker or fuse box before installing or servicing this device. Improper installation can result in serious injury or death.

- Installation should be performed by a qualified electrician or in accordance with local electrical codes.
- Do not exceed the maximum wattage rating of 300W.
- Ensure all wire connections are secure and properly insulated.
- This device is designed for indoor use only.
- Do not use with incompatible load types (e.g., certain LED drivers, fluorescent fixtures) unless specified by the manufacturer.

3. PACKAGE CONTENTS

Verify that all components are present before beginning installation:

- Legrand LEG97605 300W Non-Flush Rotary Dimmer Switch (1 unit)
- Mounting Screws (Quantity may vary)
- Instruction Manual (This document)



Figure 2: Legrand LEG97605 Dimmer Switch as packaged.

4. INSTALLATION INSTRUCTIONS

Follow these steps carefully to install your dimmer switch:

1. **Turn Off Power:** Locate the circuit breaker or fuse controlling the light fixture you intend to dim. Switch it to the OFF position. Verify power is off using a voltage tester before proceeding.
2. **Prepare Mounting Location:** The LEG97605 is a non-flush, surface-mount dimmer. Choose a suitable wall location for mounting.
3. **Wiring:**
 - Identify the live (line) wire and the load wire (to the light fixture).

- Connect the incoming live wire to the terminal marked 'L' or 'Input' on the dimmer switch.
 - Connect the wire going to the light fixture (load wire) to the terminal marked 'Load' or 'Output' on the dimmer switch.
 - Ensure all connections are tight using the screw terminals.
4. **Mounting:** Secure the dimmer switch to the wall surface using the provided mounting screws. Ensure it is firmly attached and level.
 5. **Restore Power:** Once installation is complete and all connections are secure, turn the power back on at the circuit breaker.



Figure 3: Top view of the dimmer switch, illustrating potential wiring points.

5. OPERATING YOUR DIMMER SWITCH

The Legrand LEG97605 dimmer switch features a rotary knob for dimming and an integrated push-button for ON/OFF control.

- **To Turn ON/OFF:** Press the rotary knob firmly. You will hear a click, and the light will turn on or off.
- **To Dim/Brighten:** Rotate the knob clockwise to increase light intensity and counter-clockwise to decrease light intensity.



Figure 4: Angled view highlighting the rotary control knob.

6. MAINTENANCE

Your Legrand dimmer switch requires minimal maintenance.

- **Cleaning:** To clean the surface of the dimmer, wipe with a soft, damp cloth. Do not use abrasive cleaners, solvents, or harsh chemicals, as these can damage the finish.
- **Inspection:** Periodically inspect the switch for any signs of damage or loose connections. If any issues are found, turn off power and consult a qualified electrician.

7. TROUBLESHOOTING

If you experience issues with your dimmer switch, refer to the following common problems and solutions:

Problem	Possible Cause	Solution
---------	----------------	----------

Problem	Possible Cause	Solution
Light does not turn on.	No power to the switch; incorrect wiring.	Check circuit breaker/fuse. Verify wiring connections are correct and secure.
Light does not dim or dims poorly.	Incompatible bulb type; minimum load not met.	Ensure all connected bulbs are dimmable. Check if the total wattage of bulbs meets the dimmer's minimum load requirement (if any).
Light flickers or buzzes.	Loose wiring connection; incompatible bulb type; electrical interference.	Turn off power and check all wire connections. Replace bulbs with high-quality dimmable types. Consult an electrician if problem persists.
Dimmer feels hot to the touch.	Overload or improper wiring.	Turn off power immediately. Verify total connected wattage does not exceed 300W. Consult a qualified electrician.

If the problem persists after attempting these solutions, contact Legrand customer support or a qualified electrician.

8. TECHNICAL SPECIFICATIONS





Feature	Detail
Brand	Legrand
Model Number	LEG97605
Operation Mode	ON-OFF
Current Rating	10 Amps
Wattage	300 Watts
Contact Type	Normally Open
Connector Type	Screws
Terminal	Screw
Circuit Type	1-way
Actuator Type	Rotary
Controller Type	Push Button
Contact Material	Copper
International Protection Rating	IP54
Mounting Type	Surface Mount
Color	White
Item Weight	2.46 ounces
Date First Available	September 25, 2015

9. WARRANTY AND CUSTOMER SUPPORT

For warranty information, technical assistance, or to report a problem, please contact Legrand customer support. Refer to the official Legrand website or product packaging for the most current contact details.

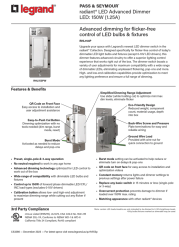
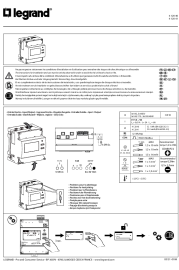
Legrand Official Website: www.legrand.us

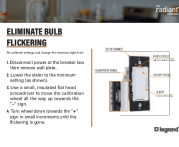
Related Documents - LEG97605

	<p>Legrand Pass & Seymour radiant LED Advanced Dimmer RHL153P - 150W Flicker-Free Control</p> <p>Discover the Legrand Pass & Seymour radiant LED Advanced Dimmer (RHL153P). This 150W dimmer offers flicker-free control for LED, CFL, and incandescent bulbs, featuring advanced dimming technology, easy calibration, and a modern design. Ideal for residential and commercial applications.</p>
	<p>Legrand 4 120 40/4 120 41 EMDX³ Energy Meter Technical Specifications and Wiring Guide</p> <p>Detailed technical specifications, installation instructions, and wiring diagrams for the Legrand 4 120 40 and 4 120 41 EMDX³ three-phase energy meters. Includes RS485 Modbus connectivity and safety guidelines.</p>
	<p>Wattstopper Auxiliary Relay Power Pack Installation Guide</p> <p>Detailed installation instructions and wiring diagram for the Wattstopper Auxiliary Relay Power Pack (Model S120/277/347E-P) by Legrand. Includes safety warnings and warranty information.</p>
	<p>How to Eliminate Bulb Flickering with Legrand Radiant Dimmers</p> <p>Troubleshoot and eliminate bulb flickering on your Legrand Radiant dimmer by recalibrating settings. This guide provides step-by-step instructions to adjust the calibration wheel for optimal performance.</p>
	<p>Legrand WNRL63 radiant® Wireless Smart Dimmer with Netatmo Installation Guide</p> <p>Step-by-step installation instructions for the Legrand WNRL63 radiant® Wireless Smart Dimmer with Netatmo. Covers installation methods, setup via the Legrand Home + Control app, device features, regulatory information, and warranty details.</p>

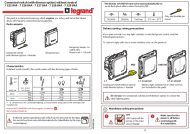

[Legrand Valena Allure Connected Switch Installation Guide](#)

Comprehensive installation guide for the Legrand Valena Allure with Netatmo connected switch (with dimmer option), covering product features, characteristics, wiring instructions, safety precautions, and compatibility. Includes model numbers 7525 84A, 7526 84A, 7527 84A, 7528 84A, and 7529 84A.