

Qolsys IQ Siren

Qolsys IQ Siren (Z-Wave) Instruction Manual

Model: IQ Siren

1. INTRODUCTION

The Qolsys IQ Siren is a wireless, ultra-loud Z-Wave siren designed to complement your security system. It provides an audible alarm at 105 dB and features integrated LED strobe lights during alarm events. Additionally, it functions as a Z-Wave repeater to enhance the performance and range of your Z-Wave network. This manual provides essential information for the proper setup, operation, and maintenance of your IQ Siren.

2. FEATURES

- Plugs into any standard electrical outlet for power.
- Three integrated LEDs strobe during alarm events for visual indication.
- Produces an ear-splitting 105 dB siren sound.
- Includes a 3-hour backup battery to ensure operation during power outages.
- Acts as a Z-Wave repeater to extend the range of your Z-Wave network.

The IQ Siren is an ultra-loud wireless Z-Wave siren that compliments your IQ Panel's built-in siren. At 105 db it's ear-splitting piezo will scare away any intruder and mimics the siren pattern used by the IQ Panel. It includes three LED lights that strobe during alarm events and contains a rechargeable 3 hour backup battery. It plugs into any standard outlet and even acts as a repeater to improve the performance of your Z-Wave network.

FEATURES

- Plugs into any standard outlet
- 3 LEDs strobe during alarm events
- Ear-splitting 105 db siren
- Clean, discreet look
- 3 hour backup battery
- Acts as Z-Wave repeater

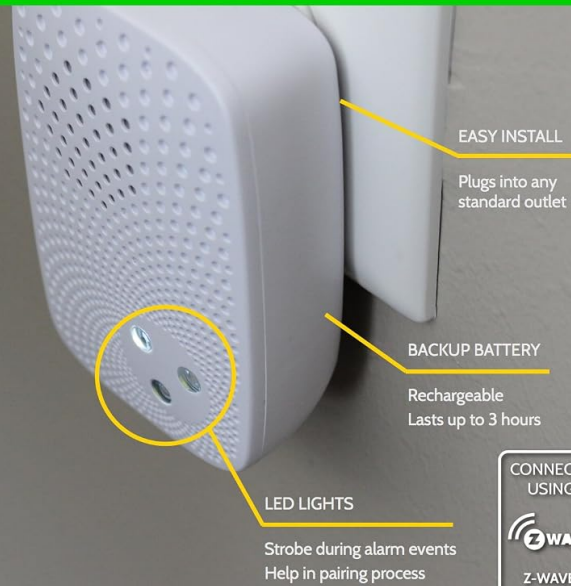

EASY INSTALL

Plugs into any standard outlet

BACKUP BATTERY

Rechargeable
Lasts up to 3 hours

LED LIGHTS

Strobe during alarm events
Help in pairing process



Image: The Qolsys IQ Siren highlighting its key features, including LED lights, backup battery, and Z-Wave connectivity.

3. SAFETY INFORMATION

Please read and understand all safety instructions before using the IQ Siren. Failure to follow these instructions may result in injury or damage to the device.

- **Loud Noise Warning:** The siren produces a very loud sound (105 dB) which can cause hearing discomfort or damage if exposed for prolonged periods or at close range. Do not activate the siren near your ears.
- **Electrical Safety:** Plug the device into a standard, properly grounded electrical outlet. Do not use with extension cords or adapters unless absolutely necessary and rated for the device. Do not expose to water or excessive moisture.
- **Battery Safety:** The device contains a backup battery. Do not attempt to replace the battery yourself unless specifically instructed. Dispose of batteries according to local regulations.
- **Placement:** Install the siren in a location where it is not easily accessible to children or pets. Ensure it is securely plugged in and not obstructed.
- **Maintenance:** Do not attempt to open or repair the device. Refer all servicing to qualified personnel.

4. PACKAGE CONTENTS

Verify that all items are present in your package:

- Qolsys IQ Siren (Z-Wave) Unit
- Quick Start Guide (if included)

5. SETUP AND INSTALLATION

Follow these steps to install and pair your IQ Siren with your Z-Wave compatible security system.

5.1 Physical Installation

1. Select a suitable indoor location for the siren, preferably centrally located within your Z-Wave network's range and near a standard electrical outlet.

2. Plug the IQ Siren directly into a standard 120V AC wall outlet. Ensure it is securely seated.



Image: The Qolsys IQ Siren plugged into a standard wall outlet, ready for operation.

5.2 Z-Wave Pairing (Inclusion)

To integrate the IQ Siren into your Z-Wave network, you must "include" it with your Z-Wave controller (e.g., Qolsys IQ Panel or other compatible Z-Wave hub).

1. Put your Z-Wave controller into "inclusion" or "add device" mode. Refer to your controller's manual for specific instructions.
2. With the IQ Siren plugged in, press the small button on the side of the siren (often indicated by a small LED or indentation). The LED on the siren should begin to flash, indicating it is attempting to pair.
3. Once successfully paired, your Z-Wave controller should confirm the inclusion, and the siren's LED may change to a solid state or turn off.
4. Test the siren's functionality through your Z-Wave controller to ensure it responds correctly to commands.

Note on Compatibility: While the IQ Siren is Z-Wave compatible, optimal performance and full feature integration are typically achieved with Qolsys IQ Panels. Compatibility with other Z-Wave hubs (e.g., Samsung SmartThings) may vary, and full functionality is not guaranteed. Always check your Z-Wave controller's compatibility list.

5.3 Z-Wave Exclusion (Removal)

If you need to remove the IQ Siren from your Z-Wave network or reset it, follow these steps:

1. Put your Z-Wave controller into "exclusion" or "remove device" mode.
2. Press the small button on the side of the IQ Siren. The controller should confirm the device's removal.



Image: Qolsys IQ Siren branding with a QR code. Scan this QR code for additional video instructions and setup guides: <http://scan.me/wcd2x2v>

6. OPERATING INSTRUCTIONS

Once successfully paired with your Z-Wave controller, the IQ Siren operates automatically in conjunction with your security system.

- **Alarm Activation:** When your Z-Wave security system triggers an alarm event, the IQ Siren will activate, emitting a 105 dB sound and flashing its LED strobe lights.
- **Alarm Deactivation:** The siren will cease sounding and strobing when the alarm event is cleared or disarmed through your Z-Wave controller.
- **Z-Wave Repeater:** The IQ Siren continuously functions as a Z-Wave repeater, strengthening the signals between your Z-Wave controller and other Z-Wave devices in its vicinity. This helps to improve the reliability and range of your overall Z-Wave network.

7. MAINTENANCE

The Qolsys IQ Siren requires minimal maintenance.

- **Cleaning:** Wipe the exterior of the siren with a soft, dry cloth. Do not use liquid cleaners or abrasive materials.
- **Backup Battery:** The internal backup battery provides power for up to 3 hours during a power outage. The siren will automatically recharge the battery when main power is restored. No user intervention is required for battery maintenance under normal conditions.
- **Firmware Updates:** Any firmware updates would typically be managed through your Z-Wave controller or security panel. Consult your panel's documentation for details.

8. TROUBLESHOOTING

If you encounter issues with your IQ Siren, refer to the following common troubleshooting steps:

Problem	Possible Cause	Solution
Siren does not pair with Z-Wave controller.	<ul style="list-style-type: none"> Controller not in inclusion mode. Siren too far from controller. Siren previously paired to another network (ghost node). Incompatibility with controller. 	<ul style="list-style-type: none"> Ensure controller is in inclusion mode. Move siren closer to the controller during pairing. Perform a Z-Wave exclusion on the siren first, then attempt inclusion. Verify your Z-Wave controller's compatibility with the IQ Siren.
Siren does not sound during an alarm.	<ul style="list-style-type: none"> No power to the siren. Siren not properly paired or configured. Alarm panel settings incorrect. 	<ul style="list-style-type: none"> Check if the siren is securely plugged into a live outlet. Verify Z-Wave pairing and ensure the siren is enabled in your alarm panel's settings. Consult your alarm panel's manual for siren configuration.
LEDs do not strobe during alarm.	<ul style="list-style-type: none"> Similar to siren not sounding. 	<ul style="list-style-type: none"> Follow troubleshooting steps for "Siren does not sound during an alarm."

If problems persist after attempting these solutions, contact Qolsys customer support or your security system provider for further assistance.

9. SPECIFICATIONS

Attribute	Detail
Brand	Qolsys
Model	IQ Siren
Color	White
Power Source	AC Plug-in with 3-hour Battery Backup
Compatible Devices	Z-Wave compatible devices and systems (optimized for Qolsys IQ Panels)
Battery Type (Backup)	Internal Rechargeable
Voltage	9 Volts (DC)
Control Method	Z-Wave (Touch button for pairing)
Audible Noise	105 Decibels
Mounting Type	Wall Outlet Plug-in
UPC	854545006412

10. WARRANTY AND SUPPORT

For warranty information, please refer to the documentation provided with your purchase or visit the official Qolsys website. For technical support, contact your security system installer or Qolsys customer service directly. Ensure you have your product model and serial number available when seeking support.

