

[Manuals.plus](#) /

› [UPBRIGHT](#) /

› [UpBright 9V AC/DC Adapter Instruction Manual for Sportcraft and Halex Dartboards](#)

## UPBRIGHT Sportcraft 69464 Dart board DC 9V Power

# UpBright 9V AC/DC Adapter Instruction Manual

For Sportcraft and Halex Electronic Dartboards

[Overview](#)

[Compatibility](#)

[Setup](#)

[Operation](#)

[Safety Features](#)

[Specifications](#)

[Troubleshooting](#)

[Maintenance](#)

[Warranty](#)

---

## 1. PRODUCT OVERVIEW

The UpBright 9V AC/DC Adapter is designed to provide reliable power to a wide range of electronic dartboards, specifically various models from Sportcraft and Halex. This power supply ensures stable operation for your compatible devices.



Figure 1: The UpBright 9V AC/DC Adapter, showing the main unit with two prongs for wall outlet connection and the attached DC output cable with a barrel connector.

The adapter features a universal input voltage range (100-240VAC) for worldwide compatibility and incorporates multiple safety protections to safeguard your devices.

## 2. COMPATIBILITY

This UpBright 9V AC/DC Adapter is compatible with numerous electronic dartboard models. Please verify your device's power requirements and connector type before use.

### Compatible Models Include:

- **Sportcraft Smartness Series:** 69464, 76567, 96229-022, 79078, 78037, 78097, 78009, 78053, 78448, 78048, 79524, 79078, 78056, 78079, 78003, (63A02-1911), (9501), D12-10-1000-07, D480900800U, 64402, D9300, D9-10, 78039, 78099.
- **Halex Series:** Alpha Electronic Dartboard #64313, Pro Series Q2 5400 ProSeries Fusion Dart Electronic, 69805 Cricketview 5000 BristleTech, 69700 Cricketview Softech 2000, 17085, 64405 Millenia 5.0 Cabinet, 69907 Madison Electronic, Match Play 3200 GT-22 GT22.

- **Other Compatible Models:** Madison II 69901, Titan BTX 64476, Model 64581, Regent Halex Delta 3 #64421, 64401, 64443, 64443-TAR 3200-Q, Arachnid Cricket Pro 650 Electronic E650ARA.

The adapter includes both big and small smart plug tips to ensure compatibility with various versions of these dartboards. It features a center negative polarity. **Note:** This adapter is NOT compatible with Sportcraft Smartness models 69464, 76567, 116764 if they require a different polarity or connector type than specified.

# Smart Plug Tip

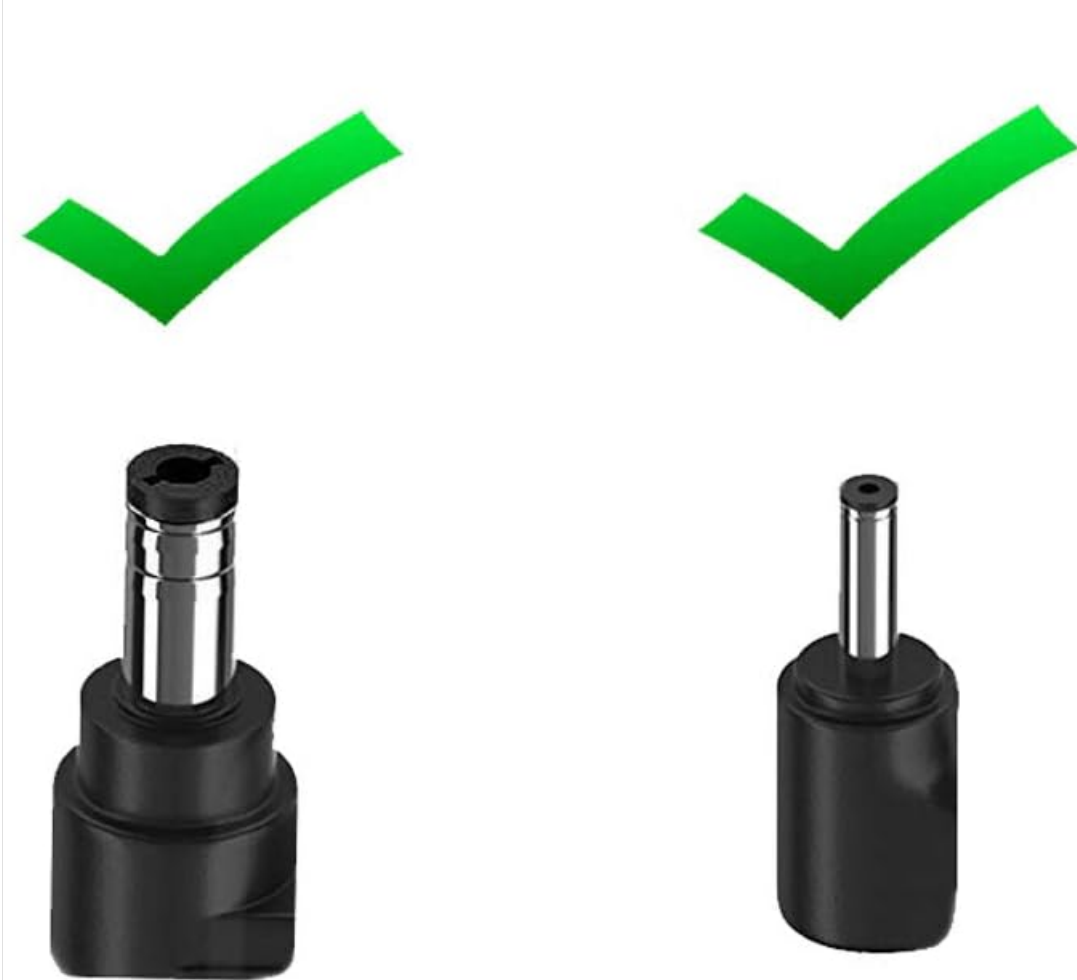

Figure 2: Illustration of the two smart plug tips provided with the adapter, designed to fit various dartboard models.

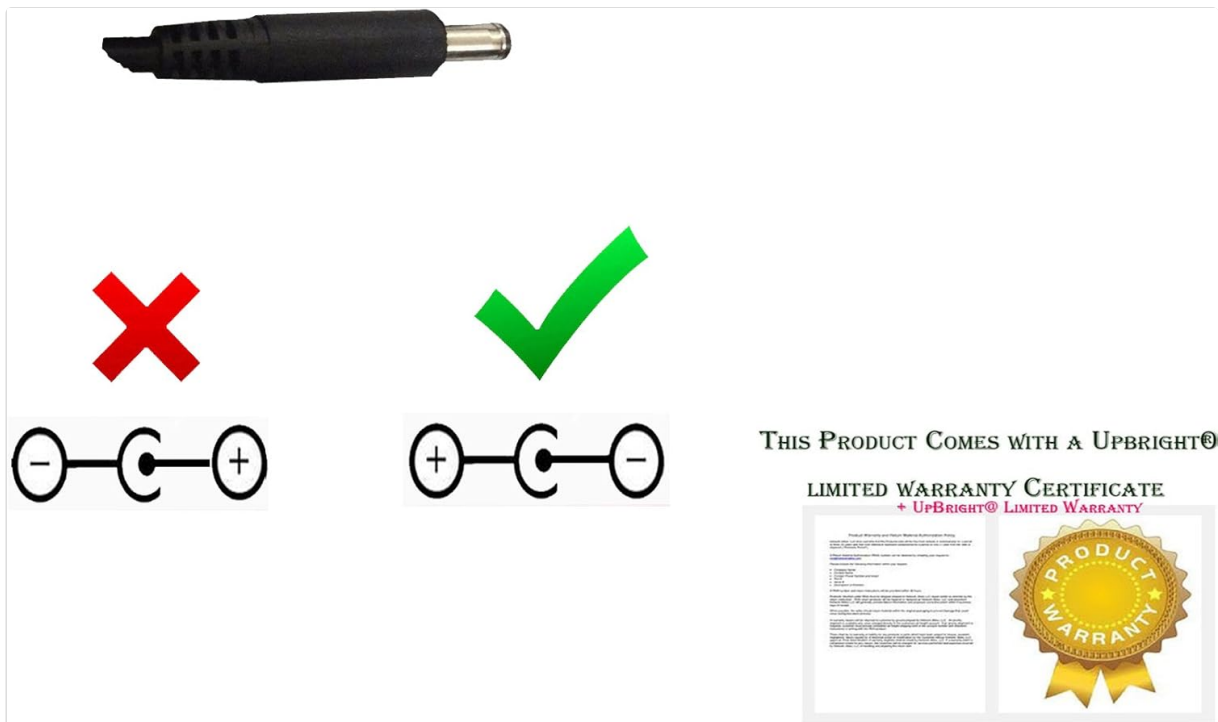

Figure 3: Diagram illustrating the correct center negative polarity of the adapter's barrel connector. Ensure your device requires center negative power.

### 3. SETUP INSTRUCTIONS

1. **Verify Compatibility:** Before connecting, confirm that your dartboard model is listed as compatible and requires a 9V DC power input with a center negative barrel connector.
2. **Select Correct Tip:** If your adapter came with multiple tips, choose the one that securely fits your dartboard's power input port.
3. **Connect to Device:** Insert the barrel connector end of the adapter cable into the power input port of your dartboard. Ensure a firm connection.
4. **Connect to Power Outlet:** Plug the AC prongs of the adapter into a standard wall power outlet (100-240VAC, 50/60Hz).
5. **Power On:** Once connected, your dartboard should receive power. Refer to your dartboard's manual for specific power-on procedures.

Always ensure the adapter is easily accessible for disconnection if needed.

### 4. OPERATING GUIDELINES

The UpBright 9V AC/DC Adapter is designed for continuous operation with compatible devices. No specific operational steps are required for the adapter itself beyond proper connection.

- Ensure the adapter is placed in a well-ventilated area to prevent overheating.
- Avoid covering the adapter during use.
- If the dartboard is not in use for an extended period, it is recommended to unplug the adapter from the wall outlet.

## 5. SAFETY FEATURES AND PROTECTIONS

The UpBright 9V AC/DC Adapter is equipped with advanced safety features to protect both the adapter and your connected device:

- **OVP (Over Voltage Output Protection):** Prevents damage to your device from excessive voltage output.
- **OCP (Over Current Output Protection):** Protects against damage caused by excessive current draw.
- **SCP (Short Circuit Output Protection):** Automatically shuts down power in case of a short circuit, preventing damage and fire hazards.
- **Overcharge Protection:** Safeguards against battery overcharging in devices with rechargeable batteries (if applicable).
- **Overheat Protection:** Monitors internal temperature to prevent overheating.
- **Lightning Protection:** Offers a degree of protection against power surges from lightning.



Figure 4: Visual representation of the multiple safety protections integrated into the UpBright AC/DC Adapter, including overcharge, overcurrent, shortage, lightning, overvoltage, and temperature protection.



Figure 5: Diagram highlighting the internal components and various security protection features of the UpBright adapter, such as good heat resistance, VO-Grade fire-retardant materials, and multiple circuit protections.

## 6. PRODUCT SPECIFICATIONS

Feature	Detail
Input Voltage	100-240VAC, 50/60Hz
Output Voltage	9V DC

<b>Output Amperage</b>	Compatible with 0.3A, 0.5A, 0.8A, 1A (300mA, 500mA, 800mA, 1000mA)
<b>Connector Type</b>	Barrel Connector (Center Negative)
<b>Product Dimensions</b>	3 x 3 x 1 inches
<b>Item Weight</b>	3.2 ounces
<b>Color</b>	Black
<b>Special Features</b>	OVP, OCP, SCP Protection, Overcharge, Overheat, Lightning Protection



Figure 6: Side view of the UpBright 9V AC/DC Adapter, showcasing its compact design and the attached power cord.

## 7. TROUBLESHOOTING

- **Device Not Powering On:**
  - Ensure the adapter is fully plugged into both the wall outlet and the device.

- Verify that the wall outlet is functional by testing it with another device.
  - Confirm that the adapter's output voltage (9V DC) and polarity (center negative) match your device's requirements.
  - Check if the correct smart plug tip is used and securely connected.
- **Adapter Feels Warm:**
    - It is normal for power adapters to feel slightly warm during operation.
    - If the adapter becomes excessively hot, immediately unplug it. Ensure it is in a well-ventilated area and not covered. If the issue persists, discontinue use.
- **Intermittent Power:**
    - Check all connections for looseness.
    - Inspect the cable for any visible damage or kinks.

## 8. MAINTENANCE

- **Cleaning:** Disconnect the adapter from power before cleaning. Use a dry, soft cloth to wipe the exterior. Do not use liquid cleaners or solvents.
- **Storage:** Store the adapter in a cool, dry place when not in use. Avoid extreme temperatures and humidity.
- **Cable Care:** Do not bend or crimp the power cable excessively. Avoid placing heavy objects on the cable.

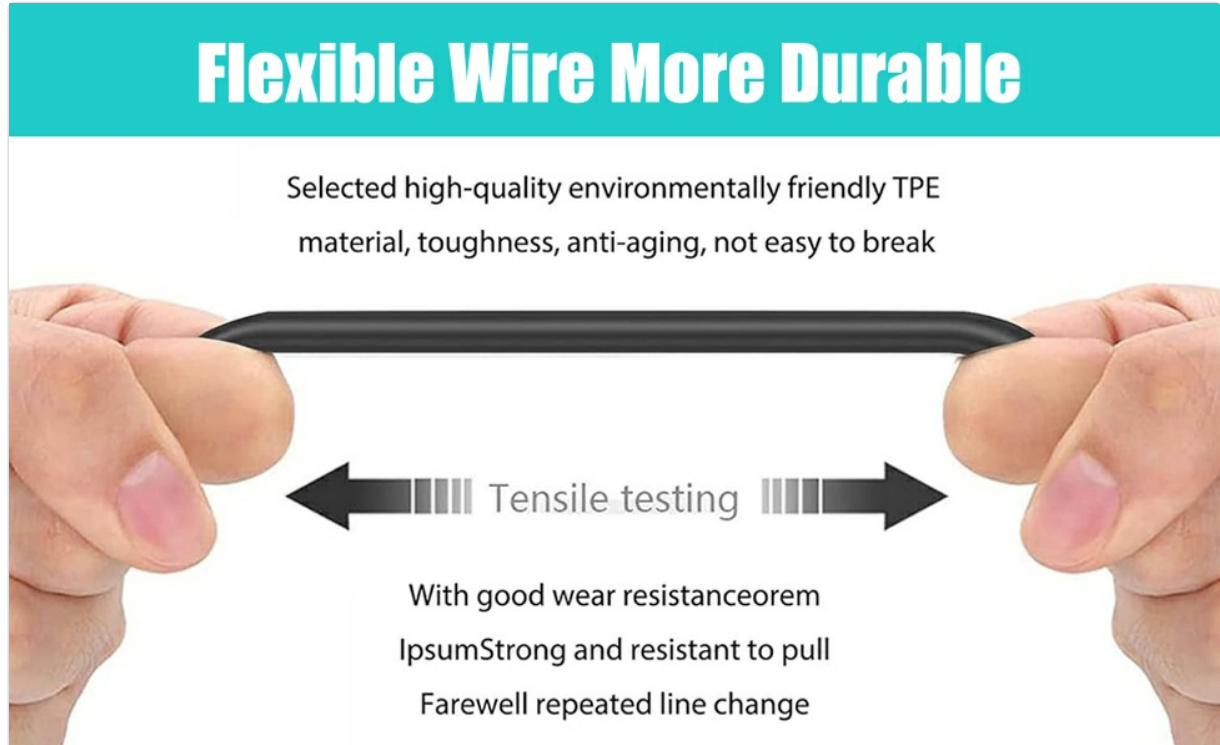

Figure 7: Illustration demonstrating the flexible and durable design of the adapter's cable, made from high-quality TPE material for resistance against wear and aging.

## 9. WARRANTY AND SUPPORT

This UpBright product comes with a limited warranty. Please refer to the warranty certificate included with your purchase for specific terms and conditions.

- **Refund Policy:** UpBright offers a 30-day refund policy from the date of purchase.
- **Exchange Policy:** A 24-month exchange policy is provided for defective units.

For technical support or warranty claims, please contact UpBright customer service through the retailer where the product was purchased or visit the official UpBright website.

## Come With A Suitable Outlet Adapter (Only One) to Fit Your Country/Area For International Order



THIS PRODUCT COMES WITH A UPBRIGHT®

LIMITED WARRANTY CERTIFICATE  
+ UPBRIGHT® LIMITED WARRANTY



Figure 8: Image showing a sample UpBright Limited Warranty Certificate and examples of international outlet adapters (AU, EU, UK) that may be included with international orders.

© 2025 UpBright. All rights reserved.

This manual is for informational purposes only. UpBright reserves the right to make changes to product specifications without prior notice.