

Koso DL-03SR

KOSO DL-03SR GP Style Multifunction Gauge User Manual

MODEL: DL-03SR

1. Introduction

This manual provides detailed instructions for the installation, operation, and maintenance of your KOSO DL-03SR GP Style Multifunction Gauge. Please read this manual thoroughly before installation and use to ensure proper function and safety. Keep this manual for future reference.

2. Safety Information

- Always disconnect the vehicle's battery before performing any electrical work to prevent short circuits and electrical shock.
- Ensure all wiring connections are secure and properly insulated to prevent damage to the gauge or vehicle's electrical system.
- Do not attempt to modify the gauge. Unauthorized modifications can lead to malfunction and void the warranty.
- Consult a qualified technician if you are unsure about any installation steps.
- Ensure the gauge is securely mounted and does not obstruct your view or interfere with vehicle controls.

3. Product Overview and Features

The KOSO DL-03SR GP Style Multifunction Gauge is designed to provide essential vehicle information in a compact and clear display. It integrates multiple functions into a single unit, suitable for various street applications.



Figure 1: Front view of the KOSO DL-03SR GP Style Multifunction Gauge. The display shows current speed (MPH), odometer reading, time, and an RPM bar graph. Indicator lights for turn signals, high beam, engine check, oil pressure, and neutral are visible at the bottom.

Key Features:

- **Speedometer:** Displays current speed in MPH or KM/H.
- **Tachometer:** Digital bar graph display for engine RPM (x 1000 RPM).
- **Odometer:** Records total distance traveled.
- **Trip Meter:** Measures distance for individual trips.
- **Clock:** Displays current time.
- **Voltmeter:** Monitors vehicle battery voltage with a 4-level display.
- **Voltage Warning:** Flashing warning when voltage is lower than 8V or higher than 18V.
- **Indicator Lights:** Includes indicators for left turn, right turn, high beam, engine check, oil pressure, and neutral gear.
- **Control Buttons:** 'SELECT' and 'ADJUST' buttons for mode selection and settings.

4. Setup and Installation

Proper installation is crucial for the gauge's performance and longevity. It is recommended to have this unit installed by a professional mechanic if you are not familiar with vehicle electrical systems.

4.1 Mounting

Mount the gauge in a location that provides clear visibility to the rider without obstructing the view of the road or interfering with vehicle controls. Ensure the mounting bracket (if included) is securely fastened to prevent vibration damage.

4.2 Wiring Connections

Identify the corresponding wires on your vehicle's electrical system. Refer to your vehicle's service manual for specific wiring diagrams. The KOSO DL-03SR typically requires the following connections:

- **Red Wire:** Connect to a constant +12V battery positive source. This maintains the clock and stored settings.
- **Brown Wire:** Connect to a switched +12V ignition positive source. This powers the gauge when the ignition is ON.
- **Black Wire:** Connect to a reliable ground point on the vehicle chassis.
- **Speed Sensor Wire:** Connect to the speed sensor. Follow the sensor's specific installation instructions for optimal calibration.
- **RPM Signal Wire:** Connect to the engine's RPM signal source (e.g., ignition coil, ECU signal).
- **Indicator Light Wires:** Connect to the respective vehicle indicator light circuits (left turn, right turn, high beam, neutral, oil pressure, engine check).

Use appropriate connectors and ensure all connections are waterproofed and protected from abrasion.

5. Operating Instructions

The DL-03SR gauge features two control buttons, 'SELECT' and 'ADJUST', located on the sides of the unit, for navigating menus and adjusting settings.

5.1 Basic Display Modes

Upon powering on, the gauge will typically display speed, RPM, and odometer. Press the 'SELECT' button to cycle through different display modes, such as trip meter, clock, or other available functions.

5.2 Setting the Clock

1. Enter the clock setting mode (usually by holding 'SELECT' or 'ADJUST' for a few seconds, or cycling through modes).
2. Use the 'ADJUST' button to change the hour value.
3. Press 'SELECT' to move to the minute value.
4. Use 'ADJUST' to change the minute value.
5. Press 'SELECT' again to save and exit the clock setting mode.

5.3 Unit Selection (MPH/KM/H)

The gauge allows selection between Miles Per Hour (MPH) and Kilometers Per Hour (KM/H). This setting is usually accessed through a dedicated setup menu. Refer to the detailed wiring diagram and setup guide provided with your product for exact steps, as procedures may vary slightly.

5.4 Voltmeter Display and Warning

The voltmeter displays battery voltage in 4 levels:

- **Level 1 (Low):** DC 11.6 ~ 12.0V
- **Level 2:** DC 12.1 ~ 12.5V
- **Level 3:** DC 12.6 ~ 13.0V
- **Level 4 (High):** DC 13.1V and above

A flashing warning will activate if the voltage drops below 8V or rises above 18V, indicating a potential issue with the vehicle's charging system.

6. Maintenance

The KOSO DL-03SR gauge is designed for durability and requires minimal maintenance.

- **Cleaning:** Use a soft, damp cloth to clean the display and housing. Avoid abrasive cleaners or solvents that could damage the plastic or screen.
- **Connection Check:** Periodically inspect all wiring connections to ensure they remain secure and free from corrosion.
- **Environmental Protection:** While designed for outdoor use, prolonged exposure to extreme weather conditions (e.g., direct sunlight, heavy rain) can affect the lifespan of the unit.

7. Troubleshooting

If you encounter issues with your DL-03SR gauge, perform the following basic checks:

- **No Display/Power:**
 - Check the main power (Red wire) and ignition power (Brown wire) connections for continuity and proper voltage.
 - Verify the ground connection (Black wire) is secure.
 - Check for blown fuses in the vehicle's electrical system.
- **Inaccurate Speed/RPM Reading:**
 - Ensure the speed sensor and RPM signal wires are correctly connected and not damaged.
 - Verify the calibration settings for speed and RPM are correct according to your vehicle's specifications (e.g., wheel circumference, number of ignition pulses).
- **Indicator Lights Not Working:**
 - Check the wiring connections for the specific indicator light.
 - Ensure the vehicle's original indicator light circuit is functioning correctly.
- **Flashing Voltage Warning:**
 - Indicates vehicle voltage is outside the 8V-18V range. Check the vehicle's battery and charging system (alternator/stator).

If troubleshooting steps do not resolve the issue, contact KOSO customer support or your dealer for further assistance.

8. Specifications



Feature	Specification
Model Number	BB642W20
Dimensions (L x W x H)	4.1 x 8.2 x 3.05 inches
Item Weight	8.5 ounces (0.53 Pounds)
Material	Metal, Plastic, Glass
Voltmeter Display Range	4 levels (DC 11.6V to 13.1V+)
Voltage Warning Range	Below 8V or Above 18V
Manufacturer	KOSO

9. Warranty and Support

For warranty information, please refer to the documentation provided at the time of purchase or contact your authorized KOSO dealer. Warranty terms and conditions may vary by region and retailer.

For technical support, product inquiries, or assistance with installation and troubleshooting beyond this manual, please contact KOSO customer service through their official website or your product retailer.

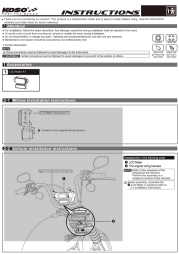
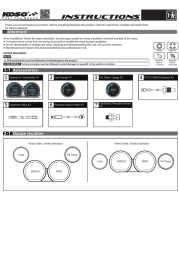
Related Documents - DL-03SR

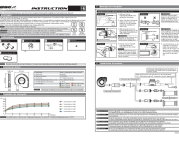
	<p>KOSO D2 LCD Meter Installation and Operation Manual</p> <p>Comprehensive instructions for installing and operating the KOSO D2 LCD Meter, covering wiring, vehicle installation, overview of features, settings, and troubleshooting.</p>
	<p>KOSO HD-03L Gauge Kit Installation and Operation Manual</p> <p>This manual provides detailed instructions for installing, operating, and configuring the KOSO HD-03L 4-piece gauge kit for Harley Davidson motorcycles. It covers accessories, disassembly, wiring, gauge overview, settings, and troubleshooting.</p>
	<p>KOSO Gauge 14-23 Road Glide Bezel Template and Installation Guide</p> <p>Download the KOSO Gauge 14-23 Road Glide bezel template. This guide provides instructions for printing, cutting, and marking holes for installation on your Road Glide motorcycle.</p>
	<p>KOSO Heated Grips Installation and Operation Manual</p> <p>Comprehensive guide for installing and operating KOSO heated grips for motorcycles. Includes technical specifications, mounting instructions, electrical connections, and troubleshooting.</p>

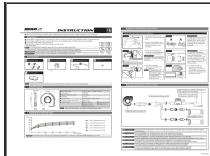

[KOSO Heated Grips Installation and Operation Manual](#)

Comprehensive instruction manual for KOSO heated grips, covering installation, specifications, function settings, low-voltage mode, and troubleshooting. Ensure safe and proper use of your KOSO heated grips.

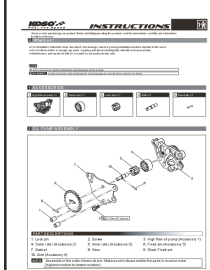

[KOSO High Flow Oil Pump Instructions and Performance Data](#)

Detailed instructions for installing the KOSO High Flow Oil Pump, including parts list, assembly guide, and a performance comparison chart showing increased oil flow.