



[Manuals.plus](#) /

> [UPBRIGHT](#) /

> UPBRIGHT 12V AC/DC Adapter Instruction Manual for Zebra ZQ500, ZQ510, ZQ520, ZQ521 Printers

UPBRIGHT ZQ500 ZQ510 ZQ520 ZQ521

UPBRIGHT 12V AC/DC Adapter Instruction Manual

FOR ZEBRA ZQ500, ZQ510, ZQ520, ZQ521 SERIES MOBILE PRINTERS

Introduction

This manual provides essential instructions for the safe and effective use of your UPBRIGHT 12V AC/DC Adapter. This power supply is designed for compatibility with Zebra ZQ500, ZQ510, ZQ520, and ZQ521 series mobile printers. Please read this manual thoroughly before use and retain it for future reference.

Safety Information

- Ensure the adapter is used with compatible devices only. Refer to the specifications section for details.
- Do not expose the adapter to water, moisture, or extreme temperatures.
- Avoid dropping or subjecting the adapter to severe impact.
- Disconnect the power supply from the outlet when not in use for extended periods.
- Do not attempt to open or repair the adapter. Refer to qualified service personnel.
- The adapter features Over Voltage Protection (OVP), Over Current Protection (OCP), and Short Circuit Protection (SCP) for enhanced safety.

UpBright 12V AC/DC Adapter Power Supply Charging Replacement for

Zebra ZQ500 ZQ510 ZQ520 ZQ521 Mobile Printer



Proven electronics Components



Mature power scheme



Strong heat dissipation



Multiple protection functions

Image Description: This diagram visually represents the internal security features of the AC adapter, highlighting its robust design for safe operation. It shows icons for heat resistance, fire-retardant materials, and various electrical protections.

Setup Instructions

1. **Unpack the Adapter:** Carefully remove the AC adapter and power cord from its packaging.
2. **Connect the AC Power Cord:** Insert the AC power cord into the AC adapter's input port. Ensure a secure connection.
3. **Connect to Power Outlet:** Plug the AC power cord into a standard electrical wall outlet (100-240VAC, 50/60Hz).
4. **Connect to Printer:** Insert the DC output barrel connector of the adapter into the DC input port of your Zebra ZQ500, ZQ510, ZQ520, or ZQ521 mobile printer.
5. **Verify Connection:** Ensure all connections are firm before powering on the printer.

Security Protection

Multiple professional protection, so that fast
Charge more safe



Good heat
Resistance



VO-Grade
Fire-Retardant



Overcharge
Protection



Overvoltage
Protection



Overheat
Protection



Overcurrent
Protection

Image Description: This diagram illustrates the correct connection sequence for the AC adapter. It shows the AC power cord connecting to the adapter, and the adapter's DC output connecting to the printer's DC input port.



Image Description: This image displays two models from the Zebra ZQ500 series mobile printers, which are compatible with this AC adapter. It provides a visual reference for the devices the adapter is designed to power.

Operating Instructions

Once the adapter is correctly connected to both the power outlet and your Zebra mobile printer, the printer should begin to charge or operate directly from the power supply. No additional steps are required for the adapter's operation beyond proper connection.

- The adapter is designed for continuous operation within its specified voltage and current limits.
- Monitor the printer's charging indicator to confirm power delivery.

Care and Maintenance

- **Cleaning:** Use a soft, dry cloth to clean the adapter. Do not use liquid cleaners or aerosols.

- **Storage:** Store the adapter in a cool, dry place away from direct sunlight and extreme temperatures when not in use.
- **Cable Care:** Avoid bending or crimping the power cords excessively. Do not place heavy objects on the cables.
- **Inspection:** Periodically inspect the adapter and cables for any signs of damage, such as frayed wires or cracked casing. Discontinue use if damage is observed.

Troubleshooting

- **No Power to Printer:**
 - Ensure the AC power cord is securely plugged into both the wall outlet and the adapter.
 - Verify the DC barrel connector is fully inserted into the printer's DC input port.
 - Test the wall outlet with another device to confirm it is functional.
 - Check for any visible damage to the adapter or cables.
- **Printer Not Charging:**
 - Confirm the adapter's specifications (12V, 4.16A/4A/5A, 48W/50W) match the printer's power requirements.
 - Ensure the printer's battery is properly installed and not faulty.
- **Adapter Overheating:**
 - Ensure the adapter is in a well-ventilated area and not covered.
 - Verify the printer is compatible and not drawing excessive power.
 - If overheating persists, discontinue use and contact support.

Product Specifications

Feature	Detail
Input Voltage	100-240VAC, 50/60Hz (Worldwide Compatible)
Output Voltage	12V DC
Output Current	4.16A (Max 5A)
Wattage	48W - 50W
Connector Type	Barrel Connector
Protection Features	OVP (Over Voltage Protection), OCP (Over Current Protection), SCP (Short Circuit Protection)
Product Dimensions	6 x 3 x 2 inches
Item Weight	12.3 ounces
Compatible Devices	Zebra ZQ500, ZQ510, ZQ520, ZQ521 Mobile Printers

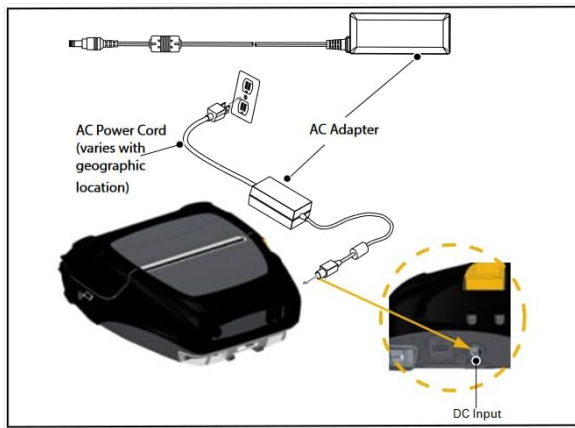

12V AC/DC Adapter Power Supply

Replacement for

Zebra ZQ500 Series Mobile Printer



Image Description: A clear view of the UPBRIGHT 12V AC/DC adapter, including the main power brick, the attached DC output cable with a barrel connector, and the detachable AC input power cord.

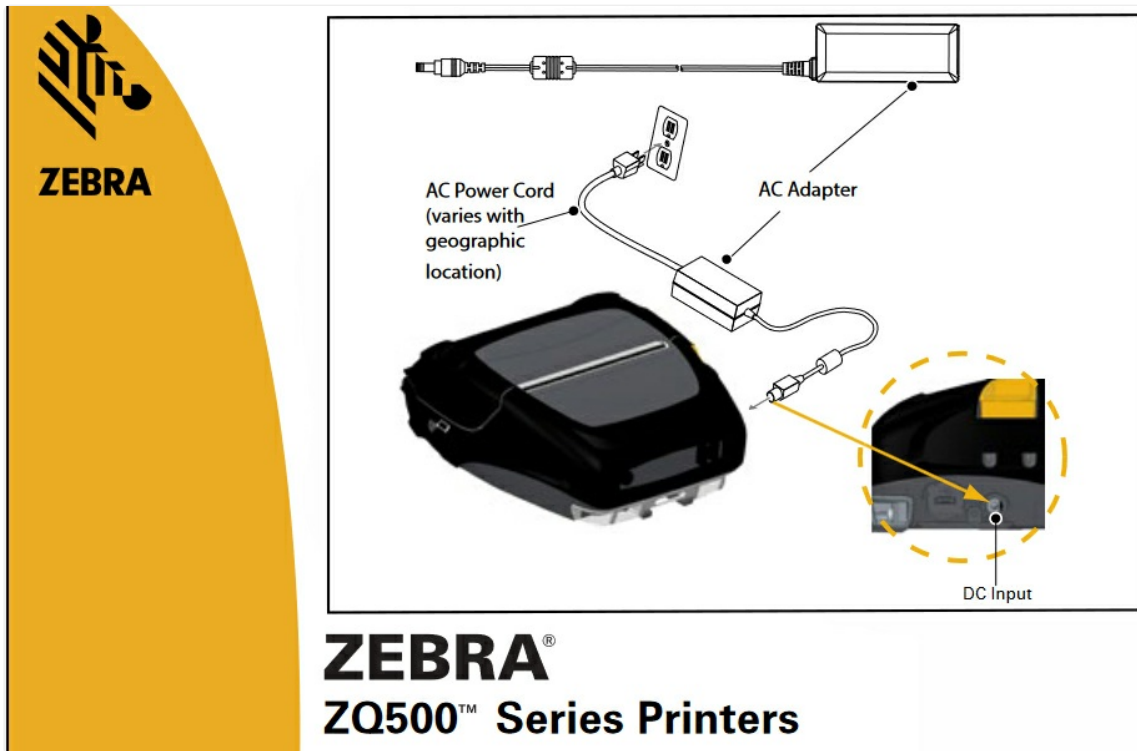

ZEBRA® ZQ500™ Series Printers

Image Description: This image illustrates different types of AC power cords, including US, EU, UK, and AU plugs, along with a common figure-8 connector. This highlights the adapter's global compatibility with various regional power outlets.

Warranty Information

This UPBRIGHT product comes with a limited warranty. Please refer to the following terms:

- **Refund Period:** 30 Days from the date of purchase.
- **Exchange Period:** 24 Months from the date of purchase.

For warranty claims or further details, please contact UPBRIGHT customer support.



Image Description: A visual representation of a product warranty certificate, featuring a golden seal, signifying the product's limited warranty coverage.

Customer Support

For any questions, technical assistance, or support regarding your UPBRIGHT 12V AC/DC Adapter, please visit the official UPBRIGHT store or contact their customer service department.

UPBRIGHT Store: [Visit UPBRIGHT Store on Amazon](#)