

IKRA IHS 600

IKRA IHS 600 Electric Hedge Trimmer User Manual

Model: IHS 600 (43225660)

[Introduction](#) [Safety](#) [Instructions](#) [Components](#) [Setup](#) [Operating](#) [Maintenance](#)
[Troubleshooting](#) [Specifications](#)

1. INTRODUCTION

Thank you for choosing the IKRA IHS 600 Electric Hedge Trimmer. This manual provides essential information for the safe and efficient operation, maintenance, and troubleshooting of your new hedge trimmer. Please read this manual thoroughly before first use and keep it for future reference. The IKRA IHS 600 is designed for trimming and shaping hedges and shrubs in domestic gardens.



Figure 1: Overview of the IKRA IHS 600 Electric Hedge Trimmer.

2. SAFETY INSTRUCTIONS

WARNING: Read all safety warnings and all instructions. Failure to follow the warnings and instructions may result in electric shock, fire, and/or serious injury.

General Safety Rules:

- **Work Area Safety:** Keep the work area clean and well-lit. Cluttered or dark areas invite accidents. Do not operate power tools in explosive atmospheres, such as in the presence of flammable liquids, gases, or dust.
- **Electrical Safety:** Power tool plugs must match the outlet. Never modify the plug in any way. Do not abuse the cord. Never use the cord for carrying, pulling, or unplugging the power tool. Keep cord away from heat, oil, sharp edges, or moving parts.
- **Personal Safety:** Always wear eye protection, hearing protection, and sturdy gloves when operating the hedge trimmer. Do not overreach. Keep proper footing and balance at all times.
- **Hedge Trimmer Use and Care:** Do not force the hedge trimmer. Use the correct hedge trimmer for your application. Disconnect the plug from the power source before making any adjustments, changing accessories, or storing power tools.
- **Maintenance:** Maintain hedge trimmers. Check for misalignment or binding of moving parts, breakage of parts, and any other condition that may affect the hedge trimmer's operation.

Specific Safety Warnings for Hedge Trimmers:

- Keep all parts of the body away from the cutter blade. Do not attempt to remove cut material or hold material to be cut when blades are moving.
- Carry the hedge trimmer by the handle with the cutter blade stopped and taking care not to operate any power switch.
- When transporting or storing the hedge trimmer, always fit the blade cover.
- Ensure the 2-hand safety switch is always engaged during operation.

3. COMPONENTS

Familiarize yourself with the parts of your IKRA IHS 600 Hedge Trimmer:

1. Front Handle with Safety Switch
2. Main Handle with Safety Switch
3. Power Cord
4. Blade
5. Blade Guard (Transparent)
6. Rotary Handle Mechanism
7. Cable Strain Relief



Figure 2: Key components including the transparent blade guard.

4. SETUP

Before operating the hedge trimmer, ensure it is properly set up and all safety measures are in place.

4.1 Unpacking:

- Carefully remove the hedge trimmer and all accessories from the packaging.
- Check for any damage that may have occurred during transit. Do not use a damaged tool.
- Ensure all listed components (including the protective case and this manual) are present.

4.2 Power Connection:

- The hedge trimmer operates on 230V AC power. Ensure your power supply matches this requirement.
- Always use an outdoor-rated extension cord that is suitable for the power rating of the hedge trimmer and is in good condition.
- Secure the extension cord to the cable strain relief on the hedge trimmer to prevent accidental disconnection during operation.

4.3 Blade Guard:

- The hedge trimmer comes with a front blade guard for added protection. Ensure it is securely in place before starting the tool.

5. OPERATING THE HEDGE TRIMMER

Follow these steps for safe and effective operation of your IKRA IHS 600 Hedge Trimmer.

5.1 Starting and Stopping:

- To start the hedge trimmer, you must simultaneously press both the front handle safety switch and the main handle safety switch.

- Release either switch to stop the hedge trimmer. The electric quick-stop feature will rapidly halt the blades.

5.2 Rotary Handle Function:

- The 180° rotary handle allows for comfortable vertical and horizontal cutting.
- To rotate the handle, ensure the tool is switched off and unplugged. Press the handle release button (if present, refer to diagram on tool) and rotate the handle to the desired position (0°, 45°, 90°). Ensure it clicks securely into place before resuming operation.

5.3 Cutting Techniques:

- **Horizontal Cutting:** Hold the hedge trimmer with both hands, keeping the blade parallel to the top of the hedge. Move steadily along the hedge, allowing the blades to cut through the branches.
- **Vertical Cutting:** Rotate the handle to the appropriate angle (45° or 90°). Move the hedge trimmer in an arc, sweeping upwards or downwards along the side of the hedge.
- Avoid cutting branches thicker than the 20mm tooth spacing. For thicker branches, use pruning shears.



Figure 3: Demonstrating the hedge trimmer in use for trimming.

6. MAINTENANCE

Regular maintenance ensures the longevity and optimal performance of your hedge trimmer.

6.1 Cleaning:

- Always unplug the hedge trimmer before cleaning.

- Remove debris from the blades and housing using a stiff brush or cloth.
- Do not use water or harsh chemicals to clean the electrical components.

6.2 Blade Care:

- After each use, clean the blades and apply a light coat of machine oil or blade lubricant to prevent rust and ensure smooth operation.
- If the blades become dull, they can be sharpened by a qualified service technician. Do not attempt to sharpen them yourself unless you have the proper tools and expertise.

6.3 Storage:

- Always fit the protective blade cover before storing the hedge trimmer.
- Store the hedge trimmer in a dry, secure place, out of reach of children.
- Avoid storing in direct sunlight or extreme temperatures.

7. TROUBLESHOOTING

This section addresses common issues you might encounter with your hedge trimmer.

Problem	Possible Cause	Solution
Hedge trimmer does not start.	No power supply. Safety switches not engaged. Power cord damaged.	Check power outlet and extension cord. Ensure both safety switches are pressed simultaneously. Inspect cord for damage; replace if necessary.
Blades are not cutting effectively.	Dull blades. Debris caught in blades. Cutting material too thick.	Have blades sharpened. Unplug and clear debris. Do not cut branches thicker than 20mm.
Excessive vibration or noise.	Loose components. Damaged blade. Motor issue.	Check for loose screws and tighten. Inspect blade for damage; replace if necessary. Contact customer support.

If you encounter issues not listed here or if solutions do not resolve the problem, please contact IKRA customer support.

8. TECHNICAL SPECIFICATIONS



Feature	Specification
Model Number	IHS 600 (43225660)

Feature	Specification
Manufacturer	IKRA
Power Source	AC/DC
Voltage	230 Volts
Electric Power	600 Watts
Cutting Length	55 cm
Tooth Spacing / Opening	20 mm
Handle Type	180° Rotary Handle
Blade Material	Hardened Aluminum
Product Dimensions (L x W x H)	112 x 21 x 26 cm
Product Weight	3.2 kg
Sound Level	99 dB
Included Components	1x Instruction Manual, 1x Protective Case

9. WARRANTY AND SUPPORT

IKRA products are manufactured to high-quality standards and undergo strict quality controls. The warranty period is subject to the terms and conditions provided at the point of purchase and applicable local laws. For warranty claims, technical support, or spare parts, please contact your authorized IKRA dealer or visit the official IKRA website for contact information.

Please have your model number (IHS 600) and serial number (if applicable) ready when contacting support.

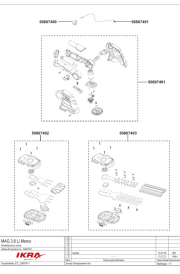
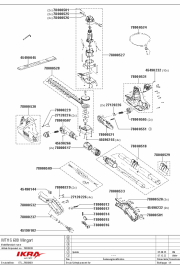
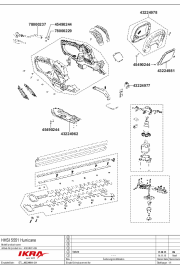
	<p>HHS-I-5555 Hedge Trimmer: User Manual, Safety, and Specifications</p> <p>Official user manual for the Ikra HHS-I-5555 electric hedge trimmer. Includes detailed operating instructions, comprehensive safety warnings, technical specifications, maintenance guide, and warranty information.</p>
	<p>IKRA IAHS 1240 Akku-Heckenschere Bedienungsanleitung</p> <p>Umfassende Bedienungsanleitung für die IKRA IAHS 1240 Akku-Heckenschere. Enthält technische Daten, Sicherheitshinweise, Bedienungsanleitung und Wartungstipps für den privaten Gebrauch.</p>
	<p>IKRA MAG 3.6 Li Merox Hedge Trimmer Parts List & Diagrams (Model 50807411)</p> <p>Detailed exploded view diagrams and parts list for the IKRA MAG 3.6 Li Merox hedge trimmer, model number 50807411. Identify and order replacement parts for your IKRA garden tool.</p>
	<p>IKRA WTHS 600 Wingart Hedge Trimmer Parts List and Diagram</p> <p>Detailed exploded view diagram and comprehensive parts list for the IKRA WTHS 600 Wingart hedge trimmer (model 78000001). Includes all component part numbers for assembly and replacement, with brand information for IKRA.</p>
	<p>IKRA HHSI 5551 Hurricane Hedge Trimmer Parts List and Exploded View Diagram</p> <p>Detailed exploded view diagram and parts list for the IKRA HHSI 5551 Hurricane hedge trimmer, including part numbers and component identification. Features product details and revision history.</p>

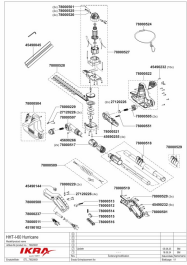

[IKRA HHT-I-60 Hurricane Parts List and Diagram](#)

Exploded view diagram and parts list for the IKRA HHT-I-60 Hurricane hedge trimmer, including part numbers and quantities.