

True TRUE988284

True 988284 Temperature Control Kit 077B6856 Instruction Manual

Model: TRUE988284

1. PRODUCT OVERVIEW

The True 988284 Temperature Control Kit 077B6856 is a genuine Original Equipment Manufacturer (OEM) replacement part designed for True Refrigeration units. This kit ensures the proper regulation of temperature within your commercial refrigeration equipment, maintaining optimal operating conditions for safety, reliability, and performance.



Image 1.1: Overview of the True 988284 Temperature Control Kit, showing the control unit, dial, and capillary tube.

Key Features:

- Genuine OEM replacement part for True Refrigeration.
- Designed for safety, reliability, and performance.
- Ensures accurate temperature regulation.
- Approved by the original equipment manufacturer.

2. SAFETY INFORMATION

Important: Read all instructions carefully before installation or operation. Failure to follow these instructions may result in property damage, personal injury, or death.

- **Electrical Hazard:** Always disconnect power to the refrigeration unit before attempting any installation, maintenance, or repair.
- **Qualified Personnel:** Installation and servicing should only be performed by qualified and authorized service personnel.
- **Genuine Parts:** Use only genuine OEM parts for replacements to ensure compatibility, safety, and optimal performance.
- **Intended Use:** This temperature control kit is intended solely for its specified designed usage within True Refrigeration equipment. Do not use for any other purpose.
- **Capillary Tube:** Handle the capillary tube with care. Do not bend sharply or kink, as this can damage the sensor and affect performance.

3. PACKAGE CONTENTS

Verify that all components are present and undamaged upon opening the package.



Image 3.1: Contents of the True 988284 Temperature Control Kit, typically including the control module, temperature dial, mounting screws, and electrical connectors.

- Temperature Control Module with Capillary Tube
- Temperature Adjustment Dial
- Mounting Screws (typically 2)
- Electrical Connectors (typically 2)
- Instruction Sheet (if included by manufacturer)

4. INSTALLATION INSTRUCTIONS

This section provides general guidance for replacing a temperature control kit. Specific installation steps may vary depending on your True Refrigeration model. Refer to your unit's service manual for detailed, model-specific instructions.

1. **Disconnect Power:** Locate the main power supply to the refrigeration unit and disconnect it. Verify that power is off using a voltage tester.
2. **Access Control Area:** Depending on your unit, you may need to remove access panels or grilles to reach the existing temperature control.
3. **Document Wiring:** Before disconnecting any wires, take clear photos or make a diagram of the existing wiring connections to the old temperature control. Note the position of the capillary tube sensor.
4. **Remove Old Control:**
 - Carefully disconnect the electrical wires from the old control.
 - Unmount the old control from its housing.
 - Gently remove the capillary tube sensor from its sensing location (e.g., evaporator coil, air

return).

5. Install New Control:

- Insert the new capillary tube sensor into the exact same sensing location as the old one. Ensure it is securely positioned for accurate temperature readings. Avoid kinking or damaging the tube.
- Mount the new temperature control module in the same position as the old one using the provided screws.
- Connect the electrical wires to the new control according to your documented wiring diagram. Ensure connections are secure.

6. **Reassemble:** Replace any access panels or grilles that were removed.

7. **Restore Power:** Reconnect the main power supply to the refrigeration unit.

8. **Test Operation:** Allow the unit to run for a period and monitor the temperature to ensure proper operation and temperature regulation. Adjust the dial as needed.

Note: If you are unsure about any step, consult a qualified refrigeration technician.

5. OPERATING INSTRUCTIONS

The temperature control kit features a rotary dial for adjusting the desired temperature within your True Refrigeration unit.

- **Temperature Adjustment:** Rotate the dial to select the desired temperature setting. Typically, rotating towards "Colder" or higher numbers (e.g., 6, 7, 8) will decrease the temperature, while rotating towards "Warmer" or lower numbers (e.g., 1, 2, 3) will increase it.
- **Monitoring:** After adjusting the setting, allow several hours for the refrigeration unit to stabilize at the new temperature. Use an independent thermometer to verify the internal temperature.
- **Optimal Setting:** The optimal setting will depend on the specific refrigeration unit and the products being stored. Adjust incrementally until the desired temperature range is consistently maintained.

6. MAINTENANCE

The True 988284 Temperature Control Kit is designed for durability and reliability. Regular maintenance of the overall refrigeration unit is crucial for its longevity and efficient operation.

- **Periodic Inspection:** Periodically inspect the control module and its wiring for any signs of wear, corrosion, or loose connections.
- **Capillary Tube:** Ensure the capillary tube remains securely in its sensing location and is not damaged or kinked.
- **Cleaning:** Keep the area around the temperature control free from dust and debris. Use a soft, dry cloth for cleaning. Do not use harsh chemicals or abrasive cleaners.
- **Professional Check:** Consider annual professional maintenance checks for your refrigeration unit, which should include inspection of the temperature control system.

7. TROUBLESHOOTING

If your refrigeration unit is experiencing temperature issues after installing this kit, consider the following common troubleshooting steps:

Problem	Possible Cause	Solution
Unit not cooling or too warm	Temperature dial set too high (warmer)	Adjust dial to a colder setting.
	Capillary tube not properly seated or damaged	Verify capillary tube placement and condition.
	Loose electrical connection	Check and secure all wiring connections (with power disconnected).
	Other refrigeration system issues (e.g., low refrigerant, dirty condenser)	Consult a qualified technician for system diagnosis.
Unit freezing contents or too cold	Temperature dial set too low (colder)	Adjust dial to a warmer setting.
	Capillary tube sensing incorrect temperature (e.g., too close to evaporator)	Ensure capillary tube is correctly positioned away from direct evaporator contact if applicable.
	Control unit malfunction	If issues persist, the control unit may require replacement or further diagnosis by a technician.
Temperature fluctuates widely	Improper capillary tube placement	Verify capillary tube placement.
	Control unit malfunction	Consult a qualified technician for diagnosis.
	Refrigeration system issues	

Warning: Do not attempt repairs beyond your technical capabilities. Always prioritize safety and consult a professional for complex issues.

8. SPECIFICATIONS

Feature	Detail
Brand	True
Model Number	TRUE988284
Product Dimensions	6 x 6 x 4 inches
Item Weight	4.8 ounces
Operation Mode	Automatic
Contact Type	Normally Open
Connector Type	Screw Terminals
Terminal	Screw
Circuit Type	1-way
Mounting Type	Surface Mount
Actuator Type	Push Button
Contact Material	Copper, Brass
Date First Available	June 15, 2011

9. WARRANTY AND SUPPORT

As a genuine OEM part, this True 988284 Temperature Control Kit is manufactured to high standards. For specific warranty information, please refer to the documentation provided with your original True Refrigeration unit or contact True Refrigeration directly.



Customer Support:

For technical assistance, troubleshooting beyond this manual, or to inquire about warranty claims, please contact True Refrigeration customer support or an authorized service provider.

- **Manufacturer:** True
- **Website:** www.truemfg.com
- **Model Number:** TRUE988284
- **Part Number:** 988284, 077B6856

© 2025 True Refrigeration. All rights reserved. Information subject to change without notice.

Related Documents - TRUE988284

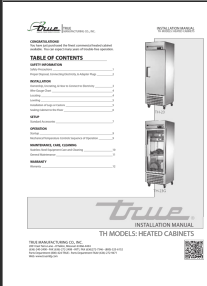
	<p>True Heated Cabinets Installation Manual: STR, STA, STG Series</p> <p>Comprehensive installation, setup, operation, maintenance, and warranty guide for True STR, STA, and STG Series commercial heated cabinets. Covers electrical connections, leveling, door adjustments, electronic controls, and care instructions.</p>
	<p>True Spec Series STR, STA, STG Installation Manual</p> <p>Installation, setup, operation, and maintenance guide for True Spec Series STR, STA, and STG commercial refrigerators and freezers by True Manufacturing Co., Inc.</p>
	<p>True TH Models Heated Cabinets Installation Manual</p> <p>Comprehensive installation, operation, and maintenance guide for True TH Models heated cabinets. Covers safety, electrical, setup, care, and warranty information from True Manufacturing Co., Inc.</p>

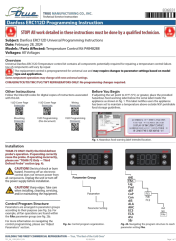

[Danfoss ERC112D Programming Instruction Manual for True Refrigeration](#)

Comprehensive programming instructions for the Danfoss ERC112D temperature control kit used in True Manufacturing commercial refrigeration units. Includes parameter adjustments, set point configuration, and troubleshooting guidance.

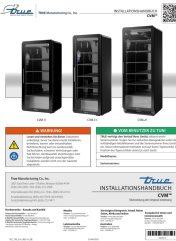

[True CVM Series Installation Manual](#)

Comprehensive installation, operation, and maintenance manual for True CVM series refrigeration units. Covers safety precautions, electrical requirements, installation procedures, leveling, sealing, shelf mounting, and general maintenance.



[True T-Series Freezer/Refrigerator Installation and Operation Manual](#)

Comprehensive installation, operation, maintenance, and troubleshooting guide for True T-Series commercial freezers and refrigerators with swing and slide doors. Covers electrical connections, leveling, component replacement, and warranty information.