

## CubicFun C705H

# CubicFun C705H Eiffel Tower 3D Puzzle Instruction Manual

Model: C705H

## INTRODUCTION

---

This instruction manual provides comprehensive guidance for the assembly and care of your CubicFun C705H Eiffel Tower 3D Puzzle. This model is designed for an engaging building experience, requiring no glue or scissors for assembly. Please read all instructions carefully before beginning.



*Image: The fully assembled CubicFun C705H Eiffel Tower 3D Puzzle, showcasing its intricate silver design.*

## SAFETY INFORMATION

---

**Warning: Small parts. Not suitable for children under 3 years due to choking hazard.**

Adult supervision is recommended during assembly, especially for younger users. Keep all packaging materials away from children.

## PACKAGE CONTENTS

---

Before starting, please verify that all components are present:

- Pre-cut puzzle sheets (various pieces for the Eiffel Tower structure)
- Instruction booklet with detailed diagrams



Image: The product packaging for the CubicFun C705H Eiffel Tower 3D Puzzle, showing the item number C705H and indicating 33 pieces.

## ASSEMBLY INSTRUCTIONS

Follow these steps carefully to assemble your Eiffel Tower 3D Puzzle. No tools, glue, or scissors are

required.

1. **Preparation:** Unpack all puzzle sheets and the instruction booklet. Familiarize yourself with the different components and the overall structure by reviewing the diagrams.
2. **Punching Out Pieces:** Carefully punch out each puzzle piece from its sheet. Be gentle to avoid tearing or damaging the pieces.
3. **Follow Diagrams:** Refer to the numbered steps and corresponding diagrams in the instruction booklet. Each piece is typically numbered or shaped to fit a specific location.
4. **Interlocking:** Connect the pieces by interlocking the tabs and slots. Ensure each connection is secure and flush. Do not force pieces if they do not fit; recheck the diagram and piece orientation.
5. **Building Layers:** Assemble the puzzle layer by layer, typically starting from the base and working upwards, as indicated in the instructions.
6. **Final Touches:** Once all pieces are assembled, ensure the structure is stable and all connections are firm.

Estimated assembly time: 60-100 minutes.

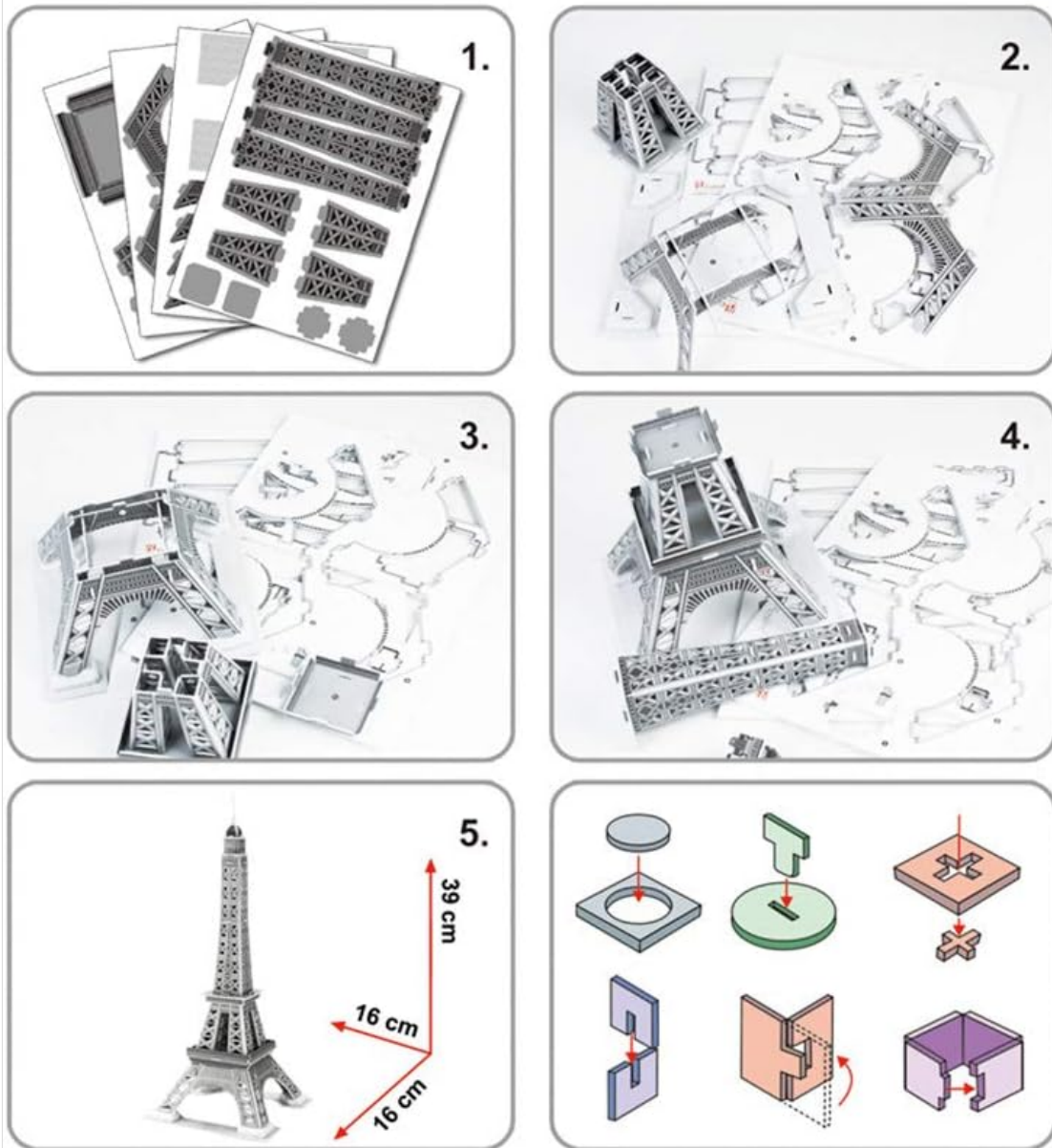

Image: A visual guide showing five key steps of the assembly process, from punching out pieces to interlocking them, and a diagram of the assembled model with dimensions.



Image: An open instruction booklet displaying detailed assembly diagrams and historical information about the Eiffel Tower.

## MAINTENANCE

To ensure the longevity and appearance of your CubicFun Eiffel Tower 3D Puzzle:

- **Cleaning:** Gently dust the model with a soft, dry cloth. Avoid using liquids or abrasive cleaners.
- **Storage:** Keep the assembled model in a dry environment, away from direct sunlight, extreme temperatures, and high humidity, which can cause warping or fading.
- **Handling:** Handle the puzzle with care to prevent pieces from detaching or bending.

## TROUBLESHOOTING

- **Pieces not fitting:** Double-check the instruction diagrams to ensure you are using the correct pieces and that they are oriented correctly. Do not force pieces together, as this may cause damage.
- **Model instability:** Review all connections to ensure every tab is fully inserted into its corresponding slot. Sometimes a slight adjustment can significantly improve stability.
- **Missing pieces:** Carefully check all packaging and surrounding areas. If a piece is genuinely missing, contact CubicFun customer support for assistance.

## SPECIFICATIONS

Model Number	C705H
Brand	CubicFun
Number of Pieces	33



<b>Assembled Dimensions (L x W x H)</b>	16 cm x 16 cm x 39 cm (approximately 6.3 x 6.3 x 15.3 inches)
<b>Item Weight</b>	1 pound
<b>Recommended Age</b>	5 years and up
<b>Material</b>	Paper and EPS foam core
<b>Assembly Time</b>	60-100 minutes



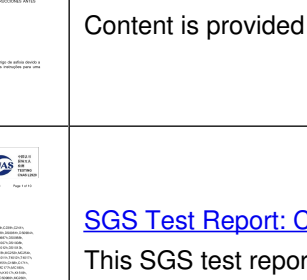
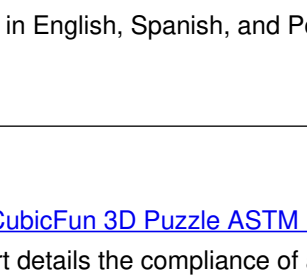
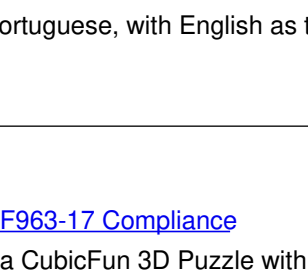

*Image: The product box displaying the assembled Eiffel Tower model alongside its approximate dimensions: 16 cm base and 39 cm height.*

## WARRANTY AND SUPPORT

CubicFun is committed to providing quality products. While specific warranty details are not provided in this manual, for any product-related inquiries, missing parts, or support, please contact CubicFun customer service directly.

You may also visit the official CubicFun store for more information: [CubicFun Store](#)

## Related Documents - C705H

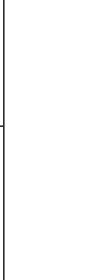
 <p>Modelo/Style L521h</p> <p>18 pieces of Tiles      18 piezas de Azulejos      18 Teile aus Keramik      18 peças de cerâmica</p> <p>18 pieces of Tiles      18 piezas de Azulejos      18 Teile aus Keramik      18 peças de cerâmica</p>	<p><a href="#">Titanic 3D Puzzle L521h - Assembly and Safety Information</a></p> <p>Detailed information for the L521h Titanic 3D Puzzle, including age recommendations, dimensions, piece count, battery requirements, and crucial safety warnings for assembly and battery usage. Content is provided in English, Spanish, and Portuguese, with English as the primary language.</p>
 <p>SGS Test Report</p> <p>SGS Test Report</p>	<p><a href="#">SGS Test Report: CubicFun 3D Puzzle ASTM F963-17 Compliance</a></p> <p>This SGS test report details the compliance of a CubicFun 3D Puzzle with the ASTM F963-17 Standard Consumer Safety Specification for Toy Safety, including tests for flammability, heavy elements, and soluble heavy metals.</p>
 <p>SGS Test Report</p> <p>SGS Test Report</p>	<p><a href="#">SGS Test Report: CubicFun 3D Puzzles - Lead and Phthalate Compliance</a></p> <p>Official SGS test report detailing the compliance of CubicFun 3D Puzzles with US CPSIA and California Proposition 65 standards for lead and phthalates. Results indicate compliance.</p>
 <p>Modelo/Style DS0990h</p> <p>Neuschwanstein Castle      DS0990h      18 x 18 x 18 cm (7" x 7" x 7")      18 x 18 x 18 cm (7" x 7" x 7")      18 x 18 x 18 cm (7" x 7" x 7")      18 x 18 x 18 cm (7" x 7" x 7")</p> <p>Neuschwanstein Castle      DS0990h      18 x 18 x 18 cm (7" x 7" x 7")      18 x 18 x 18 cm (7" x 7" x 7")      18 x 18 x 18 cm (7" x 7" x 7")      18 x 18 x 18 cm (7" x 7" x 7")</p>	<p><a href="#">Neuschwanstein Castle 3D Puzzle DS0990h - Product Information</a></p> <p>Detailed information for the Neuschwanstein Castle 3D Puzzle, model DS0990h. Includes safety warnings, dimensions, and manufacturer details in English, Spanish, and Portuguese.</p>
 <p>CubicFun      2021 CATALOGUE</p>	<p><a href="#">CubicFun 2021 Catalogue: 3D Puzzles</a></p> <p>Explore the CubicFun 2021 catalogue featuring a wide range of 3D puzzles, including Harry Potter licensed models, National Geographic landmarks, and various cityscapes. Discover detailed model information and product codes.</p>
 <p>CubicFun      2023 CATALOGUE</p>	<p><a href="#">CubicFun 2023 Catalogue: 3D Puzzles of Landmarks, Vehicles, and More</a></p> <p>Explore the CubicFun 2023 Catalogue featuring a wide range of 3D puzzles, including iconic landmarks from National Geographic, historical ships, vehicles, dinosaurs, and dollhouses. Discover detailed models with precise dimensions and piece counts.</p>



