

Open Trail HML-BC236 COMBO

Open Trail LED Light Bar 7.5" HML-BC236 COMBO User Manual

Model: HML-BC236 COMBO | Brand: Open Trail

1. INTRODUCTION

Thank you for choosing the Open Trail HML-BC236 COMBO 7.5-inch LED Light Bar. This product is designed to provide powerful and efficient auxiliary lighting for your ATV or UTV, enhancing visibility and safety during off-road activities. This manual provides essential information for the proper installation, operation, and maintenance of your new LED light bar.

2. SAFETY INFORMATION

- Always disconnect the vehicle's battery before beginning any electrical installation to prevent electrical shock or short circuits.
- Ensure all wiring connections are secure and properly insulated to prevent moisture ingress and corrosion.
- Mount the light bar securely to prevent it from dislodging during vehicle operation, which could cause injury or damage.
- Verify that the light bar's power draw is compatible with your vehicle's electrical system to avoid overloading.
- Do not look directly into the light bar when it is illuminated, as the intense light can cause eye strain or damage.
- This product may contain chemicals known to the State of California to cause cancer and birth defects or other reproductive harm (California Proposition 65 Warning).

3. PACKAGE CONTENTS

Please inspect the package contents to ensure all components are present and undamaged:

- Open Trail HML-BC236 COMBO 7.5-inch LED Light Bar
- Wiring Harness (with red and black wires)
- Mounting Brackets

- Mounting Hardware (bolts, nuts)
- Hex Wrenches (2)



This image displays the Open Trail HML-BC236 COMBO LED Light Bar along with its complete set of accessories. Visible components include the 7.5-inch LED light bar itself, a bundled wiring harness with red and black wires, mounting brackets, bolts, nuts, and two L-shaped hex wrenches for installation.

4. SETUP AND INSTALLATION

The Open Trail HML-BC236 COMBO LED Light Bar features a universal fit design, making it suitable for various ATV and UTV models. Professional installation is recommended if you are unfamiliar with vehicle electrical systems.

4.1 Mounting the Light Bar

1. Identify a suitable mounting location on your ATV or UTV that provides clear visibility and does not obstruct other vehicle functions.
2. Attach the mounting brackets to the light bar using the provided hardware. Do not fully tighten at this stage.
3. Position the light bar in the desired location and mark the drilling points for the brackets, if necessary.
4. Drill pilot holes if required, then securely fasten the light bar assembly to the vehicle using appropriate hardware.
5. Adjust the angle of the light bar for optimal beam direction, then fully tighten all mounting hardware.

4.2 Wiring Instructions

1. **Disconnect the vehicle's battery.**
2. Connect the red wire from the light bar's wiring harness to a fused 12V positive (+) power source. An inline fuse (not always included, but highly recommended) should be installed as close to the battery

as possible.

3. Connect the black wire from the light bar's wiring harness to a suitable ground (-) point on the vehicle chassis.
4. If using a switch (not always included), wire it between the fused 12V positive source and the light bar's red wire. Ensure the switch is rated for the light bar's current draw.
5. Route all wiring safely, away from moving parts, hot surfaces, and sharp edges. Use zip ties or cable clamps to secure the wiring.
6. Reconnect the vehicle's battery and test the light bar's functionality.

5. OPERATING INSTRUCTIONS

Once properly installed and wired, the Open Trail LED Light Bar is operated via the connected switch. Turn the switch to the 'ON' position to illuminate the light bar and to the 'OFF' position to turn it off. This light bar is intended for off-road use or as auxiliary lighting where permitted by local regulations.

6. MAINTENANCE

The Open Trail LED Light Bar is designed for durability and minimal maintenance. Follow these guidelines to ensure its longevity:

- **Cleaning:** Periodically clean the lens and housing with a soft cloth and mild soap and water. Avoid abrasive cleaners or harsh chemicals that could damage the finish or lens.
- **Inspection:** Regularly check all mounting hardware for tightness and inspect wiring for any signs of wear, fraying, or corrosion.
- **Waterproof Feature:** The light bar is designed to be waterproof. However, avoid directing high-pressure water sprays directly at the seals for extended periods.

7. TROUBLESHOOTING

If you encounter issues with your LED light bar, refer to the following troubleshooting steps:

- **Light Bar Does Not Turn On:**
 - Check the fuse in the wiring harness. Replace if blown.
 - Verify all electrical connections are secure and free of corrosion.
 - Ensure the switch (if used) is functioning correctly.
 - Confirm the vehicle battery has sufficient charge.
- **Light Bar is Dim or Flickering:**
 - Check for loose or corroded connections, especially the ground wire.
 - Ensure the vehicle's charging system is operating correctly.
 - Inspect the wiring for any damage or partial breaks.
- **Moisture Inside the Lens:**
 - While the unit is waterproof, extreme temperature changes can sometimes cause condensation. If persistent, inspect seals for damage.

If these steps do not resolve the issue, please contact Open Trail customer support.

8. SPECIFICATIONS

Feature	Specification
Brand	Open Trail
Model	HML-BC236 COMBO
Light Source Type	LED
Vehicle Service Type	ATV, UTV
Special Feature	Waterproof
Item Dimensions (L x W x H)	1 x 1 x 1 inches (Product dimensions may vary slightly)
Item Weight	4.64 pounds
UPC	191361148866
Manufacturer Part Number	12-9000
Color	Black

9. WARRANTY AND SUPPORT

For warranty information, technical support, or replacement parts, please contact Open Trail directly or the authorized dealer from whom you purchased the product. Keep your purchase receipt as proof of purchase.

Manufacturer: OPEN TRAIL

Related Documents - HML-BC236 COMBO





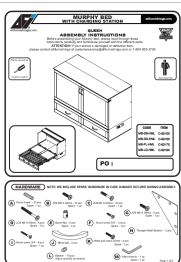

[SuperATV Rear Brush Guard Installation Instructions for Can-Am Maverick Trail](#)

Detailed installation guide for the SuperATV Rear Brush Guard designed for the Can-Am Maverick Trail. Includes step-by-step instructions, liability information, and contact details.

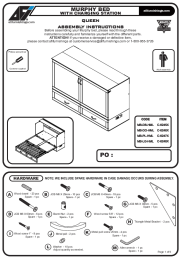

[AFI Furnishings Queen Murphy Bed with Charging Station Assembly Instructions](#)

Comprehensive assembly guide for the AFI Furnishings Queen Murphy Bed with Charging Station, detailing parts, hardware, and step-by-step instructions for safe and proper installation.

	<p>AFI Furnishings Queen Murphy Bed with Charging Station Assembly Instructions</p> <p>Comprehensive assembly guide for the AFI Furnishings Queen Murphy Bed with Charging Station. Includes detailed steps, parts list, hardware inventory, and important safety recommendations.</p>
	<p>SuperATV Flip Down Windshield Installation Instructions for Polaris RZR Trail / S</p> <p>Detailed installation guide for the SuperATV Flip Down Windshield designed for Polaris RZR Trail and S models. Includes parts list, cleaning instructions, and important safety and liability information.</p>
	<p>Falcon Ridge Yamaha Wolverine Soft Door Rear Window Combo Installation Guide</p> <p>Comprehensive installation and care instructions for the Falcon Ridge Soft Door Rear Window Combo (YA-WOLVERINE-DRW01) designed for the Yamaha Wolverine. Includes a detailed parts list, step-by-step assembly guide, cleaning and storage recommendations, return policy, and warranty information.</p>
	<p>SuperATV Glass Windshield Installation Instructions for Can-Am Maverick Trail</p> <p>Step-by-step installation guide for the SuperATV Glass Windshield designed for the Can-Am Maverick Trail. Includes parts list, liability statement, and mounting instructions.</p>