

Manuals+

[Q & A](#) | [Deep Search](#) | [Upload](#)

manuals.plus /

- › [VEMER](#) /
- › [VEMER THALOS KEY Wall Thermostat User Manual](#)

VEMER VE720900

VEMER THALOS KEY Wall Thermostat User Manual

Model: VE720900

INTRODUCTION

This manual provides comprehensive instructions for the installation, operation, and maintenance of your VEMER THALOS KEY Wall Thermostat, Model VE720900. Please read this manual carefully before installation and use to ensure proper function and safety.



Figure 1: Front view of the VEMER THALOS KEY Wall Thermostat, displaying a temperature of 23.5 degrees Celsius on its blue backlit LCD screen.

The VEMER THALOS KEY is a wall-mounted thermostat featuring an LCD screen and powered by mains electricity (230V). It is equipped with two physical buttons for intuitive control and a blue backlit display for clear readability. A keypad lock function, secured by a password, is included to prevent unauthorized changes to settings, making it

suitable for various environments, including public spaces.



TERMOSTATO THALOS KEY 230



Figure 2: The VEMER THALOS KEY Thermostat seamlessly integrated into a modern living room environment, showcasing its sleek design.

SETUP

1. Unpacking and Inspection

Carefully remove the thermostat from its packaging. Inspect the device for any signs of damage. The package should contain the VEMER THALOS KEY thermostat and this instruction manual. If any components are missing or damaged, contact your supplier immediately.

2. Mounting the Thermostat

The thermostat is designed for wall mounting. Choose a suitable location away from direct sunlight, drafts, or heat sources that could affect temperature readings. The recommended mounting height is approximately 1.5 meters (5 feet) from the floor.

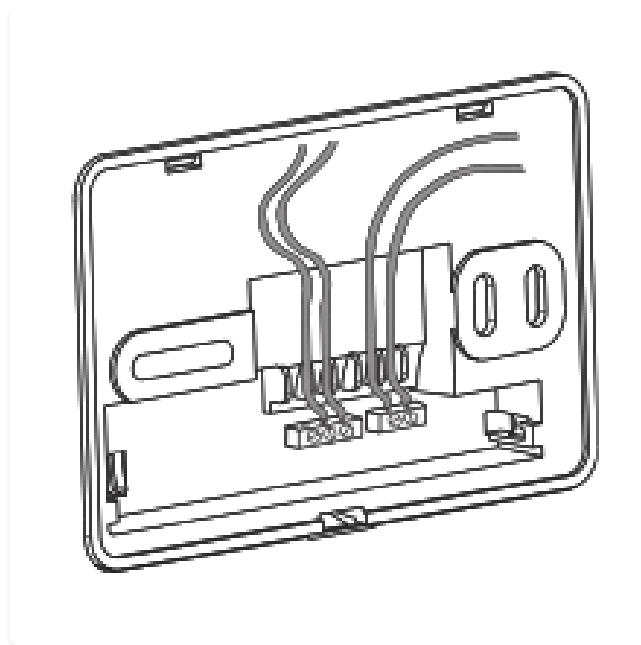

Figure 3: Dimensional diagram of the Thalos Key 230 thermostat, including front view, side view, and a basic wiring schematic, with measurements in millimeters.

Use the provided mounting screws to secure the thermostat base to the wall. Ensure the base is level before tightening the screws.



Figure 4: Illustration demonstrating the correct method for attaching the thermostat's backplate to the wall using two screws.

3. Electrical Wiring

WARNING: Electrical installation should only be performed by a qualified electrician. Disconnect power at the main circuit breaker before beginning any wiring work.

The VEMER THALOS KEY thermostat operates on a 230V mains power supply. Connect the electrical cables to the appropriate terminals on the thermostat's backplate as indicated in the wiring diagram below. Ensure all connections are secure and correctly insulated.



Figure 5: Wiring diagram illustrating the terminal connections for the thermostat, including power input and output to the heating/cooling system.

After wiring, carefully attach the thermostat front panel to the mounted base, ensuring it clicks securely into place.

OPERATING INSTRUCTIONS

1. Powering On

Once wired and mounted, restore power to the thermostat from the main circuit breaker. The LCD display will illuminate, indicating the thermostat is operational.

2. Display and Buttons

The thermostat features a clear LCD display with a blue backlight and two physical buttons (up and down arrows) for setting adjustments.



Figure 6: The thermostat's LCD display with its characteristic blue backlight, enhancing visibility.



Figure 7: The thermostat's LCD display with an alternative red backlight, indicating a different operational state or setting.

3. Setting the Temperature

Use the up (▲) and down (▼) arrow buttons to adjust the desired temperature. The display will show the set temperature, and the thermostat will automatically regulate the heating or cooling system to maintain this temperature.

4. Operating Modes (On/Off or Proportional, Summer/Winter)

The thermostat supports both On/Off and Proportional control modes, as well as Summer and Winter modes. Refer to the detailed programming section in the full product manual (if available) for instructions on how to switch between these modes and configure their parameters. Typically, a long press or combination of button presses will access mode settings.

5. Keypad Lock Function

To prevent unauthorized changes, the thermostat features a keypad lock function. This can be activated with a password. Consult the full product manual for instructions on how to set and activate/deactivate the keypad lock.



Figure 8: Icons representing key features: Keypad Lock, Display Control, Power Supply, and Cooling/Winter Mode.

MAINTENANCE

The VEMER THALOS KEY thermostat requires minimal maintenance. Follow these guidelines to ensure its longevity and optimal performance:

- **Cleaning:** Gently wipe the thermostat's surface with a soft, dry cloth. Do not use abrasive cleaners, solvents, or chemical sprays, as these can damage the display or casing.
- **Avoid Obstructions:** Ensure that no objects block the thermostat's vents or sensors, as this can lead to

inaccurate temperature readings.

- **Power Cycles:** If the thermostat is unresponsive, try cycling the power by turning off the circuit breaker for a few minutes and then turning it back on.

TROUBLESHOOTING

If you encounter issues with your VEMER THALOS KEY thermostat, refer to the following common problems and solutions:

Problem	Possible Cause	Solution
Display is blank	No power supply; loose wiring.	Check circuit breaker. Ensure wiring connections are secure (consult a qualified electrician if unsure).
Thermostat not controlling heating/cooling	Incorrect mode selected; wiring issue; system malfunction.	Verify the thermostat is in the correct operating mode (e.g., heating/cooling). Check wiring. Consult an HVAC technician if the system itself is not responding.
Temperature reading seems inaccurate	Thermostat location affected by drafts, direct sunlight, or heat sources.	Relocate the thermostat if possible. Ensure no obstructions are near the sensor.
Keypad is locked	Keypad lock function is active.	Enter the password to unlock the keypad. Refer to the full manual for password reset procedures if forgotten.

If the problem persists after attempting these solutions, please contact VEMER customer support or a certified technician.

SPECIFICATIONS

Below are the technical specifications for the VEMER THALOS KEY Wall Thermostat (Model VE720900):

Feature	Specification
Brand	VEMER
Model Name	THALOS KEY
Model Number	VE720900
Color	White
Product Dimensions (L x W x H)	12.5 x 2.6 x 8.5 cm
Item Weight	190 grams
Voltage	230 Volts
Power Source	Electrical Cable

Feature	Specification
Display Type	LCD (with blue backlight)
Control Type	Manual, Touch Control
Temperature Control Type	On/Off or Proportional
Components Included	Thermostat
Country of Origin	Italy
Spare Parts Availability	Information unavailable

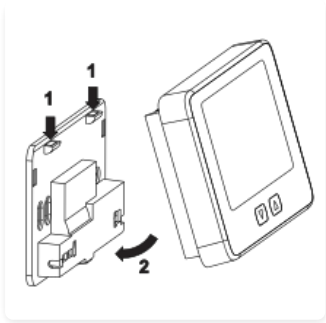



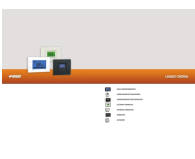
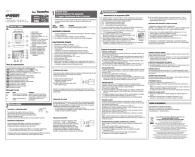
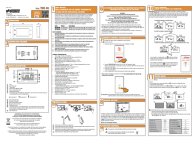

Figure 9: Indication that the product is manufactured in Italy.

WARRANTY AND SUPPORT

For warranty information, please refer to the documentation provided at the time of purchase or contact your retailer. VEMER products are designed for reliability and performance. For technical support or service inquiries, please visit the official VEMER website or contact their customer service department. Keep your purchase receipt as proof of purchase for warranty claims.

	<p>Vemer Climate Control Devices: Thermostats, Chronothermostats, and Humidistats Catalog</p> <p>Explore Vemer's comprehensive catalog of advanced climate control solutions, featuring a wide range of thermostats, chronothermostats, and humidistats designed for modern homes and buildings. Discover innovative features and quality Italian design.</p>
	<p>Vemer Climate Control Devices: Thermostats & Chronothermostats</p> <p>Explore the Vemer range of digital chronothermostats, electronic thermostats, mechanical thermostats, and humidistats for advanced home climate control. Featuring models like Iride, Dafne, Tuo, Chronos, Mithos, and more, designed for efficiency and comfort.</p>
	<p>Vemer Dafne Digital Programmable Thermostat User Manual</p> <p>Comprehensive user manual for the Vemer Dafne digital programmable thermostat, covering installation, programming, operation, safety, and technical specifications for efficient home climate control.</p>
	<p>Vemer: Catalogo Cronotermostati, Termostati e Umidostati per il Controllo Clima</p> <p>Esplora la vasta gamma di soluzioni Vemer per il controllo climatico: cronotermostati digitali, termostati elettronici e meccanici, umidostati e accessori. Scopri funzionalità avanzate per la gestione efficiente della temperatura e dell'umidità in ambienti residenziali e commerciali.</p>
	<p>Vemer ThermoPro Programmable Radiator Thermostat User Manual</p> <p>User manual for the Vemer ThermoPro programmable radiator thermostat (model VE740700). Learn about installation, programming, functions, and safety features for efficient home heating control.</p>
	<p>Vemer TUO 4G LTE Smart Thermostat User Manual</p> <p>Comprehensive user manual for the Vemer TUO 4G LTE Smart Thermostat, covering installation, configuration, programming, and operation for heating and air conditioning systems.</p>