

Lewin ML35 S1 40H 0W 00

Lewin ML35 S1 40H 0W 00 L35 230V Chain Motor Instruction Manual

Model: ML35 S1 40H 0W 00 | Brand: Lewin

1. INTRODUCTION

This manual provides essential information for the safe and efficient installation, operation, and maintenance of your Lewin ML35 S1 40H 0W 00 L35 230V Chain Motor. This chain motor is designed for automating tilt and turn windows, roof windows, and domes. It features an adjustable stroke length and includes all necessary fixing tools for display and tilt window applications.

Key features include quick and easy installation, a double-link chain for enhanced push performance and stability, and the ability for parallel connection of up to 30 motors. The motor also incorporates soft start/stop functionality and obstacle detection for improved safety and longevity.

- **Stroke Length:** Adjustable via dip switch, with options including 50, 100, 150, 200, 250, 300, 350, 400, and 420 mm.
- **Color:** White (RAL 9010).
- **Maximum Wing Width:** 1250 mm.
- **Minimum Wing Height:** 300 mm.

2. SAFETY INFORMATION

Please read all safety instructions carefully before installation and operation. Failure to follow these instructions may result in injury or damage to the product.

- **Electrical Safety:** Ensure the power supply is disconnected before any installation, maintenance, or repair work. All electrical connections must be performed by a qualified electrician in accordance with local regulations.
- **Moving Parts:** Keep hands, clothing, and other objects clear of moving parts during operation to prevent injury.
- **Installation:** The motor must be securely mounted to a stable surface capable of supporting its weight and operational forces.
- **Children and Pets:** Keep children and pets away from the operating area of the window actuator.
- **Environmental Conditions:** Do not expose the motor to extreme moisture or temperatures outside the

specified operating range.

3. PACKAGE CONTENTS

Verify that all components are present before beginning installation:

- Lewin ML35 S1 40H 0W 00 Chain Motor
- Mounting brackets and screws
- User Manual (this document)

Note: Specific fixing tools for display and tilt windows are included.

4. SETUP AND INSTALLATION

The Lewin ML35 S1 40H 0W 00 Chain Motor is designed for quick and easy installation. Refer to the technical drawings and installation diagrams for precise measurements and mounting procedures.

4.1 Mounting the Motor

Position the motor on the window frame or wall according to the specific window type (tilt and turn, roof window, or dome). Ensure the mounting surface is flat and robust. Use the provided mounting brackets and screws to secure the motor firmly.

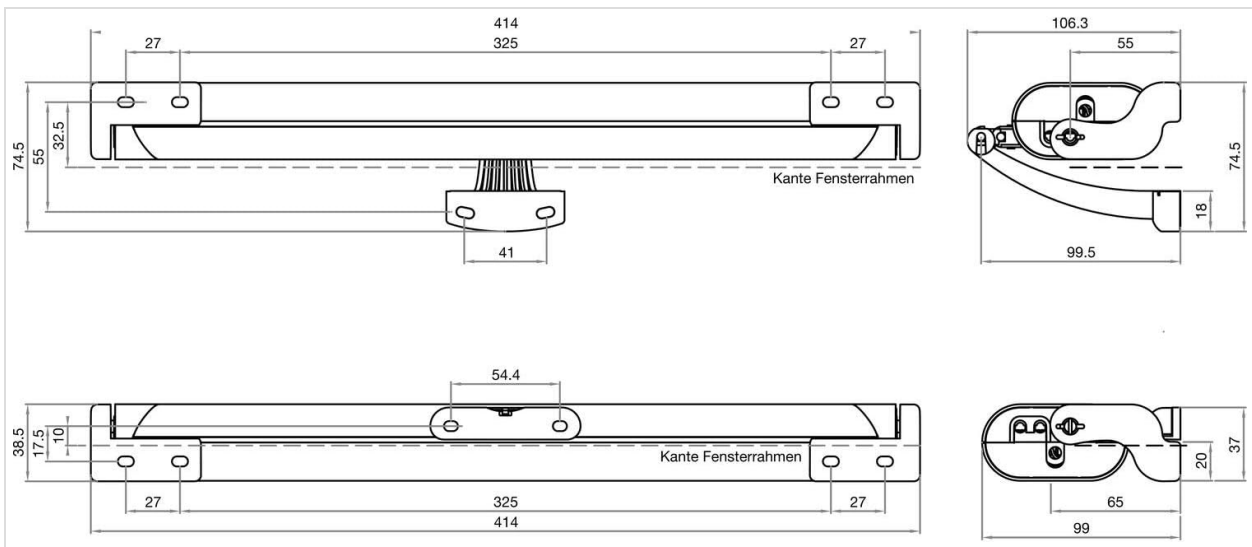

Figure 1: Technical drawing showing the dimensions and mounting points of the chain motor.

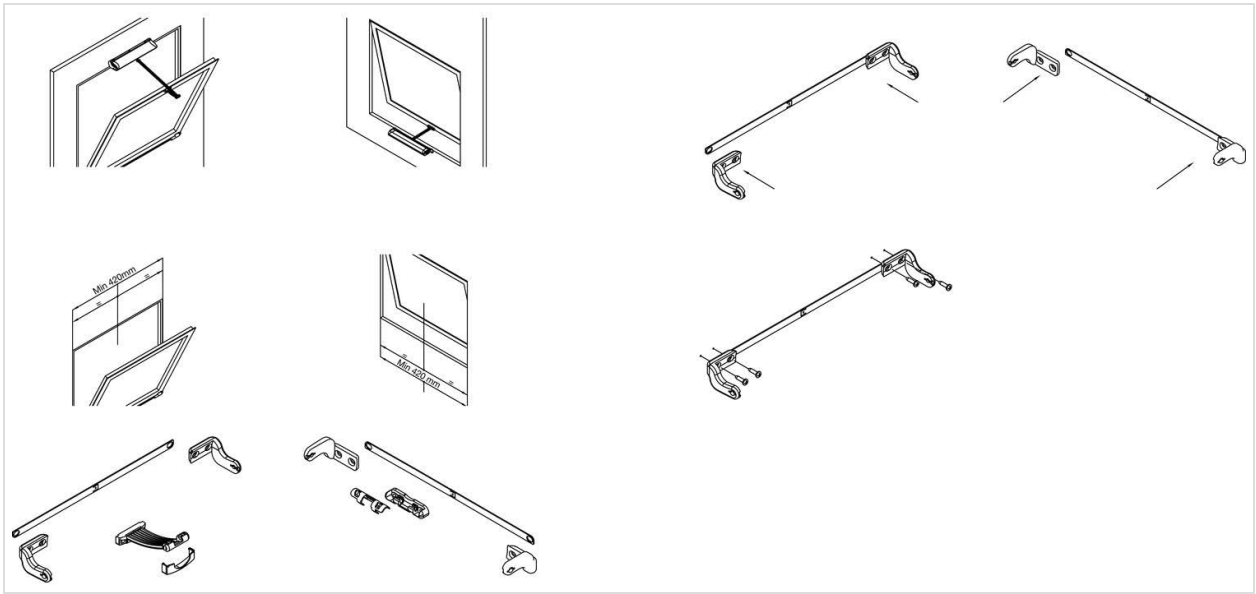

Figure 2: Installation diagrams illustrating different mounting configurations for the chain motor on various window types.

4.2 Electrical Connection

Connect the motor to a 230/240V AC power supply. Ensure all wiring is done correctly and safely. The motor supports parallel connection for up to 30 units, allowing synchronized operation of multiple windows.

4.3 Stroke Length Adjustment

The stroke length can be adjusted using the dip switches located on the motor. Refer to the motor's internal diagram or specific markings for dip switch settings corresponding to desired stroke lengths (50mm to 420mm).



Figure 3: The Lewin ML35 S1 40H 0W 00 Chain Motor installed on a window, demonstrating its operation.

5. OPERATING INSTRUCTIONS

Once installed and connected, the chain motor can be operated via a compatible control system (not included). The motor features soft start/stop for smooth operation and obstacle detection to prevent damage or injury if an obstruction is encountered during opening or closing.

5.1 Basic Operation

Activate the motor using your control switch to open or close the window. The motor will extend or retract the double-link chain to move the window sash.

5.2 Parallel Operation

If multiple motors are connected in parallel, they will operate simultaneously, ensuring synchronized movement of multiple windows or larger window sections.



Figure 4: Multiple chain motors operating in parallel on a series of windows.

6. MAINTENANCE

Regular maintenance ensures the longevity and optimal performance of your Lewin chain motor.

- **Cleaning:** Periodically clean the motor housing and chain with a soft, dry cloth. Avoid using abrasive cleaners or solvents.
- **Inspection:** Regularly inspect the mounting brackets, screws, and chain for any signs of wear, damage, or loosening. Tighten any loose fasteners.
- **Lubrication:** The chain mechanism is generally maintenance-free. Do not apply lubricants unless specifically instructed by the manufacturer.
- **Electrical Connections:** Check electrical connections for corrosion or damage. Ensure all wiring remains secure.

7. TROUBLESHOOTING

If you encounter issues with your chain motor, refer to the following common problems and solutions:

Problem	Possible Cause	Solution
Motor does not respond	No power supply; Loose electrical connection; Faulty control switch	Check power supply; Verify all electrical connections; Test control switch
Window does not open/close fully	Obstruction; Incorrect stroke length setting; Mechanical binding of window	Remove obstruction; Adjust dip switch settings for stroke length; Check window hinges/tracks for smooth movement
Motor makes unusual noise	Mechanical issue; Obstruction in chain mechanism	Inspect chain and gears for foreign objects or damage; Contact support if noise persists
Motor stops unexpectedly	Overload protection activated; Obstacle detection triggered	Check for obstructions; Reduce load on window if possible; Allow motor to cool down if overheated

If the problem persists after attempting these solutions, please contact customer support.

8. SPECIFICATIONS

Feature	Detail
Model Number	ML35 S1 40H 0W 00
Brand	Lewin
Input/Operating Voltage	230/240V AC
Power	28 Watt
Input Current	0.19 Amp
Frequency	50-60 Hz
Push/Pull Force	350N
Stroke Length (Adjustable)	50/100/150/200/250/300/350/400/420 mm
Speed (no load)	18 mm/sec

Feature	Detail
Protection Type	IP44
Continuous Operation	Max. 4 minutes
Temperature Range	-5°C to +50°C
Dimensions (L x W x H)	414 x 74.5 x 38.5 mm (Product description) / 43 x 14 x 5 cm (Product specifications)
Item Weight	1.4 kg (1400 grams)
Features	Soft start/stop, Obstacle detection, Double link chain, Parallel connection (up to 30 motors)

9. WARRANTY AND SUPPORT

For warranty information, please refer to the documentation provided at the time of purchase or contact your retailer. For technical support, spare parts, or service inquiries, please contact the manufacturer or authorized service center. Keep your purchase receipt as proof of purchase.