

AMOCAM V70C-520-6

AMOCAM 6-Unit Apartment Video Intercom System

MODEL: V70C-520-6

User Manual

1. Introduction

This manual provides detailed instructions for the installation, operation, maintenance, and troubleshooting of your AMOCAM 6-Unit Apartment Video Intercom System. Please read this manual thoroughly before installation and use to ensure proper function and longevity of the product. Keep this manual for future reference.

Safety Precautions

- Ensure all power is disconnected before performing any installation or maintenance.
- Installation should be performed by qualified personnel if you are unfamiliar with electrical wiring.
- Do not expose the outdoor unit to direct water spray or immerse it in water.
- Avoid placing indoor monitors in areas with high humidity or extreme temperatures.
- Use only the provided power supply and accessories.

2. Product Overview

The AMOCAM V70C-520-6 system is a wired video door phone kit designed for multi-unit apartments, supporting up to 6 households. It includes one outdoor camera unit and six indoor 7-inch monitors, enabling two-way audio communication, video monitoring, and remote door unlocking.

Included Components

- 1 x Outdoor Doorbell Unit
- 6 x Indoor Monitors
- Power Supplies (for each monitor)

- Connection Cables
- Mounting Accessories

System Components



Overview of the AMOCAM 6-Unit Video Intercom System, showing the outdoor doorbell unit and six indoor monitors.

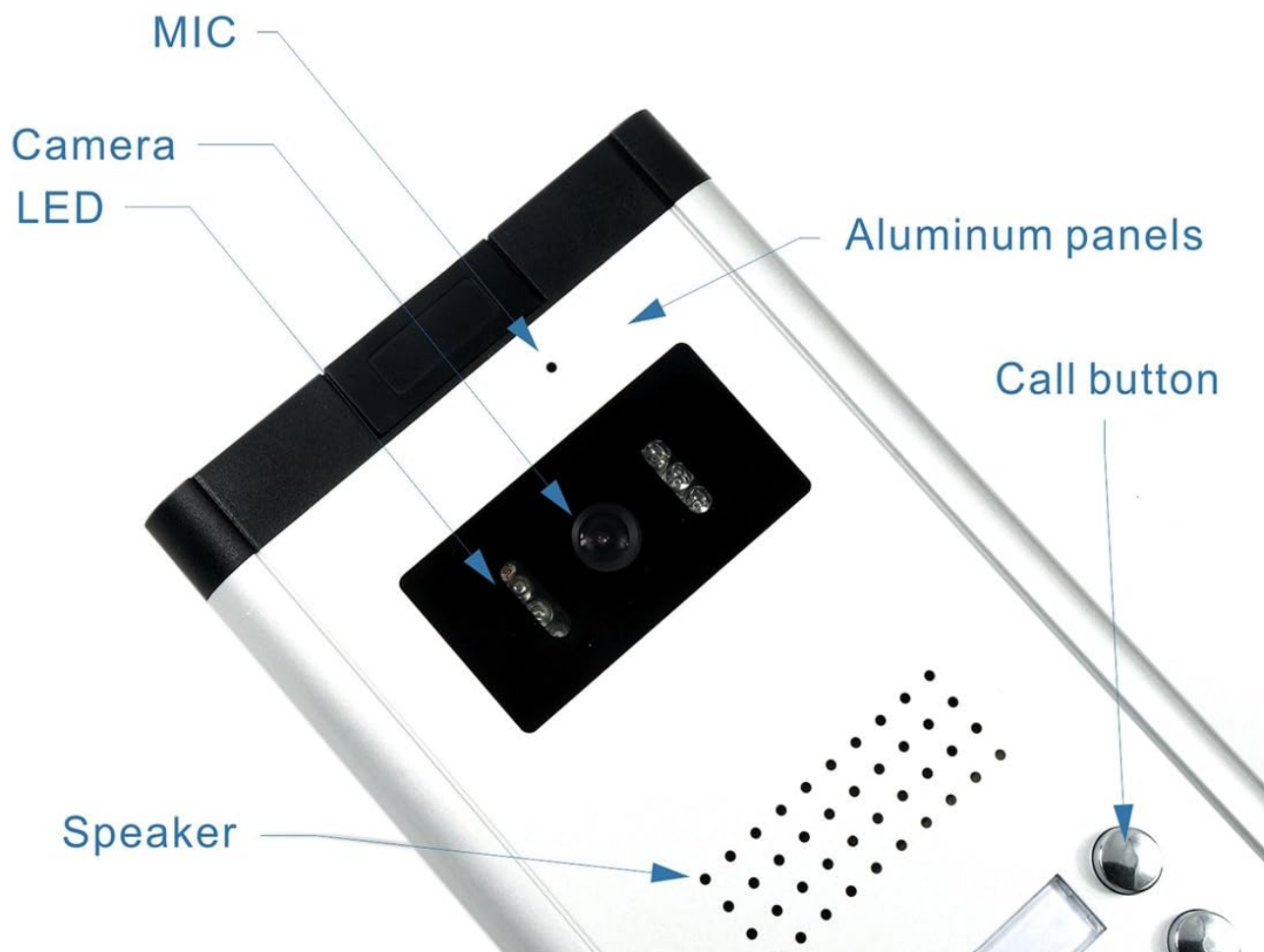

Detailed view of the outdoor unit, highlighting the camera lens, infrared LEDs for night vision, microphone, speaker, and individual call buttons for each apartment.



The 7-inch indoor monitor, displaying its dimensions (9.45 inches length, 5.9 inches width, 1.0 inch thickness).

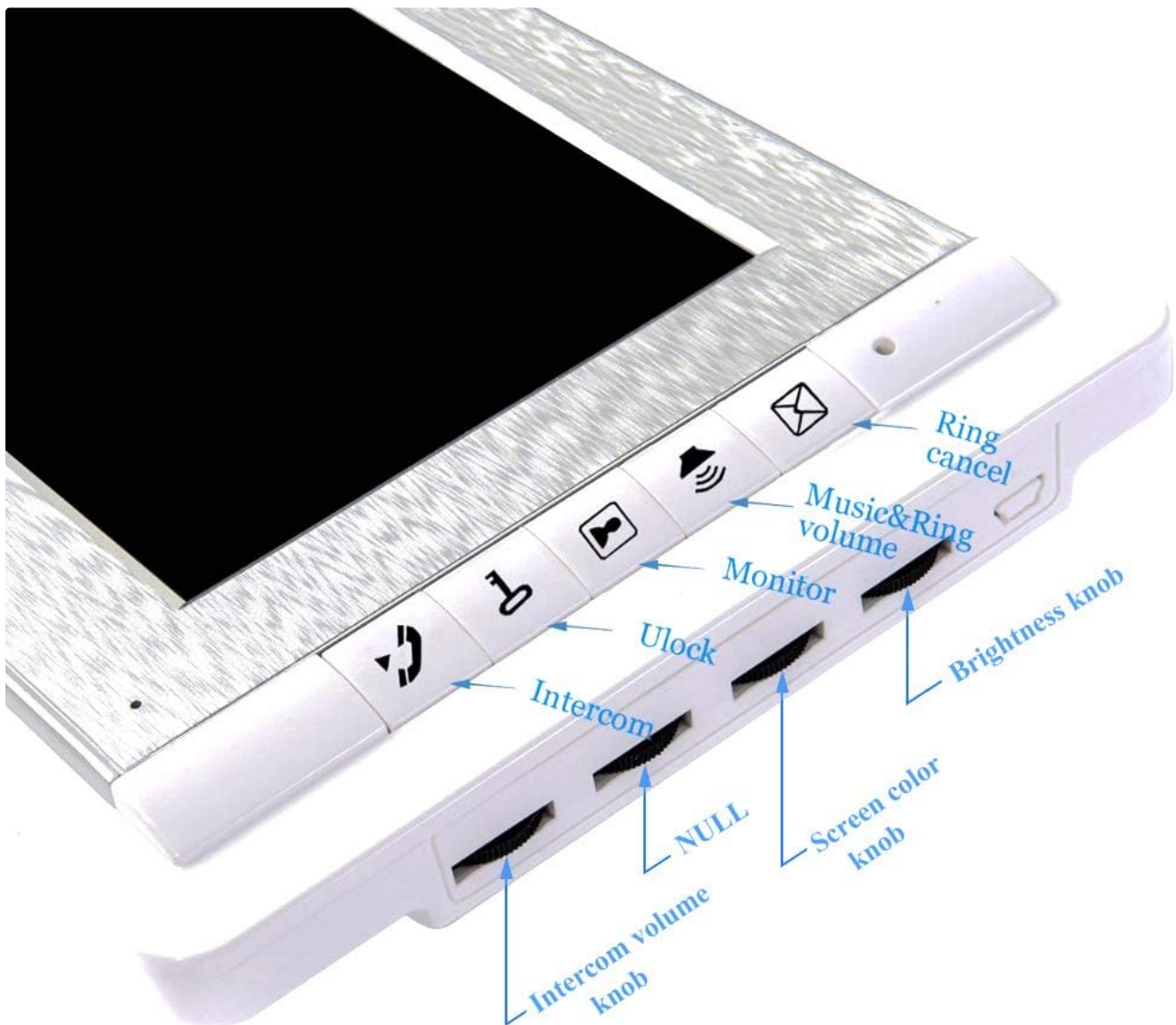

Close-up of the indoor monitor's side controls, including buttons for intercom, unlock, monitor, ring cancel, and adjustment knobs for intercom volume, music/ring volume, brightness, and screen color.

3. Setup and Installation

Careful installation is crucial for optimal performance. Follow these steps for proper setup.

Outdoor Unit Installation

1. **Mounting Height:** The standard height for the outdoor station camera lens is between 145cm and 160cm from the ground, with the center of the lens at approximately 150cm. Ensure the unit is positioned to capture the visitor's face clearly.
2. **Secure Mounting:** Use the provided set iron bracket. Pass the set iron through the holes on both sides of the outdoor station. Fix the bottom cover of the outdoor unit securely to the wall using screws.

Indoor Monitor Installation

3. **Mounting:** Hang the indoor monitor on its bracket. Ensure it is securely fastened.
4. **Power Connection:** Plug in the power adapter for the indoor monitor.

Wiring Diagram

The system uses a wired connection for stability. Refer to the diagram below for connecting the outdoor unit to the indoor monitors and electric lock.

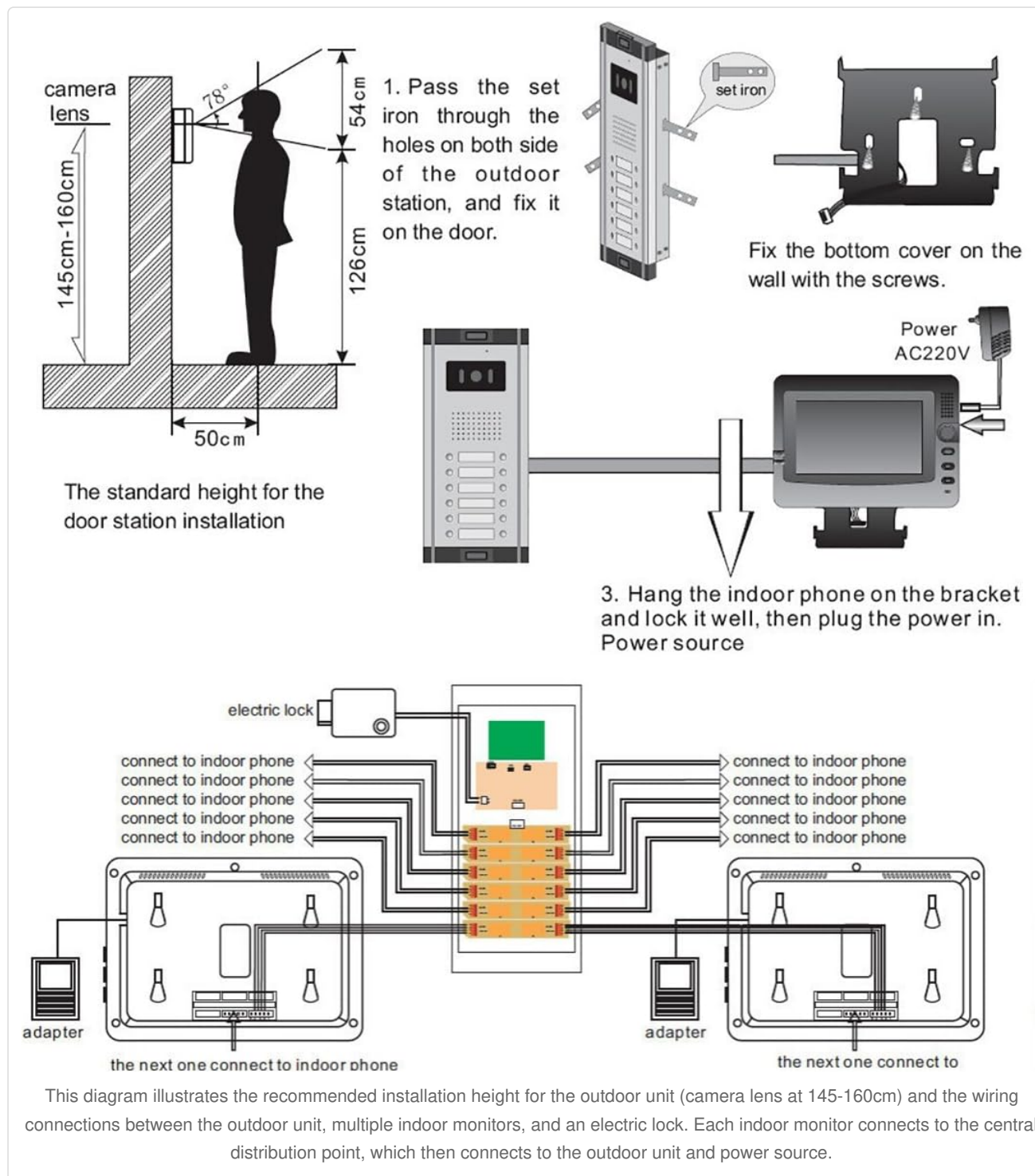



Rear view of the indoor monitor, showing the DC15V power input, video, audio, and ground connections, as well as terminals for intercom and power.

4. Operating Instructions

Familiarize yourself with the monitor controls for effective use of the intercom system.

Receiving a Call

- When a visitor presses the call button on the outdoor unit, your indoor monitor will ring and display the visitor's image.
- Press the **Answer** button (typically a phone icon) on the indoor monitor to establish two-way audio communication.

Monitoring Outside

- To view the outdoor area without a visitor present, press the **Monitor** button (typically an eye or camera icon) on your indoor monitor. The screen will display the live feed from the outdoor camera.



An indoor monitor displaying a live video feed from the outdoor unit, demonstrating the monitoring function.

Unlocking the Door

- During a call or while monitoring, press the **Unlock** button (typically a key icon) on the indoor monitor to remotely open an connected electric lock.

Adjusting Settings

- **Intercom Volume Knob:** Adjusts the volume of the two-way audio during communication.
- **Music & Ring Volume Knob:** Controls the volume of the doorbell chimes and system sounds.
- **Brightness Knob:** Adjusts the screen brightness of the indoor monitor.
- **Screen Color Knob:** Adjusts the color saturation of the display.
- **Ring Cancel Button:** Mutes the doorbell ring.

The system offers 16 different doorbell chimes. These can typically be cycled through or selected via a dedicated button or menu option (refer to specific monitor interface if available).

5. Maintenance

Regular maintenance ensures the longevity and optimal performance of your intercom system.

Cleaning

- Wipe the indoor monitors and outdoor unit with a soft, dry, or slightly damp cloth.
- Do not use abrasive cleaners, solvents, or chemical sprays, as these can damage the surfaces and electronic components.
- Ensure the camera lens on the outdoor unit is clean and free of obstructions for clear video quality.

General Care

- Periodically check all wiring connections to ensure they are secure and free from corrosion. Loose connections

can lead to intermittent operation.

- Protect the outdoor unit from extreme weather conditions where possible, although it is designed for outdoor use.

6. Troubleshooting

If you encounter issues with your AMOCAM intercom system, refer to the following common problems and solutions.

| Problem | Possible Cause | Solution |
|---|---|--|
| No video on indoor monitor | Loose video cable connection; Power issue; Damaged camera. | Check video cable connections at both the outdoor unit and indoor monitor. Ensure power is supplied to both units. If problem persists, contact support. |
| No audio or poor audio quality | Loose audio cable connection; Volume too low; Damaged speaker/microphone. | Verify audio cable connections. Adjust intercom volume knob on the indoor monitor. Check for obstructions on the speaker/microphone. |
| Doorbell does not ring | Ring volume too low; Ring cancel activated; Faulty call button. | Adjust Music & Ring Volume knob. Deactivate ring cancel. Test call button functionality. |
| Door unlock function not working | Electric lock not connected or faulty; Wiring issue. | Ensure the electric lock is properly connected and functional. Check wiring from the outdoor unit to the lock. |
| Intermittent contact or connection issues | Loose or poor quality wiring connections. | Inspect all wiring connections for tightness and integrity. Ensure wires are not wiggling or damaged. Re-secure any loose connections. |
| Indoor unit fails (e.g., no sound) | Internal component failure. | If basic troubleshooting does not resolve the issue, the unit may require professional service or replacement. |

If the problem persists after attempting these solutions, please contact AMOCAM customer support.

7. Specifications

Key technical specifications for the AMOCAM V70C-520-6 Video Intercom System.

Brand: AMOCAM

Model Number: V70C-520-6

Connectivity Technology: Wired

Number of Items: 6 (Monitors)

Indoor/Outdoor Usage: Indoor, Outdoor

Special Feature: Night Vision

Screen Size: 7 Inch LCD

Video Capture Resolution: 480p

Photo Sensor Technology: CMOS

Material: Aluminum (Outdoor Unit)

Power Source: Battery Powered (for some components, main units are wired)

Voltage: 240 Volts

Wattage: 276 watts

Item Dimensions (L x W x H): 14 x 6.5 x 10 inches (packaging/overall system)

Item Weight: 10.23 pounds

International Protection Rating: IP54 (Outdoor Unit)

Control Method: Remote, Push Button

8. Warranty and Support

AMOCAM products are designed for reliability and performance. For specific warranty details, please refer to the warranty card included with your product or visit the official AMOCAM website.

Customer Support





If you require technical assistance, have questions about your product, or need to report an issue, please contact AMOCAM customer support through the following channels:

- **Online:** Visit the [AMOCAM Store on Amazon](#) for product information and support resources.
- **Email/Phone:** Refer to the contact information provided in your product packaging or on the official AMOCAM website.

Please have your model number (V70C-520-6) and purchase date ready when contacting support.

Related Documents - V70C-520-6

| | |
|---|---|
|  | <p>ButterflyMX Intercom Installation Guide: Step-by-Step Instructions for Certified Installers</p> <p>A comprehensive installation guide for ButterflyMX video intercom systems, detailing the process for certified installers. Covers unboxing, component lists, required tools, wiring, mounting, activation, and testing for various ButterflyMX intercom models.</p> |
|---|---|

| | |
|---|--|
|  <p>Support: 1800-389-4476, ext. 2 (Mon-Fri, 9am-5pm EST) Email: support@butterflymx.com https://www.butterflymx.com/guides/10-0229-02</p> | <p>ButterflyMX Video Intercom Installation Guide for Certified Installers</p> <p>A comprehensive guide for certified installers detailing the installation process for the ButterflyMX video intercom system, including pre-installation checks, wiring, mounting, and activation steps.</p> |
|  <p>Akuvox SIP COMMUNICATOR</p> | <p>Akuvox S562W Datasheet: 7-Inch SIP Touch Screen Communicator</p> <p>Datasheet for the Akuvox S562W, a Linux-based 7-inch capacitive touch screen SIP communicator providing advanced audio and video communication, Wi-Fi 6 support, and PoE connectivity.</p> |
|  <p>Protex P3000 (XL) ヘリウムシニア...リークディテクト</p> <p>INFICON</p> | <p>Protex P3000(XL)</p> <p>INFICON Protex P3000(XL)</p> |
|  <p>Grandstream</p> | <p>Grandstream GXV3470 Quick Installation Guide: Setup, Configuration, and Features</p> <p>Comprehensive guide to installing, connecting, and configuring the Grandstream GXV3470 High-End Smart Video Phone for Android. Learn about its features, package contents, and setup.</p> |
|  <p>Grandstream</p> | <p>Grandstream GXV3480: Quick Installation Guide for Android IP Video Phone</p> <p>This document provides a quick installation guide for the Grandstream GXV3480, a high-end smart video phone for Android. It covers setup, connection, configuration, package contents, precautions, and regulatory information. The GXV3480 offers advanced communication and conferencing features for businesses.</p> |