

MAYFLASH W012

MAYFLASH GameCube Controller Adapter (Model W012)

Instruction Manual for Wii U, PC, and Nintendo Switch

INTRODUCTION

The MAYFLASH GameCube Controller Adapter (Model W012) allows users to connect up to four GameCube controllers, including wireless GameCube controllers, to a Wii U system, PC via USB, or Nintendo Switch/Switch 2. This adapter supports built-in vibration feedback and is compatible with the GC/Wii Emulator Dolphin. It is designed for plug-and-play functionality with minimal delay.



Image 1: The MAYFLASH GameCube Controller Adapter, showing its four GameCube controller ports and two USB connection cables.

SETUP

1. Connecting the Adapter

The adapter features two USB cables for connection. Both cables must be plugged into your system for full functionality, including vibration feedback.

2. Mode Selection

Locate the switch on the side of the adapter. This switch allows you to select between 'Wii U' and 'PC' modes. Ensure the switch is set to the correct mode for your intended system.



Image 2: A close-up view of the four GameCube controller ports on the adapter, ready for controller connection.

3. System-Specific Connections

- **For Wii U:** Set the switch to 'Wii U'. Plug both USB cables into the USB ports on your Wii U console.
- **For PC (Windows XP, Vista, 7, 8, 10, 11, and Mac OS):** Set the switch to 'PC'. Plug both USB cables into available USB ports on your computer. A driver may be required for vibration feedback on PC mode.
- **For Nintendo Switch/Switch 2:** Set the switch to 'Wii U'. Plug both USB cables into the USB ports on the Nintendo Switch dock. The adapter is detected as a Pro Controller on Switch 2.



Video 1: Demonstrates connecting the MAYFLASH GameCube Controller Adapter to a Wii U console and playing a game with GameCube controllers.



Video 2: Illustrates the connection of the MAYFLASH GameCube Controller Adapter to a Nintendo Switch dock and gameplay using GameCube controllers.

OPERATING INSTRUCTIONS

1. Connecting GameCube Controllers

Once the adapter is connected to your system and the correct mode is selected, plug your GameCube controllers into the four available ports on the adapter. The adapter supports up to four controllers simultaneously.

2. Vibration Feedback

The adapter supports the built-in vibration feedback feature of GameCube controllers. Ensure both USB cables are connected to the host system to provide sufficient power for vibration.

3. PC Mode Specifics

In PC mode, the adapter is compatible with various Windows operating systems and Mac OS. For optimal performance and vibration feedback, it may be necessary to install specific drivers from the MAYFLASH support page.

4. Dolphin Emulator Support

The adapter fully supports the GC/Wii Emulator Dolphin, allowing you to use your GameCube controllers for emulated games with no noticeable delay.

MAINTENANCE

To ensure the longevity and optimal performance of your MAYFLASH GameCube Controller Adapter, follow these maintenance guidelines:

- **Cleaning:** Use a soft, dry cloth to wipe the adapter's surface. Avoid using liquid cleaners or abrasive materials, as these can damage the device.
- **Storage:** Store the adapter in a cool, dry place away from direct sunlight and extreme temperatures. When not in use, consider coiling the cables neatly to prevent tangling or damage.
- **Handling:** Avoid pulling on the cables when disconnecting the adapter from your console or PC. Always grasp the USB plug directly.

TROUBLESHOOTING

If you encounter issues with your MAYFLASH GameCube Controller Adapter, refer to the following common solutions:

- **Controller Not Recognized:**
 - Ensure the 'Wii U'/PC' switch on the adapter is set to the correct position for your system.
 - Verify that both USB cables are securely plugged into the host system's USB ports.
 - For Nintendo Switch, ensure 'Pro Controller Wired Communication' is enabled in the system settings.
- **No Vibration Feedback (PC Mode):**
 - Confirm both USB cables are connected.
 - Install the latest drivers for the adapter from the official MAYFLASH web support page.
- **Input Delay:**
 - While the adapter is designed for no delay, ensure it is connected to USB 3.0 ports on a PC if available, as some users report improved polling rates.
- **Firmware Updates:**
 - Nintendo Switch system updates (e.g., 19.0.1) may sometimes affect adapter recognition. If issues arise after a system update, check the MAYFLASH web support page for the latest firmware version (e.g., V09) for your adapter and update if necessary.

SPECIFICATIONS





Brand	MAYFLASH
Model Number	W012
Hardware Platform	Nintendo Wii U

Operating System Compatibility	Nintendo Wii U, Windows XP/Vista/7/8/10/11, Mac OS, Nintendo Switch/Switch 2
Item Weight	6.4 ounces
Product Dimensions (LxWxH)	5 x 4 x 1 inches
Voltage	20 Volts
Connector Type	USB

WARRANTY AND SUPPORT

For warranty information, technical support, and the latest firmware updates, please visit the official MAYFLASH web support page. The product includes the GameCube Controller Adapter and this User Manual.

Related Documents - W012

	<p>MAYFLASH MAGIC-NS Lite USB Wireless Adapter User Manual</p> <p>User manual for the MAYFLASH MAGIC-NS Lite, a USB wireless adapter that enables connection of various Bluetooth controllers to Nintendo Switch, PC, PlayStation 3, macOS, and other systems. Includes setup, compatibility, mode switching, vibration, and dead zone adjustments.</p>
	<p>MAYFLASH W010 Wireless Sensor DolphinBar Instruction Manual</p> <p>User guide for the MAYFLASH W010 Wireless Sensor DolphinBar, detailing how to connect Wii Remote, Nunchuk, and Classic controllers to a PC via Bluetooth for various gaming and input modes, including keyboard, mouse, and controller emulation. Features setup, mode switching, button mappings, and firmware updates.</p>
	<p>Mayflash MAGIC-NS Lite USB Wireless Adapter User Manual</p> <p>Comprehensive user manual for the Mayflash MAGIC-NS Lite USB Wireless Adapter, covering setup, system and controller compatibility, mode switching, advanced features like vibration and dead zone adjustment, firmware updates, and troubleshooting.</p>
	<p>MAYFLASH PS5 Adapter: Connect PS4/PS5 Controllers to Joysticks & FPS Adapters</p> <p>Enhance your gaming experience with the MAYFLASH PS5 Adapter. This device allows you to connect wired PS4/PS5 controllers to joysticks and FPS gaming adapters for both PS4 and PS5 consoles. Features plug-and-play functionality and easy firmware updates.</p>
	<p>Mayflash MAGIC-S PRO 2 USB Wireless Adapter User Manual</p> <p>Comprehensive guide to the Mayflash MAGIC-S PRO 2 USB Wireless Adapter, covering system compatibility, controller connections, setup, firmware updates, and advanced features for gaming.</p>

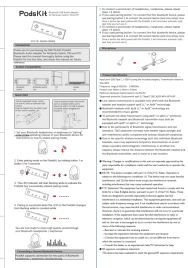

[MAYFLASH PodsKit Bluetooth USB Audio Adapter User Manual](#)

User manual for the MAYFLASH PodsKit, a Bluetooth USB audio adapter for Nintendo Switch, PS4, and PC, supporting aptX LL for low latency audio.