

Sloan CN1002A

Sloan CN1002A Crown Piston Assembly Closet with Main Seat

Instruction Manual

1. INTRODUCTION

This manual provides essential information for the proper installation, operation, and maintenance of the Sloan CN1002A Crown Piston Assembly for closets with a main seat. Please read these instructions thoroughly before proceeding with installation or service to ensure safe and efficient performance of the product.

Important Safety Information: Always turn off the water supply before attempting any installation, maintenance, or repair. Wear appropriate personal protective equipment. If you are unsure about any step, consult a qualified plumber.

2. PRODUCT OVERVIEW

The Sloan CN1002A Crown Piston Assembly is a critical component designed for use in specific closet flush valves. It is engineered to ensure reliable flushing performance and water efficiency. This assembly includes the main piston and seat components necessary for the flush valve's operation.



Figure 1: The Sloan CN1002A Crown Piston Assembly. This image displays the complete piston assembly, featuring its black body, white O-ring, and visible screws on the end cap.

Key Features:

- Designed for closet flush valves.
- Includes main seat for complete assembly.
- Manufactured in the United States.
- Complies with U.S. Navy Bureau of Ships regulations.



Figure 2: Sloan CN1002A Piston Assembly shown with two additional sealing rings. This view highlights the separate rubber rings that may be included or required for proper sealing during installation.

3. INSTALLATION

The Sloan CN1002A Crown Piston Assembly is intended for replacement or new installation within compatible flush valve bodies. Professional installation is recommended.

General Installation Steps:

1. **Turn off Water Supply:** Locate the main water shut-off valve for the fixture and turn it off completely. Flush the toilet to relieve pressure.
2. **Disassemble Existing Valve:** Carefully remove the cap and any retaining rings or screws from the top of the flush valve body to access the old piston assembly.
3. **Remove Old Piston:** Extract the old piston assembly from the valve body. Note its orientation for correct installation of the new part.
4. **Inspect Valve Body:** Clean the inside of the flush valve body, removing any debris or mineral deposits. Inspect for damage.
5. **Install New Piston Assembly:** Insert the new Sloan CN1002A Crown Piston Assembly into the valve body, ensuring it is seated correctly. Refer to the exploded view diagram for component placement.
6. **Reassemble Valve:** Replace the cap and secure any retaining rings or screws. Ensure all connections

are hand-tightened, then gently snugged with a wrench if necessary, avoiding overtightening.

7. **Restore Water Supply:** Slowly turn the water supply back on. Check for leaks around the flush valve.

8. **Test Flush:** Perform several test flushes to ensure proper operation and no leaks.

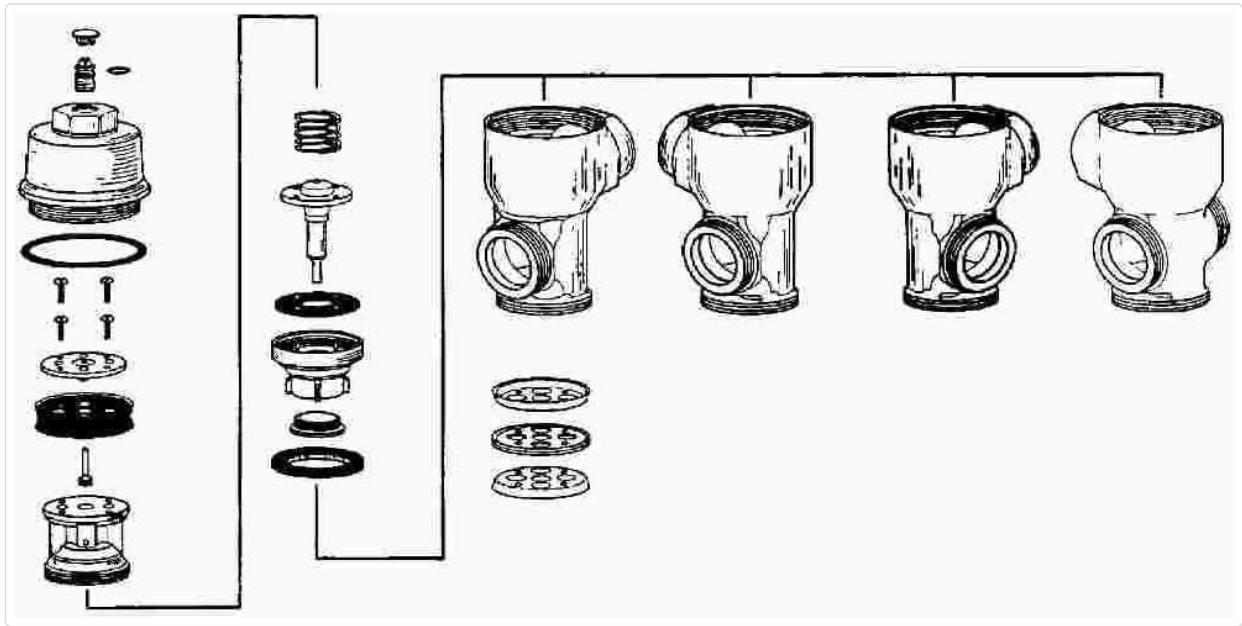

Figure 3: Exploded view diagram illustrating various flush valve components. This diagram provides a visual guide to the internal parts of a flush valve, including the piston assembly, and aids in understanding their arrangement during installation or repair.

4. OPERATING PRINCIPLES

The Sloan CN1002A Crown Piston Assembly functions as the core mechanism within a flush valve, controlling the flow of water for flushing. When the flush handle is activated, it lifts the piston, allowing water to flow from the supply line into the toilet bowl. Once the handle is released, the piston returns to its seated position, stopping the water flow and refilling the tank (if applicable to the flush valve type).

5. MAINTENANCE

Regular maintenance helps ensure the longevity and optimal performance of your Sloan CN1002A Crown Piston Assembly.

Recommended Maintenance:

- **Periodic Inspection:** Annually inspect the piston assembly for signs of wear, such as cracks, tears in rubber components, or excessive mineral buildup.
- **Cleaning:** If mineral deposits are present, carefully remove the piston assembly (following installation steps 1-3 in reverse) and clean it with a mild descaling solution or white vinegar. Rinse thoroughly with clean water before reinstallation. Avoid abrasive cleaners.
- **Seal Replacement:** If leaks occur or the flush performance degrades, inspect the O-rings and seals. Replace them if they appear worn or damaged.

6. TROUBLESHOOTING

Below are common issues related to flush valve piston assemblies and potential solutions:

Problem	Possible Cause	Solution
Incomplete Flush / Weak Flush	Worn or damaged piston assembly; debris obstructing water flow.	Inspect and clean or replace the piston assembly. Ensure water supply is fully open.
Continuous Running Water / Leaking	Piston not seating properly due to wear, debris, or damaged seals.	Remove, inspect, and clean the piston assembly and valve seat. Replace if worn or damaged.
No Flush	Piston stuck; water supply off; severe obstruction.	Check water supply. Disassemble and inspect piston for obstruction or damage.

7. SPECIFICATIONS





Detailed specifications for the Sloan CN1002A Crown Piston Assembly:

Attribute	Detail
Model Number	CN1002A
Part Number	CN1002A
Brand	Sloan
Manufacturer	SLOAN VALVE COMPANY
Material	Aluminum Alloy (main body), Plastic (seat material type)
Color	Black
Item Weight	0.81 ounces
Product Dimensions	1 x 1 x 1 inches
UPC	076335026589
Installation Type	Floor Mounted (refers to the fixture it's used in)
Included Components	toilet-repair-kits (as part of a kit)

8. WARRANTY AND SUPPORT

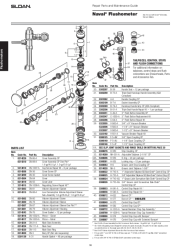
Sloan products are manufactured to high standards and are typically covered by a manufacturer's warranty against defects in materials and workmanship. For specific warranty terms and conditions, please refer to the documentation provided with your original purchase or visit the official Sloan Valve Company website. For technical assistance, replacement parts, or further inquiries, please contact Sloan Valve Company customer support directly. Contact information can usually be found on the manufacturer's website or product packaging.

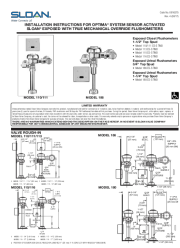
Related Documents - CN1002A

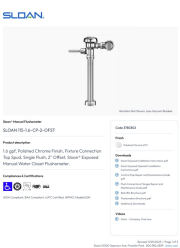
	<p>Sloan ECOS® Electronic Flushometer Installation Instructions</p> <p>Comprehensive installation guide for Sloan ECOS® Single and Dual-Flush Electronic Complete Valve and Retrofit Installations, covering new installations, RESS series conversions, and troubleshooting.</p>
	<p>Sloan Naval Flushometer Repair Parts and Maintenance Guide</p> <p>Comprehensive repair parts and maintenance guide for the Sloan Naval Flushometer, including troubleshooting tips, parts lists, and component diagrams. Covers models compatible with Crown, Star, and Marine flushometers.</p>
	<p>Sloan Royal 111-1.28-CP Manual Flushometer - Technical Specifications and Installation Guide</p> <p>Detailed product information for the Sloan Royal 111-1.28-CP manual flushometer, including specifications, features, compliances, and rough-in dimensions. Ideal for water closets.</p>
	<p>Sloan Optima System Sensor Activated Flushometer Installation Instructions</p> <p>Comprehensive installation guide for Sloan Optima System Sensor Activated Exposed Flushometers with True Mechanical Override, covering models 110, 111, 113, 115, 116, 180, and 186. Includes setup, electrical hook-up, troubleshooting, and parts list.</p>
	<p>Sloan CX Flushometer: Innovative Concealed Valve for Modern Restrooms</p> <p>Explore the Sloan CX Flushometer, a revolutionary concealed flush valve designed for commercial restrooms. It offers architects, designers, and facility managers a compact, vandal-resistant, and aesthetically pleasing solution with significant water savings and simplified maintenance. Available in multiple finishes and flush volumes.</p>
	<p>SLOAN 115-1.6-CP-2-OFST Manual Flushometer - Technical Specifications</p> <p>Detailed technical specifications for the SLOAN 115-1.6-CP-2-OFST manual flushometer, including product description, features, dimensions, and compliance information.</p>

