

Manuals+

[Q & A](#) | [Deep Search](#) | [Upload](#)

manuals.plus /

› [DELTA](#) /

› [Delta Ashlyn Single Handle Bathroom Faucet \(564-SSMPU-DST\) - Instruction Manual](#)

DELTA 564-SSMPU-DST

Delta Ashlyn Single Handle Bathroom Faucet

Model: 564-SSMPU-DST | Brand: DELTA

INTRODUCTION

This manual provides comprehensive instructions for the installation, operation, and maintenance of your Delta Ashlyn Single Handle Bathroom Faucet. Designed with sleek, angular lines and soft edges, this faucet offers a modern aesthetic for your bathroom. It features Delta's DIAMOND Seal Technology for lasting performance and InnoFlex PEX supply lines for easy installation.



Image: Delta Ashlyn Single Handle Bathroom Faucet in Stainless finish, showcasing its modern design.

Key Features:

- **DIAMOND Seal Technology:** Reduces leak points and lasts twice as long as the industry standard.
- **Integrated InnoFlex PEX Supply Lines:** Included for simplified installation and reduced leak potential.
- **WaterSense Labeled:** Uses at least 20% less water than the industry standard.
- **Lifetime Limited Warranty:** Backed by Delta Faucet's comprehensive warranty.
- **Easy Installation:** Designed for single-hole or 3-hole, 4-inch configurations with an optional deck plate.

Product Overview Video:

Your browser does not support the video tag.

Video: An overview of the Delta Ashlyn Single Hole Bathroom Faucet, highlighting its features and design.

IMPORTANT SAFETY INFORMATION

- Always turn off the water supply to the faucet before beginning any work.
- Wear safety glasses during installation to protect your eyes.
- Ensure all connections are secure to prevent leaks.
- If you are unsure about any step, consult a qualified plumber.
- Keep small parts away from children.

PACKAGE CONTENTS

Verify that all components are present before beginning installation:

- Delta Ashlyn Single Handle Bathroom Faucet
- Integrated InnoFlex PEX Supply Lines
- Optional Deck Plate (for 3-hole installations)
- Coordinating Metal Pop-Up Drain Assembly
- Mounting Hardware (nuts, washers, bracket)
- Aerator Wrench

TOOLS AND MATERIALS REQUIRED

The following tools and materials are recommended for installation:

- Adjustable Wrench (2 recommended)
- Safety Glasses
- Towel or Rag
- Bucket (for catching water)
- Flashlight (for under-sink visibility)
- Plumber's Tape (if replacing drain)
- Silicone Sealant (for uneven sink surfaces)

Your browser does not support the video tag.

Video: Delta Faucet installation guide, showing required tools and initial steps.

INSTALLATION INSTRUCTIONS

1. Prepare for Installation

1. Turn off the water supply to the sink at the shut-off valves.
2. Clear the area under the sink for access.
3. Remove your old faucet and clean the sink surface.

2. Mount the Faucet

1. If your sink has three holes, place the optional deck plate over the holes. Ensure the gasket is properly seated.
2. Feed the integrated supply lines and mounting stud of the faucet through the center hole of the sink.
3. Position the faucet squarely on the sink or deck plate.
4. From underneath the sink, secure the faucet using the provided mounting bracket and nut. Hand-tighten first, then use an adjustable wrench for final tightening, ensuring the faucet remains straight.

HOLES FOR INSTALLATION



ADDITIONAL INFORMATION

**MINIMUM CLEARANCE
TO BACKSPASH**
2.5 inches

DRAIN ASSEMBLY
Included

SUPPLY LINES
Included

**MAXIMUM DECK
THICKNESS**
2.88 inches

HOLE SIZE
1.13–1.5 inches

**WATER SUPPLY
CONNECTION**
.375 inches



see what Delta can do™

DIMENSIONS

HEIGHT 5.69 inches



SPOUT REACH 5.13 inches

OPTIONAL DECK PLATE (Included)
Covers pre-existing holes
6 inches wide

Image: Diagram illustrating faucet dimensions and installation options for 1-hole or 3-hole sinks, including the optional deck plate.

3. Connect Supply Lines

1. Connect the integrated InnoFlex PEX supply lines to your hot and cold water supply valves. The lines are color-coded (red for hot, blue for cold).
2. Hand-tighten the connections, then use an adjustable wrench for a final quarter-turn to ensure a secure, leak-free seal. Do not overtighten.
3. If the supply lines are too long, they can be spiraled to manage excess length, ensuring no kinks.

INNOFLEX[®]

PEX SUPPLY LINES



**INTEGRATED
INTO THE FAUCET**

**MADE TO RESIST CRACKS,
KINKS AND CORROSION**



Image: Close-up of InnoFlex PEX supply lines, highlighting their flexibility and integrated design.

4. Install Drain Assembly

1. Follow the instructions provided with the coordinating metal pop-up drain assembly for proper installation into your sink.
2. Ensure all seals are correctly placed and connections are tightened to prevent leaks.

5. Flush the Faucet

1. Before turning on the water fully, remove the aerator from the faucet spout using the provided aerator wrench.
2. Slowly turn on the hot and cold water supply valves.
3. Run water through the faucet for approximately 30 seconds to flush out any debris that may have entered the lines during installation.
4. Turn off the water, re-install the aerator, and check all connections for leaks.

OPERATING YOUR FAUCET

The Delta Ashlyn faucet features a single handle for easy control of water flow and temperature.

- **To Turn On/Off:** Lift the handle upwards to turn on the water. Push the handle downwards to turn off the water.
- **To Adjust Water Temperature:** Move the handle to the left for hotter water and to the right for colder water.
- **To Adjust Water Flow:** The further the handle is lifted, the greater the water flow.

Your browser does not support the video tag.

Video: A brief demonstration of the Delta Ashlyn faucet in operation, showing water flow and temperature adjustment.

CARE AND MAINTENANCE

Proper care will ensure the longevity and appearance of your Delta faucet.

- **Cleaning:** Clean your faucet regularly with a soft, damp cloth. Avoid abrasive cleaners, harsh chemicals, or polishes as they can damage the finish.
- **Aerator Cleaning:** If water flow decreases, the aerator may be clogged. Remove it using the provided wrench, rinse away any debris, and re-install.
- **DIAMOND Seal Technology:** This faucet features a diamond-embedded ceramic disc valve that requires no lubrication and eliminates wear on seals, ensuring leak-free operation for life.

**LASTS
2X
LONGER**
— THAN —
INDUSTRY STANDARD*

DIAMOND™ Valve eliminates wear on seals ensuring **LEAK-FREE OPERATION** for the life of the faucet

InnoFlex® PEX supply lines are integrated into the faucet for **ONE LESS LEAK POINT**

**Industry standard is based on ASME A112.18.1 of 500,000 cycles*

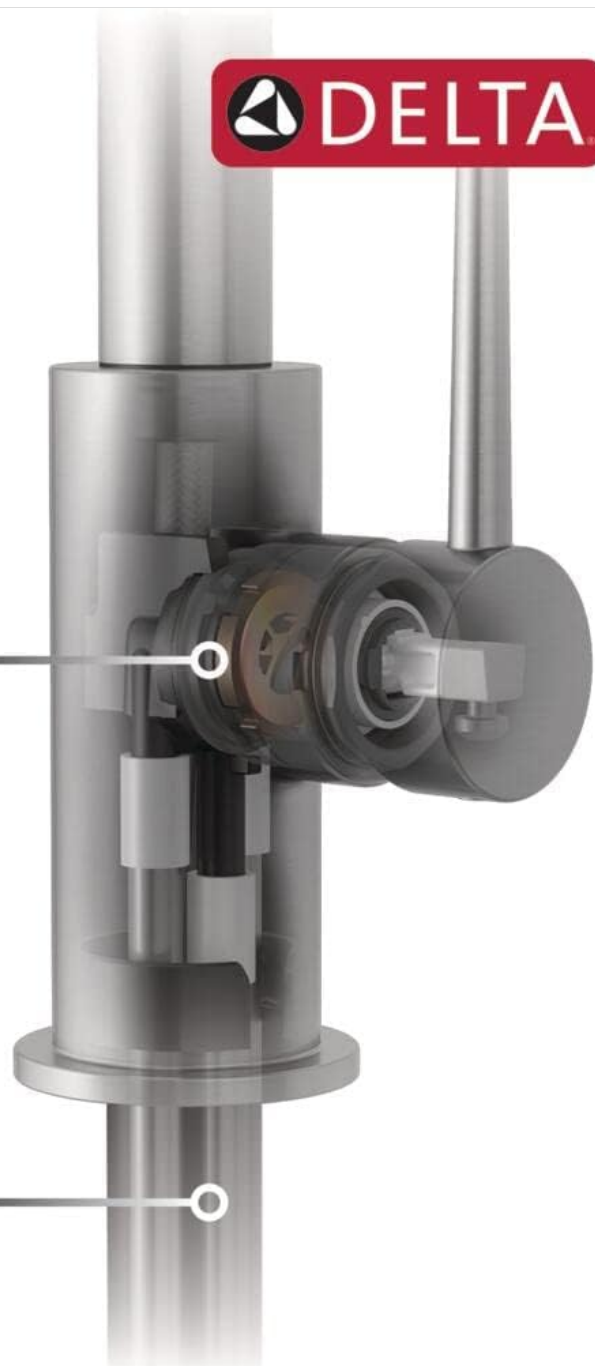

Image: Exploded view diagram illustrating the internal components of the Delta Diamond Seal Technology, emphasizing its durability and leak-free design.

TROUBLESHOOTING GUIDE

Problem	Possible Cause	Solution
Low Water Flow	Clogged aerator; partially closed shut-off valves.	Clean or replace aerator; ensure shut-off valves are fully open.
Leaks from Faucet Base	Loose mounting nut; improper gasket seating.	Tighten mounting nut; re-seat gasket.
Leaks from Supply Lines	Loose connections.	Tighten supply line connections.

Problem	Possible Cause	Solution
Water Temperature Issues	Incorrect hot/cold supply line connection; water heater issues.	Verify correct supply line connections; check water heater settings.

PRODUCT SPECIFICATIONS

Feature	Detail
Brand	DELTA
Model Name	Ashlyn®
Model Number	564-SSMPU-DST
Color	Stainless
Material	Brass
Mounting Type	Deck Mount
Number of Handles	1
Hole Count	1 (or 3 with deck plate)
Maximum Flow Rate	1.2 Gallons Per Minute
Spout Height	6.69 Inches
Spout Reach	5.13 Inches
Item Weight	4.59 pounds
Special Feature	Easy to Install

WARRANTY AND CUSTOMER SUPPORT

Your Delta Ashlyn Faucet is backed by a **Lifetime Limited Warranty**. This warranty covers defects in material and workmanship for as long as the original consumer purchaser owns the home in which the faucet was first installed.

For questions, assistance, or to make a warranty claim, please contact Delta Customer Service:

1-800-345-DELTA (3358)

For more information, visit the official Delta Faucet website.

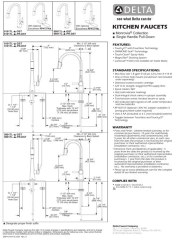
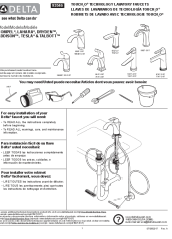
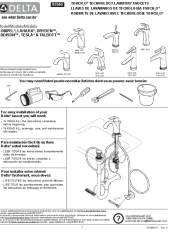

Related Documents - 564-SSMPU-DST

	<p>Delta Monrovia Collection Single Handle Pull-Down Kitchen Faucets - Specifications and Warranty</p> <p>Detailed specifications, features, warranty information, and compliance details for the Delta Monrovia Collection Single Handle Pull-Down Kitchen Faucets, including Touch2O® and DIAMOND Seal® technologies.</p>
	<p>Delta Pivotal Kitchen Faucet Installation Guide & Warranty Information</p> <p>Comprehensive installation guide for the Delta Pivotal Pullout and Pull-Down Kitchen Suite with Ribbon Spout. Includes parts lists, step-by-step instructions, Touch2O technology setup, troubleshooting, and limited warranty details.</p>
	<p>Delta Touch2O® Technology Lavatory Faucets Installation and Maintenance Manual</p> <p>Comprehensive guide for installing, maintaining, and troubleshooting Delta Touch2O® Technology Lavatory Faucets, covering various models like COMPEL®, LAHARA®, DRYDEN™, ADDISON™, TESLA®, TALBOTT™, and more. Includes warranty information and quick tips.</p>
	<p>Delta Touch2O Technology Lavatory Faucets Installation and Maintenance Guide</p> <p>Comprehensive guide for Delta Touch2O Technology Lavatory Faucets, covering installation, maintenance, troubleshooting, and warranty information for models like COMPEL, LAHARA, DRYDEN, ADDISON, TESLA, and TALBOTT.</p>
	<p>Delta Trinsic Single Handle Wall Mount Bathroom Faucet T3558LF-AWL - Product Specifications</p> <p>Detailed specifications, warranty information, and compliance details for the Delta Trinsic Single Handle Wall Mount Bathroom Faucet, model T3558LF-AWL. Includes dimensions, flow rate, and installation requirements.</p>

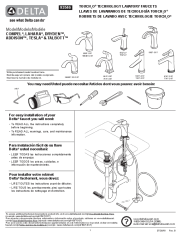

[Delta Touch2O® Technology Lavatory Faucets Installation and Maintenance Guide](#)

Comprehensive guide for installing, maintaining, and troubleshooting Delta Touch2O® Technology Lavatory Faucets, covering models like Compel, Lahara, Dryden, Addison, Tesla, and Talbott. Includes warranty information and quick tips.