

## Mitsubishi Pencil PM120T.11

# Mitsubishi Pencil PM120T.11 Procky Twin Water-Based Pens Instruction Manual

## 1. INTRODUCTION

---

This manual provides comprehensive instructions for the Mitsubishi Pencil PM120T.11 Procky Twin Water-Based Pens. These pens are designed for versatile use on various surfaces, offering vibrant, crisp colors with a dual-tip design for both fine and extra-fine applications. Please read this manual carefully to ensure proper use and maintenance of your pens.

## 2. PRODUCT FEATURES

---

- **Water-Based Pigment Ink:** Produces crisp, vivid colors without unpleasant odors.
- **Dual Tips:** Features an extra-fine tip (0.4 mm line width) and a fine round lead tip (0.9 mm line width) for varied writing and drawing needs.
- **Non-Bleed Through:** Designed to prevent ink from bleeding through most paper types.
- **Water-Resistant:** Once dry, the ink is resistant to water, preventing smudging or flowing.
- **Multi-Surface Application:** Suitable for writing on various materials including paper, metal, glass, and plastic.
- **Color:** Fuchsia (this specific product comes in a pack of 10 Fuchsia pens).



裏うつり  
しないから

模造紙に



カレンダーに



Image: Examples of Procky pens being used for creating colorful charts and marking dates on a calendar, illustrating their utility for organization and creative tasks.

乾けば水に流れない



水に  
流れない  
から

ポスターや工作物に



ダンボールに



Image: Water droplets on a surface with text written using a Procky pen, demonstrating the ink's water-resistant property once dry.

## 4. MAINTENANCE

### 4.1 Ink Refill Method

To ensure continuous use and reduce waste, Procky Twin pens are refillable. Follow these steps to replace the ink cartridge:

1. Remove the cap from the pen.
2. Gently pull out the used ink refill cartridge from the side of the pen barrel.
3. Open the new ink refill container.
4. Insert the new refill firmly into the pen barrel until it is securely in place.

### 4.2 Nib Replacement

If a nib becomes worn or damaged, it can be replaced:

1. Using a piece of paper or cloth to grip, twist and pull out the old nib.
2. Insert the new nib straight into the pen until it stops and is firmly seated.

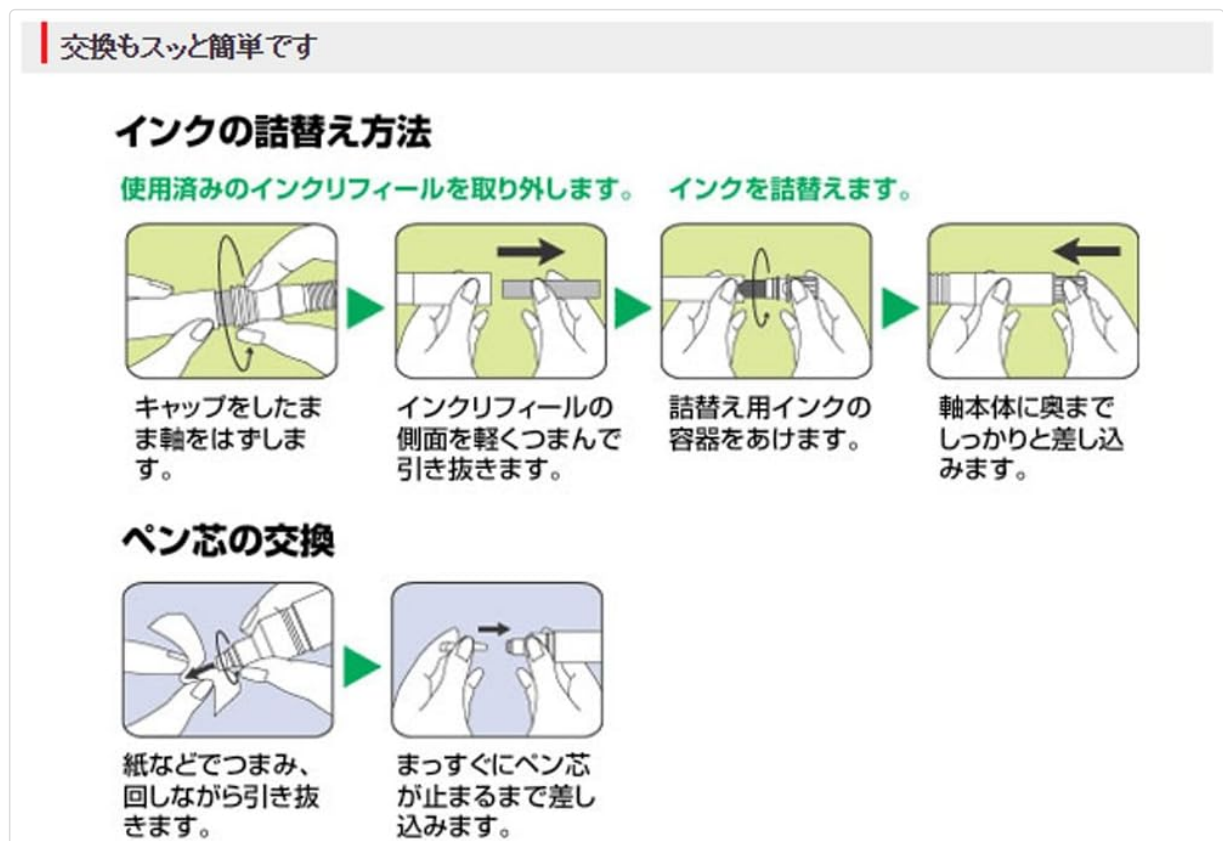

Image: A step-by-step diagram illustrating how to refill the ink cartridge and replace the nib of the Procky Twin pen.

## 5. SPECIFICATIONS

Attribute	Detail
Model Number	PM120T.11
Ink Color	Fuchsia
Point Type	Extra Fine (0.4 mm), Fine Round (0.9 mm)

Number of Items	10 pens per pack
Weight per Pen	0.4 oz (10 g)
Shaft Diameter	0.5 inches (13 mm)
Thickness	0.7 inches (17 mm)
Total Length	5.7 inches (145.6 mm)
Material Type	Suitable for writing on metal, glass, plastic, paper

## 6. TROUBLESHOOTING

---

- **Ink not flowing:** Ensure the cap is fully removed. Gently shake the pen. Try priming the tip by pressing it lightly on a scrap piece of paper for a few seconds. If the pen is old, consider replacing the ink refill.
- **Worn or damaged nib:** Refer to Section 4.2 for instructions on how to replace the nib.
- **Ink bleeding through paper:** While designed to be non-bleed, extremely thin or highly absorbent paper may still show some bleed-through. Use on appropriate paper types for best results.

## 7. WARRANTY AND SUPPORT

---

For any issues not covered in this manual, or for warranty inquiries, please contact Mitsubishi Pencil customer support. Keep your purchase receipt as proof of purchase.

**Manufacturer:** Mitsubishi Pencil

**Date First Available:** November 4, 2014