

PROFLO PFTSEC2000

PROFLO PFTSEC2000 Elongated Closed-Front Toilet Seat Instruction Manual

Model: PFTSEC2000

1. INTRODUCTION AND OVERVIEW

Thank you for choosing the PROFLO PFTSEC2000 Elongated Closed-Front Toilet Seat. This manual provides essential information for the proper installation, operation, and maintenance of your new toilet seat. Please read these instructions carefully before beginning installation to ensure correct setup and long-lasting performance.

2. PRODUCT FEATURES

- **Elongated Design:** This seat with lid is specifically designed to complement a wide variety of elongated toilet bowls.
- **Durable Construction:** Manufactured from high-quality plastic for durability and stability.
- **Quick Release System:** Features a quick-release hinge system for easy removal and reattachment, simplifying cleaning and maintenance.
- **Easy Clean:** The slide-off hinge system facilitates thorough cleaning of both the seat and the toilet bowl area.
- **Secure Mounting:** Designed for a secure mounting assembly, ensuring stability during use.

3. SETUP (INSTALLATION)

Follow these steps to install your PROFLO PFTSEC2000 toilet seat:

1. **Prepare the Toilet:** Ensure the toilet bowl is clean and dry. If replacing an old seat, remove it completely and clean the mounting area.
2. **Position the Hinges:** Place the hinge posts into the mounting holes on the toilet bowl.
3. **Secure the Mounting Hardware:** From underneath the toilet bowl, attach the washers and nuts to the hinge posts. Tighten them securely, but do not overtighten, to prevent damage.
4. **Attach the Seat:** Align the quick-release hinges on the toilet seat with the secured hinge posts. Press down firmly until the seat clicks into place.
5. **Test Stability:** Gently push on the seat to ensure it is securely attached and does not wobble.



Image: PROFLO PFTSEC2000 Elongated Closed-Front Toilet Seat installed on a white toilet. The seat is white and closed, complementing the toilet's design.

4. OPERATING (USAGE)

The PROFLO PFTSEC2000 toilet seat is designed for straightforward use and easy maintenance.

- **Lifting and Lowering:** The seat and lid can be lifted and lowered manually. Some models may feature a soft-close mechanism for quiet operation, preventing slamming.

- **Quick Release for Cleaning:** To remove the seat for cleaning, locate the quick-release buttons or levers near the hinges. Press or lift these mechanisms to detach the seat from the mounting posts.



Image: Side view of the PROFLO PFTSEC2000 Elongated Closed-Front Toilet Seat, highlighting the quick-release hinge mechanism. The seat is white and appears durable.

5. MAINTENANCE (CLEANING)

Regular cleaning will help maintain the appearance and hygiene of your toilet seat. The easy-clean slide-off hinge system simplifies this process.

- **Daily Cleaning:** Use a soft cloth or sponge with mild soap and water. Wipe down all surfaces of the seat and lid.
- **Deep Cleaning:** For a more thorough clean, utilize the quick-release feature to remove the seat. This allows access to the mounting area and the underside of the seat. Clean with a non-abrasive bathroom cleaner.
- **Avoid Harsh Chemicals:** Do not use abrasive cleaners, scouring pads, or strong chemical disinfectants, as these can damage the plastic finish.
- **Drying:** Always dry the seat and hinges thoroughly after cleaning to prevent water spots and maintain hygiene.



Image: Top-down view of the PROFLO PFTSEC2000 Elongated Closed-Front Toilet Seat, showcasing its clean white surface and elongated shape.

6. TROUBLESHOOTING

If you encounter any issues with your toilet seat, consider the following common solutions:

- **Seat Wobbles:** If the seat feels loose, remove it using the quick-release mechanism. Re-tighten the mounting nuts underneath the toilet bowl. Ensure they are snug but not overtightened.
- **Difficulty Removing/Attaching Seat:** Ensure the quick-release buttons or levers are fully engaged

or disengaged as required. Check for any obstructions around the hinge posts.

- **Lid Does Not Close Softly (if applicable):** Over time, the soft-close mechanism may wear. If this feature is critical, contact customer support for potential replacement parts or advice.

7. SPECIFICATIONS

| | |
|--------------------|---------------|
| Brand | PROFLO |
| Model Number | PFTSEC2000WH |
| Part Number | PFTSEC2000WH |
| Material | Plastic |
| Color | White |
| Style | Elongated |
| Shape | Oval |
| Product Dimensions | 18.5"L x 14"W |
| Item Weight | 3.94 pounds |
| UPC | 781889240434 |

8. WARRANTY INFORMATION

The PROFLO PFTSEC2000 Elongated Closed-Front Toilet Seat is covered under PROFLO's 1-year limited warranty. This warranty covers defects in material and workmanship under normal use and service. For specific terms and conditions, please refer to the warranty documentation provided with your purchase or contact PROFLO customer service.

9. SUPPORT INFORMATION

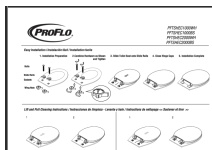

For further assistance, technical support, or to inquire about replacement parts, please contact PROFLO customer service. Contact details can typically be found on the PROFLO official website or on your product packaging.

Related Documents - PFTSEC2000



[PROFLO Toilet Seat Installation and Cleaning Guide](#)

Comprehensive guide for installing and cleaning PROFLO toilet seats, including models PFTSHEC1000WH, PFTSHEC1000BS, PFTSHEC2000WH, and PFTSHEC2000BS. Features easy installation steps and lift-and-pull cleaning instructions.

| | |
|---|--|
|  | <p>PROFLO Toilet Seat Installation and Cleaning Guide</p> <p>Step-by-step instructions for installing and cleaning PROFLO toilet seats, including models PFTSEC1000WH, PFTSEC2000WH, and PFTSEC2000BS. Features easy installation and lift-and-pull cleaning methods.</p> |
|  | <p>PROFLO HET Toilet Bowl and Tank Installation Instructions (1.28 GPF)</p> <p>Comprehensive installation guide for the PROFLO HET Toilet Bowl and Tank, featuring 1.28 gallons per flush. Includes tools needed, removal of old toilet, installation steps, adjustments, troubleshooting, and warranty information.</p> |
|  | <p>PROFLO HET Two-Piece Universal Series Toilet/Tank Installation Instructions</p> <p>This document provides comprehensive installation instructions for the PROFLO HET Two-Piece Universal Series Toilet/Tank, covering both skirted and exposed bowl models. It includes a list of necessary tools and included parts, step-by-step guidance for removing the old toilet and installing the new one, and troubleshooting tips.</p> |
|  | <p>PROFLO PF1400T Series Dual Flush Two Piece Toilet - Product Specifications</p> <p>Comprehensive product specifications, features, model details, dimensions, and certifications for the PROFLO PF1400T Series Dual Flush Two Piece Toilet. Includes warranty information and installation guidance.</p> |
|  | <p>PROFLO PF6112WH 1.28 gpf Closet Tank Parts Breakdown and Warranty Information</p> <p>Detailed parts breakdown for the PROFLO PF6112WH 1.28 gpf closet tank. Includes a list of available tank lids, internal components with part numbers, and warranty details. Features textual descriptions of diagrams and components.</p> |