

## Ledlenser T2

# Ledlenser T2 Tactical LED Torch User Manual

## 1. INTRODUCTION

The Ledlenser T2 Tactical LED Torch is a compact, robust, and high-performance illumination device designed for various applications including hunting, fishing, and general outdoor use. Engineered with a durable metal housing and a diamond-textured surface, it ensures a secure grip and resilience in demanding environments. This manual provides essential information for the proper setup, operation, and maintenance of your T2 torch.

Key features include:

- **Luminosity:** Up to 240 lumens for powerful illumination.
- **Beam Distance:** Projects light up to 180 meters (591 feet).
- **Battery Life:** Up to 25 hours on low power mode.
- **Water Resistance:** IPX6 rated, providing protection against strong jets of water.
- **Power Source:** Operates on 3x AAA alkaline batteries (included).



Image 1.1: The Ledlenser T2 Tactical LED Torch, showcasing its design and robust construction.

## 2. SAFETY INSTRUCTIONS

Please read and adhere to the following safety instructions to ensure safe operation and prevent damage to the device or injury.

- **Eye Safety:** Do not look directly into the light beam. The high intensity light can cause temporary vision impairment or permanent eye damage.
- **Children:** Keep the torch and its components out of reach of children.
- **Batteries:**
  - Use only the specified battery type (3x AAA alkaline).
  - Do not mix old and new batteries, or different types of batteries.
  - Ensure correct polarity when inserting batteries.
  - Remove batteries if the torch will not be used for an extended period to prevent leakage.
  - Dispose of used batteries according to local regulations.
- **Heat:** The torch head may become warm during prolonged use. Avoid direct contact with hot surfaces.
- **Disassembly:** Do not attempt to disassemble or modify the torch. This will void the warranty and may cause damage or injury.

### 3. PACKAGE CONTENTS

---

Verify that all items are present in the package:

- 1x Ledlenser T2 Tactical LED Torch (Model 9802)
- 3x AAA Alkaline Batteries
- 1x Hand Strap

## 4. SETUP

---

### 4.1 Battery Installation

The Ledlenser T2 requires three AAA alkaline batteries for operation. Follow these steps to install or replace the batteries:

1. Unscrew the tail cap of the torch by turning it counter-clockwise.
2. Insert three AAA alkaline batteries into the battery compartment, ensuring that the positive (+) and negative (-) terminals align with the indicators inside the torch body. Typically, the positive end of the battery faces towards the head of the torch.
3. Carefully screw the tail cap back onto the torch by turning it clockwise until it is securely tightened. Do not overtighten.



Image 4.1: The Ledlenser T2 Torch, illustrating its cylindrical body where the tail cap is located for battery access.

## 5. OPERATING INSTRUCTIONS

---

### 5.1 Turning On/Off

To turn the Ledlenser T2 Torch on or off, firmly press the tactical tail switch located at the end of the torch body.

- **Press once:** The torch will turn on in its default mode (High).
- **Press again:** The torch will turn off.

### 5.2 Changing Light Modes

The T2 torch features multiple light modes. To cycle through the available modes (High and Low), quickly press the tail switch repeatedly while the torch is on.

- **High Mode:** Provides maximum brightness (240 lumens) for long-distance illumination.
- **Low Mode:** Offers reduced brightness (25 lumens) for extended battery life and close-range tasks.

## 6. MAINTENANCE

---

Proper maintenance ensures the longevity and optimal performance of your Ledlenser T2 Torch.

- **Cleaning:** Wipe the torch body with a soft, damp cloth. Do not use abrasive cleaners or solvents, as these can damage the finish or internal components.
- **Battery Replacement:** When replacing batteries, always replace all three AAA batteries at the same time with new, fresh alkaline batteries of the same type.
- **Storage:** If the torch will not be used for an extended period, remove the batteries to prevent potential leakage and corrosion. Store the torch in a cool, dry place.
- **O-rings:** Periodically inspect the O-rings (seals) for wear and tear. A thin layer of silicone grease can be applied to maintain their water resistance properties.

## 7. TROUBLESHOOTING

If you encounter issues with your Ledlenser T2 Torch, refer to the following troubleshooting guide:

Problem	Possible Cause	Solution
Torch does not turn on.	Dead or incorrectly inserted batteries.	Check battery polarity. Replace all three AAA batteries with new ones.
Light is dim or flickers.	Low battery power. Loose tail cap.	Replace all three AAA batteries. Ensure the tail cap is securely tightened.
Tail switch is unresponsive.	Debris in switch mechanism.	Gently clean around the tail switch. If the problem persists, contact customer support.
Water ingress after exposure.	Damaged O-rings or improperly sealed tail cap.	Ensure tail cap is fully tightened. Inspect O-rings for damage and replace if necessary.

If the problem persists after attempting these solutions, please contact Ledlenser customer support.

## 8. SPECIFICATIONS

Detailed technical specifications for the Ledlenser T2 Tactical LED Torch (Model 9802):

Feature	Specification
Model Number	9802
Light Source	LED
Luminosity (Max)	240 Lumens
Luminosity (Min)	25 Lumens
Beam Distance (Max)	180 meters (591 feet)
Battery Type	3x AAA Alkaline (included)
Battery Duration (Max)	25 hours
Water Resistance	IPX6 (Water ingress resistant)
Material	Aluminum



Feature	Specification
Length	115 mm (4.5 inches)
Head Diameter	25 mm
Weight (incl. batteries)	98 grams (3.5 ounces)
Color	Black

## 9. WARRANTY AND SUPPORT

The Ledlenser T2 Tactical LED Torch is covered by a Limited Warranty. For specific details regarding warranty terms, duration, and conditions, please refer to the warranty information provided with your product packaging or visit the official Ledlenser website.

For technical support, troubleshooting assistance beyond what is provided in this manual, or to inquire about warranty claims, please contact Ledlenser customer service. You can find contact information and additional resources on the [Ledlenser Official Store](#) or their corporate website.

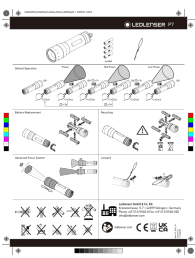
### Related Documents - T2

	<p><a href="#">Ledlenser MH5 Rechargeable Headlamp: Technical Data, Features, and Specifications</a></p> <p>Comprehensive product data sheet for the Ledlenser MH5 rechargeable headlamp, detailing its technical specifications, light performance, power options, packaging information, and warranty. Features include Advanced Focusing Optics, IP54 rating, and versatile usage modes.</p>
	<p><a href="#">LEDLENSER P7 Flashlight User Manual and Operating Guide</a></p> <p>Comprehensive guide to the LEDLENSER P7 flashlight, covering default operation, battery replacement, advanced focus system, lanyard attachment, and recycling information.</p>
	<p><a href="#">Ledlenser X21.2 High-Power Torch User Manual</a></p> <p>Comprehensive user manual for the Ledlenser X21.2 high-power torch, covering operation, features like Smart Light Technology, battery replacement, safety instructions, and specifications.</p>

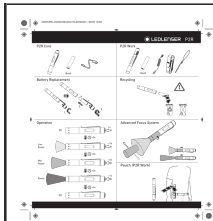

[Ledlenser P2R Core and P2R Work Flashlight User Guide](#)

Comprehensive user manual for Ledlenser P2R Core and P2R Work rechargeable flashlights, detailing operation, battery management, charging systems, and advanced features.

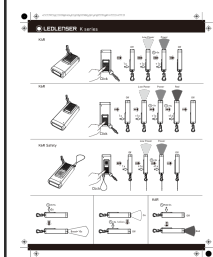

[Ledlenser K Series Flashlights: K4R, K6R, K6R Safety User Guide](#)

User guide for Ledlenser K Series rechargeable LED flashlights, including models K4R, K6R, and K6R Safety. Details operation, light modes, advanced functions, battery status, and charging.

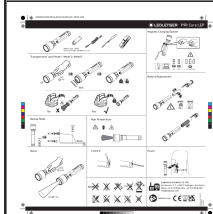

[Ledlenser P9R Core LEP Quick User Guide](#)

Concise guide to operating the Ledlenser P9R Core LEP flashlight, covering features like magnetic charging, transportation lock, backup mode, and various lighting modes.