

Genie UT110

Genie UT110 Adapter Transformer 36238A Instruction Manual

Brand: Genie | **Model:** UT110 (Also known as MGT2420, 36238A)

1. INTRODUCTION

The Genie UT110 Adapter Transformer is designed to provide a 24-volt power supply to external radio receivers used with garage door openers. This is particularly useful for garage door openers that have only two terminals on the motor or those that do not include an integrated 24-volt power supply for accessories.

This package includes the UT110 transformer, necessary wiring, and installation instructions to facilitate proper setup.



Image 1: The Genie UT110 Adapter Transformer, showing the main unit with its specifications label and a coil of connecting wire. The label indicates it is a SINO-AMERICAN GENIE AC ADAPTER, Model A22322CW, Class 2 Transformer, with input 120V 60Hz 7W and output 24VAC 210mA, made in Taiwan.

2. SETUP AND INSTALLATION

Safety First: Before beginning any installation, ensure the power to your garage door opener is disconnected at the circuit breaker to prevent electrical shock.

- Identify Power Needs:** Confirm that your garage door opener requires an external 24-volt power supply for its radio receiver. This transformer is suitable for openers with only two terminals on the motor or those lacking an internal 24-volt output.
- Mounting:** Choose a secure, dry location near the garage door opener and a standard 120V AC outlet for mounting the UT110 transformer. Ensure it is protected from physical damage and moisture.

3. Wiring Connection:

- Connect the low-voltage wires from the UT110 transformer to the appropriate terminals on your external radio receiver. Refer to your radio receiver's manual for specific terminal connections (typically marked for 24VAC input).
- Ensure all connections are secure and insulated to prevent short circuits.

4. **Power Connection:** Once the low-voltage connections are made, plug the UT110 transformer into a standard 120V AC wall outlet.

5. **Restore Power:** Reconnect power to your garage door opener at the circuit breaker.

6. **Test System:** Test the functionality of your external radio receiver and associated garage door opener accessories to ensure proper operation.

If you are unsure about any step, it is recommended to consult a qualified electrician or a garage door opener technician.

3. OPERATING INSTRUCTIONS

The Genie UT110 Adapter Transformer operates continuously once plugged into a live 120V AC outlet, providing a stable 24VAC output to the connected external radio receiver. It requires no user interaction for its primary function.

Ensure the transformer remains plugged in for the radio receiver to function. If the radio receiver or associated accessories stop working, verify the transformer is securely plugged in and receiving power.

4. MAINTENANCE

The Genie UT110 Adapter Transformer is designed for minimal maintenance. Follow these guidelines to ensure its longevity and reliable performance:

- **Keep Dry:** Ensure the transformer is installed in a dry environment, away from water, excessive humidity, or condensation.
- **Inspect Wiring:** Periodically check the wiring for any signs of wear, fraying, or damage. Replace damaged wires immediately.
- **Secure Connections:** Verify that all electrical connections remain tight and secure.
- **Cleanliness:** Keep the transformer free from dust and debris. A soft, dry cloth can be used for cleaning. Do not use liquid cleaners.

5. TROUBLESHOOTING

If your external radio receiver or keypad is not functioning, consider the following troubleshooting steps:

- **No Power to Receiver/Keypad:**
 - Check if the UT110 transformer is securely plugged into a working 120V AC outlet.
 - Verify that the circuit breaker supplying power to the outlet is not tripped.
 - Inspect the low-voltage wiring from the transformer to the receiver/keypad for any disconnections or damage.
- **Intermittent Operation:**
 - Ensure all wire connections are tight and free from corrosion.
 - Check for any physical damage to the transformer or its wires.

- **Transformer Failure:** If the transformer feels unusually hot, emits a burning smell, or shows no output voltage (requires a multimeter to test), it may have failed and needs replacement.

If troubleshooting steps do not resolve the issue, contact Genie customer support or a qualified technician.

6. SPECIFICATIONS

Feature	Detail
Model Numbers	UT110, MGT2420, 36238A
Input Voltage	120V AC, 60Hz, 7W
Output Voltage	24V AC, 210mA
Item Weight	1.19 pounds (approx. 0.54 kg)
Product Dimensions	6 x 3 x 2 inches (approx. 15.24 x 7.62 x 5.08 cm)
Manufacturer	The Genie Company

Note: Specifications are subject to change without notice.

7. WARRANTY AND SUPPORT

For specific warranty information regarding your Genie UT110 Adapter Transformer, please refer to the documentation included with your purchase or contact The Genie Company directly. Warranty terms may vary based on purchase location and retailer.

For technical support, replacement parts, or further assistance, please visit the official Genie website or contact their customer service department. You can find more information at the [Genie Store on Amazon](#).

© 2023 Genie Company. All rights reserved.

This manual is for informational purposes only. Genie assumes no responsibility for errors or omissions.

Related Documents - UT110

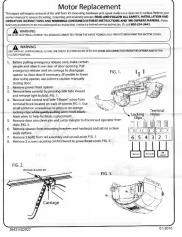
	<p>Genie External Antenna Kit Installation Guide</p> <p>Step-by-step instructions for installing the Genie 3436133491 External Antenna Kit on residential or commercial garage door operators, including disassembly and wiring.</p>
	<p>Genie Garage Door Opener Motor Replacement Guide</p> <p>Step-by-step instructions for replacing the motor in a Genie garage door opener, including safety precautions and detailed diagram descriptions.</p>

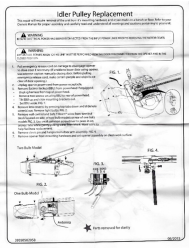

[Genie Idler Pulley Replacement Guide](#)

Step-by-step instructions for replacing the idler pulley on a Genie garage door opener. Includes warnings, required tools, and detailed procedures for safe and effective repair.



[Genie Garage Door Opener Programming Guide: Residential & Commercial Models](#)

Comprehensive guide for programming Genie residential and commercial garage door openers, including models from 1995 to current production. Learn how to program remotes, change batteries, and troubleshoot common issues. Covers various programming button pad types and safety warnings.



[How to Change or Replace Your Genie Wireless Keypad Cover](#)

Step-by-step instructions for changing or replacing the cover on your Genie wireless keypad. Learn how to safely remove the old cover and install the new one with this guide.



[Genie DC Cover Replacement Guide](#)

Detailed instructions for replacing the DC cover on Genie garage door openers, including safety precautions and step-by-step procedures.