

## Samsung SHS-P710

# Samsung SHS-P710 Digital Door Lock User Manual

Model: SHS-P710

## 1. INTRODUCTION

This manual provides detailed instructions for the installation, operation, and maintenance of your Samsung SHS-P710 Digital Door Lock. Please read this manual thoroughly before using the product to ensure proper function and safety. The SHS-P710 is a keyless touchpad security lock featuring a unique Push Pull design, multiple access methods, and advanced safety features.



Image 1.1: Front and side view of the Samsung SHS-P710 Digital Door Lock, showcasing its sleek design.

## 2. PRODUCT FEATURES

The Samsung SHS-P710 Digital Door Lock incorporates several innovative features designed for enhanced security and user convenience:

- **Push Pull Innovation:** The lock features a unique handle design that allows you to open the door by simply pushing or pulling the handle from either side.
- **Touch-screen Based Keypad:** A responsive touch-screen keypad for entering passwords.
- **Multiple Access Methods:** Supports access via password, RFID Key Tags, RFID Cards, and remote control.
- **Dual-way Security (Magic Number):** Enhances security by requiring a random number input before the main password.
- **Automatic Locking:** The door locks automatically upon closing, eliminating concerns about forgetting to lock it.
- **Fire Detection Sensor:** An integrated sensor detects indoor temperatures of 60 degrees Celsius or above, triggering an alarm and automatically releasing the lock for emergency exit.

- **Intrusion Detection Alarm:** An alarm sounds upon physical shocks or repeated incorrect authentication attempts to deter unauthorized entry.
- **Crime Setting Feature:** Activates an alarm if the door lock is operated from inside the home when this feature is enabled, useful when leaving the premises.
- **Manual Switchgear:** In case of electronic malfunction, the door can be opened using a manual lever.
- **Electric Shock Protection:** Designed with circuit technology to withstand high-voltage electric shocks, enhancing safety.
- **Silent Mode:** Allows adjustment of volume or muting of key tones and door opening melodies for quiet entry/exit.
- **Battery Dead Alarm:** Notifies users when batteries are low through a specific melody and keypad LED.
- **Welcome Function:** The keypad lights up as you approach the door, eliminating the need to touch it with your hands.
- **Randomizer:** Guides users to press two random numbers before entering the password to prevent fingerprint residue patterns.
- **Away Mode:** A dedicated button to activate an anti-theft mode when leaving home for extended periods.
- **Emergency Power Supply:** Allows temporary power supply via a 9V battery if the main batteries are fully discharged.
- **Prank Warning:** If an incorrect password is entered five times consecutively, the lock disables key authentication for three minutes and sounds an alarm.
- **Abnormal High Temperature Warning:** In addition to the fire detection sensor, a light on the indoor side of the lock flashes, and the door automatically opens for swift evacuation.

## Silent Mode

If you have a little child or often enter/exit your home late at night, you can adjust the volume or mute the key tone or the door opening melody for your family or neighborhood



## Battery Dead Alarm

If the batteries are running low, the door lock informs you through a specific melody or keypad LED. You can easily replace the batteries without having to check the battery life



## Welcome Function

As you get close to the door, the door lock greets you with LED light on the key pad. You don't even need to touch the keypad with your hands. A warning tone sounds if someone hovers in front of the door lock for over a minute



## Randomizer

Before you enter your password, you are guided to push two random numbers to prevent the password from being inferred based on the fingerprints on the frequently pushed numbers and from being seen by anyone nearby



## Away mode for long-term leave

If you go out frequently or leave the home for a long time, you can simply push the Home button to activate the Away mode



## Emergency power supply

If you fail to replace the batteries before they are fully discharged, you can still open the door with a 9V battery on the instant battery charging terminal



## Prank Warning

If you pull the door forcefully or enter an incorrect password more than five times consecutively, the door lock sounds a warning and disables key authentication for three minutes to help prevent trespassing

## Abnormal High Temperature Warning

If an abnormally high temperature is sensed inside the home, a light on the interior side of the door lock flickers showing you the emergency exit. The door lock automatically opens for swift evacuation.

Image 2.1: Visual representation of various operational features like Silent Mode, Battery Alarm, and Emergency Power.

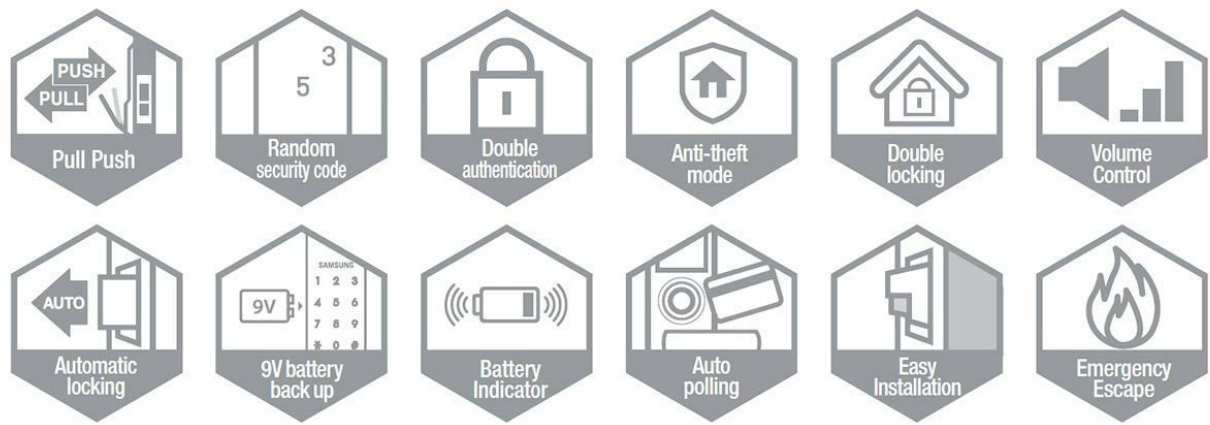

	Specifications	
Voltage	AA Alkaline 1.5 Batteries (LR6) 8EA (6V) (Separately sold)	
Emergency Power Source	9V Battery (6LF22) (Separately sold)	
Operation Method	Electronic Control Method (Password, Card, Key Tag)	
Weight	4.1 kg (including both inner and outer bodies)	
Product Dimensions	Outer Body (including the handle)	85mm (W) X 346.5mm(H) X 61mm(D)
	Inner Body (including the handle)	86mm (W) X 354.8mm(H) X 63mm(D)

Image 2.2: Icons illustrating key functionalities and safety features of the door lock.

### 3. SETUP AND INSTALLATION

Proper installation is crucial for the optimal performance and security of your digital door lock. It is recommended to have the installation performed by a qualified technician.

#### 3.1 Door Requirements

- **Applicable Door Thickness:** 38mm - 55mm (1.5 inches - 2.17 inches).
- **Mortise Model:** SHS-AML240.



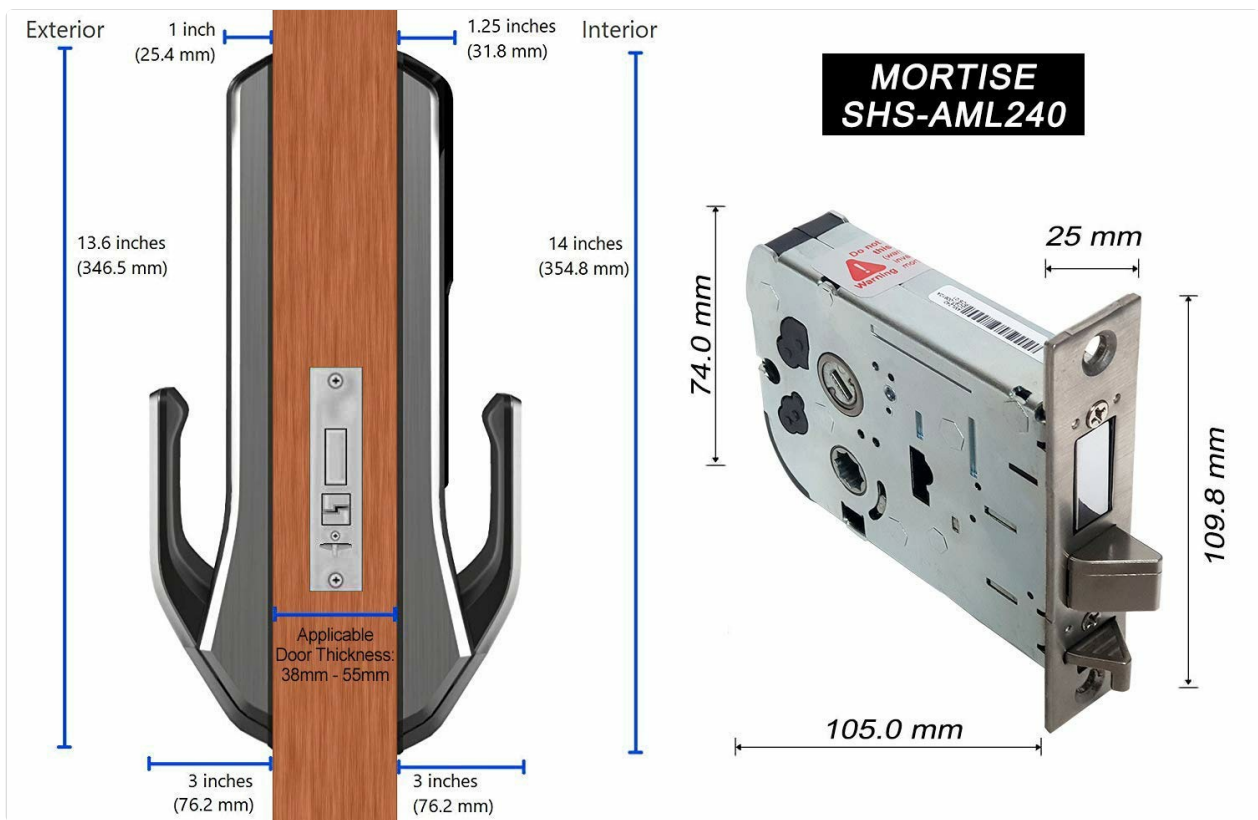

Image 3.1: Door thickness compatibility and detailed dimensions of the SHS-AML240 mortise.

### 3.2 Installation Steps (Overview)

The following is a general overview of the installation process. Refer to the detailed installation guide provided with your product for precise instructions.

1. Prepare the door by drilling necessary holes according to the template.
2. Install the mortise (SHS-AML240) into the door edge.
3. Mount the outside main body onto the door, ensuring the handle control shaft and dead bolt latch bolt are correctly aligned.
4. Install the inside main body, connecting the necessary cables.
5. Secure the inside fixed panel and rubber pad.
6. Install the battery cover and insert batteries.
7. Install the strike and strike box on the doorframe.
8. Test all functions, including locking, unlocking, and alarms.

# INSTALLATION

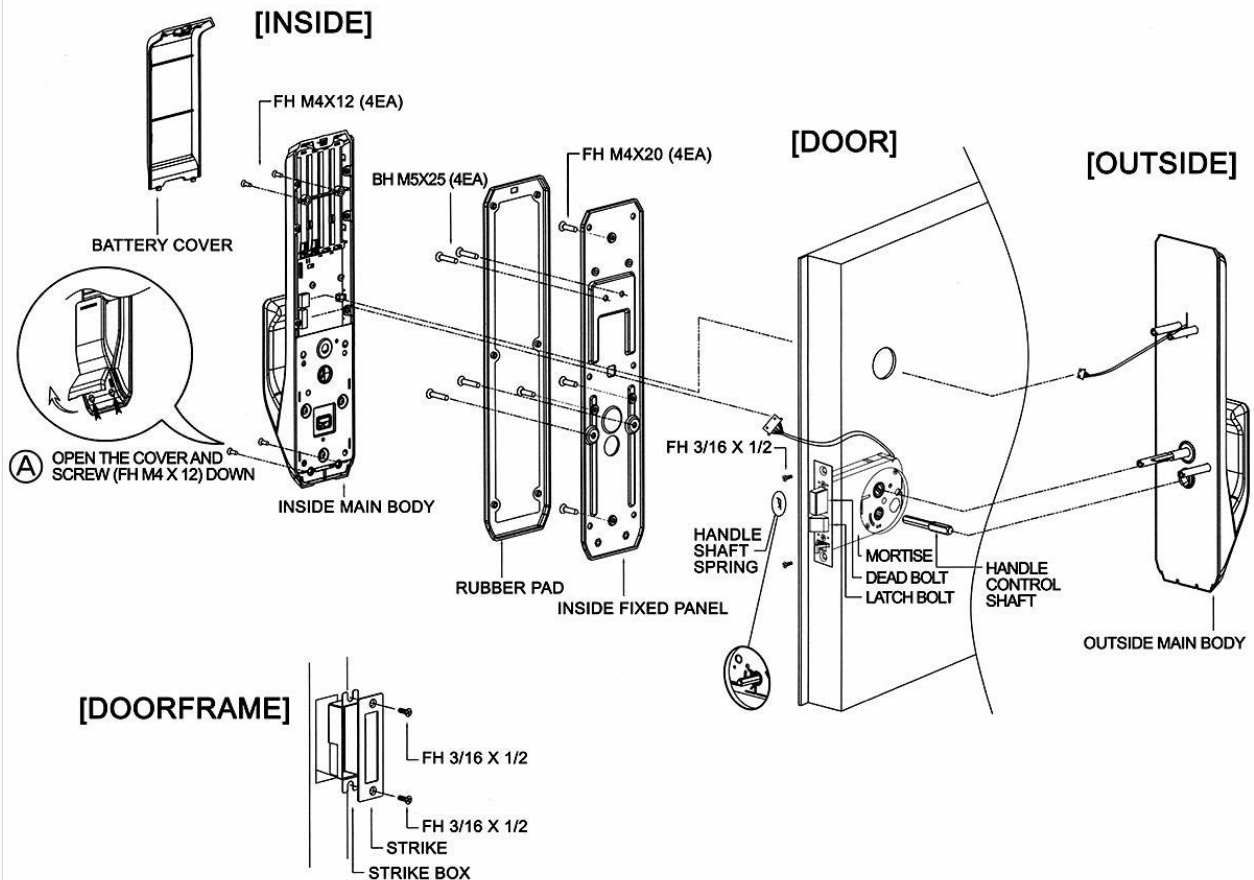

Image 3.2: Exploded diagram illustrating the installation components and their placement.

## 4. OPERATING INSTRUCTIONS

The SHS-P710 offers various methods for accessing and securing your door.

### 4.1 Accessing the Door

- **Password Entry:** Touch the keypad to activate. Enter your registered password followed by the '\*' button. The door will unlock.
- **RFID Key Tag/Card:** Place a registered RFID Key Tag or Card on the reader area of the outdoor unit. The door will unlock.
- **Remote Control:** Press the unlock button on the remote control. Ensure the remote module is installed in the lock.



Image 4.1: Included accessories: remote control, RFID cards, and key tags.

## 4.2 Locking the Door

- **Automatic Locking:** The door will automatically lock a few seconds after closing.
- **Manual Locking (from outside):** Touch the keypad or press the '\*' button after closing the door.
- **Manual Locking (from inside):** Press the close/lock button on the indoor unit.

## 4.3 Special Functions

- **Silent Mode:** To activate/deactivate, refer to the detailed programming instructions in the full manual. This mode mutes key tones and opening melodies.
- **Away Mode (Anti-theft):** Press the 'Home' button on the indoor unit when leaving for an extended period. An alarm will sound if the door is operated from inside.
- **Double Locking:** This feature provides additional security by preventing the door from being opened from the outside even with a valid key or password. Activate from the indoor unit.
- **Volume Control:** Adjust the lock's sound volume through the settings menu (refer to the full manual for steps).

## 5. MAINTENANCE

Regular maintenance ensures the longevity and reliable operation of your digital door lock.

### 5.1 Battery Replacement

- The lock uses AA Alkaline 1.5V batteries (LR6) 8EA (6V).
- When the battery dead alarm sounds, replace all batteries promptly.
- To replace, open the battery cover on the indoor unit, remove old batteries, and insert new ones, observing polarity.



## 5.2 Emergency Power Supply

- If the batteries are completely drained, you can temporarily power the lock using a 9V battery (6LF22).
- Connect the 9V battery to the emergency power terminals on the outdoor unit.
- While holding the 9V battery, enter your password or use an RFID key to unlock the door.

## 5.3 Cleaning

- Wipe the lock's surface with a soft, dry cloth.
- Do not use abrasive cleaners, solvents, or harsh chemicals, as these can damage the finish and electronic components.

# 6. TROUBLESHOOTING

This section addresses common issues you might encounter with your SHS-P710 digital door lock.

Problem	Possible Cause	Solution
Door does not lock automatically.	Automatic locking feature is disabled or misaligned.	Check settings to ensure automatic locking is enabled. Verify door alignment and strike plate position.
Keypad does not respond.	Batteries are low or dead; lock is in prank warning mode.	Replace batteries. Wait 3 minutes if prank warning is active. Use 9V emergency power if needed.
Alarm sounds unexpectedly.	Intrusion detected; high temperature detected; crime setting active.	Check for forced entry attempts. Verify indoor temperature. Deactivate crime setting if not needed.
Cannot open with remote control.	Remote module not installed; remote batteries dead; remote not paired.	Ensure remote module is correctly installed. Replace remote batteries. Refer to manual for remote pairing instructions.
Door is stuck or difficult to operate.	Mechanical obstruction; electronic malfunction.	Check for physical obstructions. If electronic, use the manual switchgear. Contact support if issue persists.

# 7. SPECIFICATIONS

Detailed technical specifications for the Samsung SHS-P710 Digital Door Lock.

Feature	Specification
Brand	Samsung
Model Name	SHS-P710 (FBA_SHS-P710R)
Lock Type	Biometric (Touchpad), Digital

Feature	Specification
Control Method	Remote, Touch
Operation Method	Electronic Control (Password, Card, Key Tag)
Power Source	AA Alkaline 1.5 Batteries (LR6) 8EA (6V) (Separately sold)
Emergency Power Source	9V Battery (6LF22) (Separately sold)
Item Weight	4.1 kg (including both inner and outer bodies) / 10 Pounds
Outer Body Dimensions (W x H x D)	85mm x 346.5mm x 61mm
Inner Body Dimensions (W x H x D)	86mm x 354.8mm x 63mm
Applicable Door Thickness	38mm - 55mm
Mortise Model	SHS-AML240

## 8. WARRANTY AND SUPPORT

Information regarding product warranty and customer support was not available in the provided data. Please refer to the product packaging or contact Samsung customer service for details on warranty coverage and support options.