

[Manuals.plus](#) /

› [UPBRIGHT](#) /

› UpBright 12V AC/DC Adapter Instruction Manual for Zebra MZ 220 iMZ320 Power Supply

UPBRIGHT Zebra MZ 220 iMZ320 12V Power Supply

UpBright 12V AC/DC Adapter Instruction Manual for Zebra MZ 220 iMZ320 Power Supply

INTRODUCTION

This manual provides essential instructions for the safe and effective use of your UpBright 12V AC/DC Adapter. This adapter, model Zebra MZ 220 iMZ320 12V Power Supply, is designed to provide reliable power to compatible Zebra MZ and iMZ Series Mobile Bluetooth Printers. Please read this manual thoroughly before use and retain it for future reference.

PRODUCT OVERVIEW

The UpBright 12V AC/DC Adapter is a switching mode power supply designed for global use, supporting input voltages from 100-240VAC. It provides a stable 12V DC output suitable for various portable devices, specifically Zebra mobile printers. The adapter includes built-in safety features such as Over Voltage Protection (OVP), Over Current Protection (OCP), and Short Circuit Protection (SCP).



Figure 1: The UpBright 12V AC/DC Adapter with its integrated power cable, ready for connection.

SETUP

Follow these steps to properly set up your AC/DC adapter:

1. **Verify Compatibility:** Ensure the adapter's output voltage (12V) and connector type match your device's requirements. This adapter is specifically designed for Zebra MZ and iMZ Series Mobile Bluetooth Printers.
2. **Check Connector Tip:** Confirm the adapter's tip is compatible with your device's power input port. The adapter features a small tip without an internal pin.



Figure 2: Illustration of the correct 'Small Tip' connector type (left) and incompatible tip types (middle and right) for proper device connection.

3. **Connect to Device:** Carefully insert the adapter's DC output plug into the power input port of your Zebra mobile printer. Ensure a snug fit.
4. **Connect to Power Outlet:** Plug the AC input prongs of the adapter into a standard wall power outlet (100-240VAC, 50/60Hz).
5. **Verify Polarity:** The adapter is designed with a specific polarity. Ensure your device also uses the same polarity (center positive).

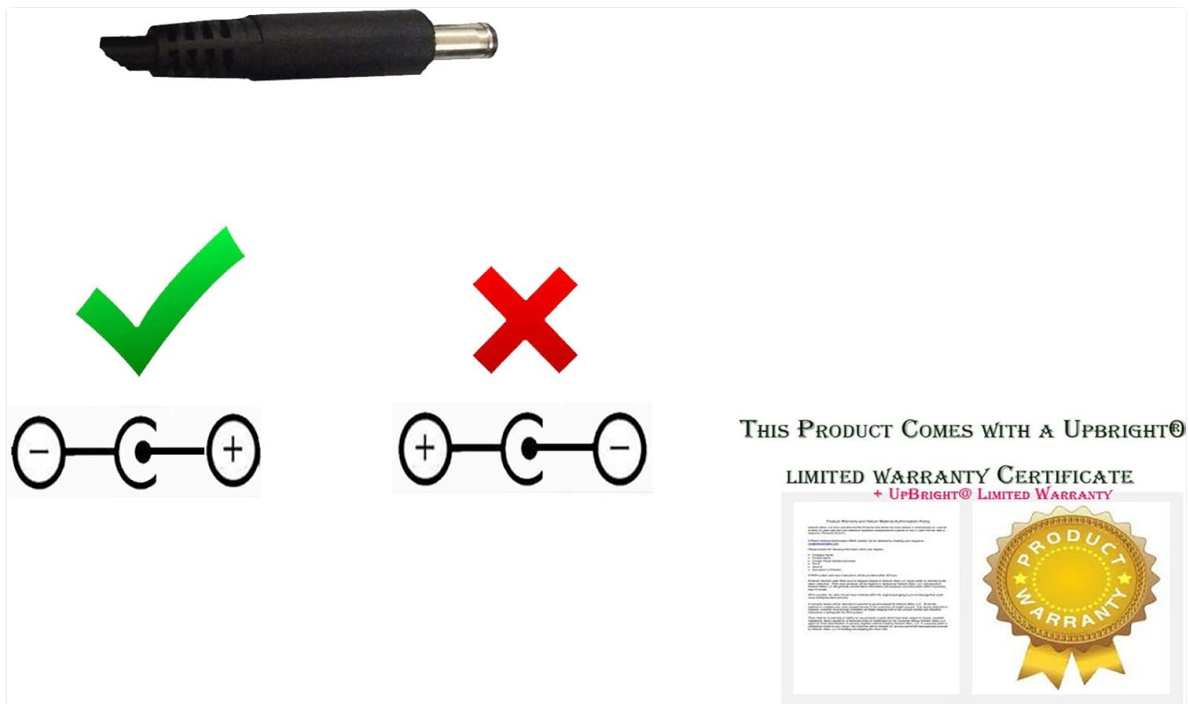

Figure 3: Visual guide for correct polarity (center positive, indicated by the checkmark) and incorrect polarity (indicated by the cross).

OPERATING INSTRUCTIONS

Once properly connected, the adapter will automatically supply power to your device. No further user interaction is required for basic operation. The adapter is designed for continuous use within its specified operating parameters.

- The adapter features a wide input voltage range (100-240VAC), making it suitable for international travel with appropriate plug adapters.

Come With A Suitable Outlet Adapter (Only One) to Fit
Your Country/Area For International Order

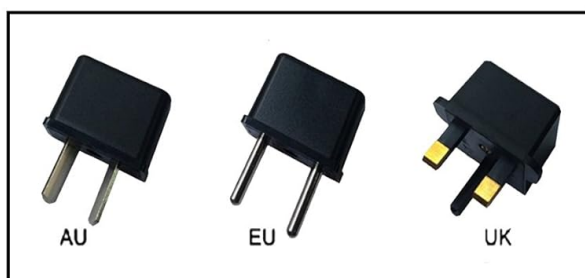

Figure 4: Examples of suitable international outlet adapters (AU, EU, UK) for global use with the wide input voltage range.

- The adapter's built-in protection mechanisms (OVP, OCP, SCP) safeguard both the adapter and your connected device from electrical hazards.

MAINTENANCE

To ensure the longevity and optimal performance of your UpBright AC/DC Adapter, follow these simple maintenance guidelines:

- **Keep Dry:** Avoid exposing the adapter to water, moisture, or high humidity.
- **Clean Gently:** Use a soft, dry cloth to clean the adapter. Do not use liquid cleaners or aerosols.
- **Avoid Extreme Temperatures:** Do not operate or store the adapter in excessively hot or cold environments.
- **Handle with Care:** Avoid dropping the adapter or subjecting it to strong impacts. Do not bend or crimp the power cord excessively.
- **Unplug When Not in Use:** For extended periods of non-use, unplug the adapter from both the wall outlet and the device.

TROUBLESHOOTING

If you encounter issues with your adapter, refer to the following troubleshooting steps:

- **No Power to Device:**
 - Ensure the adapter is securely plugged into a functional wall outlet.
 - Verify the DC output plug is firmly connected to your device's power input.
 - Test the wall outlet with another known working appliance to confirm it has power.
 - Check for any visible damage to the adapter's cable or housing.
- **Device Not Charging/Operating Correctly:**
 - Confirm that the adapter's specifications (voltage, amperage, tip type, polarity) precisely match your device's requirements. Refer to your device's manual.
 - Ensure the device itself is functioning correctly by testing it with its original power supply, if available.
- **Adapter Overheating:**
 - Unplug the adapter immediately.
 - Ensure the adapter is not covered or placed in an enclosed space that restricts airflow.
 - Verify that the adapter is not overloaded by connecting it to an incompatible device.

If these steps do not resolve the issue, please contact UpBright customer support.

SPECIFICATIONS

Input Voltage	100-240VAC, 50/60Hz
Output Voltage	12VDC
Output Current	1.25A - 2A (1250mA - 2000mA)
Wattage	15W - 24W
Protection Features	Over Voltage Protection (OVP), Over Current Protection (OCP), Short Circuit Protection (SCP)
Product Dimensions	4 x 3 x 2 inches

Item Weight	3.98 ounces
Compatible Devices	Zebra MZ Series Mobile Printers (MZ220, MZ320), Zebra iMZ Series Mobile Printers (iMZ220, iMZ320)
Included Components	1 x 2-Pin Power Adapter

WARRANTY

UpBright offers the following warranty for this product:

- **Refund Policy:** 30 Days Refund.
- **Exchange Policy:** 24 Months Exchange.

Please retain your proof of purchase for warranty claims. The product also comes with a Limited Warranty Certificate.



Figure 5: A visual representation of the Limited Warranty Certificate and Product Warranty seal provided with the UpBright adapter.

For further assistance, technical support, or warranty inquiries, please contact UpBright customer service. Refer to the contact information provided with your purchase or on the official UpBright website.

Note: Always ensure you are using the correct power adapter for your device to prevent damage and ensure safe operation.