

Kingston Brass GKB231

Kingston Brass GKB231 Magellan Tub and Shower Faucet User Manual

Model: GKB231

INTRODUCTION

This manual provides detailed instructions for the installation, operation, and maintenance of your Kingston Brass GKB231 Magellan Tub and Shower Faucet. Please read this manual thoroughly before beginning installation or use to ensure proper function and longevity of the product. Retain this manual for future reference.



Image 1: Kingston Brass GKB231 Magellan Tub and Shower Faucet, Polished Chrome finish. This image displays the complete faucet system, including the shower head, three control handles, and the tub spout.

SAFETY INFORMATION

Please observe the following safety precautions during installation and use:

- Always turn off the main water supply before beginning any plumbing work.
- Wear appropriate personal protective equipment, such as safety glasses and gloves.
- If you are unsure about any part of the installation process, consult a qualified plumber.
- Ensure all connections are secure to prevent leaks.

- Do not overtighten components, as this can cause damage.
- This product is designed for standard residential plumbing systems.

PACKAGE CONTENTS

Verify that all components are present before beginning installation:

- Faucet Assembly (including shower head, handles, and tub spout)
- Mounting Hardware
- Internal Valve Hardware

SPECIFICATIONS

Brand	Kingston Brass
Model Number	GKB231
Color	Polished Chrome
Material	Brass
Finish Type	Polished
Number of Handles	Three
Mounting Type	Wall Mount (Tub Wall Mount)
Connection Size	Standard 1/2" IPS
Item Weight	5.09 pounds
Product Dimensions	11.68 x 8 x 7.75 inches
Spout Reach	4.63 Inches
Cartridge Type	Durable Washerless

INSTALLATION

This section outlines the general steps for installing the Kingston Brass GKB231 Tub and Shower Faucet. It is recommended to consult a professional plumber for installation to ensure compliance with local codes and proper function.

Tools and Materials Required (Not Included):

- Adjustable wrench
- Pipe thread sealant (Teflon tape or pipe dope)
- Screwdriver (Phillips and flathead)
- Measuring tape
- Level

- Safety glasses and gloves

Installation Steps:

1. **Prepare the Installation Area:** Turn off the main water supply to your home. Drain any remaining water from the pipes. Clear the area around the tub and shower wall.
2. **Rough-in Plumbing:** Ensure your wall plumbing is set up for a three-handle, wall-mount tub and shower faucet with standard 1/2" IPS connections. The internal valve hardware should be installed according to standard plumbing practices.
3. **Install the Faucet Body:** Position the faucet body and secure it to the wall using the provided mounting hardware. Ensure it is level and properly aligned.
4. **Connect Water Lines:** Connect the hot and cold water supply lines to the appropriate inlets on the faucet body. Apply pipe thread sealant to all threaded connections to prevent leaks.
5. **Install Tub Spout:** Thread the tub spout onto its connection point. Ensure it is securely tightened and facing downwards into the tub.
6. **Install Shower Head:** Attach the shower arm to the wall connection, applying pipe thread sealant. Then, thread the shower head onto the shower arm. Adjust the angle as desired.
7. **Install Handles:** Attach the three control handles (hot, cold, and diverter) to their respective stems. Secure them with any provided set screws or caps.
8. **Test for Leaks:** Slowly turn on the main water supply. Check all connections for leaks. If leaks are detected, turn off the water, tighten the connections, and retest.

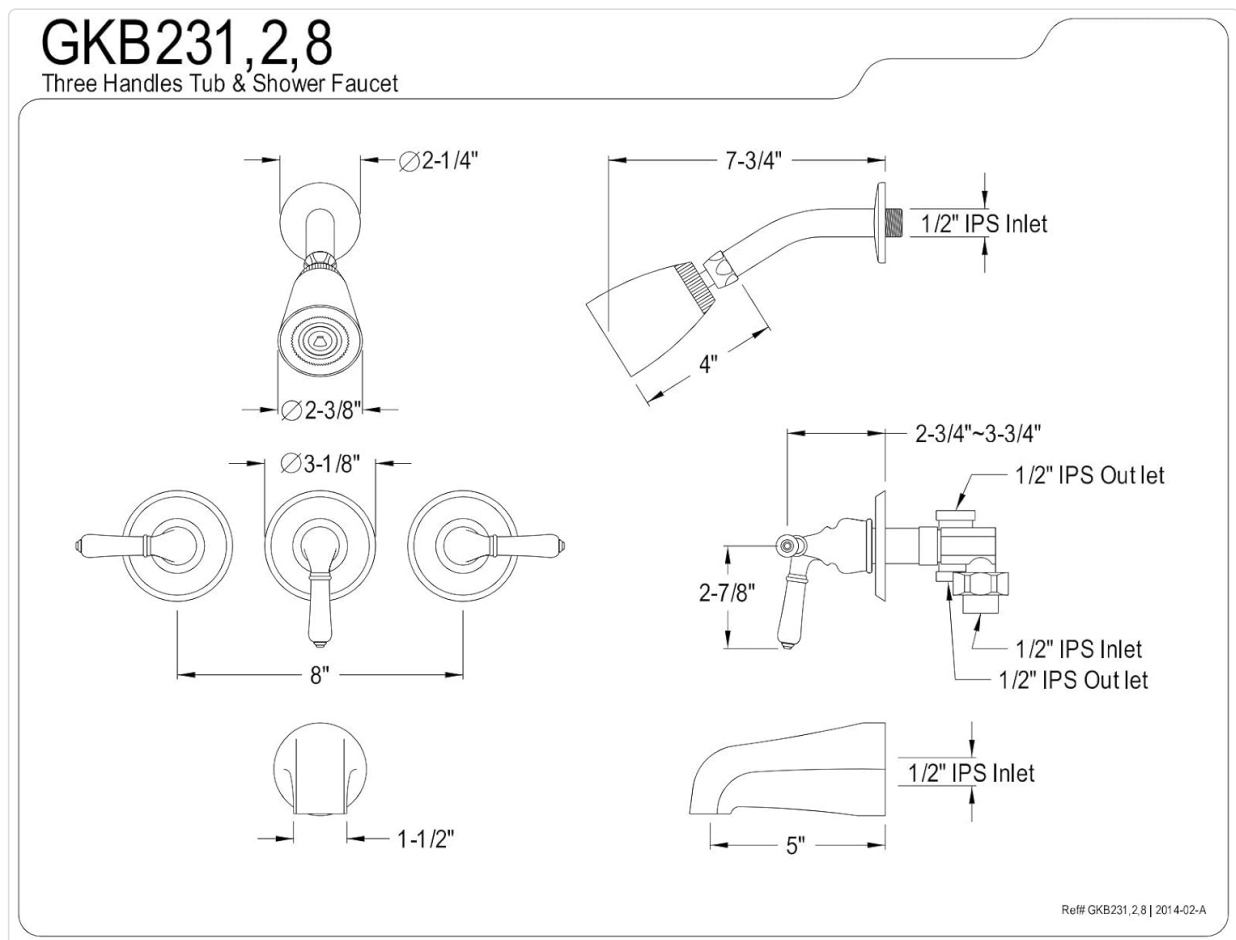

Image 2: Technical diagram illustrating the dimensions and connection points for the Kingston Brass GKB231 Tub and Shower Faucet. This diagram provides critical measurements for rough-in plumbing and component placement, including 1/2" IPS inlets and outlets.

OPERATION

The Kingston Brass GKB231 Magellan Tub and Shower Faucet features a three-handle design for precise control over water temperature and flow direction.

- **Hot Water Handle:** Typically located on the left. Turn counter-clockwise to increase hot water flow.
- **Cold Water Handle:** Typically located on the right. Turn counter-clockwise to increase cold water flow.
- **Diverter Handle:** Located in the center. Turn this handle to switch water flow between the tub spout and the shower head.

Adjust the hot and cold handles to achieve your desired water temperature. Use the diverter handle to select between filling the tub or using the shower.

MAINTENANCE

Regular cleaning and maintenance will help preserve the finish and functionality of your faucet.

- **Cleaning the Finish:** Clean the polished chrome finish with a soft, damp cloth and mild soap. Avoid abrasive cleaners, harsh chemicals, or scouring pads, as these can damage the finish. Rinse thoroughly and dry with a soft cloth to prevent water spots.
- **Cleaning the Shower Head:** Periodically check the shower head nozzles for mineral buildup. If clogged, gently rub the rubber nozzles to dislodge deposits or soak the shower head in a solution of white vinegar and water.
- **Washerless Cartridges:** The faucet uses durable washerless cartridges, which generally require less maintenance. If you experience persistent drips or difficulty turning the handles, the cartridges may need to be inspected or replaced.

TROUBLESHOOTING

Here are some common issues and their potential solutions:

Issue: Leaking from handles or spout.

Solution:

- Ensure all connections are securely tightened.
- The internal washerless cartridge may need to be replaced. Turn off water supply before attempting replacement.

Issue: Low water pressure from shower head or tub spout.

Solution:

- Check for mineral buildup in the shower head nozzles or tub spout aerator. Clean as described in the Maintenance section.
- Verify that the main water supply is fully open.
- Inspect the water lines for any kinks or obstructions.

Issue: Handles are stiff or difficult to turn.

Solution:

- Mineral deposits can accumulate around the cartridge. Cleaning or replacing the cartridge may resolve

this.

- Ensure the handle screws are not overtightened.

If these troubleshooting steps do not resolve the issue, please contact customer support or a qualified plumber.

WARRANTY INFORMATION



Kingston Brass products are typically backed by a limited warranty. For specific warranty terms and conditions applicable to your GKB231 Magellan Tub and Shower Faucet, please refer to the official Kingston Brass website or contact their customer service department. Keep your proof of purchase for warranty claims.



CUSTOMER SUPPORT

For further assistance, technical support, or to order replacement parts, please contact Kingston Brass customer service:

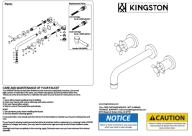
- **Website:** www.kingstonbrass.com
- Refer to the product packaging or the Kingston Brass website for current contact information, including phone numbers and email addresses.

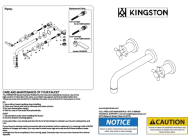
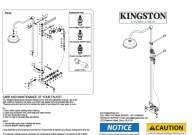
Related Documents - GKB231

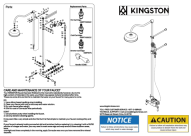
	<p>Kingston Brass Twin Handles Wall Mount Faucet Installation and Care Guide</p> <p>Comprehensive guide for installing and maintaining your Kingston Brass Twin Handles Wall Mount Faucet. Includes parts list, step-by-step instructions, and care tips.</p>
	<p>Kingston Brass CCK266K8 Tub Filler with Supply Line & Stop Valve Installation Instructions</p> <p>Comprehensive installation guide for the Kingston Brass CCK266K8 freestanding tub filler faucet, covering parts, tools, step-by-step instructions, and essential safety warnings for proper setup.</p>
	<p>Kingston Brass Twin Handles Wall Mount Faucet Installation and Care Guide</p> <p>Comprehensive guide for installing and maintaining your Kingston Brass Twin Handles Wall Mount Faucet. Includes parts list, step-by-step installation instructions, and essential care tips to preserve the faucet's finish.</p>
	<p>Kingston Brass Wall Mount Shower Combination Installation Guide and Care</p> <p>Detailed installation instructions and care guide for the Kingston Brass Wall Mount Shower Combination. Includes parts list, maintenance tips, and important safety warnings.</p>

	<p>Kingston Brass Wall Mount Shower Combination Installation and Maintenance Guide</p> <p>Comprehensive installation and maintenance guide for the Kingston Brass Wall Mount Shower Combination, including parts lists, tool requirements, step-by-step instructions, and care tips.</p>
	<p>Kingston Brass Pressure Balancing Valve Tub & Shower Unit Installation Instructions</p> <p>Comprehensive installation, repair, and maintenance guide for Kingston Brass Pressure Balancing Valve Tub & Shower Units, including reversible cartridge instructions and step-by-step assembly.</p>

Documents - Kingston Brass – GKB231

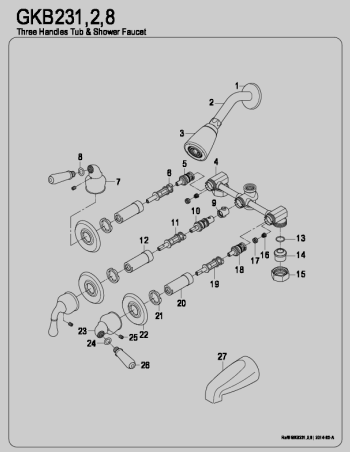

[\[pdf\]](#) Instructions Diagram

GKB231 2 8 zoeywang Read instructions KINGSTON BRASS GKB232 MAGELLAN WATER SAVING 3 HANDLE TUB AND SHOWER FAUCET WITH SAVINGS SHOWERHEAD Parts Diagram kbauthority files Kingston Brass New |||

...

lang: **score:27** filesize: 182.54 K page_count: 1 document date: 2014-02-07

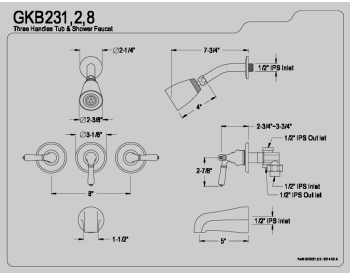

[\[pdf\]](#) Specifications

GKB231 2 8 zoeywang Click Here Kingston Brass Magellan Tub and Shower Trim Package with 1 5 GPM Single Function Head Specification Sheet kingston brass gkb23 specification sheet s1 img b build mediabase specifications 528908 |||

...

lang: **score:14** filesize: 80.9 K page_count: 1 document date: 2014-03-24

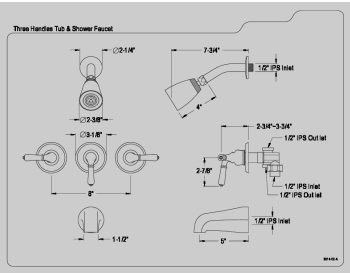

[\[pdf\]](#) Specifications Catalog

GKB231 2 8 zoeywang Magellan 3 Handle 1 Spray Tub and Shower Faucet with Showerhead in Brushed Nickel Valve Included Specification Kingston Brass HGKB238 663370998218 0663370998218 1006446929 55cde65f 8e93 4225 810b 510bd6f3ee82 images thdstatic catalog Images 55 |||

...

lang: **score:12** filesize: 148.44 K page_count: 1 document date: 2021-02-22

GKB231,2,8
Three Handles Tub & Shower Faucet

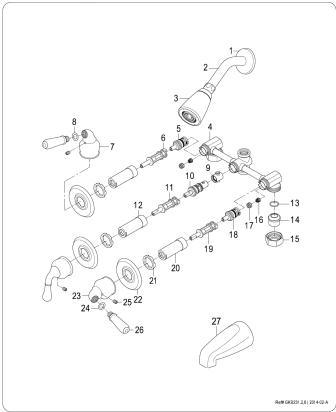

[pdf] Diagram

GKB231 2 8 zoeywang Untitled KB AuthorityGKB231 Three Handles Tub Shower Faucet 23 24 3 5 4 7 9
10 11 12 25 22 1 13 16 Ref 8 | 2014 02 Av1kbauthority files Kingston Brass New Parts Diagram srsltid
AfmBOopakUV9fNQexCFFGdLUaJSEvgcX1QfTkfG7i0jn2GAHbbGPw sO |||

...

lang: score:11 filesize: 182.54 K page_count: 1 document date: 2014-02-07