

Scheppach 3901302915

Instruction Manual for Scheppach HS 120o Circular Sawbench

Model: HS 120o (3901302915)

1. INTRODUCTION

This manual provides essential information for the safe and efficient operation, maintenance, and troubleshooting of your Scheppach HS 120o 12-inch (315mm) Circular Sawbench. Please read this manual thoroughly before operating the machine to ensure proper use and to prevent injury or damage.

The Scheppach HS 120o is designed for sawing beams, boards, and other wood-like materials. It is suitable for ripping, crosscutting, angle, and compound angle cuts in workshop and construction site environments.

2. SAFETY INSTRUCTIONS

WARNING: Failure to follow these safety instructions may result in serious injury or death.

- Always wear appropriate personal protective equipment (PPE), including safety glasses, hearing protection, and dust mask.
- Ensure the sawbench is stable and securely placed on a level surface before operation.
- Keep hands and fingers clear of the saw blade at all times. Use push sticks or push blocks when cutting small pieces.
- Disconnect the power supply before performing any adjustments, maintenance, or when changing the saw blade.
- Do not operate the sawbench in damp or wet conditions.
- Keep the work area clean and well-lit. Cluttered areas invite accidents.
- Never force the workpiece into the blade. Allow the blade to cut at its own pace.
- Ensure the blade guard is in place and functioning correctly before each use.
- Only use saw blades recommended by the manufacturer and suitable for the material being cut.
- Do not wear loose clothing, gloves, ties, or jewelry that could get caught in moving parts.

3. COMPONENTS OVERVIEW

Familiarize yourself with the main components of your Scheppach HS 120o Circular Sawbench:



Figure 3.1: Overall view of the Scheppach HS 120o Circular Sawbench, showing the main table, saw blade, motor housing, and support frame.

- **Saw Blade:** The cutting tool, 315 mm diameter.
- **Table Top:** The main work surface, with an extension table for larger materials.
- **Rip/Mitre Fence:** Adjustable guide for straight and angled cuts.
- **Blade Guard:** Protects the user from the rotating blade.
- **Height Adjustment Handwheel:** For setting the cutting height.
- **Angle Adjustment:** For setting the blade angle (90° to 45°).
- **Motor:** 230V/50Hz/2.2 kW motor, providing 2800 RPM.
- **Suction Hose:** For dust extraction connection.
- **On/Off Switch:** Power control for the sawbench.

4. SETUP AND ASSEMBLY

Before operating the sawbench, ensure it is properly assembled and set up.

1. **Unpacking:** Carefully remove all components from the packaging. Verify that all included components are present: HW-Saw blade diameter 315 mm, driving device, extension table, and suction hose.
2. **Frame Assembly:** Assemble the sawbench frame according to the diagrams provided in the separate assembly guide. Ensure all bolts and fasteners are securely tightened.
3. **Table Extension:** Attach the extension table to the main table. This provides flexibility for handling larger workpieces.
4. **Blade Installation:** Ensure the sawbench is unplugged. Install the 315mm HW-Saw blade, ensuring it is oriented correctly for cutting. Tighten the blade retaining nut securely.
5. **Suction Hose Connection:** Connect the provided suction hose to the dust extraction port on the sawbench. For optimal dust collection, connect it to a suitable dust extractor system.
6. **Power Connection:** Connect the sawbench to a 240V, 50Hz power supply. Ensure the electrical circuit can handle the 2.2 kW power requirement.



Figure 4.1: A person standing next to the sawbench, illustrating its approximate size and ergonomic design for user interaction.

5. OPERATING INSTRUCTIONS

Follow these steps for safe and effective operation of your sawbench.

1. **Pre-Operation Check:** Before each use, inspect the saw blade for damage, ensure all guards are in place, and verify that the power cord is in good condition.
2. **Adjusting Blade Height:** Use the height adjustment handwheel to set the blade height. For most cuts, the blade should extend approximately 1/8 inch (3mm) above the workpiece. The maximum cutting height is 83 mm.
3. **Adjusting Blade Angle:** The blade can be swiveled from 90° (vertical) to 45° for angled cuts. Loosen the angle locking mechanism, adjust to the desired angle, and re-tighten securely.
4. **Setting the Fence:** Position the rip/mitre fence to the desired distance from the blade for rip cuts, or set it for miter cuts. Ensure the fence is parallel to the blade for rip cuts and securely locked in place.
5. **Starting the Saw:** Press the ON switch to start the motor. Allow the blade to reach full speed (2800 RPM) before beginning the cut.
6. **Making a Cut:**
 - Place the workpiece firmly against the fence and the table.
 - Slowly and steadily feed the workpiece into the rotating blade. Do not force the material.
 - Maintain control of the workpiece throughout the cut. Use a push stick for narrow cuts or when your hands are close to the blade.
 - The cutting speed is 46 m/sec.
7. **Stopping the Saw:** Press the OFF switch to stop the motor. Wait for the blade to come to a complete stop before removing the workpiece or making any adjustments.



Figure 5.1: The sawbench in operation, demonstrating a typical cutting scenario with a workpiece being fed into the blade.

6. MAINTENANCE

Regular maintenance ensures the longevity and safe operation of your sawbench.

- **Cleaning:** After each use, disconnect the power and clean the sawbench. Remove sawdust and debris from the table, blade guard, and motor housing. Use compressed air for hard-to-reach areas.
- **Blade Inspection:** Regularly inspect the saw blade for sharpness, cracks, or missing teeth. Replace dull or damaged blades immediately.
- **Lubrication:** Periodically apply a light coat of machine oil to moving parts, such as the blade height and angle adjustment mechanisms, to ensure smooth operation.
- **Fastener Check:** Periodically check all nuts, bolts, and screws for tightness. Re-tighten as necessary to prevent vibration and ensure stability.
- **Dust Extraction System:** Ensure the dust extraction hose and port are clear of obstructions for efficient dust removal.

7. TROUBLESHOOTING

This section addresses common issues you might encounter.

Problem	Possible Cause	Solution
Saw does not start	No power supply; faulty switch; motor overload.	Check power connection and circuit breaker; inspect switch; allow motor to cool if overloaded.
Blade not cutting smoothly	Dull or damaged blade; incorrect blade for material; improper feed rate.	Replace or sharpen blade; use appropriate blade; adjust feed rate.
Excessive vibration	Loose blade; unstable sawbench; damaged blade.	Tighten blade nut; ensure sawbench is on a stable surface; replace damaged blade.
Poor dust extraction	Clogged hose/port; dust extractor not connected or insufficient.	Clear obstructions; ensure dust extractor is connected and functioning.

8. TECHNICAL SPECIFICATIONS

Feature	Specification
Model	HS 120o (3901302915)
Brand	Scheppach
Engine	230V/50Hz/2.2 kW
Number of Revolutions	2800 1/min (RPM)
Cutting Speed	46 m/sec
Cutting Height (Max)	83 mm
Swivel Range (Blade Angle)	90° to 45°
Table Size with Extension	950 x 800 mm
Saw Blade Diameter	315 mm (12 inches)
Item Weight	47 Kilograms (103.4 pounds)
Product Dimensions	34.65 x 24.02 x 17.72 inches
Included Components	HW-Saw blade diameter 315 mm, driving device, extension table, suction hose
Power Source	Corded Electric
Voltage	240 Volts
Wattage	2200 watts

9. WARRANTY AND SUPPORT

For warranty information and technical support, please refer to the warranty card included with your product or contact Scheppach customer service directly. Keep your purchase receipt as proof of purchase.
For additional assistance, visit the official Scheppach website or contact your local authorized dealer.

Related Documents - 3901302915

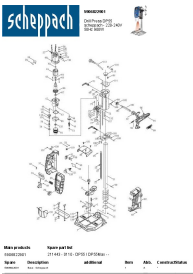

[Scheppach Drill Press DP55 \(5906822901\) Spare Parts List and Diagram](#)

Comprehensive spare parts list and exploded view diagram for the Scheppach Drill Press DP55 (Model 5906822901), including part numbers, descriptions, and assembly references.



Scheppach HS80 Table Saw User Manual

User manual for the Scheppach HS80 table saw, covering safety, assembly, operation, maintenance, and troubleshooting for woodworking.

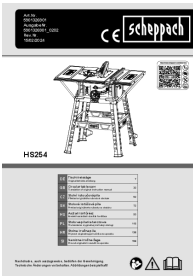

Scheppach HS254 Tischkreissäge - Bedienungsanleitung

Diese umfassende Bedienungsanleitung für die Scheppach HS254 Tischkreissäge bietet detaillierte Informationen zur Einrichtung, sicheren Bedienung, Wartung und Fehlerbehebung für Holzbearbeitungsaufgaben.

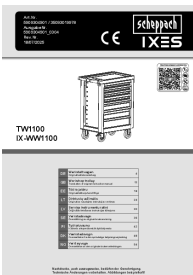

[scheppach TW1100 IX-WW1100 Werkstattwagen Bedienungsanleitung](#)

Entdecken Sie den scheppach TW1100 IX-WW1100 Werkstattwagen. Diese Bedienungsanleitung bietet detaillierte Informationen zur sicheren Handhabung, Montage und Wartung Ihres Werkstattwagens.



Scheppach HSC130 Steintrenner Bedienungsanleitung

Die Bedienungsanleitung für den Scheppach HSC130 Steintrenner bietet detaillierte Anweisungen zur sicheren Montage, Inbetriebnahme, Wartung und Fehlerbehebung dieses leistungsstarken Geräts für Haus und Garten.

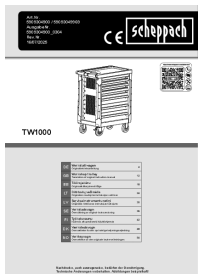

[scheppach TW1000 Werkstattwagen Bedienungsanleitung](#)

Umfassende Anleitung für den scheppach TW1000 Werkstattwagen, die Montage, Bedienung, Sicherheitshinweise, Wartung und Entsorgung abdeckt. Erfahren Sie, wie Sie Ihren Werkstattwagen sicher und effizient nutzen.