

## Manuals+

[Q & A](#) | [Deep Search](#) | [Upload](#)

[manuals.plus](#) /

› [EGLO](#) /

› [EGLO 86996A Nikita Wall or Ceiling Light Instruction Manual](#)

## EGLO 86996A

# EGLO 86996A Nikita Wall or Ceiling Light Instruction Manual

Model: 86996A | Brand: EGLO

## INTRODUCTION

This manual provides detailed instructions for the safe installation, operation, and maintenance of your EGLO 86996A Nikita Wall or Ceiling Light. Please read this manual thoroughly before installation and retain it for future reference. The EGLO Nikita light fixture features a transitional design with a matte nickel finish and satin glass accents, suitable for both wall and ceiling mounting.

## IMPORTANT SAFETY INFORMATION

**WARNING: Risk of electric shock. Disconnect power at the fuse box or circuit breaker before installation or servicing.**

Always consult a qualified electrician if you are unsure about the installation process. Ensure all wiring connections are secure and comply with local electrical codes.

This product is designed for indoor use only. Do not expose to moisture or extreme temperatures.

**Proposition 65 Warning:** This product may contain chemicals known to the State of California to cause cancer and birth defects or other reproductive harm. Please check your local laws before purchasing this product.

## WHAT'S IN THE BOX

- Light Fixture (EGLO 86996A Nikita)
- Installation Hardware (screws, wire nuts, mounting bracket) - *(Standard components, may vary slightly)*
- Instruction Manual

**Note:** 1x100W Halogen bulb is **not included** and must be purchased separately.

## SETUP AND INSTALLATION

This section outlines the general steps for installing the EGLO 86996A light fixture. Specific details may vary based on your electrical box and mounting surface. Always ensure power is OFF before beginning installation.

### Tools Required (Not Included):

- Screwdriver (Phillips and/or Flathead)
- Wire Strippers
- Pliers
- Electrical Tape
- Safety Glasses

## Installation Steps:

1. **Turn Off Power:** Locate the circuit breaker or fuse box that supplies power to the installation location. Turn off the power completely. Verify power is off using a voltage tester.
2. **Prepare Mounting Surface:** If replacing an existing fixture, carefully remove it. Ensure the electrical box is securely mounted and capable of supporting the fixture's weight.
3. **Attach Mounting Bracket:** Secure the fixture's mounting bracket to the electrical box using the provided screws. Ensure it is firmly attached.
4. **Make Electrical Connections:**
  - Connect the **green or bare copper ground wire** from the fixture to the ground wire from the electrical box (usually bare copper or green). Secure with a wire nut.
  - Connect the **white wire** from the fixture to the white (neutral) wire from the electrical box. Secure with a wire nut.
  - Connect the **black wire** from the fixture to the black (hot) wire from the electrical box. Secure with a wire nut.

Ensure all wire nuts are tightly secured and no bare wire is exposed. Wrap connections with electrical tape for added security.

5. **Mount the Fixture:** Carefully align the fixture with the mounting bracket and secure it in place using the provided screws. Ensure the fixture is flush against the wall or ceiling.
6. **Install Bulb:** Insert one 100W Halogen bulb (not included) into the socket. Do not exceed the maximum wattage.
7. **Restore Power:** Once installation is complete and all connections are secure, turn the power back on at the circuit breaker or fuse box.



Image: Front view of the EGLO 86996A Nikita Wall or Ceiling Light in matte nickel finish.



Image: The EGLO 86996A Nikita light fixture mounted on a blue wall, illustrating its up/down lighting effect.





Image: The EGLO 86996A Nikita light fixture integrated into a modern living room, demonstrating its aesthetic appeal.

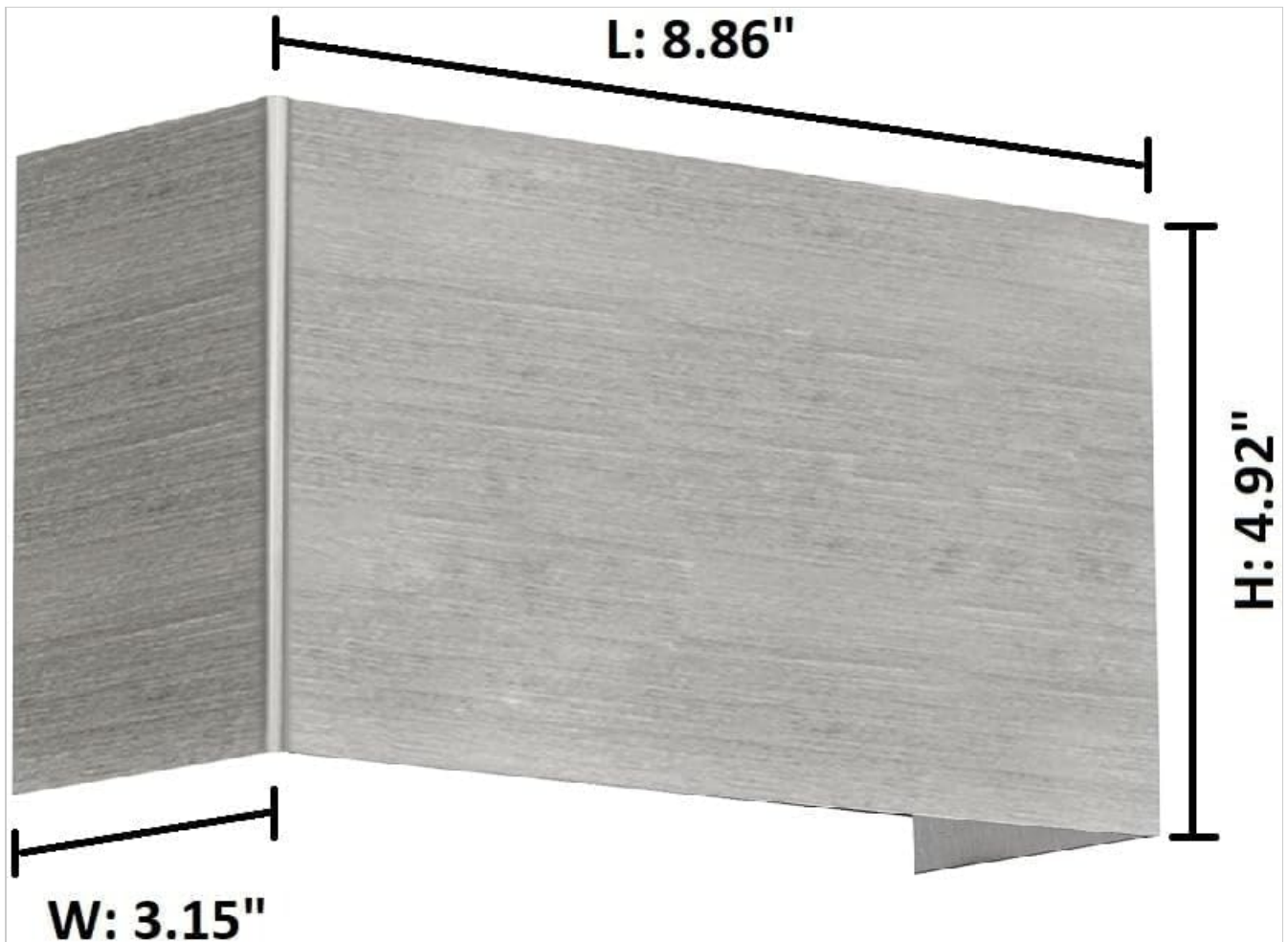

Image: Dimensional drawing of the EGLO 86996A Nikita light, showing length (8.86"), width (3.15"), and height (4.92").

## OPERATION

---

The EGLO 86996A Nikita light fixture operates via a standard wall switch (not included) connected to your household electrical system. It is designed for 120 Volts AC power.

- **Power On/Off:** Use the wall switch to turn the light fixture on or off.
- **Bulb Type:** This fixture requires one 100W Halogen bulb (not included). Halogen bulbs can generate significant heat.
- **Dimmable:** The fixture is dimmable if connected to a compatible dimmer switch and using dimmable halogen bulbs.

## MAINTENANCE

---

Regular maintenance ensures the longevity and optimal performance of your light fixture.

- **Cleaning:** Before cleaning, ensure the power is turned off and the fixture has cooled down. Wipe the fixture with a soft, dry cloth. Do not use abrasive cleaners, solvents, or polishes as they may damage the finish or glass.
- **Bulb Replacement:**
  - a. Turn off power to the fixture at the circuit breaker.
  - b. Allow the bulb to cool completely before touching it.
  - c. Carefully remove the old bulb.
  - d. Insert a new 100W Halogen bulb. Avoid touching the new halogen bulb directly with bare hands, as oils can reduce bulb life. Use a clean cloth or glove.
  - e. Restore power.

- **Inspection:** Periodically check for any loose wiring or damaged components. If any damage is found, discontinue use and consult a qualified electrician.

## TROUBLESHOOTING

If you encounter issues with your EGLO 86996A light fixture, refer to the following common troubleshooting steps:

Problem	Possible Cause	Solution
Light does not turn on.	No power to the fixture.	Check circuit breaker/fuse.
	Loose wire connection.	Verify all wire connections are secure (power off).
	Defective bulb.	Replace bulb with a new one.
	Faulty wall switch.	Test wall switch or consult electrician.
Light flickers.	Loose bulb.	Tighten bulb.
	Incorrect bulb type/wattage.	Ensure correct 100W Halogen bulb is used.
	Loose wire connection.	Check wire connections (power off).
	Incompatible dimmer switch.	Ensure dimmer is compatible with halogen bulbs.
Fixture gets too hot.	Over-wattage bulb.	Ensure bulb is 100W or less.
	Normal for halogen bulbs.	Halogen bulbs naturally produce heat. Ensure adequate ventilation around the fixture.

If these steps do not resolve the issue, contact customer support or a qualified electrician.

## SPECIFICATIONS

Feature	Detail
Brand	EGLO
Model Name	Nikita
Model Number	86996A
Color	Matte Nickel
Material	Metal, Glass
Style	Cottage (Transitional)
Light Fixture Form	Sconce (Wall or Ceiling Mount)
Product Dimensions (L x W x H)	8.86" x 3.15" x 4.92"
Item Weight	2 Pounds
Indoor/Outdoor Usage	Indoor
Power Source	Corded Electric

Feature	Detail
Light Source Type	Halogen
Number of Light Sources	1
Maximum Compatible Wattage	100 Watts
Voltage	120 Volts
Special Feature	ETL Listed
Lighting Method	Up/Down Light

## WARRANTY INFORMATION

This product comes with a Manufacturer's Warranty. For specific details regarding coverage, duration, and claims process, please refer to the warranty documentation included with your purchase or contact EGLO customer support directly.

## CUSTOMER SUPPORT

For further assistance, technical support, or inquiries regarding your EGLO 86996A Nikita Wall or Ceiling Light, please contact EGLO customer service. You can often find contact information on the EGLO official website or through your retailer.

**Online Resources:** [Visit the EGLO Store on Amazon](#)

## PRODUCT VIDEO

Your browser does not support the video tag.

Video: An official brand video showcasing various EGLO lighting products and their design philosophy. This video provides a general overview of the EGLO brand's offerings and aesthetic.



### Related Documents - 86996A



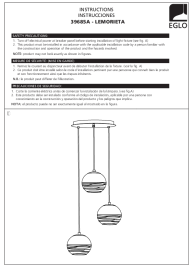

[EGLO 39685A LEMORIETA Pendant Light Installation Instructions](#)

Detailed installation guide for the EGLO 39685A LEMORIETA pendant light, including safety precautions, wiring, and height adjustment instructions.

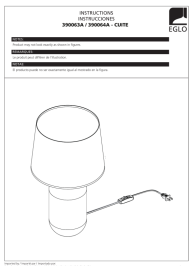

[EGLO CUIITE 390063A/390064A Table Lamp Instructions](#)

Official assembly and usage instructions for the EGLO CUIITE table lamp, models 390063A and 390064A. Learn how to install the bulb, attach the shade, and connect the power.

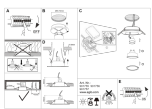

[EGLO FAVAZZINA LED Recessed Lamp Installation Guide | Models 901755, 901756, 901757](#)

Comprehensive installation guide for the EGLO FAVAZZINA LED recessed lamp. Learn about wiring, mounting, safety clearances, and product specifications. Includes models 901755, 901756, and 901757.



[EGLO 44001A MIDSUMER Pendant Light Installation Guide](#)

Official installation instructions for the EGLO 44001A MIDSUMER pendant light. Learn how to safely install your new EGLO lighting fixture with step-by-step guidance.

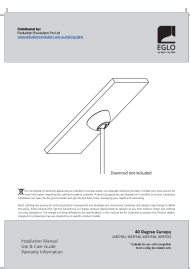

[EGLO 40 Degree Canopy Installation Manual and Warranty Information](#)

Comprehensive guide for installing the EGLO 40 Degree Canopy ceiling fan accessory, including safety precautions, parts list, wiring instructions, maintenance, and warranty details for models 20557501, 20557502, 20557504, 20557512.

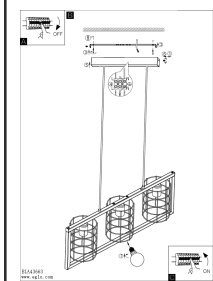

### [EGLO JUBILY Pendant Light \(Model 43663\) - Installation and Wiring Guide](#)

Step-by-step installation and wiring guide for the EGLO JUBILY pendant light, model 43663.

Includes details on mounting, electrical connections, and operation for your EGLO lighting fixture.