

Manuals+

[Q & A](#) | [Deep Search](#) | [Upload](#)

manuals.plus /

› [Alpena](#) /

› [Alpena 77259 Dash Litz Blue LED Lighting Instruction Manual](#)

Alpena 77259

Alpena 77259 Dash Litz Blue LED Lighting Instruction Manual

Model: 77259

INTRODUCTION

The Alpena 77259 Dash Litz Blue LED lighting kit provides custom accent lighting for your vehicle's interior. This kit includes four micro LEDs designed for easy installation and operation, enhancing the aesthetic appeal of your vehicle's dashboard or footwell areas.

SAFETY INFORMATION

- Ensure your vehicle's engine is off and the ignition is in the "OFF" position before installation.
- Do not obstruct driver's view or interfere with vehicle controls, airbags, or safety features.
- Avoid installing in areas exposed to extreme heat or moisture.
- Use only with a 12-volt DC power source.
- If you are unsure about any installation step, consult a qualified automotive technician.

PACKAGE CONTENTS

Verify that all components are present in your Alpena 77259 Dash Litz kit:

- 4 x Micro Blue LEDs with wiring
- 1 x 12-Volt Power Plug (cigarette lighter adapter) with ON/OFF switch
- Self-adhesive 3M™ foam tape (pre-applied or included for attachment)







Image: The four micro LEDs, their connecting wires, and the 12-volt power plug with an integrated ON/OFF switch, laid out unlit.

SETUP AND INSTALLATION

1. **Plan Placement:** Determine the desired locations for the four micro LEDs within your vehicle's interior. Common areas include under the dashboard, footwells, or along console edges. Ensure the wiring can reach the 12-volt power outlet without obstruction.
2. **Clean Surface:** Thoroughly clean the chosen installation surfaces with an alcohol wipe to remove any dust, dirt, or grease. Allow the surface to dry completely. This ensures optimal adhesion of the foam tape.
3. **Attach LEDs:** Peel the backing from the self-adhesive 3M™ foam tape on each micro LED. Carefully press each LED firmly onto the cleaned surface for at least 30 seconds to secure it.
4. **Route Wiring:** Neatly route the wiring from each LED to the central 12-volt power plug. Use cable ties or clips (not included) to secure the wires and prevent them from interfering with vehicle operation or being damaged.
5. **Connect Power:** Insert the 12-volt power plug into your vehicle's cigarette lighter or auxiliary power outlet.

OPERATING INSTRUCTIONS

1. **Power On:** Once the 12-volt power plug is inserted into the vehicle's outlet, locate the ON/OFF switch on the power plug. Slide the switch to the "ON" position. The micro LEDs will illuminate with a blue light.
2. **Power Off:** To turn off the LEDs, slide the switch on the 12-volt power plug to the "OFF" position.



Image: The four micro LEDs illuminated with a blue light, connected to their wiring and the 12-volt power plug.



Image: The Alpena Dash Litz LEDs installed in a vehicle, casting a blue glow on the dashboard gauges and surrounding area.

MAINTENANCE

- **Cleaning:** To clean the LED units, gently wipe them with a soft, dry cloth. Do not use abrasive cleaners or solvents.
- **Adhesion:** If an LED unit becomes loose, re-secure it using new automotive-grade double-sided adhesive tape. Ensure the surface is clean and dry before re-application.

TROUBLESHOOTING

Problem	Possible Cause	Solution
---------	----------------	----------

Problem	Possible Cause	Solution
LEDs do not light up.	<ul style="list-style-type: none"> ◦ 12-volt power plug not fully inserted. ◦ Vehicle's power outlet is not active. ◦ ON/OFF switch is in the "OFF" position. ◦ Blown fuse in vehicle's power outlet circuit. 	<ul style="list-style-type: none"> ◦ Ensure the power plug is securely seated. ◦ Check if the vehicle's ignition needs to be on for the outlet to be active. ◦ Slide the ON/OFF switch to the "ON" position. ◦ Consult your vehicle's manual to check and replace the fuse for the 12-volt power outlet.
One or more LEDs flicker or are dim.	<ul style="list-style-type: none"> ◦ Loose wiring connection. ◦ Damaged LED unit. 	<ul style="list-style-type: none"> ◦ Check all wiring connections for secure fit. ◦ If an LED is damaged, replacement of the entire kit may be necessary.

SPECIFICATIONS

- **Model:** Alpena 77259 Dash Litz
- **Input Voltage:** 12 Volts DC
- **Bulb Type:** LED (Micro LEDs)
- **Color:** Blue
- **Dimensions (packaging):** Approximately 5.1 x 4 x 1.3 inches
- **Weight (total package):** Approximately 4 ounces



WARRANTY AND SUPPORT

For warranty information or technical support regarding your Alpena 77259 Dash Litz Blue LED lighting kit, please refer to the contact information provided on the product packaging or visit the official Alpena website. Keep your proof of purchase for warranty claims.

You can visit the Alpena Store for more information: [Alpena Official Store](#)

© 2023 Alpena. All rights reserved.

Related Documents - 77259

	<p>Alpena MotorLED Flow 78355 Installation Guide and Product Information</p> <p>Comprehensive guide for installing and operating the Alpena MotorLED Flow™ (Part # 78355). Includes assembly, mounting, wiring instructions, FCC compliance, and limited warranty information for this automotive interior mood lighting system.</p>
	<p>Alpena MotorLED Flow™ 78359 Installation and Operation Guide</p> <p>Comprehensive guide for installing and operating the Alpena MotorLED Flow™ (Part #78359) interior mood lighting system. Includes safety warnings, wiring instructions, FCC compliance, and warranty information.</p>

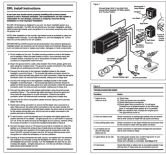

[DRL Install Instructions - Alpena Daylight Running Light Kit](#)

Comprehensive installation guide for the Alpena DRL-Kit, detailing wiring, setup, and troubleshooting for your vehicle's daylight running lights.

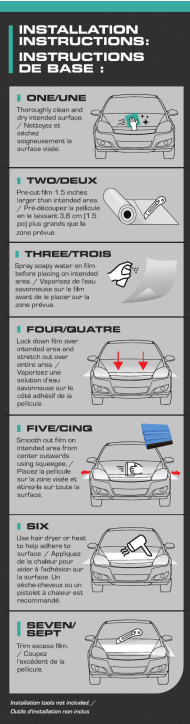

[Alpena 93008 Glossy PPF Hood Kit Installation Instructions](#)

Step-by-step guide for installing Alpena's 93008 Glossy PPF (Paint Protection Film) hood kit. This guide covers surface preparation, film cutting, application using soapy water and a squeegee, heat application, and trimming. Installation tools are not included.



[Alpena USB Thin Beam - Phone Control Installation Guide & Warranty](#)

Comprehensive installation guide, safety warnings, and limited warranty details for the Alpena USB Thin Beam - Phone Control (Part #: 78540). Learn how to safely install and operate this automotive auxiliary LED lighting product.

[Alpena FloGlo 112" Underglow Kit Installation and Operation Guide](#)

Comprehensive guide for installing and operating the Alpena FloGlo 112" Underglow Kit. Includes assembly, wiring, mounting, and app usage instructions, along with warranty information and FCC compliance.