

Wright Products V2012WH

Wright Products Heavy Duty Pneumatic Screen & Storm Door Closer

Model: V2012WH

1. INTRODUCTION

The Wright Products V2012WH Heavy Duty Pneumatic Screen & Storm Door Closer is designed to provide reliable and controlled closing for out-swinging storm or screen doors. Featuring an innovative EZ-Hold "Tap-N-Go" function, this closer allows for convenient hands-free operation. Its durable construction and adjustable closing speed make it suitable for various door types, from light to heavy-duty applications.





Image 1.1: The Wright Products V2012WH door closer with all included mounting hardware, including screws and brackets.

2. PRODUCT FEATURES

- **EZ-HOLD Open Function:** Allows the door to be held open at any desired position with a simple tap, providing hands-free convenience.
- **Heavy Duty Performance:** Engineered for robust use on heavier storm and security doors, ensuring consistent and reliable operation.
- **Adjustable Speed Control:** Features a thumbscrew dial for easy, tool-free adjustment of the door's closing speed.
- **Smooth Pneumatic Closing:** Air-cushioned tube prevents door slamming, ensuring quiet and secure closure.
- **Universal Installation:** Designed for quick and easy installation on most out-swinging doors, with all necessary mounting hardware included.



DOOR
CLOSER
FERME-
PORTE
CERRADOR
DE PUERTA

WRIGHT
PRODUCTS

PREMIER

WRIGHT
PRODUCTS

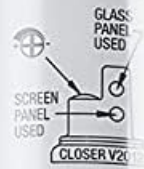

FOR USE WITH:
HEAVY
STYLE
DOORS



POUR UNE UTILISATION AVEC
POIDS
LOURD
PORTES

PARA USO CON PUERTAS
DE ESTILO PESADO

CONVENIENT
EZ-HOLD
OPEN
FEATURE



PUSH BUTTON TO HOLD



FOR HANDS FREE ENTRY

EZ-HOLD



FUNCTION
abierta a la
vez de cerrar
la puerta

FITS 3/4" - 2" DOOR / S'ADAPTE 2 cm - 5,1 cm PORTE



Image 2.1: Product packaging illustrating the convenient EZ-Hold open feature and heavy-duty design.

3. COMPATIBILITY

This door closer is compatible with a wide range of out-swinging doors. Ensure your door meets the following criteria for optimal performance:

- Designed for out-swinging wood or metal doors.
- Suitable for doors ranging from 3/4-inch to 2-inch thick.
- Features seasonal latching adjustment, allowing for switching between glass or screen inserts.



Image 3.1: Visual guide detailing the compatibility of the door closer with various door types and thicknesses.

4. SETUP & INSTALLATION

4.1 Tools Required

- Drill
- Drill bits (appropriate size for screws)
- Screwdriver (Phillips head recommended)
- Measuring tape
- Pencil

4.2 Installation Steps

1. **Prepare the Door:** Ensure the door frame and door surface are clean and free of obstructions.
2. **Determine Mounting Location:** For optimal performance, mount the closer at the top of the door, on the side that swings out. For heavier doors, a second closer can be mounted at the bottom.
3. **Attach Door Bracket:** Position the door bracket on the door frame, ensuring it is level and aligned. Mark the screw holes with a pencil. Drill pilot holes and secure the bracket with the provided screws.
4. **Attach Closer to Door:** Attach the closer body to the door itself using the provided screws and bracket. Ensure the closer is parallel to the door frame when the door is closed.
5. **Connect Pin:** Insert the connecting pin through the closer rod and the door frame bracket.
6. **Test Operation:** Slowly open and close the door to ensure smooth operation. Adjust the closing speed as needed (refer to Section 5).



Image 4.1: The Wright Products door closer correctly installed on an out-swinging storm door, demonstrating its low-profile appearance.

Measure For Fit

Heavy Duty Pneumatic Closer With Tap-N-Go®



V2012WH

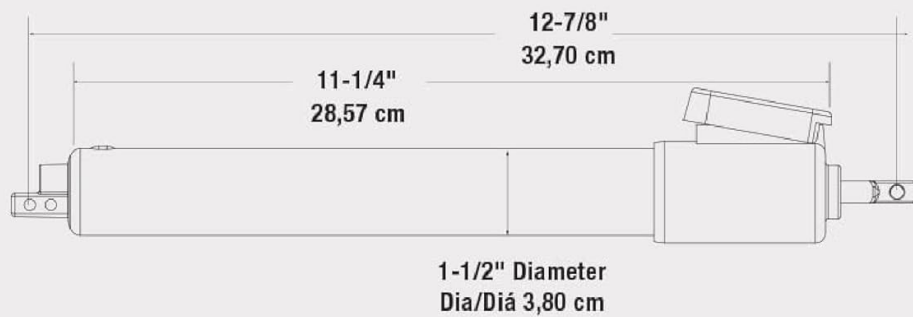

Image 4.2: Technical diagram illustrating the dimensions of the heavy-duty pneumatic closer for proper fit and installation.

Identify Your Closer By Model Number

Heavy Duty Pneumatic Closer With Tap-N-Go®



V2012WH

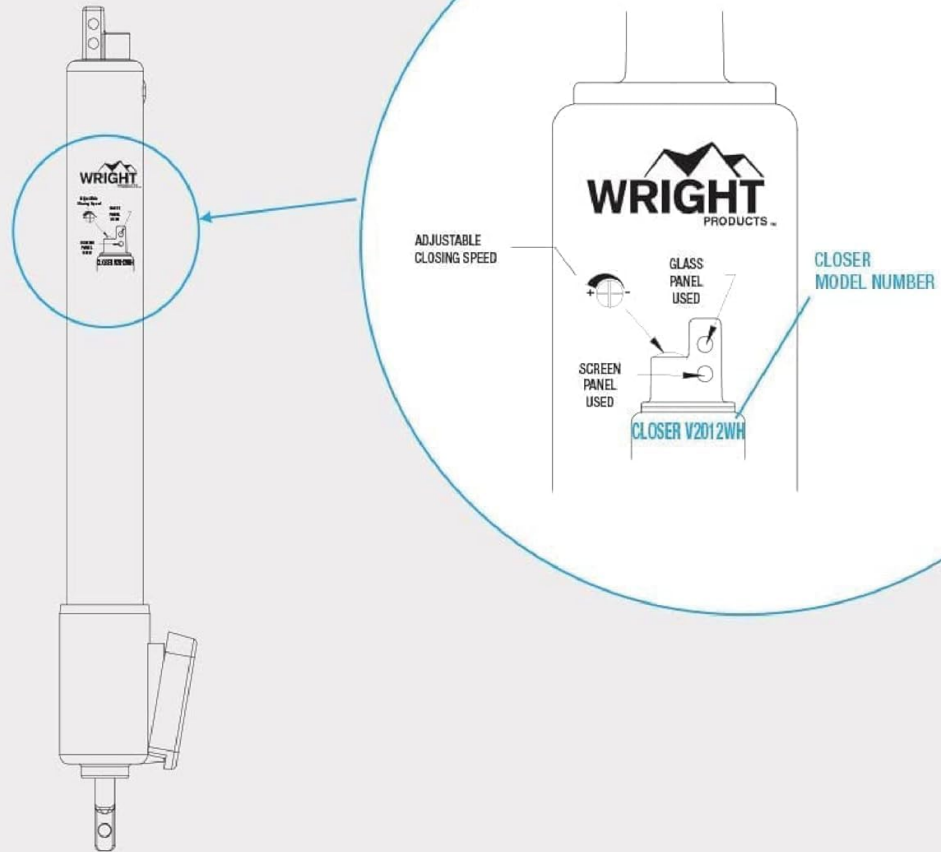

Image 4.3: Diagram showing the location of the model number (V2012WH) and adjustable closing speed indicator on the closer body.

5. OPERATING INSTRUCTIONS

5.1 EZ-Hold "Tap-N-Go" Feature

To engage the EZ-Hold feature, simply push the button located on the closer body prior to opening your door to the desired location. The door will remain open. To disengage the hold-open feature and allow the door to close, gently push the door open slightly further, or give it a small 'tap'. The mechanism will release, and the door will begin to close.

5.2 Adjusting Closing Speed

The closing speed of the door can be adjusted using the thumbscrew dial located at the end of the closer. Turning the thumbscrew clockwise will decrease the closing speed (slower), and turning it counter-clockwise will increase the closing speed (faster). Adjust gradually until the desired closing speed is achieved, ensuring the door closes securely without slamming.

6. MAINTENANCE

The Wright Products V2012WH door closer is factory lubricated and designed for minimal maintenance. Periodically inspect the closer and mounting hardware for any signs of wear, looseness, or damage. Ensure all screws are tight. Do not attempt to disassemble the closer, as it contains pressurized components. If the closer is damaged or not functioning correctly, replacement is recommended.

7. TROUBLESHOOTING

Problem	Solution
Door slams shut	Adjust the closing speed by turning the thumbscrew clockwise to slow it down.
Door does not close completely	Adjust the closing speed by turning the thumbscrew counter-clockwise to speed it up. Check for obstructions or binding in the door hinges.
EZ-Hold feature not engaging/disengaging	Ensure the button is fully depressed to engage. To disengage, push the door slightly further open. If issues persist, the mechanism may be worn and require replacement.
Closer leaks fluid	This indicates internal seal failure. The closer cannot be repaired and must be replaced.
Closer makes excessive noise	Ensure the closer is securely mounted and all screws are tight. If noise persists, the internal mechanism may be faulty, requiring replacement.

8. SPECIFICATIONS

Specification	Detail
Model Number	V2012WH
Material	Aluminum
Color	White
Item Weight	0.01 Ounces (Note: This weight seems incorrect, likely a data entry error. Actual weight is typically higher for such a product.)
Product Dimensions (L x W x H)	3.13" x 3.88" x 15.88" (approximate, unextended)
Installation Type	Screw-In
Opening Range	Full 90 degrees
UPC	654204513974, 039208995627

9. WARRANTY INFORMATION

Wright Products offers a Lifetime Warranty on this product. For specific details regarding warranty claims, coverage, and limitations, please refer to the official warranty documentation included with your purchase or contact Wright Products customer support.

10. CUSTOMER SUPPORT

For further assistance, technical support, or to inquire about replacement parts, please visit the official Wright Products store or contact their customer service department.

Wright Products Official Store: [Visit Store](#)

© 2024 Wright Products. All rights reserved.

Related Documents

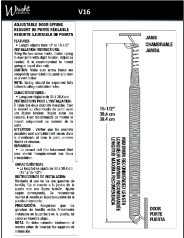
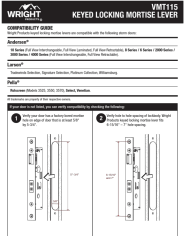
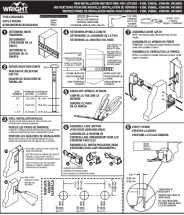
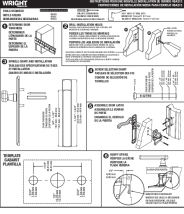
	<p>Wright Products V16 Adjustable Door Spring Installation Guide</p> <p>Installation instructions and features for the Wright Products V16 adjustable door spring, designed for screen and storm doors. Learn how to properly mount and adjust the spring for optimal performance.</p>
	<p>Wright Products VMT115 Keyed Locking Mortise Lever Compatibility Guide</p> <p>Check compatibility for Wright Products VMT115 keyed locking mortise levers with Andersen, Larson, and Pella storm doors. Includes essential measurements for door preparation, such as mortise hole size, hole spacing, and backset.</p>
	<p>Wright Products Latch Installation Instructions</p> <p>Comprehensive installation guide for Wright Products latches (models V398, V398BL, V398WH, VK398X3), providing step-by-step instructions and diagrams. Includes details on tools required, door preparation, spindle adjustment, latch assembly, and strike verification, with content available in English, French, and Spanish.</p>
	<p>Wright Products VBA213 Latch Installation Instructions</p> <p>Step-by-step guide for installing the Wright Products VBA213 latch, including tool requirements, drilling instructions, and strike verification. This document provides clear instructions for a smooth installation process.</p>

User Manual of Product 1:
Wright Products V2012WH Heavy Duty Screen and Storm Door
Tap-N-Go Pneumatic Closer, White
User Manual of Product 2:
Prime-Line K 5026 Storm Door Protector Chain and Spring,
Zinc Plated (Single Pack)

[\[pdf\]](#) User Manual Instructions Warranty

95000000 REVD ai User Manual of Product 1 Wright Products V2012WH Heavy DutyFULL LIFETIME WARRANTY This product is fully warranted to be free defects in material and workmanship for the life productA1h4htlQ0oLm media amazon images I A1h4htlQ0oL |||

User Manual of Product 1: Wright Products**V2012WH** Heavy Duty Screen and Storm Door Tap-N-Go Pneumatic Closer, White User Manual of Product 2: Prime-Line K 5026 Storm Door Protector Chain and Spring, Zinc Plated Single Pack
INSTALLATION INSTRUCTIONS FOR DOOR CLOSER INSTRUCTIONS POUR L
INSTALLATIO...

lang:en **score:31** filesize: 1.53 M page_count: 3 document date: 2012-10-12

User Manual of Product 1:
Wright Products V2012WH Heavy Duty Screen and Storm Door
Tap-N-Go Pneumatic Closer, White

[\[pdf\]](#) User Manual

User Manual Hamilton Beach Electric Indoor Searing Grill 6 Serving Extra Large Drip Tray Stainless Steel 25361 Digital Programmable Rice Cooker Food Steamer 8 Cups Cooked 4 Uncooked Home Kitchen 81leXVuIUil m media amazon images I |||

User Manual of Product 1: Wright Products**V2012WH** Heavy Duty Screen and Storm Door Tap-N-Go Pneumatic Closer, White Indoor Grill Gril-sant pour l interieur Parrilla interior Read before use. Lire avant utilisation. Lea antes de usar. Questions: 1.800.851.8900 Recipes, tips, product information an...

lang:en **score:14** filesize: 280.09 K page_count: 3 document date: 0000-00-00