

CURT 13142

CURT 13142 Class 3 Trailer Hitch Instruction Manual

Model: 13142 | Brand: CURT

1. PRODUCT OVERVIEW

The CURT 13142 Class 3 Trailer Hitch is engineered for serious towing, offering a vehicle-specific fit for select Mercedes-Benz GLK350 models. This hitch provides a weight carrying capacity of 3,500 lbs. Gross Trailer Weight (GTW) and 350 lbs. Tongue Weight (TW). It features a standard 2-inch receiver tube, suitable for a variety of towing applications including utility trailers, boat trailers, campers, and more. Each hitch is constructed from high-strength steel with precise welding and protected by a co-cured finish of liquid A-coat and black powder coat for superior resistance to rust, chipping, and UV damage.



Image 1.1: The CURT 13142 Class 3 Trailer Hitch, showcasing its robust construction and 2-inch receiver.

2. KEY FEATURES

- **Dependable Strength:** Rated for 3,500 lbs. gross trailer weight and 350 lbs. tongue weight (limited to lowest-rated towing component).
- **Versatile Design:** Equipped with a standard 2-inch x 2-inch hitch receiver. Note: Not compatible with vertical hanging bike racks that require bikes to be hung/mounted vertically.
- **Fully Tested:** Every CURT Class 3 trailer hitch design undergoes rigorous testing in real-world, on-vehicle conditions at our Detroit engineering facility, adhering to SAE J684 standards for safety.
- **Rust, Chip, UV-Resistant:** Protected with a unique dual-coat finish of rust-resistant liquid A-coat and highly durable black powder coat, co-cured for exceptional durability.
- **Easy to Install:** Designed for a custom, factory fit on select model years of the Mercedes-Benz GLK350.

FEATURES & BENEFITS

Representative Image

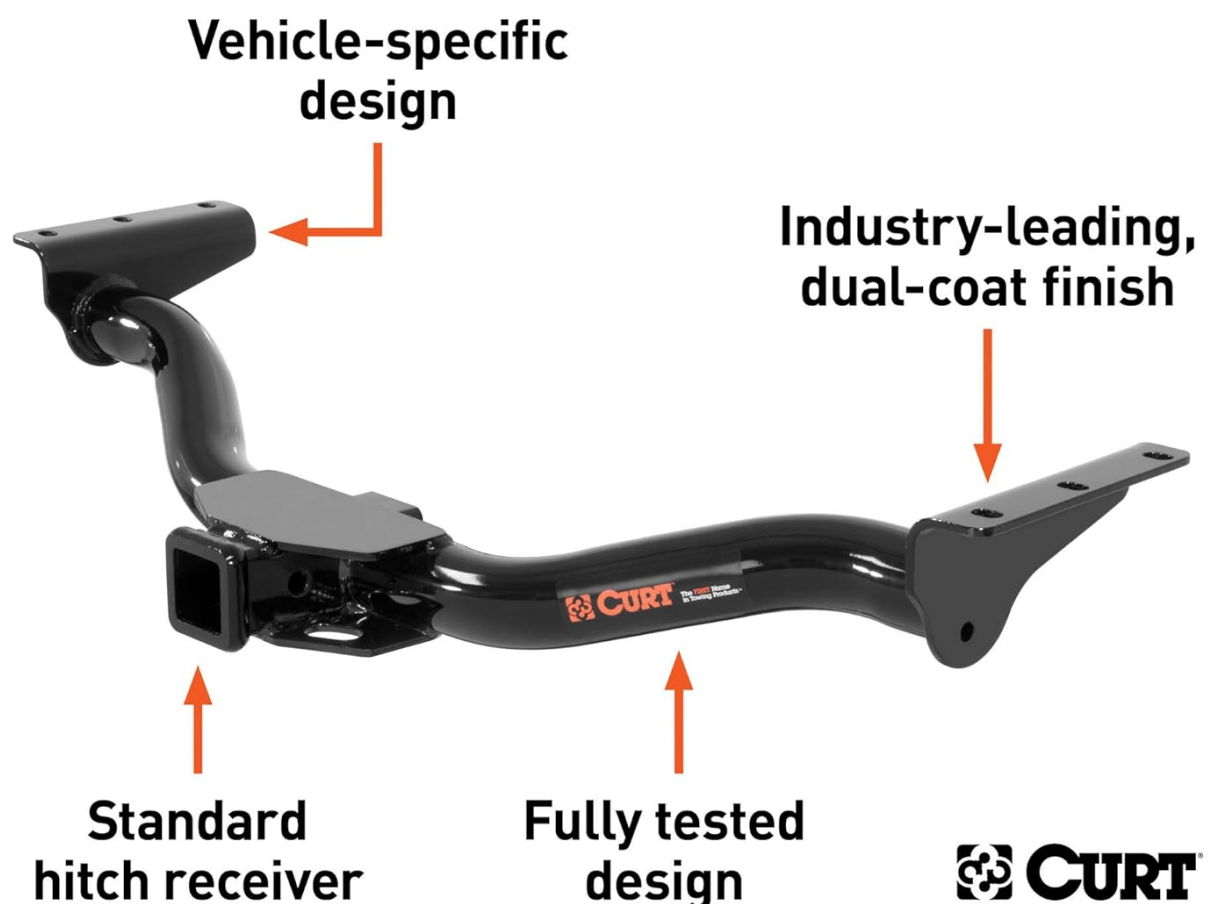
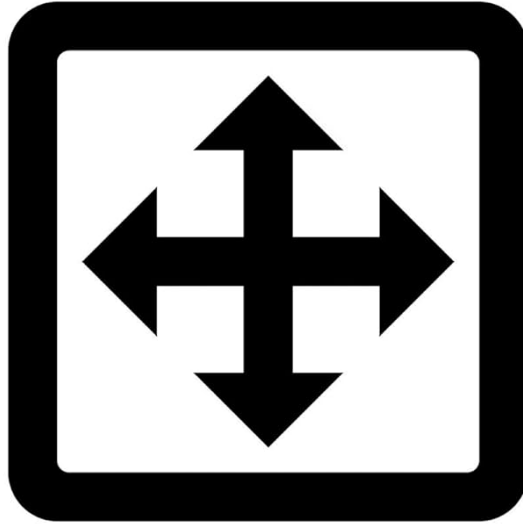

Image 2.1: Overview of the hitch's features, including vehicle-specific design, dual-coat finish, standard receiver, and tested design.

RECEIVER TUBE SIZE



2"



Image 2.2: Illustration confirming the 2-inch receiver tube size, indicating compatibility with standard towing accessories.

3. PACKAGE CONTENTS

Verify that all components are present before beginning installation.

- 1 x CURT Class 3 Trailer Hitch (Model 13142)

4. INSTALLATION & SETUP

The CURT 13142 trailer hitch is designed for a custom, vehicle-specific fit on select Mercedes-Benz GLK350 models. While designed for ease of installation, professional installation is recommended to ensure proper fitment and safety.

General Installation Considerations:

- Always refer to the detailed installation instructions provided with your specific hitch model for vehicle-specific steps.
- Ensure the vehicle is on a level surface and properly supported before beginning work.

- Some installations may require temporary removal of vehicle components (e.g., exhaust hangers, fascia) or minor modifications (e.g., drilling, enlarging existing holes).
- Use appropriate safety gear, including eye protection and gloves.
- Torque all fasteners to the specifications outlined in the detailed instructions.

FEATURES & BENEFITS

Standard hitch receiver



Image 4.1: A close-up view of the standard 2-inch hitch receiver, where towing accessories are inserted.

Installation Video:

Video 4.1: An official video from Curt Manufacturing providing an overview of the CURT 13142 Class 3 Trailer Hitch, including key features and benefits relevant to installation and use.

5. OPERATION

Once the CURT trailer hitch is securely installed, it is ready for towing. Always ensure that the trailer being towed does not exceed the lowest-rated towing component, which includes the hitch's capacity, the vehicle's towing capacity, and the trailer's Gross Vehicle Weight Rating (GVWR).

Towing Best Practices:

- **Connect Securely:** Always use a properly sized hitch ball and ensure the coupler is fully engaged and locked onto the hitch ball.
- **Safety Chains:** Cross safety chains under the trailer tongue and attach them to the designated chain loops on the hitch.
- **Wiring:** Connect trailer lighting wiring harness to the vehicle's electrical system for proper signal lights and brakes.
- **Weight Distribution:** Distribute the trailer load evenly, ensuring proper tongue weight (typically 10-15% of the GTW for conventional trailers).
- **Pre-Trip Inspection:** Before each trip, inspect the hitch, ball, coupler, safety chains, and wiring for any signs of wear, damage, or improper connection.

6. MAINTENANCE

Regular maintenance of your CURT trailer hitch will ensure its longevity and safe operation.

- **Inspect Regularly:** Periodically check the hitch for any signs of rust, chipping, cracks, or deformation. Pay close attention to weld points and mounting hardware.
- **Clean:** Keep the hitch clean from dirt, salt, and road debris. Wash with mild soap and water, then rinse thoroughly.
- **Protect Finish:** The dual-coat finish provides excellent protection. If any deep scratches or chips occur, touch up with a suitable rust-inhibiting paint to prevent corrosion.
- **Hardware Check:** Ensure all bolts and nuts remain tight. Re-torque if necessary according to the original installation instructions.

FEATURES & BENEFITS

Industry-leading, dual-coat finish



Image 6.1: The dual-coat finishing process, illustrating the application of liquid A-coat and black powder coat for enhanced durability and corrosion resistance.

7. TROUBLESHOOTING

While CURT hitches are designed for reliability, occasional issues may arise. Here are some common concerns and general advice:

- **Fitment Issues:** If the hitch does not seem to align correctly with your vehicle's frame, double-check that you have the correct model for your specific Mercedes-Benz GLK350 year and trim. Ensure all obstructions are removed as per the detailed installation guide.
- **Loose Components/Noise:** If you notice rattling or excessive movement, inspect all mounting hardware. Tighten any loose bolts to the specified torque settings. Ensure the hitch ball and coupler are properly secured.
- **Corrosion:** Despite the protective coating, prolonged exposure to harsh elements or damage to the finish can lead to rust. Address any chips or scratches promptly with rust-inhibiting paint.
- **Towing Performance:** If experiencing sway or instability while towing, verify that the trailer is loaded correctly with appropriate tongue weight. Ensure tire pressures on both the vehicle and trailer are correct.

For persistent issues or complex installation challenges, it is recommended to consult a certified professional installer or contact CURT customer support directly.

8. SPECIFICATIONS

Attribute	Value
Brand	CURT
Model	Class 3 Hitch (13142)
Item Weight	41.8 Pounds
Product Dimensions	47 x 15 x 14 inches
Material	Carbon Steel
Finish Type	GLOSS BLACK POWDER COAT
Maximum Towing Capacity	3500 Pounds (GTW)
Tongue Weight	350 Pounds
Receiver Tube Size	2-inch x 2-inch
Vehicle Service Type	Pickup Trucks, Marine-Personal-Craft, ATV, Car, Sport-Utility-Vehicles, Snowmobiles, Trailer
Country of Origin	USA
UPC	612314035649
Date First Available	January 25, 2013



Image 8.1: The 'Made in USA' logo, indicating the country of manufacture for the product.

9. WARRANTY & SUPPORT

Specific warranty terms and detailed support contact information are not available in the provided product data. For the most accurate and up-to-date warranty details, technical support, or to purchase replacement parts, please visit the official CURT Manufacturing website or contact their customer service department directly.

You can typically find contact information and warranty policies on the manufacturer's official website:

www.curtmfg.com

© 2024 CURT Manufacturing. All rights reserved. This manual is for informational purposes only.

Related Documents - 13142

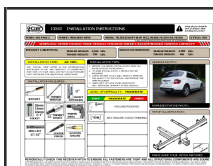

[CURT 13342 Installation Instructions for Mercedes-Benz ML Series Trailer Hitch](#)

Detailed installation guide for the CURT 13342 receiver hitch, designed for Mercedes-Benz ML350, ML500, ML320 CDI, and ML550 models (2006-2010). Includes specifications, required tools, parts list, step-by-step walkthrough, safety warnings, and warranty information.

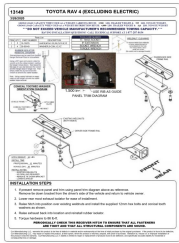

[Toyota RAV4 \(2006-Current\) Trailer Hitch Installation Guide - CURT 13149](#)

Step-by-step installation instructions for the CURT 13149 Class 3 Trailer Hitch for Toyota RAV4 models (2006-Current, excluding Electric). Includes parts list, tools required, safety information, and towing capacity details.

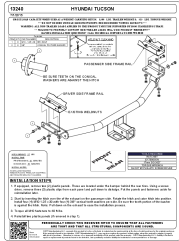

[CURT 13240 Class III Trailer Hitch Installation Guide for Hyundai Tucson](#)

Step-by-step installation instructions for the CURT 13240 Class III receiver hitch, designed for the Hyundai Tucson. Includes parts list, tools required, safety warnings, and warranty details.



[CURT 13146 Trailer Hitch Installation Manual](#)

This document provides installation instructions for the CURT 13146 trailer hitch, including parts list, tools required, safety instructions, and towing capacity information for select Honda Pilot and Acura MDX models.



[CURT 13068 Trailer Hitch Installation Manual for Honda Odyssey](#)

Detailed installation manual for the CURT 13068 Class 3 Trailer Hitch, designed for the Honda Odyssey. Includes parts list, tools required, safety instructions, and step-by-step assembly guidance.

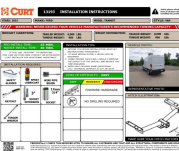

[CURT 13193 Trailer Hitch Installation Guide for Ford Transit](#)

Step-by-step installation instructions for the CURT 13193 trailer hitch designed for the Ford Transit van. Includes parts list, tools required, safety information, and towing capacity details.