

Manuals+

[Q & A](#) | [Deep Search](#) | [Upload](#)

manuals.plus /

› [Cornat](#) /

› [CORNAT PAR3 3094 Parla CT Thermostat for Shower - Chrome User Manual](#)

Cornat PAR3



CORNAT PAR3 3094 Parla CT Thermostat for Shower - Chrome

User Manual

INTRODUCTION

This manual provides essential information for the proper installation, operation, and maintenance of your CORNAT PAR3 3094 Parla CT Thermostat for Shower. Please read these instructions carefully before installation and use to ensure safe and efficient performance of the product. Keep this manual for future reference.

PRODUCT OVERVIEW

The CORNAT PAR3 3094 Parla CT Thermostat is a wall-mounted shower fixture designed for precise temperature control and water flow management. It features a polished chrome finish and a Cool-Touch function for enhanced safety.



Produkt-Abmessungen

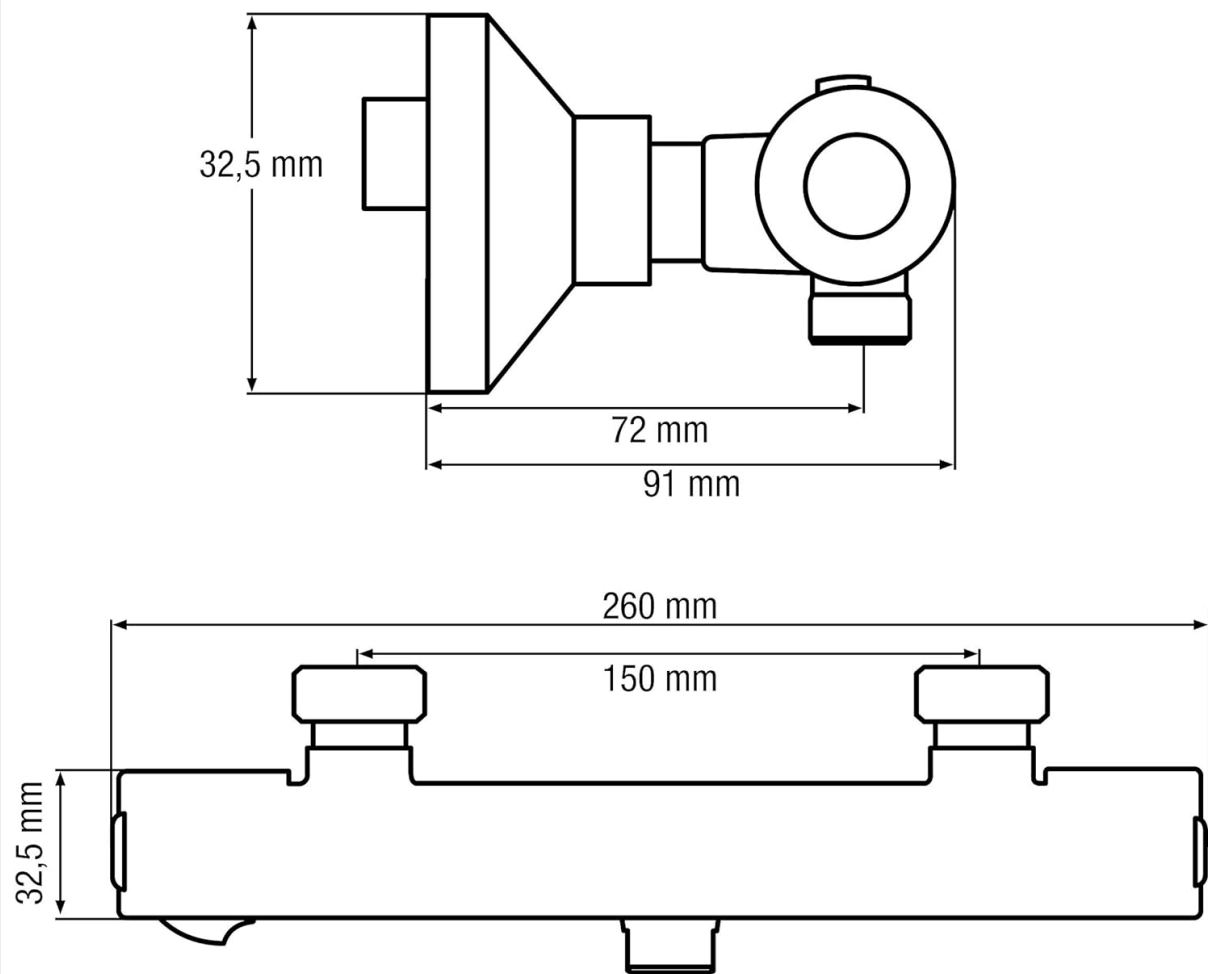

Image 1: Front view of the CORNAT PAR3 3094 Parla CT Thermostat for Shower, showcasing its polished chrome finish and dual control handles.

SETUP AND INSTALLATION

The CORNAT PAR3 3094 Parla CT Thermostat is designed for wall-mount installation with two holes. Professional installation is recommended to ensure correct setup and compliance with local plumbing codes.

Included Components:

- Parla Thermostatic Shower Faucet, CT/Chrome
- Mounting hardware (check packaging for complete list)

Installation Steps:

1. **Preparation:** Ensure water supply is turned off before beginning installation. Clear the installation area.
2. **Mounting:** Securely mount the thermostat to the wall using the provided hardware. Ensure the mounting surface is sturdy and level.
3. **Connections:** Connect the hot and cold water lines to the corresponding inlets on the thermostat. Ensure all connections are tight to prevent leaks.
4. **Testing:** Slowly turn on the water supply and check for any leaks. Test the temperature and flow controls.

Product Dimensions:

Image 2: Detailed diagram showing the dimensions of the CORNAT PAR3 3094 Parla CT Thermostat in millimeters, including overall width, depth, and connection spacing.

Refer to the dimension diagram for precise measurements required for installation planning. The overall width is 260 mm, with a connection spacing of 150 mm. The depth from the wall is 91 mm.

OPERATING INSTRUCTIONS

The CORNAT PAR3 3094 Parla CT Thermostat features two handles for controlling water flow and temperature.

- **Temperature Control:** The handle on the left side controls the water temperature. Rotate it to adjust to your desired warmth. The thermostatic function maintains a consistent temperature once set.
- **Flow Control:** The handle on the right side controls the water flow. Rotate it to turn the water on or off and to adjust the intensity of the flow.

The **Cool-Touch** feature ensures that the surface of the thermostat remains cool to the touch, preventing accidental burns during use.

Note: While the thermostat maintains a set temperature, the indicated temperature on the control may not always precisely match the actual water temperature. Adjust to your comfort level.

MAINTENANCE

Regular cleaning and maintenance will help preserve the appearance and functionality of your CORNAT PAR3 3094 Parla CT Thermostat.

- **Cleaning the Finish:** The polished chrome finish should be cleaned with a soft cloth and mild soap or a non-abrasive cleaner specifically designed for chrome fixtures. Avoid using harsh chemicals, abrasive cleaners, or scouring pads, as these can damage the finish.
- **General Care:** Periodically check all connections for tightness to prevent leaks. If the water flow or temperature control becomes stiff, consult a professional plumber.

TROUBLESHOOTING

If you encounter issues with your thermostat, refer to the following common problems and solutions:

Problem	Possible Cause / Solution
Inaccurate Temperature Display	The thermostat maintains the set temperature, but the dial indication may not be exact. Adjust to your preferred comfort level rather than relying solely on the numerical display.
Difficulty Turning Handles	Mineral buildup or internal wear can cause handles to become stiff. Ensure hands are dry for better grip. If persistent, professional inspection may be required.
Initial Hot Water Surge After Pause	After pausing water flow, a brief surge of very hot water may occur upon restarting. Exercise caution and allow water to stabilize before stepping into the stream.
Water Leaks	Check all connections for tightness. If leaks persist, turn off the water supply and contact a qualified plumber.

SPECIFICATIONS

Feature	Detail
Brand	Cornat
Model Number	PAR3
Recommended Uses	Shower
Mounting Type	Wall Mount
Finish Type	Polished
Material	Brass
Number of Handles	2
Hole Count	2
Special Feature	Cool-Touch
Item Weight	2.44 pounds
Package Dimensions	11.57 x 4.25 x 2.95 inches
Manufacturer	Conmetall

WARRANTY AND SUPPORT

For warranty information or technical support, please refer to the documentation provided with your purchase or contact the retailer or manufacturer directly. The manufacturer is Conmetall.
Please have your model number (PAR3) and purchase date available when contacting support.