

manuals.plus /

- › [GT OMEGA](#) /
- › [GT OMEGA Classic Steering Wheel Stand User Manual \(Model LMK15\)](#)

## GT OMEGA LMK15

# GT OMEGA Classic Steering Wheel Stand User Manual

Model: LMK15

## INTRODUCTION

---

The GT OMEGA Classic Steering Wheel Stand is a durable, foldable, and adjustable entry-level driving simulator designed to enhance your racing experience. This manual provides essential information for the proper assembly, operation, and maintenance of your wheel stand.

It comes pre-equipped with a shifter support and a chair link for added stability and compatibility with various gaming setups. The stand is designed for easy storage and is upgrade-ready for future enhancements.

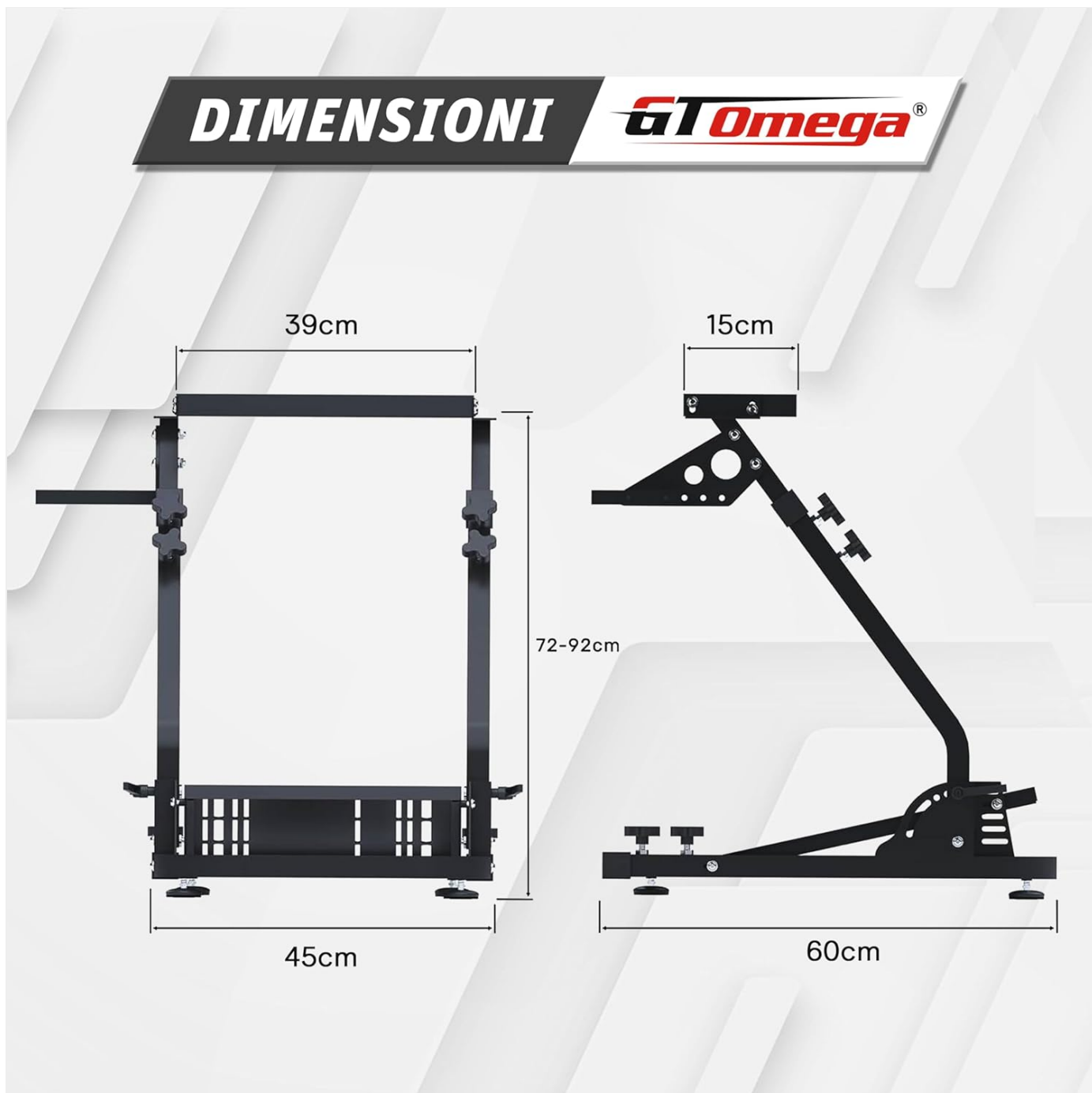

Image: The GT OMEGA Classic Steering Wheel Stand shown with a racing wheel, pedals, and shifter mounted, ready for use.

## SETUP AND ASSEMBLY

The GT OMEGA Classic Steering Wheel Stand arrives partially assembled. Follow these instructions for complete setup.

### 1. Unpacking and Component Check

- Carefully remove all components from the packaging.
- Verify that all parts listed in the included parts diagram (refer to the physical manual) are present.
- Ensure no components are damaged during transit. Contact customer support immediately if any parts are missing or damaged.

### 2. Basic Frame Assembly

The main frame of the stand is largely pre-assembled. Unfold the frame and secure any locking mechanisms as per the physical instruction diagram. The stand is designed to be stable and robust.

# **SUPPORTO PER RUOTA CLASSICO**

**GT Omega®**

Il supporto per volante GT Omega Classic è un simulatore di guida entry-level, resistente e pieghevole, con oltre 10 anni di comprovata affidabilità. Include un attacco gratuito per il collegamento della sedia e un supporto per il cambio per una maggiore compatibilità e stabilità.



Image: The GT OMEGA Classic Steering Wheel Stand with the included chair link, designed to prevent chair movement during use.

## **3. Attaching the Steering Wheel and Pedals**

The stand is compatible with most major racing wheels and pedals, including Logitech G29/G920, Thrustmaster T300/TMX, and Fanatec CSL/DD. Use the provided screws and mounting points to securely attach your equipment.

- Place your steering wheel onto the wheel plate and align the mounting holes. Secure with appropriate screws.
- Position your pedals on the pedal plate. Utilize the pre-drilled holes to fix the pedals firmly in place.

## **CARATTERISTICHE PRINCIPALI**

**GT Omega®**

### **AMPIA COMPATIBILITÀ**

Compatibile con tutti i principali volanti e pedali, inclusi  
Logitech G29/G920, Thrustmaster T300/TMX,  
Fanatec CSL/DD e altro ancora.



Image: Detail showing the mounting points for a racing wheel and pedals, highlighting broad compatibility.

#### **4. Shifter Support Installation**

The stand includes a dedicated shifter support. Attach it to either the left or right side of the main frame using the designated mounting points and hardware. Ensure it is tightened securely to prevent movement during use.

**CARATTERISTICHE  
PRINCIPALI**

**GT Omega®**

## ***PIEGHEVOLE E SALVASPAZIO***

Il telaio leggero, abbinato alla caratteristica pieghevole, lo rende la soluzione ideale per chi ha poco spazio ma ha bisogno di un supporto affidabile.

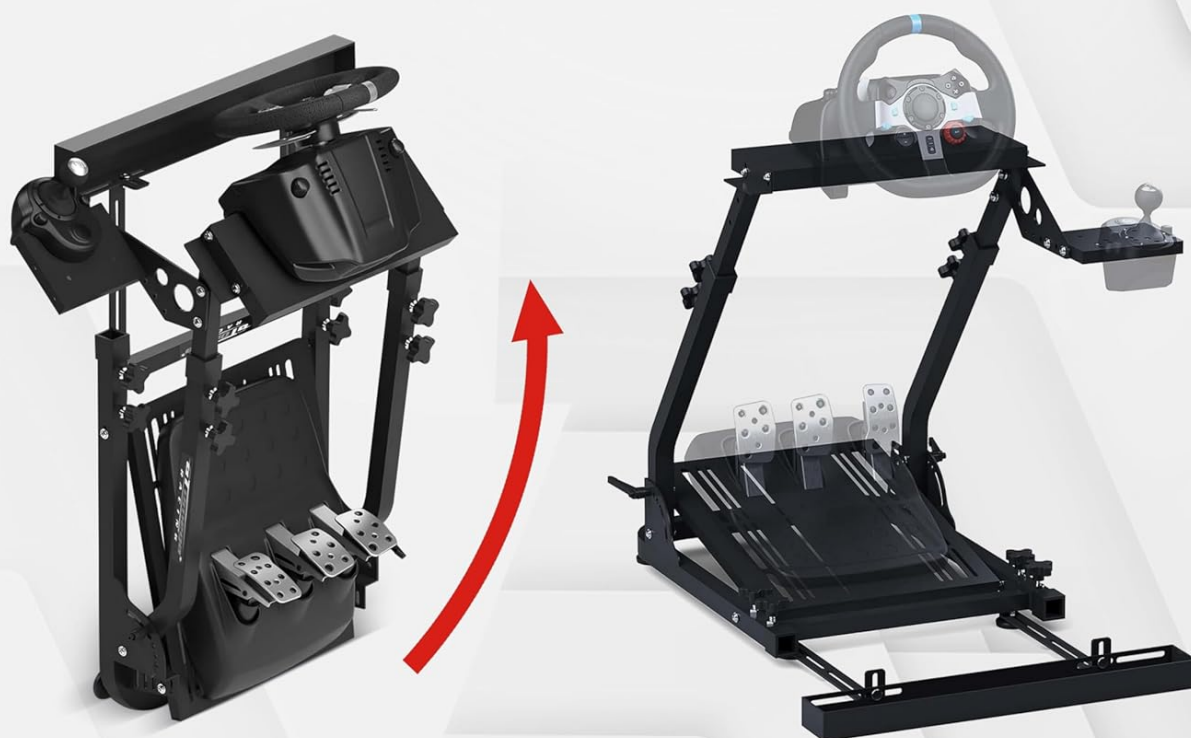

Image: A complete setup of the GT OMEGA Classic Steering Wheel Stand, including a racing wheel, pedals, and an attached shifter.

### **5. Adjustments**

The stand offers multiple adjustment options to customize your racing position:

- **Wheel Plate Angle:** Adjust the angle of the steering wheel plate for optimal comfort.
- **Height Adjustment:** Modify the height of the wheel stand to match your seating position.
- **Pedal Plate Angle:** Adjust the angle of the pedal plate for ergonomic foot placement.
- **Shifter Position:** The shifter mount can be adjusted for distance and angle.

Loosen the adjustment knobs, set to your desired position, and then firmly tighten all knobs to ensure stability.



## **CARATTERISTICHE PRINCIPALI**

**GT Omega®**

# ***COSTRUITO PER DURARE***

Realizzato in acciaio resistente, questo supporto elimina la flessione durante il gioco e rimane saldamente in posizione anche durante le gare più intense.



Image: Visual representation of the stand's adjustable components, such as the wheel bridge, left/right mountable shifter, and included chair link.

## **OPERATING INSTRUCTIONS**

Once assembled and adjusted, the GT OMEGA Classic Steering Wheel Stand provides a stable platform for your racing peripherals.

### **1. Connecting Peripherals**

- Connect your steering wheel, pedals, and shifter to your gaming console or PC according to their respective manufacturer's instructions.
- Route cables neatly using cable ties (not included) to prevent entanglement and ensure a tidy setup.

### **2. Using the Chair Link**

For enhanced stability, especially with office chairs on wheels, utilize the included Classic Chair Link. Position your chair's

front wheels into the link to prevent unwanted movement during intense racing sessions.

### 3. Folding for Storage

The stand features a foldable design for convenient storage. To fold:

1. Disconnect all peripherals from your console/PC.
2. Loosen the main adjustment knobs that control the stand's angle.
3. Carefully fold the stand into its compact position. Ensure no cables are pinched.
4. Tighten the knobs slightly to keep the stand in its folded state for transport or storage.



Image: The GT OMEGA Classic Steering Wheel Stand shown in its folded configuration, demonstrating its space-saving design.

## MAINTENANCE

Regular maintenance ensures the longevity and optimal performance of your GT OMEGA Classic Steering Wheel Stand.

- **Cleaning:** Wipe down the stand with a soft, damp cloth. Avoid abrasive cleaners or solvents that could damage the finish.
- **Tightness Check:** Periodically check all bolts, screws, and adjustment knobs to ensure they are securely tightened. Loose connections can affect stability and performance.
- **Storage:** When not in use for extended periods, store the stand in a dry, cool place, ideally in its folded configuration to save space.
- **Inspection:** Regularly inspect the frame for any signs of wear, damage, or corrosion. Address any issues promptly.

## TROUBLESHOOTING

This section addresses common issues you might encounter with your steering wheel stand.

Problem	Possible Cause	Solution
Stand feels unstable or wobbly.	Loose adjustment knobs or bolts. Uneven floor surface.	Ensure all adjustment knobs and mounting bolts are firmly tightened. Adjust the leveling feet on the base if your floor is uneven. Utilize the included chair link.
Peripherals (wheel, pedals, shifter) are moving.	Peripherals not securely mounted.	Re-check the mounting screws for your steering wheel, pedals, and shifter. Ensure they are tightened according to their respective manuals and the stand's instructions.
Difficulty folding the stand.	Adjustment knobs not fully loosened. Cables obstructing movement.	Ensure all relevant adjustment knobs are sufficiently loosened. Check for any cables or peripherals that might be obstructing the folding mechanism.

## SPECIFICATIONS

**Model Number:** LMK15

**Product Dimensions (L x W x H):** 61 x 78 x 46 cm (24 x 30.7 x 18.1 inches)

**Weight:** 13 kg (28.7 lbs)

**Material:** Heavy-duty steel construction

**Compatibility:** Universal for most major racing wheels, pedals, and shifters (e.g., Logitech G29/G920, Thrustmaster T300/TMX, Fanatec CSL/DD)

**Adjustability:** Wheel plate angle, height, pedal plate angle, shifter position.

**Features:** Foldable design, pre-equipped shifter support, Classic Chair Link included.

## WARRANTY INFORMATION

For detailed warranty information regarding your GT OMEGA Classic Steering Wheel Stand, please refer to the official GT OMEGA website or the warranty card included with your product. Warranty terms and conditions may vary by region.

## CUSTOMER SUPPORT

If you require further assistance, have questions about assembly, or need to report an issue, please visit the official GT OMEGA support website. You can typically find FAQs, contact forms, and additional resources there.

**GT OMEGA Official Website:** [www.gtomega.com](http://www.gtomega.com)



