

OSD Audio TSM-T9

OSD Audio TSM-T9 Dual Arm Desk Mount User Manual

Model: TSM-T9

Brand: OSD Audio

1. INTRODUCTION AND OVERVIEW

This manual provides comprehensive instructions for the safe and efficient installation, operation, and maintenance of your OSD Audio TSM-T9 Dual Arm Desk Mount. This heavy-duty mount is designed to securely hold two LCD monitors ranging from 13 inches to 23 inches, enhancing your workspace ergonomics and organization.

The TSM-T9 features a robust black anodized aluminum construction, offering durability and stability. It supports monitors with a maximum weight of 15 kg (33 lbs) per monitor and is VESA compliant with 75x75mm and 100x100mm patterns. The mount allows for flexible adjustments including tilt (+60°/-60°), 180° swivel, and 360° rotation, enabling optimal viewing angles. Integrated cable management helps maintain a tidy desk environment.



Figure 1: OSD Audio TSM-T9 Dual Arm Desk Mount

This image displays the complete OSD Audio TSM-T9 dual arm desk mount, showcasing its central pole, two articulating arms, and VESA mounting plates. The black anodized aluminum finish is visible, highlighting the sturdy construction designed for two monitors.

2. SAFETY INFORMATION

- **Weight Capacity:** Do not exceed the maximum weight capacity of 15 kg (33 lbs) per monitor. Exceeding this limit can result in instability, property damage, or personal injury.
- **Monitor Size:** This mount is designed for monitors between 13 and 23 inches. Using monitors outside this range may compromise stability and functionality.
- **Desk Thickness:** Ensure your desk surface is strong enough to support the combined weight of the mount and two monitors. The desk clamp requires a stable and appropriate thickness.
- **Assembly:** Follow all assembly instructions carefully. Improper installation can lead to serious injury. If you are unsure about any part of the installation, seek professional assistance.
- **Pinch Points:** Be aware of potential pinch points during assembly and adjustment of the arms. Keep hands and fingers clear of moving parts.
- **Cable Management:** Route cables carefully to prevent snagging or damage, which could lead to monitors falling or electrical hazards.
- **Proposition 65 Warning:** This product may contain chemicals known to the State of California to cause cancer and birth defects or other reproductive harm. Wash hands after handling.

3. PACKAGE CONTENTS

Please verify that all components are present and undamaged before beginning assembly. If any parts are missing or damaged, contact OSD Audio customer support.

- Main Support Pole
- Desk Clamp Assembly (Base, Clamp Plate, Tightening Knob/Screws)
- Dual Articulating Monitor Arms (2 units)
- VESA Mounting Plates (2 units)
- Hardware Kit (various screws, washers, spacers for VESA mounting)
- Hex Keys / Allen Wrenches (for assembly and adjustments)
- Cable Management Clips (if included)

4. SPECIFICATIONS

Heavy Duty Dual LCD T Series Desk Mount

- ❖ Black Anodized Aluminum
- ❖ Dual LCD Monitors
- ❖ 60° up, 60° down tilt



TSM-T9

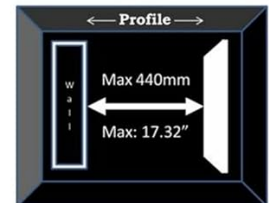

Figure 2: Key Specifications and Features

This image illustrates the OSD Audio TSM-T9 mount with callouts for key specifications, including monitor size compatibility (13"-23"), maximum weight capacity (15kg/33lbs per monitor), and a profile view showing maximum height (440mm / 17.32").

Product Specifications

| Feature | Detail |
|--------------------------|---|
| Model Number | TSM-T9 (OSD-TSM-T9) |
| Compatible Monitor Sizes | 13 inches to 23 inches |
| Maximum Weight Capacity | 15 kg (33 lbs) per monitor |
| VESA Compliance | 75x75mm, 100x100mm |
| Tilt Adjustment | +60° / -60° |
| Swivel Adjustment | 180° |
| Rotation Adjustment | 360° (Portrait to Landscape) |
| Mounting Type | Tabletop Clamp Mount |
| Material | Black Anodized Aluminum |
| Product Dimensions | 26.4 x 13.1 x 4.1 inches (approximate, assembled) |
| Item Weight | 9.8 pounds |
| UPC | 810281017839 |

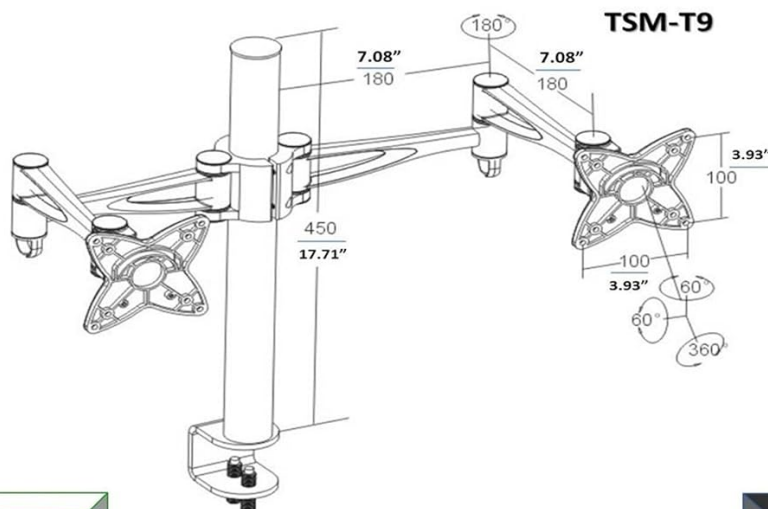

Figure 3: Detailed Dimensions and Adjustment Ranges

This image provides a technical drawing of the OSD Audio TSM-T9, detailing various dimensions in millimeters and inches, including arm length (180mm / 7.08"), pole height (450mm / 17.71"), and VESA plate dimensions (100mm / 3.93"). It also visually represents the swivel (180°), tilt (+60°/-60°), and rotation (360°) capabilities, along with VESA compatibility (75x75, 100x100).

5. SETUP INSTRUCTIONS

Before you begin, ensure you have a clear workspace and all package contents are accounted for. Two people are recommended for safely mounting monitors.

1. Attach Desk Clamp to Pole:

Secure the desk clamp base to the bottom of the main support pole using the provided screws. Ensure it is tightened firmly.

2. Mount Pole to Desk:

Position the assembled pole and clamp on your desk. Adjust the clamp plate and tighten the knob/screws until the pole is securely fastened to the desk surface. Ensure the mount is stable and does not wobble.

3. Attach Articulating Arms:

Slide the two articulating monitor arms onto the main support pole. Adjust their height to your desired position and secure them using the set screws on the arm collars with the provided hex key. Ensure they are level and firmly attached.

4. Attach VESA Plates to Monitors:

Carefully place your monitor face down on a soft, clean surface. Align the VESA mounting plate with the screw holes on the back of your monitor (either 75x75mm or 100x100mm pattern). Use the appropriate screws and washers from the hardware kit to secure the plate to the monitor. Do not overtighten.

5. Mount Monitors to Arms:

With assistance, carefully lift each monitor and slide its VESA plate onto the corresponding arm's mounting head. Ensure the monitor clicks into place or is secured with any provided locking mechanism. Double-check that both monitors are securely attached before releasing them.

6. Cable Management:

Route your monitor power and video cables through the integrated cable management clips or channels on the arms and pole. This helps to keep your workspace tidy and prevents cable damage.

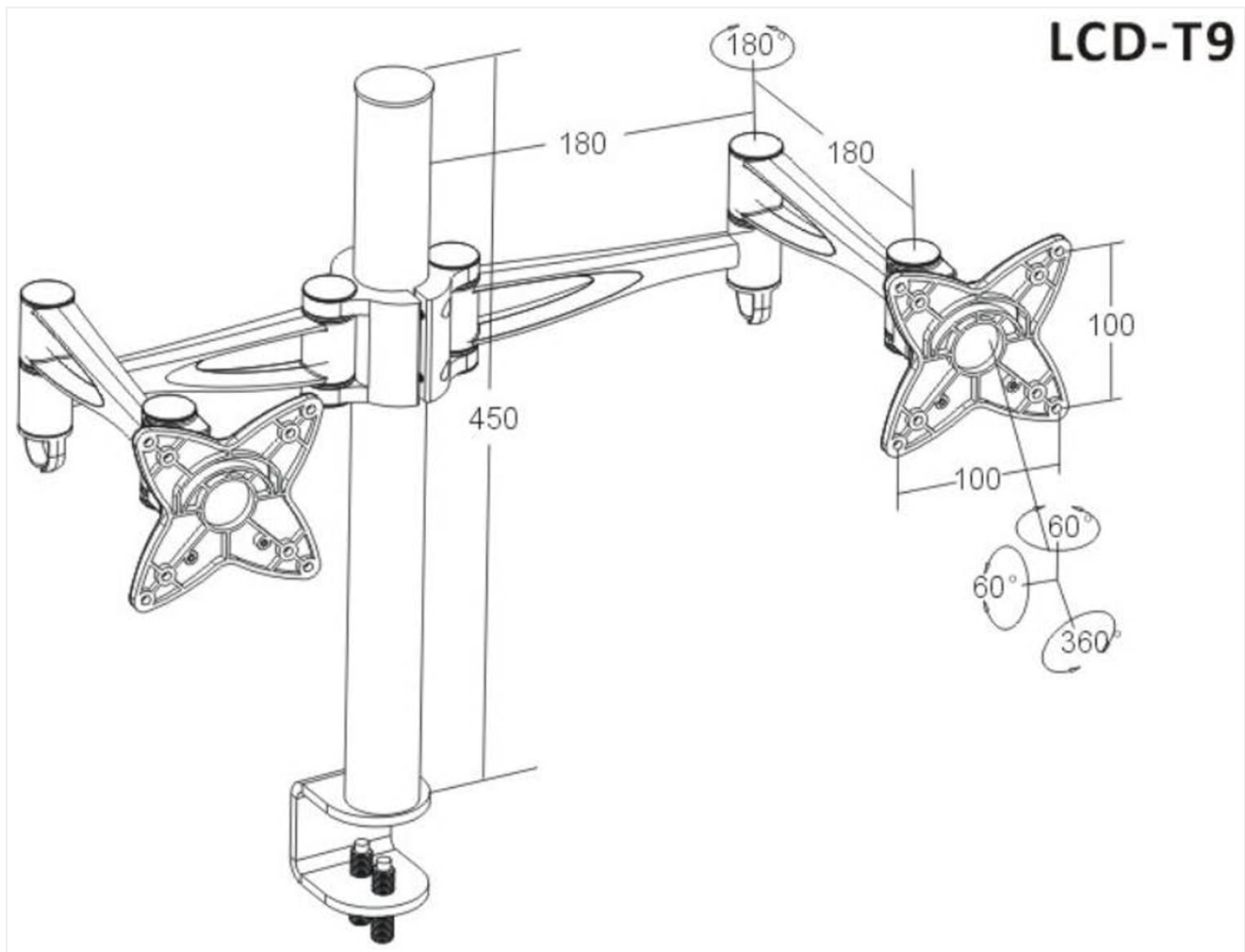

Figure 4: Technical Diagram for Assembly Reference

This line drawing provides a clear, simplified view of the OSD Audio TSM-T9 mount, illustrating the main components and their relative positions, useful for assembly. It includes key measurements and indicates the range of motion for tilt, swivel, and rotation.

6. OPERATING INSTRUCTIONS

Once your monitors are securely mounted, you can adjust their position to achieve optimal ergonomic viewing.

- **Height Adjustment:** To adjust the height of the monitors, loosen the set screws on the arm collars on the main pole, slide the arms to the desired height, and re-tighten the screws firmly.
- **Tilt Adjustment:** The monitor can be tilted up or down by grasping the top and bottom edges of the monitor and gently adjusting it to the desired angle (+60° to -60°).
- **Swivel Adjustment:** The monitor arms can swivel 180° horizontally around the main pole. The VESA plate also allows for 180° swivel.
- **Rotation Adjustment:** You can rotate your monitor 360° to switch between landscape and portrait orientations. Simply grasp the monitor and turn it.
- **Arm Extension/Retraction:** The articulating arms allow you to extend or retract your monitors closer or further from you.

Always make adjustments smoothly and ensure all screws are tightened after repositioning to maintain stability.

7. MAINTENANCE

- **Cleaning:** Clean the mount with a soft, damp cloth. Avoid abrasive cleaners or solvents that could damage the finish.
- **Periodic Checks:** Periodically check all screws and connections to ensure they remain tight and secure. Over time, vibrations or frequent adjustments can cause fasteners to loosen.
- **Lubrication:** No lubrication is typically required for this type of mount. If any joints become stiff, consult OSD Audio customer support.

8. TROUBLESHOOTING

Common Issues and Solutions

| Problem | Possible Cause | Solution |
|------------------------------------|--|---|
| Mount wobbles or is unstable. | Desk clamp not tightened sufficiently; desk surface too thin or weak; main pole not secured. | Ensure the desk clamp is fully tightened. Verify your desk can support the weight. Check set screws securing the pole. |
| Monitor sags or tilts downwards. | Monitor is too heavy for the tilt mechanism; tilt adjustment screw is loose. | Verify monitor weight is within limits (15kg/33lbs). Tighten the tilt adjustment screw on the VESA plate joint using the provided hex key. |
| Difficulty adjusting arm movement. | Joints are too tight. | Use the provided hex key to slightly loosen the tension screws at the arm joints until desired movement is achieved. Do not loosen excessively. |
| Monitors are not level. | Arms are not at the same height on the pole; VESA plate not perfectly aligned. | Adjust the height of the arms on the main pole. Ensure VESA plates are mounted straight on monitors. |



9. WARRANTY AND SUPPORT



For warranty information and customer support, please refer to the documentation included with your purchase or visit the official OSD Audio website. Keep your purchase receipt as proof of purchase for any warranty claims.

Manufacturer: OSD Audio

For further assistance, please contact OSD Audio customer service directly.

Related Documents - TSM-T9

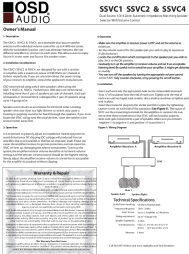
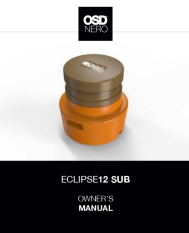
| | |
|--|---|
|  STEREO SPEAKER SELECTORS OSD-SSVC6D  USER MANUAL | OSD SSVC6D 6-Zone Stereo Speaker Selector User Manual User manual for the OSD SSVC6D, a 6-zone stereo speaker selector with dual source operation, internal volume controls, and adjustable impedance matching. Learn about installation, operation, safety precautions, and hookup. |
|--|---|

| | |
|---|--|
|  | <p>OSD Nero ARC Pendant Speakers Install Guide</p> <p>Installation guide for OSD Nero ARC 4/6/8/SUB 70V/100V/8 Ohm pendant speakers, covering preparation, hanging, setup, operation, specifications, troubleshooting, and warranty information.</p> |
|  | <p>OSD Audio SSV1, SSV2, SSV4 Dual Source Speaker Selector Owner's Manual</p> <p>Owner's manual for OSD Audio SSV1, SSV2, and SSV4 dual source speaker selectors. Includes descriptions, installation, operation, warranty, and technical specifications for these audio devices.</p> |
|  | <p>OSD Nero Eclipse12 Subwoofer Owner's Manual and Installation Guide</p> <p>Comprehensive guide for the OSD Nero Eclipse12 Subwoofer, covering model specifications, installation instructions, wiring diagrams, and warranty details for outdoor audio systems.</p> |
|  | <p>OSD NERO Stream XD/XD2 Integrated Amplifier Wi-Fi Streamer Owner's Manual</p> <p>Comprehensive owner's manual for the OSD NERO Stream XD and XD2 integrated amplifier Wi-Fi streamers. Learn about setup, connections, features, streaming services, app control, specifications, and warranty.</p> |
|  | <p>OSD SRT4 GEN2 4-Zone Wi-Fi Smart Preamp Streamer Owner's Manual</p> <p>Detailed owner's manual for the OSD SRT4 GEN2 4-Zone Wi-Fi Smart Preamp Streamer, covering setup, connections, streaming services, multi-room audio, specifications, and warranty information.</p> |