

Quad Lock QLM-BMP-BL

Quad Lock Stem/Handlebar Bike Mount Pro User Manual

Model: QLM-BMP-BL

1. Introduction

The Quad Lock Stem/Handlebar Bike Mount Pro is designed to securely attach your smartphone to your bicycle's stem or handlebars. Featuring a patented dual-stage locking mechanism, it provides a strong and reliable hold, allowing you to access your phone's apps on the go with confidence. This mount is compatible with all Quad Lock Cases and Universal Adapters (sold separately).



Image: The Quad Lock Stem/Handlebar Bike Mount Pro, showcasing its compact design and dual-stage locking mechanism.

2. What's in the Box

Your Quad Lock Stem/Handlebar Bike Mount Pro package includes the following components:

- 1 x Quad Lock Stem / Handlebar Bike Mount
- Mounting Hardware (4 x EPDM O-Rings, 2 x Zipties)



Image: A close-up view of the Quad Lock Bike Mount Pro and its included mounting hardware.

3. Key Features

- **Lightweight, Strong, and Secure:** Engineered for maximum security and minimal weight.
- **Patented Dual-Stage Lock:** Ensures your phone is held securely to your bike, even over bumps and jumps.

- **Quick Attach/Detach:** Simple twist and lock system provides easy access to your smartphone.
- **Easy Installation:** Designed to fit stems or handlebars with a tube diameter of 25-40mm.
- **Compatibility:** Works seamlessly with all Quad Lock Cases and Adapters (not included).

4. Setup and Installation

Follow these steps to install your Quad Lock Bike Mount Pro:

1. **Choose Mounting Location:** Identify a suitable position on your bike's stem or handlebars. Ensure the surface is clean and dry. The mount is designed for tube diameters between 25-40mm.
2. **Secure the Mount:** Use either the provided EPDM O-Rings or Zipties to firmly attach the mount to your chosen location. For O-Rings, stretch them around the mount and the handlebar/stem, ensuring a snug fit. For Zipties, thread them through the mount's designated slots and tighten securely.



Image: A hand securing the Quad Lock Bike Mount Pro to a bicycle handlebar using a zip tie.

3. **Test Stability:** Once installed, gently try to move the mount to ensure it is stable and does not rotate or slide. Adjust as necessary.



Image: The Quad Lock Bike Mount Pro securely installed on a bicycle handlebar, ready for phone attachment.

5. Operating Instructions

Using your Quad Lock Bike Mount Pro is simple and intuitive:

1. **Attach Your Phone:** Align your Quad Lock equipped phone (with a Quad Lock Case or Universal Adapter) with the mount. The phone's adapter should fit into the mount's receiver.
2. **Twist to Lock:** Once aligned, gently push your phone down onto the mount and twist it 45 degrees until you hear and feel a click. This engages the patented dual-stage locking mechanism, securing your phone firmly in place.



Image: A hand demonstrating the twist-and-lock motion to secure a phone onto the Quad Lock Bike Mount.

3. **Verify Lock:** Before riding, always ensure your phone is fully locked by gently pulling upwards on it. It should not detach.
4. **Detach Your Phone:** To remove your phone, press down on the blue lever located on the mount and twist your phone 45 degrees in the opposite direction. Once unlocked, lift your phone off the mount.



Image: An iPhone securely mounted on a bicycle handlebar using the Quad Lock Bike Mount Pro, displaying a map application.



Image: A Samsung Galaxy phone mounted on a bicycle handlebar, showing its secure and accessible position for cycling.

6. Maintenance

To ensure the longevity and optimal performance of your Quad Lock Bike Mount Pro, follow these simple maintenance guidelines:

- **Cleaning:** Periodically wipe down the mount with a damp cloth to remove dirt and grime. Avoid harsh chemicals or abrasive cleaners.
- **Inspect Components:** Regularly check the O-Rings or Zipties for signs of wear, stretching, or damage. Replace them if necessary to maintain a secure fit.
- **Lubrication:** The locking mechanism is designed for smooth operation. If it feels stiff, a small amount of silicone-based lubricant can be applied to the moving parts.

7. Troubleshooting

If you encounter any issues with your Quad Lock Bike Mount Pro, consider the following:

- **Mount Slipping on Handlebar/Stem:** Ensure the O-Rings or Zipties are tightened sufficiently. If using O-Rings, try using an additional set or replacing worn ones. For Zipties, ensure they are pulled taut.
- **Phone Not Locking Securely:** Verify that your phone is equipped with an official Quad Lock Case or Universal Adapter. Ensure the phone is properly aligned with the mount and twisted a full 45 degrees until a distinct click is heard/felt. Check for any debris in the locking mechanism.
- **Difficulty Detaching Phone:** Ensure you are fully depressing the blue release lever on the mount before twisting the phone. The mechanism requires a firm press to disengage.

8. Specifications

Feature	Detail
Product Dimensions	1.69 x 1.26 x 5.12 inches
Item Weight	1.41 ounces
Item Model Number	QLM-BMP-BL
Color	Black/Blue





Manufacturer	Annex Products Pty Ltd
Country of Origin	China
Compatible Devices	Smartphones (with Quad Lock Cases)
Mounting Type	Handlebar / Stem

9. Warranty and Support

For information regarding product warranty, returns, or additional support, please refer to the official Quad Lock website or contact Quad Lock customer service directly. You can also visit the [Quad Lock Store on Amazon](#) for more details and product information.

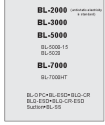
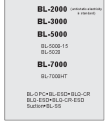
© 2025 Quad Lock. All rights reserved.

Related Documents - QLM-BMP-BL

	<p>NDakter Bike Lock: Step-by-Step Password Reset Guide</p> <p>Detailed instructions for resetting the password on your NDakter 5-digit combination bike lock. Learn how to change your code easily and securely, with tips for remembering your new password.</p>
	<p>HIOS Brushless Driver BL Series Operation Manual</p> <p>Comprehensive operation manual for HIOS BL Series Brushless Drivers, covering specifications, parts identification, accessories, operating procedures, torque adjustment, and troubleshooting for models like BL-2000, BL-3000, BL-5000, and BL-7000.</p>
	<p>HIOS Brushless Driver BL Series Operation Manual</p> <p>This operation manual provides detailed information on the HIOS Brushless Driver BL Series, including models BL-2000, BL-3000, BL-5000, and BL-7000. It covers parts identification, specifications, accessories, power supplies, operating procedures, torque adjustment, and troubleshooting.</p>
	<p>Sportneer Bike D Lock User Manual - Heavy Duty Bicycle Security</p> <p>Comprehensive user manual for the Sportneer Bike D Lock, detailing features, installation, usage, and FAQs for optimal bicycle security. Includes information on the U-lock, security cable, and mounting bracket.</p>
	<p>Tcyoatoa 4-Digit Combination Cable Lock User Guide</p> <p>Comprehensive instructions for the Tcyoatoa 4-digit combination cable lock. Learn how to easily unlock your lock and follow the step-by-step guide to reset your password for enhanced security of bikes, lockers, and more.</p>
	<p>Panasonic Network Camera Setup Guide: BL-C210 & BL-C230 Installation and Configuration</p> <p>Comprehensive setup guide for Panasonic network cameras, models BL-C210 and BL-C230. Learn how to install, configure network settings, access remotely, and use viewer software.</p>

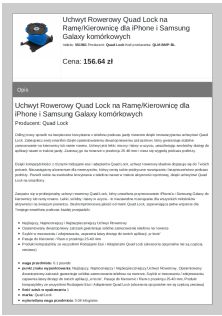

[pdf]

Uchwyt Rowerowy Quad Lock na Ramie Kierownicy dla iPhone i Samsung Galaxy komórkowych Sklep internetowy stylem.pl uchwyt rowerowy quad lock rame kit Uchwyt Rowerowy Quad Lock na Ram/Kierownic dla iPhone i Samsung Galaxy komrkowych Indeks: 551961 Producent: Quad Lock iPhone i Samsung Galaxy komrkowych Producent: Quad Lock Odkryj nowy sposób na bezpieczne... lang:pl score:31 filesize: 87.54 K page_count: 2 document date: 2024-10-07

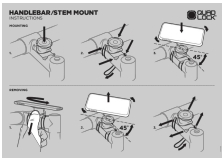

[pdf] Instructions Borchure

Quad Lock® Stem Handlebar Bike Mount Outback Equipment QLM BMP BL outbackequipment.au assets brochures ||| HANDLEBAR/STEM MOUNT INSTRUCTIONS MOUNTING 1. 2. REMOVING 3. 454545 1. 2. 4455 45 3. 2002-020 ... lang:pl score:22 filesize: 256.68 K page_count: 1 document date: 2020-05-08



[pdf]

Link JBI Product Details Quad Lock MAP Policy drive google file d.1Jgp ZktuPNIZdt4R LRKFDrNPiBd 7q9 view ||| Quad Lock MAP and Online Sales Policies Quad Lock smart phone mounting products are premium products ... 9.99 59.99 59.99 59 Quad Lock Stem / Handlebar Bike Mount QLM-OFM-2 Quad Lock Out Front Mount V2 QLM-OF... lang:en score:19 filesize: 178.95 K page_count: 22 document date: 2024-12-15



[pdf] Catalog

Catalogue QUADLOCK 2022 EN mybihr medias context bWFzdGVyfiHJvB3R8NDlyNDM4NXhcHBsaWNhdGlvbi9wZGZ8aDg4L2hmZS8zMdGzMzM3ODI5NTgtzOC9DYXRhbG9ndWUgUVVvBRExPQ0sgMjAyMiAtIiEVLn attachment true ||| 2022 PRODUCT CATALOGUE QUADLOCKCASE.NET Story: Where it all began. Our story started with wanting ... OCKCASE.NET BL The Quad Lock Bike Mount is the lightest and strongest smartphone bike mounting system on... lang:en score:17 filesize: 4.03 M page_count: 28 document date: 2022-11-10



[pdf] Accessories Catalog

PRODUCT CATALOGUE Totmoto Add to your existing Desk Mount for an easy magnetic attachment no Twist Lock required Easy change from portrait landscape 2023 Q4 PRODUCT CATALOGUE QUADLOCKCASE.NET We give people the confidence to explore their world. B ... OCKCASE.N BMP-BL BIHR P/N 1118088 The Quad Lock Bike Mount is the lightest and strongest smartphone bike m... lang:en score:16 filesize: 4.01 M page_count: 32 document date: 2023-11-27