

[Manuals.plus](#) /

› [Light Fixture Industries](#) /

› LFI Lights | Combo Red Exit Sign with Emergency Lights | White Housing | All LED | Two Adjustable Square Heads | Hardwired with Battery Backup | UL Listed | COMBO2-R-W-BB Battery Backup White Housing

Light Fixture Industries COMBO2-R-W-BB

LFI Lights Combo Red Exit Sign with Emergency Lights User Manual

Model: COMBO2-R-W-BB

Brand: Light Fixture Industries

1. INTRODUCTION

This manual provides detailed instructions for the installation, operation, and maintenance of the LFI Lights Combo Red Exit Sign with Emergency Lights, Model COMBO2-R-W-BB. This unit is designed to provide clear exit indication and emergency illumination during power outages, ensuring compliance with safety regulations.

Important Safety Information

WARNING: Read all instructions carefully before installation. Failure to do so may result in electric shock, fire, or other hazards that could cause injury or death.

- This product must be installed in accordance with the applicable installation code by a person familiar with the construction and operation of the product and the hazards involved.
- Ensure the main power supply is disconnected before installation or servicing.
- This unit is UL 924 Listed, and complies with NEC, OSHA, and NFPA 101 Life Safety Code standards.
- Do not mount near gas or electric heaters.
- Do not allow power supply cords to be subjected to undue stress.
- The unit is designed for damp locations but should not be exposed to direct water spray or submersion.



Figure 1: LFI Lights Combo Red Exit Sign with Emergency Lights, showing the red "EXIT" sign and two adjustable LED emergency light heads.

2. SETUP AND INSTALLATION

This unit is designed for hardwired installation and comes with a universal mounting plate for various mounting options (ceiling, wall, end). Ensure all local and national electrical codes are followed during installation.

2.1 Mounting

1. **Disconnect Power:** Turn off the main power supply at the circuit breaker before beginning installation.
2. **Select Mounting Location:** Choose a suitable location that provides clear visibility for the exit sign and adequate illumination from the emergency lights.
3. **Prepare Housing:** Remove the faceplate and diffuser from the unit. The housing is injection-molded, 5VA flame retardant thermoplastic.
4. **Mounting Plate:** Secure the universal mounting plate to the junction box or mounting surface using appropriate hardware (not included).
5. **Wire Connections:** Connect the unit's wires to the building's electrical supply (120/277 VAC operation).
 - Connect the black wire to 120V AC supply.
 - Connect the red wire to 277V AC supply.
 - Connect the white wire to the neutral wire.
 - Cap off any unused wires.



Figure 2: Internal wiring and battery compartment. Ensure proper wire connections and battery installation.

2.2 Battery Connection

The unit includes a long-lasting NiCad battery. Connect the battery pack to the circuit board. Ensure the connection is secure. The battery is designed for low maintenance and provides backup power during outages.

2.3 Final Assembly

1. **Knock-out Arrows:** If required, use the knock-out arrows on the faceplate to indicate the direction of exit.
2. **Reattach Faceplate:** Securely reattach the faceplate and diffuser to the housing.
3. **Restore Power:** Once installation is complete and all connections are secure, restore power to the unit at the circuit breaker.

3. OPERATING INSTRUCTIONS

3.1 Initial Operation and Charging

Upon initial power-up, the unit will begin charging its battery. Allow at least 24 hours for the battery to fully charge before conducting the first test. The AC indicator light (usually green) will illuminate when AC power is present and the battery is charging.



Figure 3: AC indicator light and test button. The green light indicates AC power is present.

3.2 Testing the Unit

Regular testing is crucial to ensure the unit functions correctly during a power outage.

1. **Monthly Test:** Press and hold the "TEST" button for approximately 30 seconds. The emergency lights should illuminate, and the exit sign should remain lit (if applicable). Release the button; the lights should turn off, and the AC indicator should re-illuminate.
2. **Annual Test:** Disconnect AC power to the unit for a minimum of 90 minutes. The emergency lights and exit sign should remain illuminated for the entire duration. Reconnect AC power; the unit should return to normal operation and begin recharging.

3.3 Adjusting Emergency Light Heads

The two square emergency light heads are adjustable, allowing for optimal light direction. They can rotate 360 degrees and pivot 180 degrees to direct light where needed most.

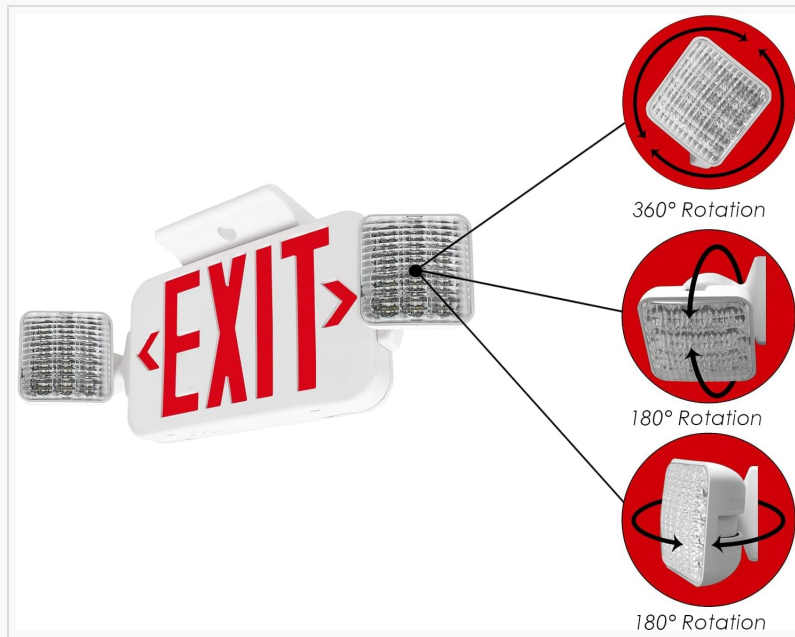

Figure 4: Illustration of the adjustable emergency light heads, demonstrating their full range of motion.

4. MAINTENANCE

The LFI Lights Combo Exit Sign is designed for low maintenance. However, periodic checks are recommended to ensure optimal performance.

- **Cleaning:** Clean the exterior of the unit and light heads periodically with a soft, damp cloth. Do not use abrasive cleaners or solvents.
- **Battery:** The NiCad battery is long-lasting. If the unit fails the monthly or annual test, the battery may need replacement. Contact a qualified electrician for battery replacement.
- **Inspection:** Periodically inspect the unit for any visible damage, loose connections, or signs of wear.

5. TROUBLESHOOTING

Refer to the table below for common issues and their solutions.

Problem	Possible Cause	Solution
AC indicator light is off.	No AC power to the unit.	Check circuit breaker. Ensure unit is properly wired to AC supply.
Emergency lights do not illuminate during power outage or test.	Battery not connected, discharged, or faulty.	Ensure battery is securely connected. Allow 24 hours for initial charge. If problem persists, battery may need replacement.

Problem	Possible Cause	Solution
Emergency lights remain on constantly.	Unit is in emergency mode due to power interruption or test button stuck.	Check AC power supply. Ensure test button is not stuck. If AC power is present, battery may be fully discharged and unit is operating on emergency power. Allow time to recharge.
Exit sign not lit (if applicable).	No AC power or internal LED failure.	Check AC power. If AC is present and emergency lights work, contact support for LED failure.

6. SPECIFICATIONS

- **Model Number:** COMBO2-R-W-BB (FBA_COMBOR2)
- **Brand:** Light Fixture Industries
- **Input Voltage:** 120/277 VAC
- **Light Type:** All LED (Exit Sign and Emergency Heads)
- **Battery Type:** NiCad (Nickel-Cadmium), 1 Product Specific battery required (included)
- **Housing Material:** Injection molded, 5VA flame retardant thermoplastic
- **Color:** White Housing
- **Dimensions:** Approximately 20 x 2 x 8 inches (50.8 x 5.08 x 20.32 cm)
- **Product Dimensions (L x W):** 19.22"L x 8.13"W
- **Item Weight:** 2 pounds (0.91 kg)
- **Mounting Type:** Universal (Ceiling Mount, Wall Mount, End Mount)
- **Compliance:** UL 924 Listed, NEC, OSHA, NFPA 101 Life Safety Code
- **Protection:** Short circuit, voltage surge, brown out, and low battery voltage disconnect protected.
- **Location Rating:** Damp Location Listed

7. WARRANTY AND SUPPORT

7.1 Return Policy

This product is subject to a 30-day refund/replacement return policy from the date of purchase. Please refer to your retailer's specific return guidelines for detailed information.

7.2 Technical Support

For technical assistance, troubleshooting beyond this manual, or warranty inquiries, please contact Light Fixture Industries directly. Refer to the contact information provided with your purchase or visit the official Light Fixture Industries website for support details.

Manufacturer: Light Fixture Industries

Seller: Light Fixture Industries (via Amazon Fulfillment)

For further information, you may visit the [Light Fixture Industries Store on Amazon](#).

© 2023 Light Fixture Industries. All rights reserved.

This manual is for informational purposes only. Specifications are subject to change without notice.