

TP-Link TL-WN823N

TP-Link TL-WN823N N300 Mini USB Wireless WiFi Network Adapter User Manual

Model: TL-WN823N

1. INTRODUCTION

This manual provides comprehensive instructions for the installation, operation, and maintenance of your TP-Link TL-WN823N N300 Mini USB Wireless WiFi Network Adapter. This device is designed to provide high-speed wireless connectivity for your computer, enabling seamless internet access, streaming, and online gaming. The TL-WN823N offers wireless transmission rates up to 300Mbps, operating within the 2.400-2.4835GHz frequency range. Its compact, mini USB 2.0 interface ensures portability and convenience. It is compatible with various operating systems including Windows (XP/7/8/8.1/10), Mac OS (10.7~10.13), and Linux Kernel (2.6.24~4.9.60). Please note that actual wireless performance may vary based on environmental factors, network conditions, and client limitations.



Figure 1.1: TP-Link TL-WN823N N300 Mini USB Wireless WiFi Network Adapter and Packaging

This image displays the compact TP-Link TL-WN823N N300 Mini USB Wireless WiFi Network Adapter alongside its retail packaging. The packaging highlights key features such as 300Mbps speed, mini size, and compatibility with Mac and Linux operating systems.

2. PACKAGE CONTENTS

Verify that your package contains the following items:

- Wireless Adapter TL-WN823N
- Resource CD
- Quick Installation Guide

3. SETUP

3.1 Hardware Installation

1. Insert the TL-WN823N adapter into an available USB port on your computer. Ensure it is firmly seated.



300Mbps at 2.4GHz



Video



Voice



Game



Figure 3.1: Inserting the Adapter

This diagram illustrates the first step of setup: inserting the TP-Link TL-WN823N Mini USB Wireless Adapter directly into a USB port on your computer.

3.2 Driver Installation

After inserting the adapter, you need to install the necessary drivers. You have two options:

1. **Using the Included CD:** Insert the Resource CD into your computer's CD-ROM drive and follow the on-screen instructions to install the drivers.
2. **Downloading from TP-Link Website:** If your computer does not have a CD drive or if you prefer the latest

drivers, visit the official TP-Link support website. Navigate to the support page for the TL-WN823N model and download the appropriate drivers for your operating system. The direct link for drivers is typically found on the product's support page on www.tp-link.com.

3.3 Connecting to a Wireless Network

Once the drivers are installed, you can connect to a wireless network. The TL-WN823N supports Wi-Fi Protected Setup (WPS) for quick and easy connection.

1. Using WPS Button:

- Press the WPS button on your wireless router.
- Within two minutes, press the WPS button on your TL-WN823N adapter. The adapter will automatically connect to your Wi-Fi network.

2. Manual Connection:

- Open your computer's wireless network settings.
- Scan for available networks.
- Select your desired Wi-Fi network (SSID) from the list.
- Enter the network security key (password) when prompted.
- Click 'Connect' to establish the connection.



Figure 3.2: WPS Connection with Router

This image illustrates the process of connecting to a Wi-Fi network by pressing the WPS button on your wireless router.

Press the WPS Button to Connect Your Wi-Fi

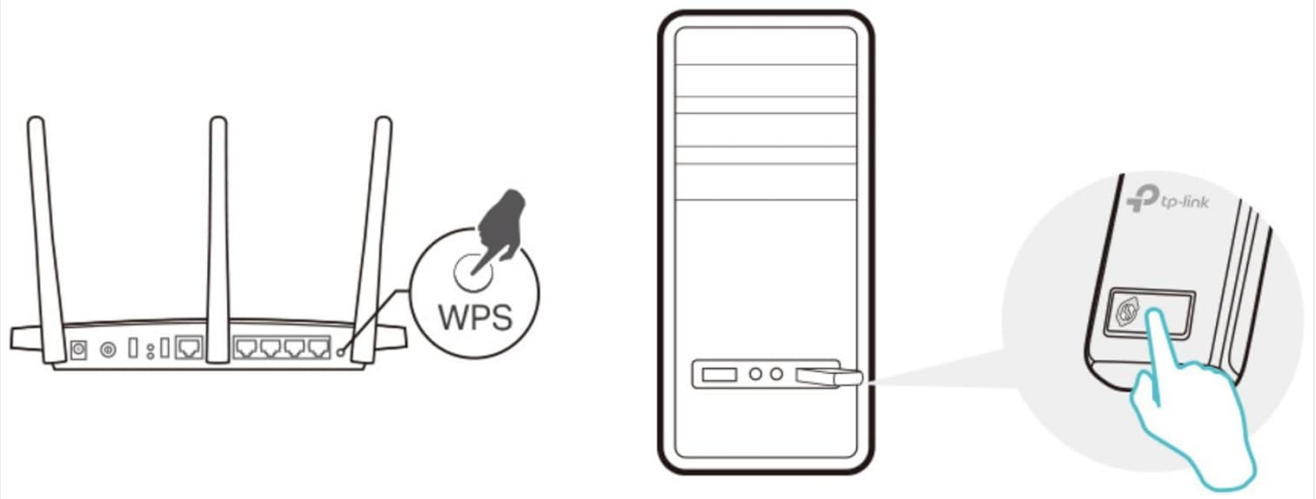

Figure 3.3: WPS Connection with PC

This image demonstrates pressing the WPS button on the computer, which is part of the WPS connection process for the TL-WN823N adapter.

4. OPERATING THE ADAPTER

Once connected, your TL-WN823N adapter provides a stable and fast wireless connection for various online activities.

4.1 High-Speed Connectivity

The adapter supports speeds up to 300Mbps, ideal for:

- **HD Streaming:** Enjoy lag-free high-definition video streaming.
- **Online Gaming:** Experience smooth and responsive online gaming.
- **Voice Calls:** Conduct clear voice and video calls without interruptions.

Easy Set Up

- 1 Insert the adapter into a USB port on your computer directly

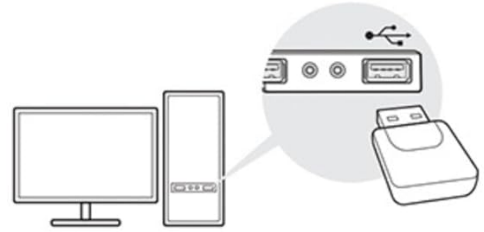

- 2 Install the software with the include CD or download from

<https://www.tp-link.com/en/download/TL-WN823N.html#Driver>

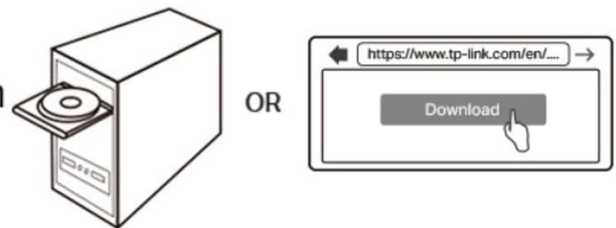

- 3 Scan for the available networks and connect to finish the installation



Figure 4.1: High-Speed Performance

This image highlights the TP-Link TL-WN823N adapter's capability to deliver 300Mbps speeds at 2.4GHz, suitable for video streaming, voice communication, and online gaming.

4.2 Hotspot Functionality

With the appropriate software (often included with the driver utility), you can easily establish a high-speed Wi-Fi hotspot using your computer and the TL-WN823N adapter. This allows other devices to connect to your computer's internet connection.

5. MAINTENANCE

To ensure the longevity and optimal performance of your TL-WN823N adapter, follow these maintenance guidelines:

- **Keep Clean:** Regularly wipe the adapter with a soft, dry cloth to remove dust and debris. Avoid using liquid cleaners or solvents.
- **Proper Handling:** Avoid dropping the adapter or subjecting it to strong impacts.
- **Storage:** When not in use, store the adapter in a cool, dry place away from direct sunlight and extreme temperatures.

- **Firmware Updates:** Periodically check the TP-Link website for any available firmware updates for your model. Updating firmware can improve performance and stability.

6. TROUBLESHOOTING

If you encounter issues with your TL-WN823N adapter, refer to the following common troubleshooting steps:

6.1 Connection Issues

- **No Connection/Frequent Disconnections:**
 - Ensure the adapter is securely plugged into a USB port. Try a different USB port.
 - Verify that the correct drivers are installed. Reinstall drivers if necessary.
 - Check your Wi-Fi network's password and ensure it is entered correctly.
 - Restart your computer and your wireless router.
 - Ensure your router's firmware is up to date.
 - Check for interference from other electronic devices or physical obstructions.
- **Slow Speeds:**
 - Ensure your computer is within optimal range of your wireless router.
 - Minimize physical obstructions between the adapter and the router.
 - Check for other devices consuming bandwidth on your network.
 - Update your router's firmware.

6.2 Driver or Software Issues

- **Adapter Not Recognized:**
 - Confirm that your operating system is supported (Windows XP/7/8/8.1/10, Mac OS 10.7~10.13, Linux Kernel 2.6.24~4.9.60).
 - Uninstall any previous wireless adapter drivers before installing the TL-WN823N drivers.
 - Download the latest drivers directly from the TP-Link website.

7. SPECIFICATIONS

Feature	Description
Model	TL-WN823N
Wireless Standards	IEEE 802.11n, IEEE 802.11g, IEEE 802.11b
Data Transfer Rate	Up to 300 Mbps
Frequency Range	2.400 - 2.4835 GHz
Interface	Mini USB 2.0
Operating System Compatibility	Windows (XP/7/8/8.1/10), Mac OS (10.7~10.13), Linux Kernel (2.6.24~4.9.60)
Dimensions (L x W x H)	1.54 x 0.72 x 0.31 inches

Feature	Description
Item Weight	2.12 ounces (0.13 Pounds)
Color	Black
UPC	013342001307

8. WARRANTY INFORMATION

For detailed warranty information regarding your TP-Link TL-WN823N adapter, please refer to the warranty card included in your product packaging or visit the official TP-Link website. Warranty terms and conditions may vary by region and purchase date.

9. SUPPORT

For further assistance, technical support, or to access additional resources, please utilize the following options:

- **Official User Guides:** You can find the official User Guide and Installation Manual in PDF format on the TP-Link support website or via the links provided with your product documentation.
- **TP-Link Website:** Visit the official TP-Link website (www.tp-link.com) for product information, FAQs, driver downloads, and support contact details.
- **Online Support:** TP-Link typically offers online support resources, including live chat and email support, through their official website.