

KRUPS KH732D50

KRUPS KH732D50 2-Slice Stainless Steel Toaster Instruction Manual

Model: KH732D50

INTRODUCTION

This manual provides essential information for the safe and efficient operation of your KRUPS KH732D50 2-Slice Stainless Steel Toaster. Please read all instructions carefully before first use and retain for future reference.

IMPORTANT SAFETY INSTRUCTIONS

When using electrical appliances, basic safety precautions should always be followed, including:

- Read all instructions.
- Do not touch hot surfaces. Use handles or knobs.
- To protect against electrical shock, do not immerse cord, plugs, or toaster in water or other liquid.
- Close supervision is necessary when any appliance is used by or near children.
- Unplug from outlet when not in use and before cleaning. Allow to cool before putting on or taking off parts.
- Do not operate any appliance with a damaged cord or plug or after the appliance malfunctions or has been damaged in any manner.
- The use of accessory attachments not recommended by the appliance manufacturer may cause injuries.
- Do not use outdoors.
- Do not let cord hang over edge of table or counter, or touch hot surfaces.
- Do not place on or near a hot gas or electric burner, or in a heated oven.
- To disconnect, turn any control to "off", then remove plug from wall outlet.
- Do not use appliance for other than intended use.
- Oversize foods, metal foil packages, or utensils must not be inserted in a toaster as they may create a fire or risk of electric shock.
- A fire may occur if toasters are covered or touching flammable material, including curtains, draperies, walls, and the like, when in operation.

- Do not attempt to dislodge food when toaster is plugged in.
- Do not operate unattended.

PRODUCT OVERVIEW

Familiarize yourself with the components of your KRUPS KH732D50 toaster.



Image: Front view of the KRUPS KH732D50 2-Slice Stainless Steel Toaster, showing the two toasting slots, the toast lift lever, and the control panel with Cancel, Defrost, Reheat, and Bagel buttons, along with the browning control dial.

1. Toasting Slots (2)

2. Toast Lift Lever
3. Cancel Button
4. Defrost Button
5. Reheat Button
6. Bagel Button
7. Browning Control Dial (Settings 1-6)
8. Removable Crumb Tray (located at the bottom)

SETUP

1. **Unpacking:** Carefully remove the toaster and all packaging materials. Ensure all components are present and undamaged.
2. **Initial Cleaning:** Wipe the exterior of the toaster with a damp cloth. Do not immerse the toaster in water.
3. **First Use (Burn-off):** Before toasting food for the first time, operate the toaster without bread for a few cycles at the highest browning setting (6) in a well-ventilated area. This will burn off any manufacturing residues and eliminate initial odors. A slight odor or smoke is normal during this process.
4. **Placement:** Place the toaster on a stable, flat, heat-resistant surface, away from flammable materials like curtains. Ensure adequate space around the toaster for ventilation.
5. **Cord Storage:** The toaster features cord storage underneath the unit to keep countertops tidy. Unwind only the necessary length of cord.

OPERATING INSTRUCTIONS

General Toasting

1. **Plug In:** Connect the power cord to a 120V AC electrical outlet.
2. **Place Bread:** Insert up to two slices of bread or other items into the toasting slots. The variable width slots accommodate various bread types.
3. **Select Browning Level:** Turn the Browning Control Dial to your desired setting, from 1 (lightest) to 6 (darkest).



Image: A close-up of the control panel of the KRUPS KH732D50 toaster, highlighting the browning control dial and function buttons.

4. **Start Toasting:** Press the Toast Lift Lever down until it locks into place. The toaster will begin toasting, and the selected function button (if any) will illuminate.





Image: A hand pressing down the toast lift lever on the KRUPS KH732D50 toaster, initiating the toasting cycle.

5. **Retrieve Toast:** Once the toasting cycle is complete, the toast will automatically pop up. For smaller items, use the high-lift feature by manually pushing the lever upwards to safely retrieve them.

Special Functions

Your toaster includes dedicated buttons for specific toasting needs:

- **Cancel:** Press this button at any time to stop the toasting cycle and eject the bread.



Image: A close-up of the KRUPS KH732D50 toaster control panel, showing the Cancel button illuminated with a blue LED light.

- **Defrost:** Use this function for toasting frozen items like waffles, pastries, or frozen bread. It extends the toasting time to first defrost and then toast the item.
- **Reheat:** This function warms previously toasted items without further browning.
- **Bagel:** Designed for bagels, this function toasts the cut side while gently warming the outside. Ensure bagels are placed with the cut side facing inwards towards the center heating elements.

To use a special function, insert the item, select your desired browning level, press the corresponding function button, then press the Toast Lift Lever down.

MAINTENANCE AND CLEANING

Regular cleaning ensures optimal performance and extends the life of your toaster.

1. **Unplug and Cool:** Always unplug the toaster from the power outlet and allow it to cool completely before cleaning.
2. **Crumb Tray:** The toaster is equipped with a removable crumb tray for easy cleaning.



Image: The KRUPS KH732D50 toaster with its removable crumb tray pulled out from the bottom, showing accumulated crumbs.

- Pull out the crumb tray from the front of the toaster.
 - Discard accumulated crumbs.
 - Wipe the tray clean with a damp cloth and dry thoroughly before reinserting.
 - Ensure the crumb tray is fully inserted before operating the toaster.
3. **Exterior Cleaning:** Wipe the exterior stainless steel surfaces with a soft, damp cloth. For stubborn spots, a mild non-abrasive cleaner can be used. Dry thoroughly. Do not use abrasive cleaners or metal scouring pads.
4. **Interior Cleaning:** Do not insert any objects into the toasting slots to clean. If food becomes lodged, unplug the toaster and carefully invert it to shake out the food.

TROUBLESHOOTING

Problem	Possible Cause	Solution
Toaster does not turn on.	Not plugged in; power outage; faulty outlet.	Ensure toaster is securely plugged into a working outlet. Check circuit breaker.
Bread does not toast evenly.	Uneven bread thickness; crumb buildup; inconsistent browning setting.	Ensure bread is centered. Clean crumb tray regularly. Adjust browning setting.
Smoke coming from toaster.	Food lodged in slots; excessive crumbs; burning food.	Immediately press Cancel, unplug, and allow to cool. Remove any lodged food or clean crumb tray.
Toast is too light/dark.	Browning setting too low/high.	Adjust the Browning Control Dial to a higher or lower setting as desired.

Problem	Possible Cause	Solution
Toast lift lever does not stay down.	Toaster not plugged in; internal mechanism issue.	Ensure the toaster is plugged in. If the issue persists, contact customer support.

SPECIFICATIONS

- **Model:** KH732D50
- **Brand:** KRUPS
- **Type:** 2-Slice Toaster
- **Material:** Stainless Steel
- **Color:** Stainless Steel / Silver
- **Wattage:** 800 watts
- **Voltage:** 120 Volts
- **Browning Settings:** 6 levels
- **Special Features:** Cancel, Defrost, Reheat, Bagel functions, High-lift lever, Variable width slots, Removable crumb tray, Cord storage.
- **Product Dimensions:** 9.8"D x 14"W x 9.3"H
- **Item Weight:** Approximately 3.3 Pounds (3.27 lbs)
- **UPC:** 010942213789



Image: Diagram showing the dimensions of the KRUPS KH732D50 toaster: 9.8 inches deep, 14 inches wide, and 9.3 inches high.

WARRANTY AND SUPPORT

Your KRUPS KH732D50 Toaster comes with a 2-year worldwide warranty. For warranty claims, technical support, or service inquiries, please refer to the contact information provided in your product packaging or visit the official KRUPS website.

Please retain your proof of purchase for warranty purposes.



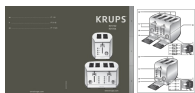

© KRUPS. All rights reserved.

Related Documents - KH732D50

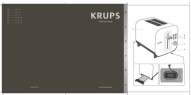

[KRUPS KH732/KH734 Toaster User Manual: Features, Operation, and Safety](#)

Comprehensive user manual for KRUPS KH732 and KH734 toasters. Learn about important safety precautions, product features, how to toast bread, use special functions like defrost and bagel, cleaning, troubleshooting, and warranty information.

	<p>KRUPS Express KH411D50 2-Slice Toaster User Manual and Safety Guide</p> <p>Comprehensive user manual for the KRUPS Express KH411D50 2-Slice Toaster, covering safety instructions, operation, features, cleaning, troubleshooting, and warranty information.</p>
	<p>KRUPS TOASTER KH682 User Manual and Instructions</p> <p>Comprehensive user manual and instructions for the KRUPS TOASTER KH682, covering operation, features, cleaning, troubleshooting, and disposal. Learn how to get the best results from your KRUPS toaster.</p>
	<p>Krups EA9000 Espresso Automatic User Manual</p> <p>Comprehensive user manual for the Krups EA9000 Espresso Automatic coffee machine, covering setup, operation, maintenance, and troubleshooting.</p>
	<p>KRUPS 4-Slice Belgian Waffle Maker User Manual and Recipes</p> <p>Comprehensive user manual for the KRUPS 4-Slice Belgian Waffle Maker, including operating instructions, safety precautions, cleaning guidelines, troubleshooting tips, and a variety of delicious waffle recipes. Learn how to use and maintain your KRUPS waffle maker for perfect waffles every time.</p>
	<p>Krups Sensation Milk EA91 Range Quick Start Guide</p> <p>Concise guide to setting up, using, and maintaining your Krups Sensation Milk EA91 Range automatic coffee machine. Learn how to make coffee and milk-based drinks, clean, and descale the appliance.</p>

Documents - KRUPS – KH732D50

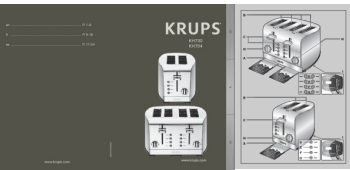

[KRUPS KH732/KH734 Toaster User Manual: Features, Operation, and Safety](#)

Comprehensive user manual for KRUPS KH732 and KH734 toasters. Learn about important safety precautions, product features, how to toast bread, use special functions like defrost and bagel, cleaning, troubleshooting, and warranty information.

lang:i-klinton **score:31** filesize: 2.03 M page_count: 17 document date: 2024-06-19

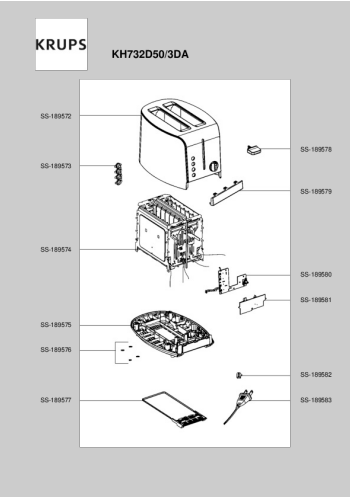

[\[pdf\]](#)

Download the exploded view KRUPS 2 Slice Stainless Steel Toaster KH732D50 explodedview 3DA dam groupeseb m d885ba3b0c53a801 original timestamp 20240726165200 |||

KH732D50/3DA SS-189572 SS-189573 SS-189574 SS-189575 SS-189576 SS-189577 SS-189578 SS-189579 SS-189580 SS-189581 SS-189582 SS-189583 ...

lang:i-klinton **score:27** filesize: 20.94 K page_count: 1 document date: 2024-07-12

