

## Memorex MKS-SS2

# Memorex MKS-SS2 SingStand 2 Home Karaoke System User Manual

Model: MKS-SS2

## INTRODUCTION

The Memorex MKS-SS2 SingStand 2 is an all-in-one home karaoke system designed to provide an immersive singing experience. It features integrated stereo speakers, multiple inputs for audio devices and instruments, and vocal enhancement controls. This manual provides detailed instructions for setting up, operating, and maintaining your SingStand 2.

## WHAT'S IN THE BOX

Please check the package contents to ensure all items are present:

- SingStand 2 Unit
- Microphone
- Microphone Cord
- 11-Inch Line-In Cord
- 7-Inch Line-In Cord
- Cord Management Clip
- User Manual (this document)

## PRODUCT OVERVIEW



Figure 1: Memorex MKS-SS2 SingStand 2 unit, showing the microphone, stand, and base with integrated speakers.



Figure 2: Individuals enjoying the Memorex SingStand 2, demonstrating its use in a social setting.

## Key Features:

- **All-in-one Karaoke System:** Combines microphone, stand, and speaker system for a complete karaoke experience.
- **Universal Line-In:** Connects to any audio device with a headphone jack, including tablets, MP3 players, and smartphones.
- **Instrument Input:** Allows connection of a guitar or keyboard for musical accompaniment.
- **Auto Voice Control (AVC):** Automatically balances vocal levels with music, dampening original song vocals when you sing.
- **Built-in Stereo Speakers:** Two 5-watt speakers integrated into the base deliver clear and powerful audio.
- **Dual Microphone Inputs:** Supports two microphones for duets (one microphone included).
- **Adjustable Echo Effect:** Add a fun echo to your vocals.
- **Device Cradle:** Built-in cradle securely holds your device for easy lyric reading.
- **Cord Management Clip:** Helps keep wires organized and out of the way.

## SETUP GUIDE

---

1. **Unpack Components:** Carefully remove all items from the packaging and verify against the "What's in the Box" list.
2. **Assemble the Stand:**
  - Insert the main pole into the base of the SingStand 2. Ensure it is securely seated.
  - Attach the upper microphone holder and device cradle to the top of the pole.
3. **Connect Power:** Plug the power cord into the DC IN jack on the SingStand 2 base, then plug the other end into a standard electrical outlet.

#### 4. **Connect Microphone(s):**

- Plug the included microphone cord into the MIC 1 input on the SingStand 2 base.
- If using a second microphone (sold separately), plug its cord into the MIC 2 input.

5. **Connect Audio Device:** Use the provided 11-inch or 7-inch line-in cord to connect your audio device (e.g., smartphone, tablet, MP3 player) to the LINE IN jack on the SingStand 2 base. Place your device in the built-in cradle.

6. **Connect Instrument (Optional):** If using an instrument, connect it to the GUITAR/INSTRUMENT input on the SingStand 2 base.

7. **Organize Cords:** Use the included cord management clip to secure and organize any loose cables along the stand.

## OPERATING INSTRUCTIONS

---

### Powering On/Off:

- Press the **POWER** button on the base to turn the unit on or off. The power indicator light will illuminate when on.

### Playing Music:

- Ensure your audio device is connected to the LINE IN jack.
- Start playing music or karaoke tracks on your connected device.
- Adjust the overall music volume using the **MASTER VOLUME** knob on the SingStand 2 base.

### Using the Microphones:

- Adjust the volume for Microphone 1 using the **MIC 1 VOLUME** knob.
- If using a second microphone, adjust its volume with the **MIC 2 VOLUME** knob.
- To add an echo effect to your vocals, turn the **ECHO** knob clockwise to increase the effect.

### Auto Voice Control (AVC):

- The AVC feature automatically lowers the original vocal track of a song when you begin singing into the microphone, allowing your voice to be heard clearly.
- Press the **VOCAL** button to activate or deactivate the AVC function.

### Using the Instrument Input:

- Connect your guitar or keyboard to the GUITAR/INSTRUMENT input.
- Adjust the instrument volume using the **GUITAR VOLUME** knob.

## MAINTENANCE

---

- **Cleaning:** Wipe the unit with a soft, dry cloth. Do not use liquid cleaners or abrasive materials.
- **Storage:** When not in use, store the SingStand 2 in a cool, dry place away from direct sunlight and extreme temperatures.
- **Cable Care:** Avoid sharp bends or kinks in the power and audio cables to prevent damage. Use the cord management clip to keep cables tidy.
- **Microphone Care:** Handle the microphone carefully. Avoid dropping it or exposing it to moisture.

## TROUBLESHOOTING

---

Problem	Possible Cause	Solution
No power	Power cord not connected; Power outlet not active; Unit is off.	Ensure power cord is securely plugged into the unit and a working outlet. Press the POWER button.
No sound from speakers	Master volume too low; Audio device volume too low; Audio cable not connected properly.	Increase MASTER VOLUME. Increase volume on connected audio device. Check LINE IN cable connection.
Microphone not working	Microphone volume too low; Microphone not plugged in; Faulty microphone/cord.	Increase MIC 1/MIC 2 VOLUME. Ensure microphone cord is fully inserted. Test with another microphone if available.
Distorted sound	Volume levels too high (clipping); Faulty audio source.	Reduce MASTER VOLUME, MIC VOLUME, or audio device volume. Test with a different audio source.
AVC not working	AVC feature is deactivated.	Press the VOCAL button to activate AVC.

## SPECIFICATIONS

Feature	Detail
Model Number	MKS-SS2
Dimensions (Extended)	59 inches (Height) x 12 inches (Base Diameter)
Weight	9.3 pounds
Speaker Output	2 x 5-watt stereo speakers
Connectivity	3.5 mm Line-In, 2 x Microphone Inputs, 1 x Instrument Input
Power Source	AC Powered (2.3E+2 Volts AC)
Color	Silver/Black

## WARRANTY INFORMATION

The Memorex MKS-SS2 SingStand 2 is backed by a **90-day limited warranty** from the date of purchase. This warranty covers defects in materials and workmanship under normal use. For warranty service or support, please contact Memorex customer service. Keep your proof of purchase for warranty claims.

*Note: This warranty does not cover damage caused by misuse, accident, unauthorized modification, or normal wear and tear.*

## CUSTOMER SUPPORT

For further assistance, technical support, or inquiries regarding your Memorex MKS-SS2 SingStand 2, please refer to the official Memorex website or contact their customer service department. Contact information can typically be found on the product packaging or the official brand website.



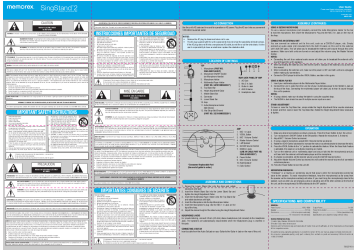

[Memorex SingStand 2 MKS-SS2 User Guide: Setup, Operation, and Specifications](#)

Comprehensive user guide for the Memorex SingStand 2 (MKS-SS2) karaoke system. Learn how to assemble, connect, operate, and troubleshoot your device. Includes safety instructions, component descriptions, and technical specifications.  
lang:en score:27 filesize: 626.87 K page\_count: 2 document date: 2015-01-15

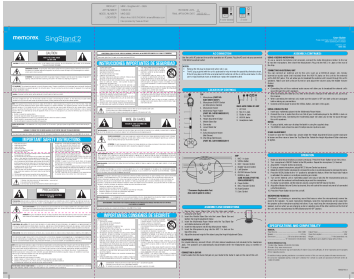

[\[pdf\] User Manual Quick Start Guide Instructions Guide](#)

SingStand 2 User Guide unless the modifications are expressly approved in instruction manual The user could lose authority to operate this equipment if an unauthorized change or modification is made  
CAUTION TO PREVENT ELECTRIC SHOCK MATCH WIDE BLADE OF PLUG SLOT AND FULLY  
INSERT This device complies with part 15 of FCC Rules 91ay9n rFLS ecx images amazon I  
PRODUCT ART NUMBER MODEL NUMBER LOCATION MRX SingStand 2 QSG  
73952745 **MKS-SS2** Allison Arne / 651.704.3404 / amarne imation.com Files  
provided by Treasure Chest REVISION LEVEL A FINAL ARTWORK DATE 05.02.12  
Spot color Black Pr ocess 1 color black Spot color PMS 2995C Pr ocess 2 color Si...  
lang:en score:14 filesize: 896.03 K page\_count: 2 document date: 2015-01-15