

Genie 36163R.S

Genie 36163R.S IntelliCode Garage Door Opener Receiver Instruction Manual

1. INTRODUCTION

This manual provides comprehensive instructions for the installation, operation, and maintenance of your Genie 36163R.S IntelliCode Garage Door Opener Receiver. This receiver is designed to enhance the compatibility of your garage door opener system with Genie IntelliCode remotes, operating on both 315MHz and 390MHz frequencies.

Please read all instructions carefully before beginning installation or operation to ensure proper function and safety.

2. PACKAGE CONTENTS

The Genie 36163R.S IntelliCode Receiver package includes:

- One (1) Genie 36163R.S IntelliCode Receiver unit.

Note: This package contains the receiver unit only. Transmitters (remotes), wiring, and power packs are not included and must be acquired separately if needed. This receiver is commonly used as a component in the GIRUD-1T Receiver Kit.

3. SAFETY INFORMATION

Always observe the following safety precautions:

- Disconnect power to the garage door opener before installing or servicing the receiver.
- Ensure all wiring connections are secure and comply with local electrical codes.
- Keep hands and clothing clear of the garage door and its moving parts during operation.
- Do not allow children to operate the garage door opener or play with remote controls.
- Test the safety reversal system of your garage door opener after installation.

4. SETUP AND INSTALLATION

The Genie 36163R.S receiver is designed for straightforward installation. Follow these steps:

4.1. Identify Components



Figure 1: Top view of the Genie 36163R.S IntelliCode Receiver. This image shows the overall compact design of the receiver unit.



Figure 2: Bottom view of the Genie 36163R.S IntelliCode Receiver. The label displays the receiver model (315390R2) and FCC compliance information.



Figure 3: Side view of the Genie 36163R.S IntelliCode Receiver. This image highlights the POWER, COMMON, and WALLBUTTON TERMINAL connections, along with the LEARN CODE INDICATOR LED and LEARN CODE BUTTON.

4.2. Wiring the Receiver

1. **Disconnect Power:** Before making any connections, ensure the power to your garage door opener is disconnected at the circuit breaker.
2. **Locate Terminals:** On your garage door opener power head, locate the terminals for the wall control button. These are typically labeled "COMMON" and "WALL BUTTON" or similar.
3. **Connect Receiver Wires:**
 - Connect a wire from the receiver's "COMMON" terminal to the "COMMON" terminal on your garage door opener.
 - Connect a wire from the receiver's "WALLBUTTON TERMINAL" to the "WALL BUTTON" terminal on your garage door opener.
 - Connect the receiver's "POWER" terminal to a 24-volt power source. This may be available from your garage door opener's accessory terminals or require a separate 24V power pack (not included).
4. **Secure Connections:** Ensure all wire connections are tight and secure.

4.3. Mounting the Receiver

Mount the receiver in a location that is protected from moisture and physical damage, preferably near the garage door opener. Ensure the antenna wire hangs freely and is not coiled or obstructed for optimal signal reception.

5. OPERATING INSTRUCTIONS: PROGRAMMING REMOTES

This receiver is compatible with Genie IntelliCode remotes. To program a remote to the receiver:

1. **Restore Power:** Reconnect power to your garage door opener. The LEARN CODE INDICATOR LED on the receiver should illuminate or flash.
2. **Press Learn Button:** Press and release the "LEARN CODE BUTTON" on the receiver (refer to Figure 3). The LEARN CODE INDICATOR LED will begin to flash slowly.
3. **Activate Remote:** Within 30 seconds, press and release the button on your IntelliCode remote control that you wish to program.
4. **Confirmation:** The LEARN CODE INDICATOR LED on the receiver will stop flashing and remain lit for a moment, then turn off, indicating successful programming.
5. **Test Remote:** Press the programmed button on your remote control to test the garage door opener's operation.
6. **Program Additional Remotes:** Repeat steps 2-5 for any additional IntelliCode remotes you wish to program.

Note: If the remote does not operate the garage door, ensure the remote has fresh batteries and repeat the programming steps.

6. TROUBLESHOOTING

- **Receiver not responding:**
 - Check power connections to the receiver. Ensure 24V power is supplied.
 - Verify wiring to the garage door opener's wall button terminals is correct and secure.
 - Ensure the garage door opener itself has power.
- **Remote not operating door after programming:**
 - Confirm the remote is a Genie IntelliCode remote.
 - Check the remote's battery. Replace if necessary.
 - Repeat the programming steps carefully.
 - Ensure the remote is within range of the receiver.
- **Reduced remote range:**
 - Ensure the receiver's antenna wire is fully extended and not obstructed or coiled.
 - Check for sources of radio interference (e.g., other electronic devices, metal objects).
 - Consider relocating the receiver for better line-of-sight to where remotes are typically used.

7. SPECIFICATIONS

Model:	Genie 36163R.S
Operating Frequencies:	315MHz and 390MHz

Compatibility:	Genie IntelliCode Remotes
Power Requirement:	24 Volts (DC, typically)
Batteries:	Not required for receiver operation
Manufacturer:	Genie

8. MAINTENANCE

The Genie 36163R.S IntelliCode Receiver requires minimal maintenance. Periodically:

- Inspect wiring for any signs of wear or damage.
- Ensure the receiver is free from dust and debris.
- Verify the antenna is unobstructed.



No user-serviceable parts are inside the receiver unit. Do not attempt to open or repair the unit yourself.

9. WARRANTY AND SUPPORT

For warranty information or technical support, please refer to the official Genie website or contact Genie customer service. Keep your purchase receipt for warranty claims.

Genie Customer Service: Refer to product packaging or the official Genie website for current contact information.

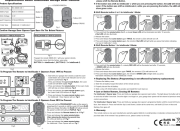
Related Documents - 36163R.S

	<p>GenieMaster Transmitter Operation and Programming Guide</p> <p>This guide provides instructions for operating and programming the GenieMaster transmitter, compatible with Intellicode 1, Intellicode 2, and code switch garage door openers. It includes safety warnings, programming steps, and battery replacement information.</p>
	<p>Replacement Genie Intellicode Garage Door Remote - RC-SM26-GN-1 User Guide</p> <p>This guide provides specifications and programming instructions for the Replacement Genie Intellicode Garage Door Remote, model RC-SM26-GN-1. Learn how to program the remote for Intellicode 1 and Intellicode 2 openers, replace the battery, and erase existing remotes.</p>
	<p>Genie Wireless Keypad Intellicode Programming and Operation Instructions</p> <p>Comprehensive guide for Genie Intellicode wireless keypads, covering programming, operation, mounting, battery replacement, and troubleshooting. Includes safety warnings and regulatory information.</p>



[Genie GK-R Wireless Keypad Instructions](#)

This document provides instructions for programming and operating the Genie GK-R Wireless Keypad for garage door openers. It covers PIN setup, programming for single and multiple doors, keypad operation, mounting, battery replacement, and resetting the keypad to factory defaults.

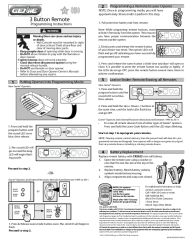

[Genie 3-Button Remote Programming Instructions](#)

Step-by-step guide for programming Genie 3-button remotes for garage door openers, including instructions for new openers and models manufactured between 1995-2011. Covers programming, erasing remotes, and battery replacement.



[Genie 4560 DC Powered Screw Drive Opener: Operation and Maintenance Manual](#)

Comprehensive guide for the Genie 4560 DC Powered Screw Drive Opener, covering installation, safety features, operation, maintenance, troubleshooting, and parts. Learn how to safely install and maintain your Genie garage door opener.