

## Sicce Shark ADV 800

# SICCE Shark ADV 800 Internal Filter User Manual

Model: Shark ADV 800 | Brand: Sicce

## INTRODUCTION

This manual provides detailed instructions for the installation, operation, and maintenance of the SICCE Shark ADV 800 Internal Filter. Designed for both freshwater and saltwater aquariums, this internal filter is intended for submerged use only. Please read these instructions carefully before use to ensure proper function and longevity of your filter.



Image: The SICCE Shark ADV 800 Internal Filter, a compact and modular unit designed for submerged aquarium filtration.

## SAFETY INFORMATION

---

- Always disconnect the power supply before performing any maintenance or handling the filter.

- Ensure the filter is fully submerged during operation.
- Do not operate the filter if the power cord or plug is damaged.
- This appliance is for indoor use only and must not be used for purposes other than those specified.
- Keep out of reach of children.

## PACKAGE CONTENTS

---

Verify that all components are present before proceeding with installation:

- SICCE Shark ADV 800 Internal Filter unit
- Filter media (sponge)
- Venturi air intake system components
- Suction cups for mounting
- Instruction Manual (this document)



Image: The Shark ADV 800 filter shown with its packaging and various components, including filter media and air intake parts.

## SETUP

1. **Preparation:** Unpack all components. Rinse the filter unit and all media thoroughly with aquarium water or dechlorinated tap water before initial use. Do not use soap or detergents.
2. **Assembly:**
  - Attach the suction cups to the filter body for secure mounting.
  - Insert the provided filter media into the filter compartments. The Shark ADV features a modular design, allowing for additional filtering compartments (sold separately) to be added.
  - If using the Venturi system for additional oxygenation, connect the air intake tube and adjust the air flow regulator as desired.

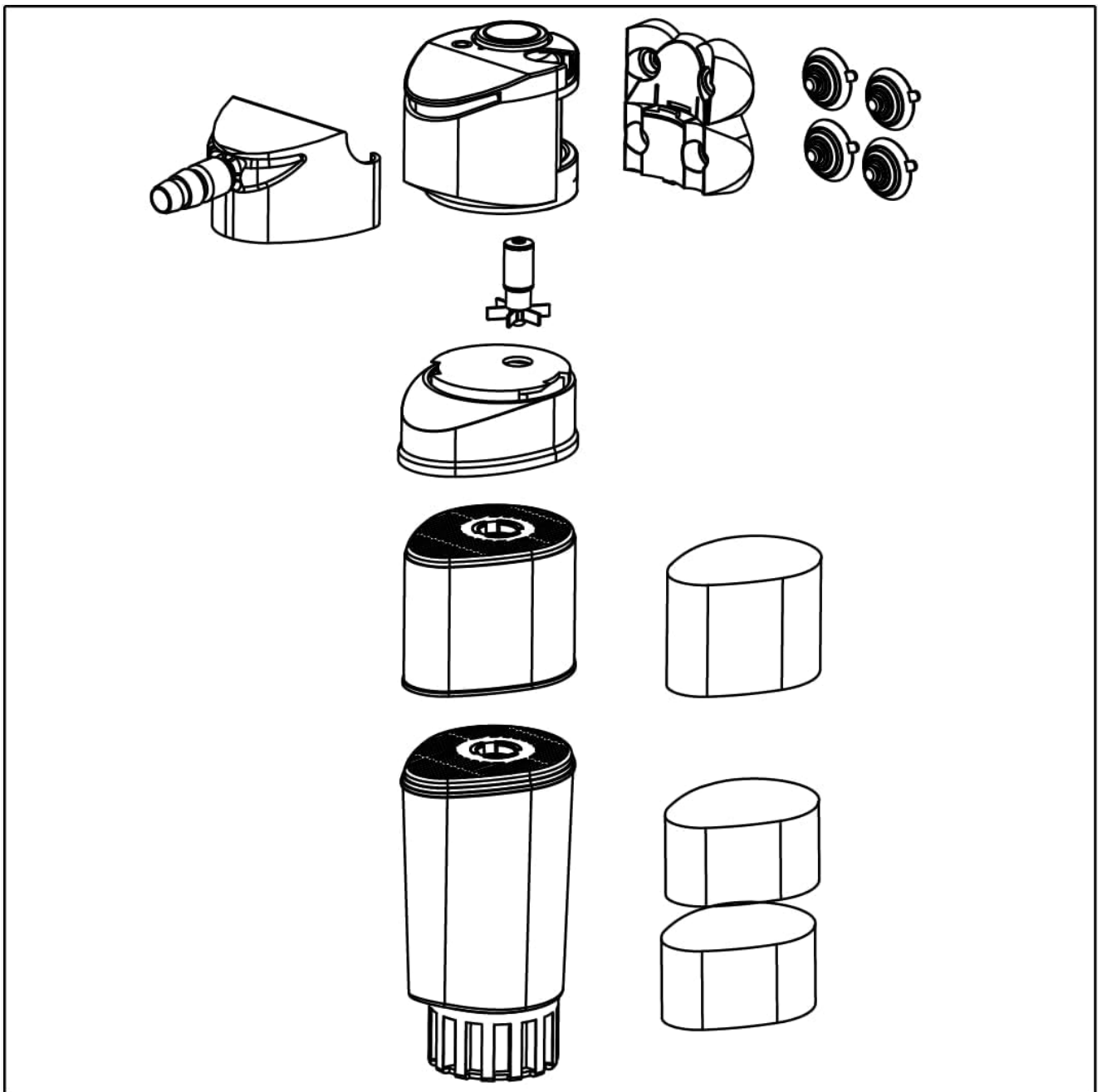

Image: An exploded diagram illustrating the individual components of the Shark ADV filter, including the motor head, impeller, filter cartridges, and suction cups.

3. **Placement:** Position the filter inside the aquarium, ensuring it is fully submerged. Secure it to the aquarium wall using the suction cups. Ensure the water outlet is positioned to create adequate water circulation.
4. **Initial Startup:** Once securely placed and fully submerged, connect the power plug to an electrical outlet. The filter will begin operating.

## OPERATING INSTRUCTIONS

- **Power On/Off:** The filter operates continuously when plugged into a power source. To turn off, disconnect from the power outlet.
- **Flow Adjustment:** The water flow rate can be adjusted using the dial located on the top of the filter unit. Rotate the dial to increase or decrease flow as needed for your aquarium size and inhabitants.
- **Venturi System:** The integrated Venturi system allows for additional oxygenation of the aquarium water. Adjust the air intake regulator to control the amount of air introduced. Note that operating the Venturi system may produce some noise.
- **Fish Protection:** The intake diameter is adjustable to protect smaller fish from being drawn into the filter. Ensure it is

set appropriately for your aquarium's inhabitants.

## MAINTENANCE

---

Regular maintenance is crucial for the optimal performance and longevity of your SICCE Shark ADV 800 filter.

### 1. Disassembly for Cleaning:

- Disconnect the filter from the power supply.
- The Shark ADV features a patented Magnetic Quick Uncoupling System (MCS System). This allows you to detach the filter body and media compartments from the motor head without removing the entire unit from the aquarium. Simply pull the filter body downwards to separate it from the magnetic connection.



Image: A hand demonstrating the magnetic quick uncoupling system, separating the filter's lower section from its upper motor unit for easy maintenance.

- The transparent mechanical filter body allows for easy visual inspection of clogging levels.
- Cleaning Filter Media:** Remove the filter media (sponge) from the compartments. Rinse the sponge thoroughly in old aquarium water (from a water change) to preserve beneficial bacteria. Replace the sponge if it is heavily degraded or cannot be cleaned effectively.
  - Cleaning Impeller and Motor Head:** Periodically clean the impeller and its housing in the motor head to prevent blockages and maintain efficient operation. Gently remove the impeller and clean any debris.
  - Reassembly:** Reassemble the filter components, ensuring all parts are correctly seated. Reattach the filter body to the motor head using the MCS System.
  - Restart:** Place the filter back into the aquarium, ensure it is fully submerged, and reconnect the power supply.

## TROUBLESHOOTING

Problem	Possible Cause	Solution
Filter not starting or weak flow	Not plugged in Impeller blocked or damaged Filter media clogged Air in the system	Check power connection. Disconnect power, clean impeller and housing. Clean or replace filter media. Ensure filter is fully submerged and gently shake to release trapped air.
Excessive noise	Impeller not seated correctly or damaged Debris in impeller housing Venturi system operating (normal for some noise) Filter not securely mounted	Disconnect power, check and reseal/replace impeller. Clean impeller housing. Adjust Venturi air intake or turn off if not needed. Ensure suction cups are firmly attached to the aquarium wall.
Water not clear	Filter media clogged or insufficient Incorrect filter size for tank	Clean or replace filter media. Consider adding additional filter compartments. Ensure the filter's capacity matches your aquarium volume.

## SPECIFICATIONS

Feature	Detail
Model	Shark ADV 800
Part Number	SIC113
Flow Rate	211 GPH (800 L/h)
Filtering Volume	320 cm³
Product Dimensions	5 x 10 x 15 inches (approximate)
Item Weight	13.9 ounces
Application	Freshwater and Saltwater
Usage	Indoor, Submerged
Special Features	Patented Magnetic Quick Uncoupling System (MCS), Venturi System, Adjustable Intake Diameter, Modular Design

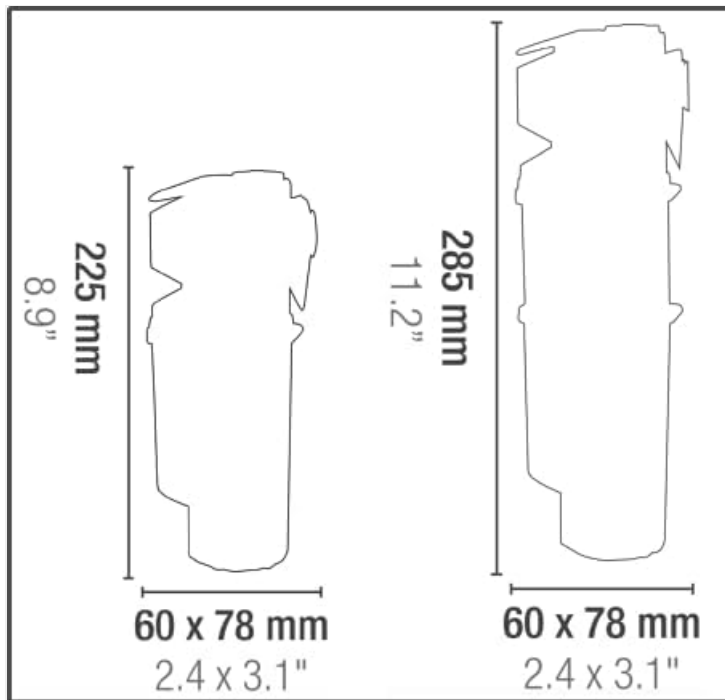

Image: A technical drawing showing the dimensions of different Shark ADV filter models, indicating height and base measurements.

## WARRANTY AND SUPPORT

The SICCE Shark ADV 800 Internal Filter comes with a Manufacturer Warranty. For specific warranty details, duration, and terms, please refer to the documentation included with your product or visit the official Sicce website.

For technical support, replacement parts, or warranty claims, please contact Sicce customer service through their official channels.

**Manufacturer:** Sicce

**Website:** [www.sicce.com](http://www.sicce.com)



© 2024 Sicce. All rights reserved. Information subject to change without notice.

## Related Documents - Shark ADV 800



### [Shark ADV Internal Aquarium Filter - User Manual and Safety Instructions](#)

Comprehensive guide for the Shark ADV internal aquarium filter, covering installation, operation, maintenance, safety precautions, and warranty information. Includes multilingual instructions.



 <p>INSTRUCTION MANUAL Shark PRO EN - IT - DE - FR - ES - NL - PT - RU - CZ - CN - KR</p>	<p><a href="#">SICCE SHARK PRO Internal Filter Instruction Manual</a></p> <p>Instruction manual for the SICCE SHARK PRO internal aquarium filter, covering safety, technical specifications, assembly, maintenance, and warranty information.</p>
 <p>INSTRUCTION MANUAL Shark PRO EN - IT - DE - FR - ES - NL - PT - RU - CZ - CN - KR</p>	<p><a href="#">SICCE Shark PRO Internal Filter Instruction Manual</a></p> <p>This manual provides instructions and technical specifications for the SICCE Shark PRO internal filter, a high-performance aquarium filter designed for water applications. It includes safety guidelines, component details, and spare parts information.</p>
 <p>INSTRUCTION MANUAL SHARK PRO NANO EN - IT - DE - FR - ES - NL - PT</p>	<p><a href="#">SICCE SHARK PRO NANO Internal Filter: Instruction Manual &amp; Guide</a></p> <p>Comprehensive instruction manual for the SICCE SHARK PRO NANO internal aquarium filter. Learn about installation, maintenance, safety, technical specifications, and warranty.</p>
 <p>INSTRUCTION MANUAL Shark PRO EN - IT - DE - FR - ES - NL - PT - RU - CZ - CN - KR</p>	<p><a href="#">SICCE SHARK PRO Internal Filter: Instruction Manual &amp; Features</a></p> <p>Comprehensive guide to the SICCE SHARK PRO internal aquarium filter, covering features, installation, maintenance, safety, and technical specifications for optimal aquarium water quality.</p>
 <p>INSTRUCTION MANUAL Shark PRO NANO EN - IT - DE - FR - ES - NL - PT</p>	<p><a href="#">Sicce Shark Pro Nano Internal Filter Instruction Manual</a></p> <p>This document provides detailed instructions for the Sicce Shark Pro Nano internal filter, covering technical specifications, safety precautions, installation, maintenance, and warranty information.</p>



[\[pdf\]](#)

Aquarium 2016 RU us sicce pub media wysiwyg |||

MADE IN ITALY 2016 English / : - , , , , , , ... - 180 Scuba 100 / 150 26 - 47 US gal

Flora Life 1 Zerophos Zeronitra Bioker Akuapure Shark ADV 800 Tank capacity /

Nautilus 130 - 200 Scuba 150 / 200 34.5 - 52 US gal Flora L...

lang:fr **score:25** filesize: 24.55 M page\_count: 67 document date: 2016-04-28



[\[pdf\]](#) Catalog

UTSD207 A EN DE catalogo2018 ISSUU us sicce pub media wysiwyg |||

EN CATALOGUE DE KATALOG COMPANY PROFILE Our history begins in 1974

when Mr. Paolo Pettenon found ... optional water flow. Strmungsfrderer fr einen

gerichteten Wasserablauf. 285 mm 11.2 225 mm 8.9 Shark ADV 800 120 x 73 x h 300

mm 4.7 x 2.97 x h 11.8 60 x 78 mm 2.4 x 3.1 60 x 78 mm 2.4 x 3.1 ...

lang:en **score:21** filesize: 22.86 M page\_count: 132 document date: 2018-09-18

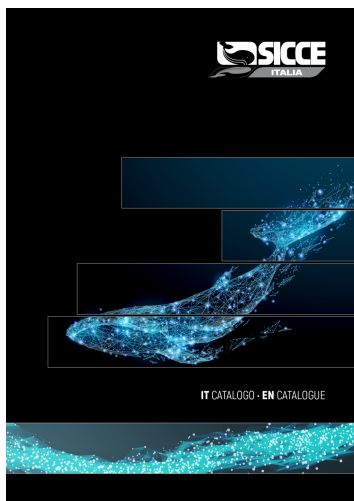

[\[pdf\]](#) Catalog

INDICE SICCE2019 catalogo IT EN 18 19 sicce media wysiwyg sezione cataloghi |||

IT CATALOGO EN CATALOGUE COMPANY PROFILE La nostra storia ha origine

nel 1974 quando il Sig. Paol ... O MIX FOAMS FOCUS ON REFILL CARTRIDGE

Shark ADV 400 600 120 x 73 x h 240 mm 4.7 x 2.9 x h 9.4 Shark ADV 800 120 x 73 x

h 300 mm 4.7 x 2.97 x h 11.8 Convogliatore di flusso per una uscita dell ...

lang:it **score:21** filesize: 45.58 M page\_count: 101 document date: 2019-09-10



[\[pdf\]](#) Catalog

FR CATALOGUE · ES CATÁLOGO UTSD207 A catalogo2018 ISSUU 1 us sicce media wysiwyg |||

FR CATALOGUE ES CATLOGO COMPANY PROFILE Notre histoire a dbut en 1974 quand M. Paolo Pettenon a ... d coulement pour une sortie d eau dirige. Transportador de flujo para una salida de agua dirigida. Shark ADV 800 120 x 73 x h 300 mm 4.7 x 2.97 x h 11.8 285 mm 11.2 225 mm 8.9 60 x 78 mm 2.4 x 3...

lang:fr **score:20** filesize: 22.87 M page\_count: 132 document date: 2018-09-18