



[Manuals.plus](#) /

> [CubicFun](#) /

> CubicFun World's Great Architectures MC101H Dubai Burj Al Arab 3D Puzzle Instruction Manual

CubicFun MC101H

CubicFun World's Great Architectures MC101H Dubai Burj Al Arab 3D Puzzle Instruction Manual

Model: MC101H | Brand: CubicFun

INTRODUCTION

This manual provides detailed instructions for assembling your CubicFun World's Great Architectures MC101H Dubai Burj Al Arab 3D Puzzle. Follow these guidelines carefully to ensure a successful and enjoyable building experience. This puzzle is designed to recreate the iconic Burj Al Arab hotel in Dubai using interlocking pieces.



Image: The CubicFun MC101H Dubai Burj Al Arab 3D Puzzle packaging and the fully assembled model, showcasing its intricate design and scale.

SAFETY INFORMATION

WARNING: Choking Hazard - Small Parts. Not For Children Under 3 Years.

Always supervise young children during assembly. Keep all small pieces away from infants and pets to prevent accidental ingestion. Dispose of packaging materials responsibly.

PACKAGE CONTENTS

Before beginning assembly, please verify that all components are present:

- Pre-cut EPS foam board puzzle sheets (101 pieces)
- Instruction booklet with diagrams

If any pieces are missing or damaged, please contact CubicFun customer support.

ASSEMBLY INSTRUCTIONS

No tools or glue are required for the assembly of this 3D puzzle. The pieces are designed to interlock securely. Follow the numbered steps and diagrams provided.

CubicFun®

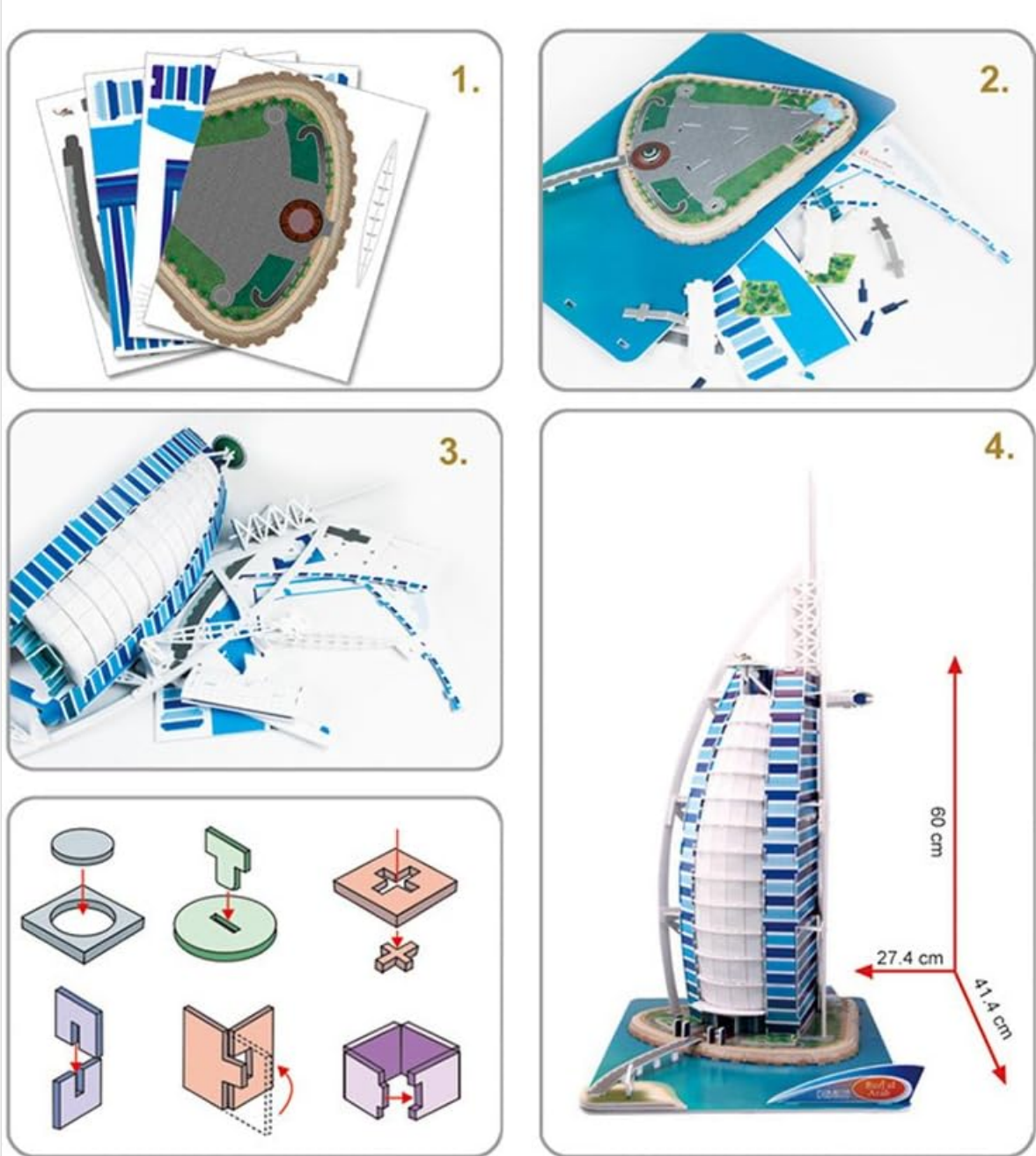

Image: A visual guide illustrating the four main stages of assembly for the CubicFun MC101H puzzle, along with diagrams of various interlocking piece types.

Step-by-Step Guide:

- 1. Preparation:** Carefully detach all puzzle pieces from the foam sheets. Organize them by number or shape as indicated in the instruction booklet.
- 2. Base Assembly:** Begin by assembling the base structure of the model. This typically involves interlocking the larger, flat pieces that form the foundation and surrounding water area. Refer to diagram 1 and 2 in the provided image.

3. **Building Structure:** Proceed with constructing the main body of the Burj Al Arab. Identify corresponding numbered slots and tabs. Gently push pieces together until they interlock securely. Work systematically from the lower sections upwards. Refer to diagram 3 in the provided image.
4. **Detailing and Finishing:** Attach smaller detail pieces such as the helipad, antenna, and any decorative elements. Ensure all connections are firm. The completed model should stand stably. Refer to diagram 4 in the provided image for the final structure.



Image: A detailed view of the helipad and the upper sections of the assembled Burj Al Arab 3D puzzle, highlighting the intricate design elements.

MAINTENANCE

To maintain the appearance of your assembled 3D puzzle:

- **Cleaning:** Dust the model gently with a soft, dry cloth or a soft brush. Avoid using water or cleaning solutions, as they may damage the paper and EPS foam material.
- **Storage:** Display the model in a stable location away from direct sunlight, high humidity, or extreme temperatures to prevent warping or fading.

TROUBLESHOOTING

- **Pieces not fitting:** Ensure you are using the correct pieces for the designated slots. Do not force pieces; they should interlock smoothly. Check the piece numbers and diagrams.
- **Model unstable:** Re-check all connections to ensure pieces are fully interlocked. Ensure the base is correctly assembled and placed on a flat surface.
- **Missing pieces:** If you discover a missing piece, please contact CubicFun customer support with your model number and a description of the missing part.

SPECIFICATIONS

Model Number	MC101H
Brand	CubicFun
Number of Pieces	101
Assembled Dimensions (L x W x H)	16.3" x 10.7" x 23.6" (41.4 x 27.4 x 60 cm)
Material	Paper and EPS Foam Board
Recommended Age	5 years and up
Item Weight	1 pound

SUPPORT AND CONTACT

For further assistance, inquiries about missing parts, or general support, please visit the official CubicFun website or contact their customer service department. Refer to the product packaging for specific contact details or warranty information.

You can also visit the [CubicFun Store on Amazon](#) for more information.