

KITCHEN CROP VKP1024

Kitchen Crop Deluxe Grain Mill (Model VKP1024) Instruction Manual

Your guide to operating and maintaining your grain mill.

1. INTRODUCTION

The Kitchen Crop Deluxe Grain Mill (Model VKP1024) is designed for grinding a variety of dry, non-oily grains into flour. Its robust construction and adjustable settings allow for precise control over the coarseness of your grind, from cracked grains to fine, bread-quality flour. This manual provides essential information for the safe and effective use of your grain mill.

This mill is equipped with durable stainless steel grinding burrs, making it suitable for wheat, rice, oats, barley, rye, peppercorns, non-oily seeds, and spices. It offers versatility for various culinary applications, ensuring maximum nutrient retention and freshness in your homemade products.

2. IMPORTANT SAFETY INFORMATION

- **Read all instructions** before operating the grain mill.
- Ensure the mill is securely clamped to a **strong, steady surface** before use to prevent movement and potential injury.
- Keep hands and foreign objects **out of the milling chamber** during operation.
- This appliance is not intended for use by children. Keep out of reach of children.
- Do not operate the mill without the plastic hopper installed.
- Only grind **dry, non-oily grains**. Grinding oily or wet ingredients can damage the burrs and mechanism.
- Always inspect the mill for any damage before each use. Do not operate if damaged.

3. SETUP INSTRUCTIONS

3.1 Unpacking and Component Identification

Carefully remove all components from the packaging. Verify that all parts are present:

- Grain Mill Body (Cast Aluminum)

- Hand Crank Assembly
- Stainless Steel Grinding Burrs (Pre-installed)
- Hopper (Clear Plastic)
- Mounting Clamp
- Adjustment Knob

3.2 Assembling the Grain Mill

1. **Attach the Hand Crank:** Insert the hand crank into the designated opening on the side of the mill body and secure it with the provided screw or pin.
2. **Install the Hopper:** Place the clear plastic hopper onto the top opening of the mill body. Ensure it sits firmly in place.
3. **Secure to a Surface:** Use the robust mounting clamp to securely attach the grain mill to a countertop or table. The clamp can accommodate surfaces up to 2 inches (51 mm) thick. Tighten the clamp firmly to prevent any movement during operation.

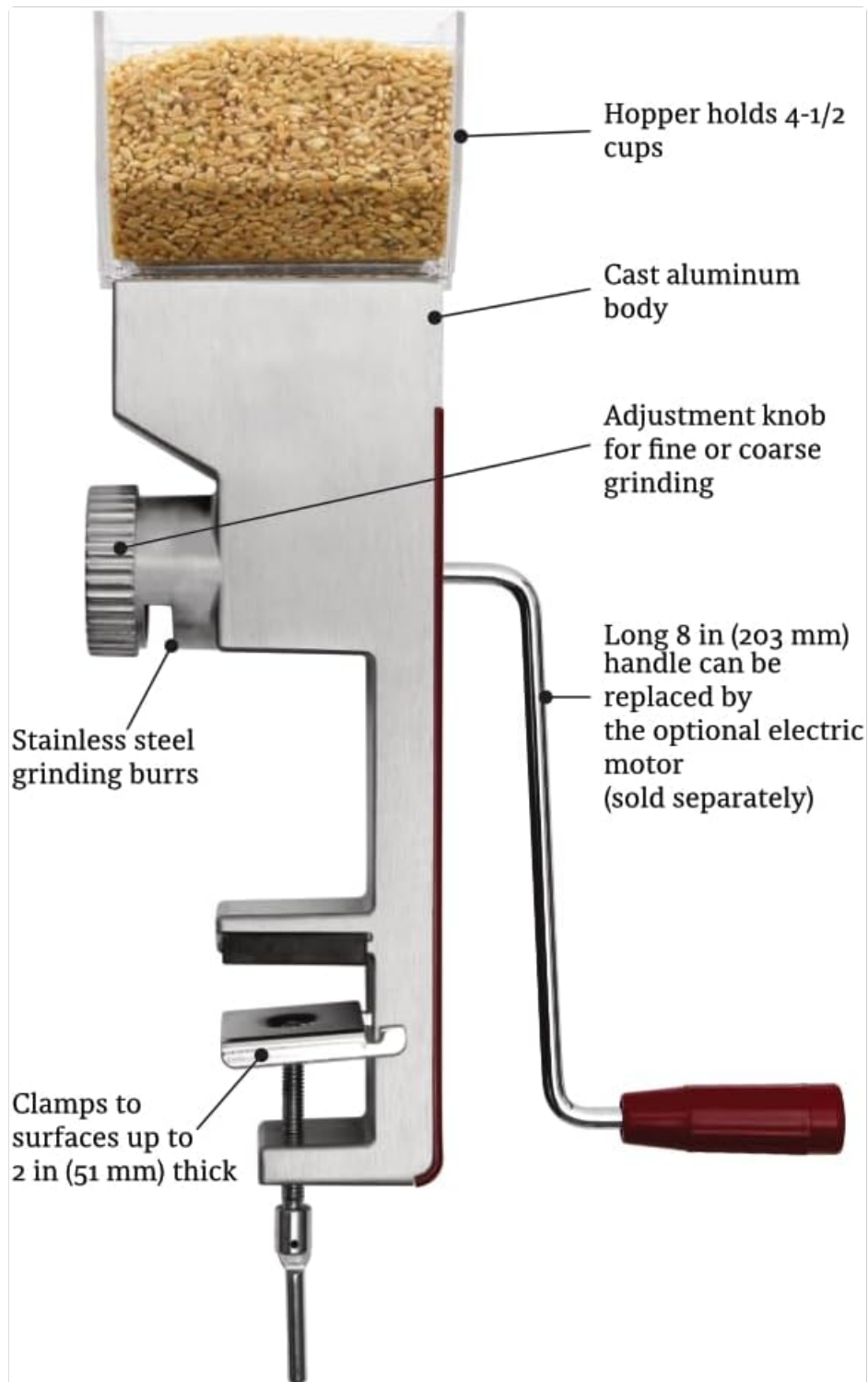

Figure 1: Key components of the Kitchen Crop Deluxe Grain Mill. This image shows the hopper, cast aluminum body, adjustment knob for fine or coarse grinding, stainless steel grinding burrs, long 8-inch (203 mm) handle (which can be replaced by an optional electric motor, sold separately), and clamps for surfaces up to 2 inches (51 mm) thick.

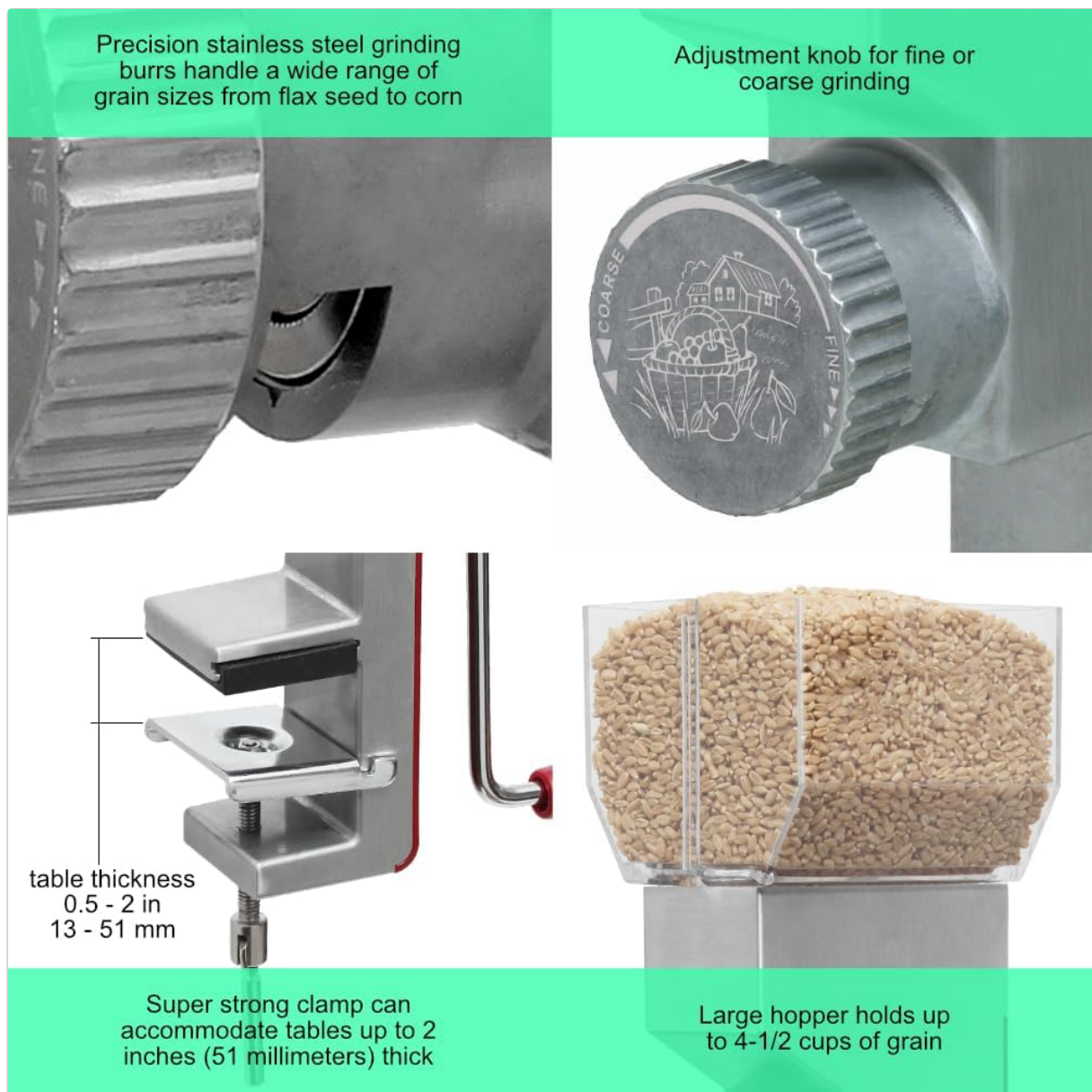

Figure 2: Detailed view of the adjustment knob for grind coarseness, the super strong clamp accommodating table thicknesses from 0.5 to 2 inches (13-51 mm), and the large hopper holding up to 4-1/2 cups of grain.

4. OPERATING INSTRUCTIONS

4.1 Adjusting Grind Coarseness

The mill features a convenient dial for adjusting the grind coarseness. Turn the adjustment knob to select your desired fineness, from coarse cracked grains to fine, bread-quality flour. It is recommended to start with a coarser setting and gradually adjust to a finer setting if needed, especially for harder grains.

4.2 Grinding Grains

1. Ensure the mill is securely mounted and the hopper is empty.
2. Place a bowl or container beneath the mill's output chute to collect the ground flour.
3. Pour your desired dry, non-oily grains into the hopper. The hopper holds up to 4-1/2 cups of grain.
4. Begin turning the hand crank in a steady, clockwise motion. The grains will feed into the grinding burrs and emerge as flour.
5. For very fine flour, it may be beneficial to pass the grains through the mill once on a coarser setting, then collect the coarsely ground material and pass it through a second time on a finer setting.



Figure 3: The Kitchen Crop Deluxe Grain Mill actively grinding grains, demonstrating the output of freshly milled flour into a collection bowl.

*Superior milling design grinds
a wide range of grain sizes
from flax seed to corn using
precision stainless steel burrs*



FLAX SEED



COFFEE



RICE



BEANS



WHEAT



CORN
(Popcorn NOT
Recommended)



Figure 4: This image illustrates the superior milling design capable of grinding a wide range of grain sizes using precision stainless steel burrs. Examples include flax seed, coffee, rice, beans, wheat, and corn (Popcorn NOT Recommended).

4.3 Official Product Video: Operation Overview

Video 1: This video from Palmer Wholesale demonstrates the operation of the VKP Brands Deluxe Grain Mill with Hand Crank, showcasing the grinding process and ease of use.

5. MAINTENANCE

5.1 Cleaning

Regular cleaning ensures optimal performance and longevity of your grain mill.

1. **Disassembly:** Carefully disassemble the mill by removing the hand crank, hopper, and loosening the adjustment knob to access the grinding burrs.
2. **Brush Cleaning:** Use a dry brush to remove any residual flour or grain particles from the burrs and internal components.
3. **Wipe Down:** Wipe all parts with a dry or slightly damp cloth. Do not immerse the main body in water.
4. **Drying:** Ensure all parts are completely dry before reassembling to prevent rust or mold.

5.2 Lubrication

Periodically apply a small amount of food-grade mineral oil to the moving metal parts, such as the shaft and adjustment screw, to ensure smooth operation and prevent corrosion.

6. TROUBLESHOOTING

Problem	Possible Cause	Solution
Inconsistent grind / Coarse flour when fine setting selected	Burrs not properly adjusted or worn.	Adjust the coarseness knob to a finer setting. If burrs are worn, consider replacement.
Mill is difficult to turn	Too much grain in hopper, burrs set too fine, or oily/wet grains.	Reduce grain quantity, adjust to a coarser setting, or ensure grains are dry and non-oily. Check for blockages.
Mill wobbles during operation	Not securely clamped to surface.	Ensure the mounting clamp is tightened firmly to a stable, sturdy countertop or table.
No flour output	Hopper empty, blockage, or burrs not engaged.	Refill hopper, check for and clear any blockages, ensure burrs are correctly assembled and adjusted.

7. SPECIFICATIONS

- **Brand:** KITCHEN CROP
- **Model Number:** VKP1024
- **Material:** Stainless Steel (Burrs), Cast Aluminum (Body)
- **Color:** Black or Silver
- **Item Weight:** 3.3 Pounds
- **Product Dimensions:** 11"L x 3"W x 16"H
- **Recommended Uses:** Grinding dry, non-oily grains
- **UPC:** 811957011205

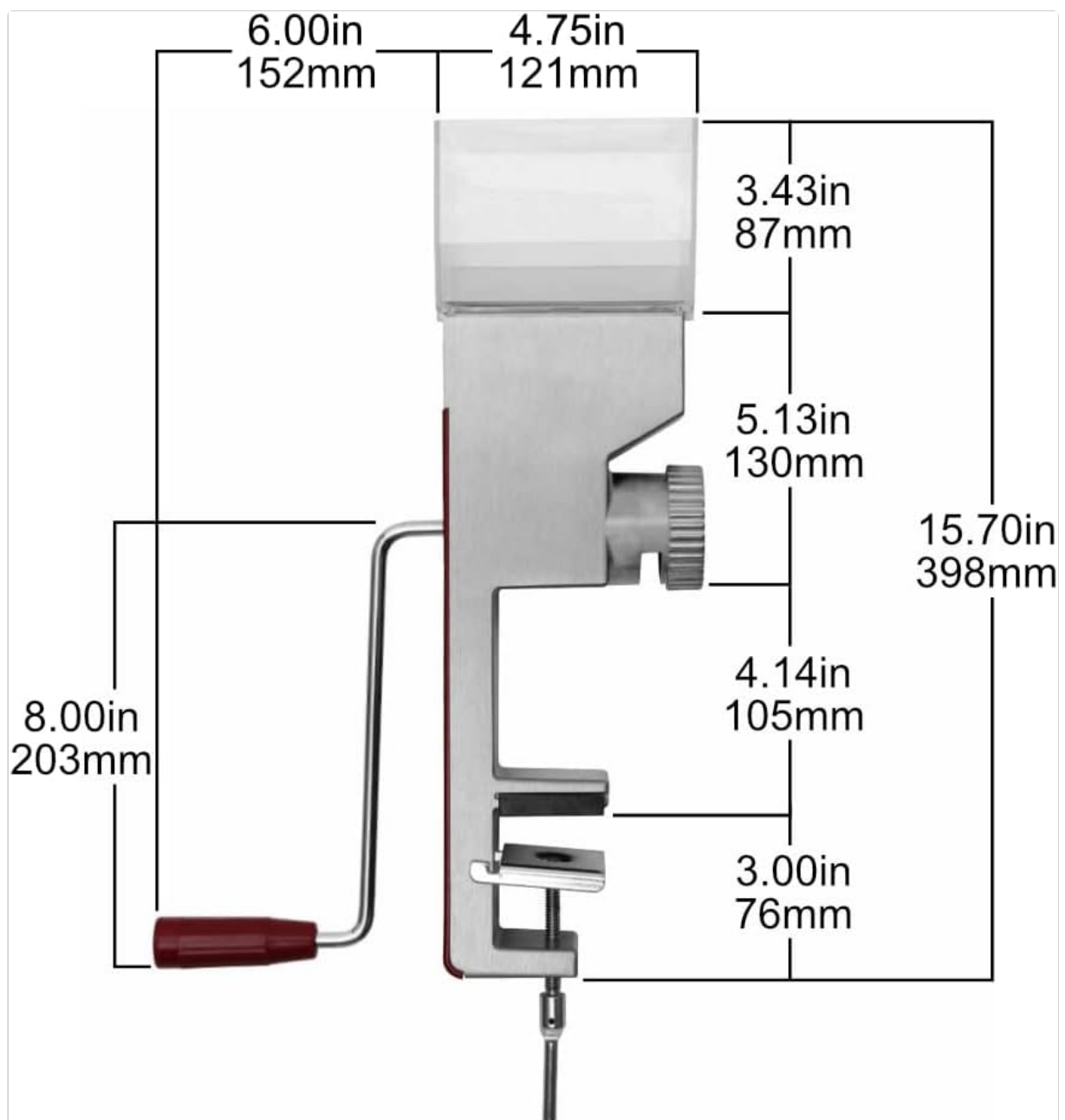

Figure 5: Dimensional diagram of the Kitchen Crop Deluxe Grain Mill, illustrating its height, width, and length in both inches and millimeters.

8. WARRANTY AND SUPPORT

The Kitchen Crop Deluxe Grain Mill is backed by a comprehensive **5-year warranty**, ensuring your peace of mind and long-term satisfaction with your purchase. For warranty claims, technical support, or replacement parts, please contact KITCHEN CROP customer service through their official website or the retailer where the product was purchased.