

- › [Case](#) /
- › [Case 1845C Uni-Loader Skid Steer Service Manual](#)

Case 1845C Uni-Loader Skid Steer

Case 1845C Uni-Loader Skid Steer Service Manual

Model: 1845C Uni-Loader Skid Steer

INTRODUCTION

This document serves as a comprehensive service manual for the Case 1845C Uni-Loader Skid Steer. It provides detailed instructions, specifications, and diagrams necessary for the proper maintenance, repair, and troubleshooting of the machine. With 570 pages, including color and foldout diagrams, this manual is an essential resource for technicians and owners.

MANUAL OVERVIEW

The service manual is organized into distinct sections, each focusing on a specific system or component of the Case 1845C Uni-Loader. This structure allows for easy navigation and quick access to relevant information.

1845C UNI-LOADER TABLE OF CONTENTS		
SERIES/SECTION	SECTION NO.	FORM NO.
1 GENERAL		
Safety Rules, Service Manual Introduction and		
Torque Specifications	1001	8-42910
Fluids and Lubricants Chart	1002	8-42910
General Engine Specifications	1010	8-27200
Detailed Engine Specifications	1024	8-24161
2 ENGINES		
Engine and Radiator Removal and Installation	2000	8-42910
Engine Accessories (Air Cleaner, Ether Injection		
System, and Mufflers)	2001	8-42910
Cylinder Head and Valve Train	2415	8-24171
Cylinder Block, Crankshaft, Pistons, Rods, Camshaft,		
Main Bearings, Oil Seals, and Flywheel	2425	8-2418
Lubrication System	2445	8-2411
Cooling System	2455	8-242
3 FUEL SYSTEM		
Engine Controls, Fuel Lines, and Fuel Tank	3001	8-4
Fuel System and Filters	3410	8-
Fuel Injection Pump and Drive Gear	3412	8
Fuel Injectors	3413	8
ELECTRICAL		
Removal and Installation of Starter and Alternator	4001	
Electrical System Specifications, Troubleshooting, and		
Booster Batteries	4002	
Wiring Schematic	4003	
Battery	4005	

Image: Table of Contents showing major sections like General, Engines, Fuel System, and Electrical.

KEY SECTIONS AND CONTENT

1. General Information

This section covers fundamental aspects such as safety rules, an introduction to the service manual itself, torque specifications, and detailed charts for fluids and lubricants. It also includes general and detailed engine specifications.

2. Engine Systems

Detailed procedures for engine and radiator removal and installation are provided. This includes information on engine accessories like air cleaners, ether injection systems, and mufflers. Comprehensive guidance on cylinder head, valve train, cylinder block, crankshaft, pistons, rods, camshaft, main bearings, oil seals, flywheel, lubrication system, and cooling system is included.

3. Fuel System

This section details engine controls, fuel lines, and the fuel tank. It also covers the fuel system and filters, the fuel injection pump and drive gear, and fuel injectors, providing essential information for maintenance and repair.

4. Electrical System

Instructions for the removal and installation of the starter and alternator are outlined. This section also provides electrical system specifications, troubleshooting guides, and information on booster batteries, wiring schematics, and battery maintenance.

5. Detailed Procedures and Diagrams

The manual includes step-by-step instructions for various repair and maintenance tasks, often accompanied by illustrative images to clarify each step. Exploded view diagrams provide a comprehensive visual breakdown of complex assemblies, aiding in correct reassembly and identification of parts.

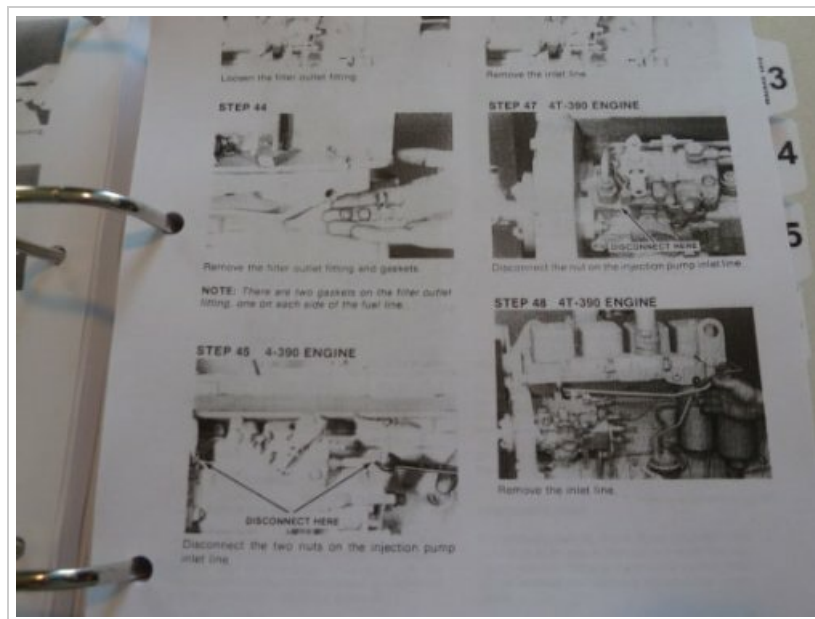

Image: Page showing detailed, numbered steps for removing engine components, including specific instructions for 4T-390 and 4-390 engines.

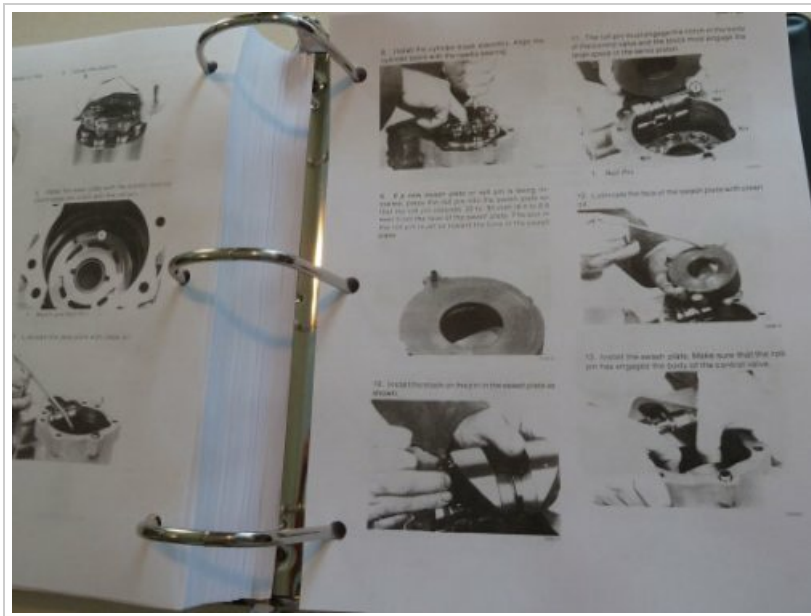

Image: Pages illustrating the assembly of internal components, likely within an engine or hydraulic system, with multiple small images for each step.

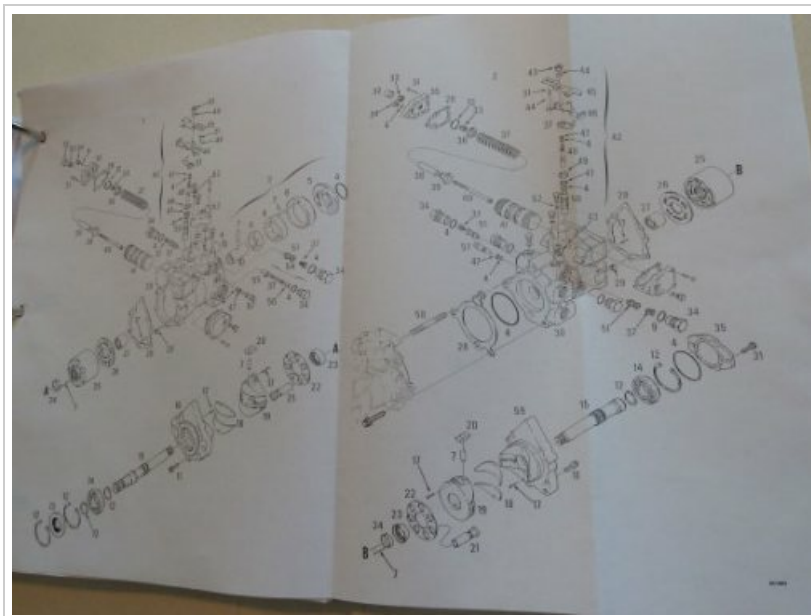

Image: A foldout page displaying an exploded view diagram of a complex mechanical assembly, with numbered parts for identification.

SPECIFICATIONS

The manual includes comprehensive technical specifications for various components and systems of the Case 1845C Uni-Loader. These specifications are crucial for ensuring that all repairs and replacements meet manufacturer standards, contributing to the longevity and optimal performance of the equipment.

MAINTENANCE AND TROUBLESHOOTING

This service manual is designed to guide users through routine maintenance schedules and procedures, helping to prevent common issues and extend the operational life of the skid steer. It also provides structured troubleshooting steps to diagnose and resolve problems efficiently, minimizing downtime.

PUBLISHER INFORMATION

This service manual is published by TechMedia and authored by J.I. Case. It was originally published on January 1, 1986, and is presented in English. The manual is available in a ring-bound format for durability and ease of use in a workshop environment.

© 1986 J.I. Case / TechMedia. All rights reserved.