



[Manuals.plus](#) /

> [iSpring](#) /

> iSpring RCC7AK User Manual: NSF Certified 6-Stage Reverse Osmosis System

iSpring RCC7AK

iSpring RCC7AK User Manual

NSF Certified, 75 GPD, Alkaline 6-Stage Reverse Osmosis System

INTRODUCTION

This manual provides comprehensive instructions for the installation, operation, and maintenance of your iSpring RCC7AK Reverse Osmosis Water Filter System. Designed to deliver clean, healthy, and great-tasting water, this NSF-certified system features a 6-stage filtration process with an alkaline remineralization stage. Please read this manual thoroughly before installation and use to ensure optimal performance and longevity of your system.

PRODUCT OVERVIEW

The iSpring RCC7AK is an advanced under-sink reverse osmosis water filtration system. Key features include:

- **PATENTED DESIGN:** Top-mounted fastener for easy countertop installation from above.
- **MINERAL BOOST:** Patented natural mineral AK stage for balanced pH and essential minerals.
- **TRANSPARENT FIRST-STAGE HOUSING:** Allows easy monitoring of contaminant buildup for timely filter changes.
- **NSF 58 CERTIFIED:** Certified to NSF/ANSI 58 and 372 standards for the entire system.
- **EFFECTIVE FILTRATION:** Reduces over 1,000 contaminants including TDS, PFAS, Chlorine, Lead, and more.
- **EASY INSTALLATION:** DIY-friendly design with quick-fitting connections and step-by-step video guides.
- **TRUSTWORTHY SUPPORT:** Lifetime technical support from Atlanta, GA.
- **CONVENIENT REPLACEMENT FILTERS:** Easy access to various filter sets (F4AK, F9K, F19K75, F28K75).



Figure 1: iSpring RCC7AK 6-Stage Reverse Osmosis System with Alkaline Remineralization. This image shows the complete system including the filter housing, RO membrane, alkaline filter, and the top-mounted faucet.

SETUP AND INSTALLATION

The iSpring RCC7AK system is designed for straightforward DIY installation. Follow these general steps, and refer to the detailed instructions and videos for specific guidance.

- 1. Unboxing and Component Identification:** Carefully unpack all components and verify against the packing list.
- 2. Faucet Installation:** The patented top-mounted faucet allows for installation from above the sink.

Patented Design for Easy Installation

Patented Top-Mounted Design

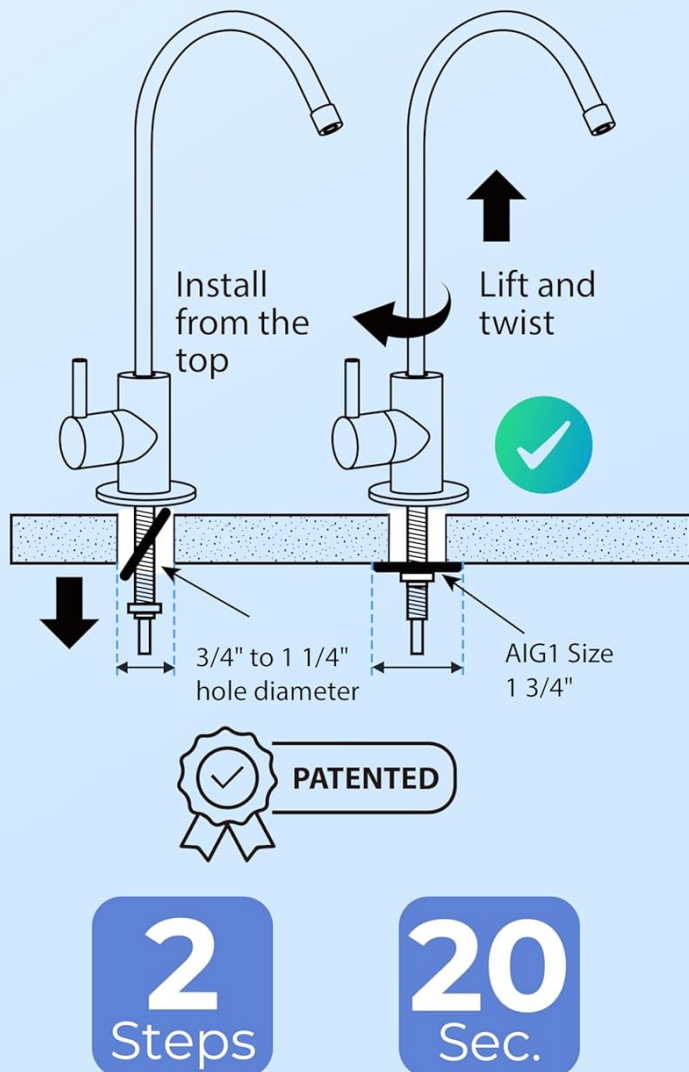

2
Steps

20
Sec.

Other Brands

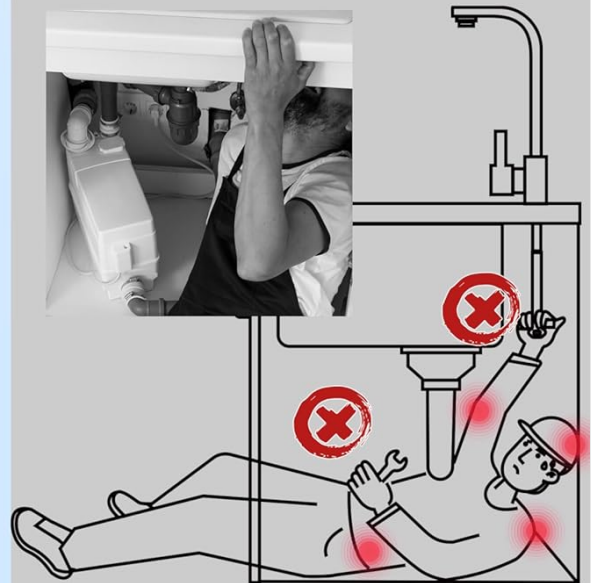

- Hard to Reach
- Tools Required
- Tight Space

6+
Steps

30
Min.

Figure 2: Patented Top-Mounted Faucet Design. This diagram illustrates the simple two-step process for installing the faucet from above the countertop, eliminating the need to work underneath the sink.

3. **Feed Water Adapter Installation:** Connect the feed water adapter to your cold water line.

To Existing Kitchen Faucet

Fits both 1/2" NPT & 3/8" COMP

Feed Water Adapter #AFW43

One Piece Design. No Risk of Leaking.

RO 1/4" Tubing

Do Not Over Tighten

Cold Water Shutoff Valve



Figure 3: Feed Water Adapter. This image details the connection points for the feed water adapter, showing how it integrates with existing plumbing.

4. **Drain Saddle Installation:** Install the drain saddle on the drain pipe under your sink.
5. **Tank Installation:** Place the water storage tank in a suitable location under the sink.
6. **Filter Cartridge Installation:** Insert the filter cartridges into their respective housings. Ensure correct order (PP, GAC, CTO).
7. **Tubing Connections:** Connect the color-coded tubing to the correct ports on the system, tank, faucet, and drain saddle.
8. **System Flush:** Before first use, flush the system as per the detailed instructions to remove carbon fines and air.

OPERATING INSTRUCTIONS

Once installed and flushed, your iSpring RCC7AK system is ready for use. To dispense purified water, simply open the dedicated RO faucet. The system will automatically refill the storage tank as water is drawn.

The alkaline remineralization stage ensures that the purified water has a balanced pH and contains beneficial minerals,

providing a taste similar to natural spring water.

RO + Alkaline Water

Alkaline filter minerals provide these key benefits:

- ✓ Protect pancreatic beta cells with antioxidant properties ^[1]
- ✓ Quickly replenish lost water ^[2]
- ✓ Provide a taste similar to natural spring water
- ✓ Deliver balanced alkalinity

May help reduce:

- ✗ Incidence of coronary heart disease (CHD) ^[1]
- ✗ Cardiovascular disease (CVD) ^[1]
- ✗ Cancer ^[1]
- ✗ Overall mortality ^[1]
- ✗ Osteoporosis ^[1]

References:

- [1] Mousa, H. A. L. (2016). Health Effects of Alkaline Diet and Water, Reduction of Digestive Tract Bacterial Load, and Earthing. *Alternative Therapies in Health & Medicine*, 22.
- [2] Rosborg, I., & Kozisek, F. (2016). *Drinking Water Minerals and Mineral Balance* (p. 175). Springer International.



Note:

This system removes contaminants while restoring essential minerals, improving pH balance and taste, with only a slightly higher TDS.

Figure 4: Transparent First-Stage Filter Housing. This image highlights the transparent housing of the first-stage filter, allowing users to visually inspect the level of sediment and dirt captured, indicating when a filter change is needed.

MAINTENANCE

Regular maintenance is crucial for the optimal performance and longevity of your iSpring RCC7AK system. This primarily involves replacing the filter cartridges according to the recommended schedule.

Filter Replacement Schedule:

Filter Stage	Filter Type	Replacement Frequency
Stage 1 (PP)	PP Sediment Filter	Every 6-12 months (or as needed based on water quality)
Stage 2 (GAC)	Granular Activated Carbon Filter	Every 6-12 months

Filter Stage	Filter Type	Replacement Frequency
Stage 3 (CTO)	Carbon Block Filter	Every 6-12 months
Stage 4 (RO)	Reverse Osmosis Membrane	Every 2-3 years
Stage 5 (FT15)	Post Carbon Filter	Every 12 months
Stage 6 (AK)	Alkaline Remineralization Filter	Every 12 months

RCC7AK Replacement Filter Sets



F4AK

6-Month



F9K

1-Year



F19K75

2-Year



F28K75

3-Year

Figure 5: iSpring RCC7AK Replacement Filter Sets. This image displays the various filter sets available for replacement, categorized by their recommended replacement intervals (6-month, 1-year, 2-year, 3-year).

Replacement filters can be easily accessed. Refer to the specific filter set numbers (F4AK, F9K, F19K75, F28K75) for convenient ordering.

If you encounter any issues with your iSpring RCC7AK system, refer to the following common troubleshooting tips. For more complex problems, contact iSpring technical support.

- **Low Water Flow:** Check the pressure in the storage tank. Ensure all shut-off valves are fully open. Filters may be clogged and require replacement.
- **Unusual Taste or Odor:** This often indicates that the carbon filters (GAC, CTO, Post Carbon) need replacement. Ensure proper flushing after new filter installation.
- **Leaking:** Turn off the water supply immediately. Check all connections for tightness. Ensure O-rings are properly seated and not damaged.
- **No Water Production:** Verify the water supply is on and the feed water adapter is open. Check the tank's air pressure. The RO membrane might be clogged.

For detailed troubleshooting guides and video tutorials, visit the iSpring support website or contact their technical support team.

SPECIFICATIONS

Specification	Value
Brand	iSpring
Model Number	RCC7AK
Material	Plastic, Polypropylene (PP), Polyethylene (PE), Polystyrene, Acrylonitrile Butadiene Styrene (ABS)
Item Weight	20 Pounds
Product Dimensions	15.5 x 16 x 18 inches
External Testing Certification	NSF 58 CERTIFIED
Flow Rate	284 Liters Per Day
Installation Method	Under Sink
Power Source	No Power Needed
Special Features	Reduce TDS

WARRANTY AND SUPPORT

Your iSpring RCC7AK system comes with a **1-year manufacturer limited warranty**. iSpring is committed to providing excellent customer service and offers lifetime technical support from their Atlanta, GA location. For any questions regarding water quality, installation, accessories, or replacement filters, please contact iSpring support.

You can find contact information and additional resources on the official iSpring website or through the provided documentation with your product.



Figure 6: iSpring Customer Support. This image depicts a customer service representative, symbolizing the readily available technical support for water issues, installation, accessories, and replacement filters.