

Manuals+

[Q & A](#) | [Deep Search](#) | [Upload](#)

manuals.plus /

- › [SteelSeries](#) /
- › [SteelSeries Sensei Laser Gaming Mouse User Manual](#)

SteelSeries 62150

SteelSeries Sensei Laser Gaming Mouse User Manual

Model: 62150

1. INTRODUCTION

The SteelSeries Sensei Laser Gaming Mouse is designed for precision and customization, catering to both casual and competitive gamers. It features an advanced laser sensor, an ambidextrous design, and extensive customization options through its dedicated software. This manual provides detailed instructions for setup, operation, maintenance, and troubleshooting to ensure optimal performance of your device.



Image 1: Top-down view of the SteelSeries Sensei Laser Gaming Mouse, showcasing its sleek grey finish and central scroll wheel.

2. PACKAGE CONTENTS

Please verify that all items are present in your package:

- SteelSeries Sensei Laser Gaming Mouse
- Quick Start Guide (if included)



Image 2: Retail packaging for the SteelSeries Sensei Laser Gaming Mouse, displaying the product name and brand logo.

3. SETUP

3.1 Hardware Connection

1. Unpack the SteelSeries Sensei Laser Gaming Mouse from its packaging.
2. Connect the USB cable of the mouse to an available USB port on your computer. The mouse is plug-and-play compatible, and your operating system should automatically detect and install the necessary basic drivers.

3.2 Software Installation (SteelSeries Engine)

For full customization and advanced features, it is recommended to install the SteelSeries Engine software:

1. Visit the official SteelSeries website (steelseries.com/engine) to download the latest version of the SteelSeries Engine software.
2. Follow the on-screen instructions to install the software.
3. Once installed, launch the SteelSeries Engine to configure your mouse settings, including CPI, button assignments, macros, and lighting effects.



Image 3: Bottom view of the SteelSeries Sensei Laser Gaming Mouse, showing the laser sensor and product information label.

4. OPERATING THE MOUSE

4.1 Ambidextrous Design

The Sensei mouse features an ambidextrous shape, making it comfortable for both left-handed and right-handed users. The side buttons are mirrored on both sides to accommodate different grip styles and preferences.

4.2 Programmable Buttons

The mouse is equipped with 7 programmable buttons. These buttons can be customized using the SteelSeries Engine software to perform various functions, including:

- Standard mouse clicks (left, right, middle)
- Keyboard key assignments
- Complex macros
- CPI switching



Image 4: Side view of the SteelSeries Sensei Laser Gaming Mouse, highlighting the two programmable side buttons.

4.3 CPI Adjustment

The Sensei mouse allows for on-the-fly CPI (Counts Per Inch) adjustment. The dedicated CPI indicator button, typically located behind the scroll wheel, allows you to cycle between two user-defined CPI settings. These settings can be configured within the SteelSeries Engine software to match your preferred sensitivity levels for different tasks or games.

4.4 Illumination

The mouse features three-zone illumination: the scroll wheel, the CPI indicator, and the SteelSeries logo. The color and lighting effects (e.g., steady, pulse) for these zones can be customized through the SteelSeries Engine software.

5. STEELSERIES ENGINE SOFTWARE

The SteelSeries Engine is a powerful software suite that unlocks the full potential of your Sensei mouse. Key functionalities include:

- **Button Mapping:** Assign any function, keyboard key, or macro to any of the 7 programmable buttons.
- **CPI Settings:** Fine-tune and save multiple CPI profiles for different applications or games.
- **Macro Editor:** Create and manage complex macros for in-game actions or productivity tasks.
- **Polling Rate:** Adjust the mouse's polling rate for optimal responsiveness.
- **Illumination Control:** Customize LED colors and effects for the scroll wheel, CPI indicator, and logo.
- **Profile Management:** Create and save multiple profiles, allowing you to switch between different configurations quickly.
- **Firmware Updates:** Keep your mouse's firmware up-to-date for improved performance and new features.



Image 5: Screenshot of the SteelSeries Engine software interface, showing options for button mapping, CPI adjustment, and lighting customization.

6. MAINTENANCE

To ensure the longevity and optimal performance of your SteelSeries Sensei mouse, follow these maintenance guidelines:

- **Cleaning:** Use a soft, dry cloth to wipe the surface of the mouse. For stubborn dirt, a slightly damp cloth can be used, but ensure no moisture enters the mouse. Avoid harsh chemicals or abrasive cleaners.
- **Sensor Care:** Keep the laser sensor on the bottom of the mouse clean and free from dust or debris. Use a cotton swab or compressed air if necessary.
- **Cable Management:** Avoid sharp bends or excessive pulling on the USB cable to prevent damage.

7. TROUBLESHOOTING

If you encounter issues with your SteelSeries Sensei mouse, refer to the following common solutions:

- **Mouse Not Responding:**
 - Ensure the USB cable is securely connected to your computer.
 - Try connecting the mouse to a different USB port.
 - Restart your computer.
- **Inconsistent Tracking:**
 - Clean the laser sensor on the bottom of the mouse.
 - Ensure you are using the mouse on a suitable surface (e.g., a mouse pad).
 - Check for dust or debris on your mouse pad.
- **Buttons Not Working:**
 - Verify button assignments in the SteelSeries Engine software.
 - Ensure the software is running correctly and profiles are loaded.

- **Software Issues:**

- Update the SteelSeries Engine software to the latest version.
- Reinstall the SteelSeries Engine software.
- Check for any available firmware updates for your mouse within the software.

8. SPECIFICATIONS

Feature	Detail
Brand	SteelSeries
Model Number	62150
Movement Detection Technology	Laser
Connectivity Technology	USB
Color	Grey
Hardware Platform	PC
Operating System Compatibility	All Major PC Operating Systems
Item Weight	14.6 ounces
Product Dimensions (LxWxH)	7.9 x 6.8 x 2.3 inches
Programmable Buttons	7
Illumination Zones	3 (Scroll Wheel, CPI Indicator, Logo)

9. WARRANTY AND SUPPORT

The SteelSeries Sensei Laser Gaming Mouse is covered by a manufacturer's warranty. For detailed information regarding warranty terms, conditions, and duration, please refer to the warranty card included with your product or visit the official SteelSeries website. For technical support, driver downloads, and frequently asked questions, please visit the SteelSeries support page.

SteelSeries Official Website: steelseries.com

SteelSeries Support: support.steelseries.com

Related Documents - 62150

PRIME
WIRELESS
PRODUCT
INFORMATION
GUIDE

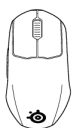

[SteelSeries Prime Wireless Product Information Guide](#)

Get started with the SteelSeries Prime Wireless gaming mouse. This guide covers setup, features, CPI/polling rate functions, battery indicators, and system requirements for optimal performance.

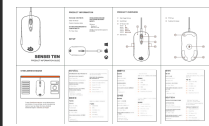

[SteelSeries Sensei Ten Gaming Mouse Product Information](#)

Comprehensive product information guide for the SteelSeries Sensei Ten gaming mouse, detailing package contents, system requirements, setup, and product overview with multilingual support.

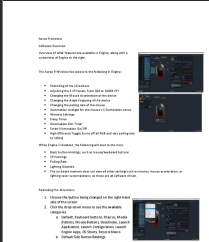

[SteelSeries Aerox 9 Wireless Software Guide](#)

A comprehensive guide to the SteelSeries Engine software for the Aerox 9 Wireless gaming mouse, covering button remapping, CPI settings, illumination customization, and battery saving features.

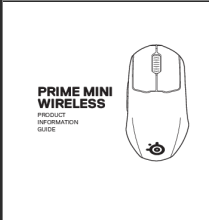

[SteelSeries Prime Mini Wireless Product Information Guide](#)

A comprehensive guide to the SteelSeries Prime Mini Wireless gaming mouse, covering setup, features, and specifications. Learn how to connect your mouse, customize settings with SteelSeries Engine, and understand its various functions and indicators.

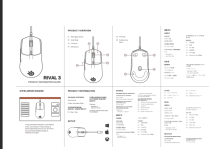

[SteelSeries Rival 3 Gaming Mouse Product Information Guide](#)

Comprehensive guide for the SteelSeries Rival 3 gaming mouse, covering product overview, system requirements, software needs, setup, and compliance information. Includes multilingual support details.

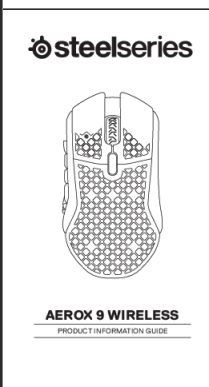

[SteelSeries Aerox 9 Wireless Gaming Mouse: Product Information Guide](#)

Comprehensive guide for the SteelSeries Aerox 9 Wireless gaming mouse, covering setup, features, compatibility, and regulatory information. Learn how to connect, customize, and optimize your gaming experience.